

# PERMIT ISSUED

**City of Portland, Maine - Building or Use Permit Application**  
 389 Congress Street, 04101 Tel: (207) 874-8703, Fax: (207) 874-8716

Permit No: 03-1281	Issue Date: <b>OCT 22 2003</b>	CBL: d7 090 P006001
-----------------------	-----------------------------------	---------------------------

Location of Construction: 471 Island Ave	Owner Name: Bell Christine F Winter	Owner Address: 471 Island Ave <b>CITY OF PORTLAND</b>	Phone: 766-2237
Business Name:	Contractor Name: self	Contractor Address: Portland	Phone:
Lessee/Buyer's Name	Phone:	Permit Type: Sheds	Zone: <b>R-2</b>

Past Use: Single Family	Proposed Use: Single Family w/garden shed	Permit Fee: \$30.00	Cost of Work: \$1,000.00	CEO District: 3	<b>13,020</b>
Proposed Project Description: Build 8x12 wood shed		FIRE DEPT: <input type="checkbox"/> Approved <input type="checkbox"/> Denied		INSPECTION: Use Group: <b>R3</b> Type: <b>accessory</b> <b>BOCA 1999 SB</b>	
		Signature:		Signature: <b>JMB 10/23/03</b>	
PEDESTRIAN ACTIVITIES DISTRICT (P.A.D.)					
Action: <input type="checkbox"/> Approved <input type="checkbox"/> Approved w/Conditions <input type="checkbox"/> Denied					
Signature: _____ Date: _____					

Permit Taken By: jmb	Date Applied For: 10/20/2003	<b>Zoning Approval</b>
-------------------------	---------------------------------	------------------------

<ol style="list-style-type: none"> <li>1. This permit application does not preclude the Applicant(s) from meeting applicable State and Federal Rules.</li> <li>2. Building permits do not include plumbing, septic or electrical work.</li> <li>3. Building permits are void if work is not started within six (6) months of the date of issuance. False information may invalidate a building permit and stop all work..</li> </ol>	<p style="text-align: center;"><b>Special Zone or Reviews</b></p> <input type="checkbox"/> Shoreland <input type="checkbox"/> Wetland <input type="checkbox"/> Flood Zone <input type="checkbox"/> Subdivision <input type="checkbox"/> Site Plan  Maj <input type="checkbox"/> Minor <input type="checkbox"/> MM <input type="checkbox"/> Date: <b>JMB 10/23/03</b>	<p style="text-align: center;"><b>Zoning Appeal</b></p> <input type="checkbox"/> Variance <input type="checkbox"/> Miscellaneous <input type="checkbox"/> Conditional Use <input type="checkbox"/> Interpretation <input type="checkbox"/> Approved <input type="checkbox"/> Denied  Date: _____	<p style="text-align: center;"><b>Historic Preservation</b></p> <input checked="" type="checkbox"/> Not in District or Landmark <input type="checkbox"/> Does Not Require Review <input type="checkbox"/> Requires Review <input type="checkbox"/> Approved <input type="checkbox"/> Approved w/Conditions <input type="checkbox"/> Denied  Date: <b>JMB</b>
--	---	---	---

### CERTIFICATION

I hereby certify that I am the owner of record of the named property, or that the proposed work is authorized by the owner of record and that I have been authorized by the owner to make this application as his authorized agent and I agree to conform to all applicable laws of this jurisdiction. In addition, if a permit for work described in the application is issued, I certify that the code official's authorized representative shall have the authority to enter all areas covered by such permit at any reasonable hour to enforce the provision of the code(s) applicable to such permit.

SIGNATURE OF APPLICANT	ADDRESS	DATE	PHONE
------------------------	---------	------	-------

RESPONSIBLE PERSON IN CHARGE OF WORK, TITLE	DATE	PHONE
---	------	-------

This page contains a detailed description of the Parcel ID you selected. Press the **New Search** button at the bottom of the screen to submit a new query.

**Current Owner Information**

<b>Card Number</b>	1 of 1
<b>Parcel ID</b>	090 P006001
<b>Location</b>	471 ISLAND AVE
<b>Land Use</b>	SEASONAL
<b>Owner Address</b>	BELL CHRISTINE F WINTER 471 ISLAND AVE PEAKS ISLAND ME 04108
<b>Book/Page</b>	7993/13
<b>Legal</b>	90-P-6-7 ISLAND AVE PEAKS ISLAND 13020 SF

**Valuation Information**

<b>Land</b>	<b>Building</b>	<b>Total</b>
\$63,530	\$58,170	\$121,700

**Property Information**

<b>Year Built</b>	<b>Style</b>	<b>Story Height</b>	<b>Sq. Ft.</b>	<b>Total Acres</b>	
1900	Cottage	2	1453	0.299	
<b>Bedrooms</b>	<b>Full Baths</b>	<b>Half Baths</b>	<b>Total Rooms</b>	<b>Attic</b>	<b>Basement</b>
3	1		5	None	Pier/slab

**Outbuildings**

<b>Type</b>	<b>Quantity</b>	<b>Year Built</b>	<b>Size</b>	<b>Grade</b>	<b>Condition</b>
-------------	-----------------	-------------------	-------------	--------------	------------------

**Sales Information**

<b>Date</b>	<b>Type</b>	<b>Price</b>	<b>Book/Page</b>
-------------	-------------	--------------	------------------

**Picture and Sketch**

<u><a href="#">Picture</a></u>	<u><a href="#">Sketch</a></u>
--------------------------------	-------------------------------

[Click here to view Tax Roll Information.](#)

Any information concerning tax payments should be directed to the Treasury office at 874-8490 or [e-mailed.](#)





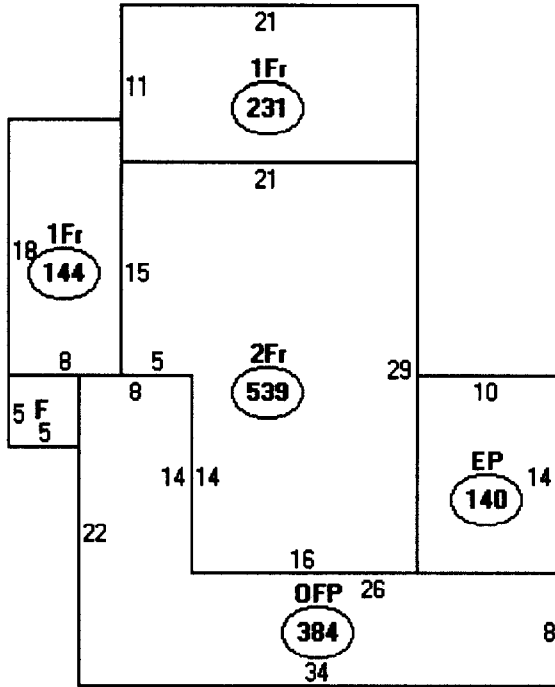

Descriptor/Area

- A: 2Fr  
539 sqft
- B: 1Fr  
144 sqft
- C: 1Fr  
231 sqft
- D: EP  
140 sqft
- E: OFF  
384 sqft
- F: WD  
25 sqft

1,463  
96 shed

1,359

OK

Lot 13,020  
x20%

~~2,604 SF~~

# All Purpose Building Permit Application

If you or the property owner owes real estate or personal property taxes or user charges on any property within the City, payment arrangements must be made before permits of any kind are accepted.

Location/Address of Construction: <u>471 ISLAND AVE PEAKS IS.</u>		
Total Square Footage of Proposed Structure <u>960</u>	Square Footage of Lot <u>13,020</u>	
Tax Assessor's Chart, Block & Lot Chart# <u>90</u> Block# <u>P</u> Lot# <u>687</u>	Owner: <u>CHRISTINA F. WINTER</u>	Telephone: <u>207 766 2237</u>
Lessee/Buyer's Name (if Applicable)	Applicant name, address & telephone: <u>SAME AS ABOVE</u>	Cost Of Work: \$ <u>1000</u> Fee: \$ <u>30.00</u>
Current use: _____		
If the location is currently vacant, what was prior use: <u>YARD</u>		
Approximately how long has it been vacant: <u>Since Purchase</u>		
Proposed use: <u>GARDEN SHED</u>		
Project description: <u>8 X 12</u>		
Contractor's name, address & telephone:		
Who should we contact when the permit is ready: <u>CHRISTINA F WINTER</u>		
Mailing address: <u>471 ISLAND AVE PEAKS IS. ME 04108</u>		
We will contact you by phone when the permit is ready. You must come in and pick up the permit and review the requirements before starting any work, with a Plan Reviewer. A stop work order will be issued and a \$100.00 fee if any work starts before the permit is picked up.    PHONE:		

**IF THE REQUIRED INFORMATION IS NOT INCLUDED IN THE SUBMISSIONS THE PERMIT WILL BE AUTOMATICALLY DENIED AT THE DISCRETION OF THE BUILDING/PLANNING DEPARTMENT, WE MAY REQUIRE ADDITIONAL INFORMATION IN ORDER TO APPROVE THIS PERMIT.**

*I hereby certify that I am the Owner of record of the named property, or that the owner of record authorizes the proposed work and that I have been authorized by the owner to make this application as his/her authorized agent. I agree to conform to all applicable laws of this jurisdiction. In addition, if a permit for work described in this application is issued, I certify that the Code Official's authorized representative shall have the authority to enter all areas covered by this permit at any reasonable hour to enforce the provisions of the codes applicable to this permit.*

Signature of applicant: <u>Christina F. Winter</u>	Date: <u>10/16/03</u>
--	-----------------------

**This is NOT a permit, you may not commence ANY work until the permit is issued.  
If you are in a Historic District you may be subject to additional permitting and fees with the  
Planning Department on the 4<sup>th</sup> floor of City Hall**

DISPLAY THIS CARD ON PRINCIPAL FRONTAGE OF WORK

# CITY OF PORTLAND

## BUILDING INSPECTION

### PERMIT ISSUED

Please Read Application And Notes, If Any, Attached

Permit Number: 031281

OCT 22 2003

This is to certify that Bell Christine F Winter/self

has permission to Build 8x12 wood shed

**CITY OF PORTLAND**

AT 471 Island Ave

090 P006001

provided that the person or persons, firm or corporation accepting this permit shall comply with all of the provisions of the Statutes of Maine and of the Ordinances of the City of Portland regulating the construction, maintenance and use of buildings and structures, and of the application on file in this department.

Apply to Public Works for street line and grade if nature of work requires such information.

Notification of inspection must be given and when permission is procured before this building or part thereof is occupied or services used-in. HOUR NOTIFICATION REQUIRED.

A certificate of occupancy must be procured by owner before this building or part thereof is occupied.

#### OTHER REQUIRED APPROVALS

Fire Dept. \_\_\_\_\_

Health Dept. \_\_\_\_\_

Appeal Board \_\_\_\_\_

Other \_\_\_\_\_  
Department Name

*James Bourke* 10/23/03  
Director - Building & Inspection Services

**PENALTY FOR REMOVING THIS CARD**

# BUILDING PERMIT INSPECTION PROCEDURES

Please call 874-8703 or ~~874-8699~~ to schedule your inspections as agreed upon

Permits expire in 6 months, if the project is not started or ceases for 6 months.

The Owner or their designee is required to notify the inspections office for the following inspections and provide adequate notice. Notice must be called in 48-72 hours in advance in order to schedule an inspection:

By initialzing at each inspection time, you are agreeing that you understand the inspection procedure and additional fees from a "Stop Work Order" and "Stop Work Order Release" will be incurred if the procedure is not followed as stated below.

JB ~~Pre-construction Meeting~~: Must be scheduled with your inspection team upon receipt of this permit. Jay Reynolds, Development Review Coordinator at 874-8632 must also be contacted at this time, before any site work begins on any project other than single family additions or alterations.

- |                                     |   |   |
|-------------------------------------|---|---|
| <input checked="" type="checkbox"/> | Footing/Building Location Inspection:       | Prior to pouring concrete   |
| <input checked="" type="checkbox"/> | Re-Bar Schedule Inspection:                 | Prior to pouring concrete   |
| <input checked="" type="checkbox"/> | Foundation Inspection:                      | Prior to placing ANY backfill   |
| <input checked="" type="checkbox"/> | Framing/Rough Plumbing/Electrical:          | Prior to any insulating or drywalling   |
| <input checked="" type="checkbox"/> | <del>Final Certificate of Occupancy</del> : | Prior to any occupancy of the structure or use. NOTE: There is a <del>\$75.00 fee</del> per inspection at this point. |

Certificate of Occupancy is not required for certain projects. Your inspector can advise you if your project requires a Certificate of Occupancy. All projects DO require a final inspection

If any of the inspections do not occur, the project cannot go on to the next phase, REGARDLESS OF THE NOTICE OR CIRCUMSTANCES.

NA **CERTIFICATE OF OCCUPANICES MUST BE ISSUED AND PAID FOR, BEFORE THE SPACE MAY BE OCCUPIED**

<u>x Susan S. Smith</u>	<u>10/27/03</u>
Signature of applicant/designee	Date
<u>Jamie Bouke</u>	<u>10/27/03</u>
Signature of Inspections Official	Date

CBL: 90-P-6 Building Permit #: 03-1281