

City of Portland, Maine - Building or Use Permit Application

389 Congress Street, 04101 Tel: (207) 874-8703, Fax: (207) 874-8716

| | | |
|-----------------------|-----------------------------------|--------------------|
| Permit No: 05-1506 | Issue Date: NOV 23 2005 | CBL 090 00 5001 |
|-----------------------|-----------------------------------|--------------------|

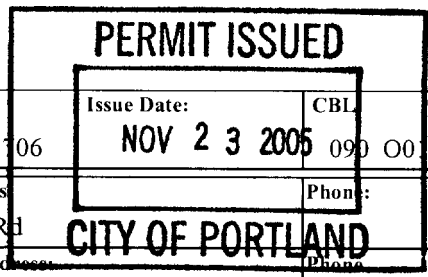

| | | | |
|--|--|--|---|
| Location of Construction: 51 Sargent Rd | Owner Name: Sutherland Perry S | Owner Address: 51 Sargent Rd | Phone: |
| Business Name: | Contractor Name: self | Contractor Address: Portland | Phone: |
| Lessee/Buyer's Name | Phone: | Permit Type: Additions - Dwellings | Zone: IR-2 |
| Past Use: Single Family | Proposed Use: Single Family w/14' x 20' barn on piers w/storage above, 8' x 14' screen porch & 374 sf of deck on grade | Permit Fee: \$228 00 | Cost of Work: \$23,000.00 |
| Proposed Project Description: Build a 14' x 20' barn on piers w/storage above, 8' x 14' screen porch & 374 sf of deck on grade | | CEO District: 2 | INSPECTION: Use Group R3 Type SB IRL-2003 Signature: JMB 11/23/05 |
| | | FIRE DEPT: <input type="checkbox"/> Approved <input type="checkbox"/> Denied | Signature: |
| | | PEDESTRIAN ACTIVITIES DISTRICT (P.A.D.) Action: <input type="checkbox"/> Approved <input type="checkbox"/> Approved w/Conditions <input type="checkbox"/> Denied Signature: _____ Date: _____ | |

| | | | | |
|---|--|--|---|---|
| Permit Taken By: jmb | Date Applied For: 11/22/2005 | Zoning Approval | | |
| <ol style="list-style-type: none"> This permit application does not preclude the Applicant(s) from meeting applicable State and Federal Rules. Building permits do not include plumbing, septic or electrical work. Building permits are void if work is not started within six (6) months of the date of issuance. False information may invalidate a building permit and stop all work.. | | Special Zone or Reviews <input type="checkbox"/> Shoreland <input type="checkbox"/> Wetland <input type="checkbox"/> Flood Zone <i>part 15</i> <input type="checkbox"/> Subdivision <i>zone x</i> <input type="checkbox"/> Site Plan <i>OK</i> Maj <input type="checkbox"/> Minor <input type="checkbox"/> MM <input type="checkbox"/> Date: JMB 11/23/05 | Zoning Appeal <input type="checkbox"/> Variance <input type="checkbox"/> Miscellaneous <input type="checkbox"/> Conditional Use <input type="checkbox"/> Interpretation <input type="checkbox"/> Approved <input type="checkbox"/> Denied Date: _____ | Historic Preservation <input checked="" type="checkbox"/> Not in District or Landmark <input type="checkbox"/> Does Not Require Review <input type="checkbox"/> Requires Review <input type="checkbox"/> Approved <input type="checkbox"/> Approved w/Conditions <input type="checkbox"/> Denied Date: JMB |

CERTIFICATION

I hereby certify that I am the owner of record of the named property, or that the proposed work is authorized by the owner of record and that I have been authorized by the owner to make this application as his authorized agent and I agree to conform to all applicable laws of this jurisdiction. In addition, if a permit for work described in the application is issued, I certify that the code official's authorized representative shall have the authority to enter all areas covered by such permit at any reasonable hour to enforce the provision of the code(s) applicable to such permit.

SIGNATURE OF APPLICANT ADDRESS DATE PHONE

RESPONSIBLE PERSON IN CHARGE OF WORK, TITLE DATE PHONE



General Building Permit Application

If you or the property owner owes real estate or personal property taxes or user charges on **any property within the City, payment arrangements must be made before permits of any kind are accepted.**

| | | | |
|---|--|--|---|
| Total Square Footage of Proposed Structure TOTAL: 780 | | Square Footage of Lot 11,018 | |
| Tax Assessor's Chart, Block & Lot Chart# Block# Lot# 90 0 15.16.17.19.20 | | Owner: PERRY S. SUTHERLAND | Telephone: 766-5809 |
| Lessee/Buyer's Name (If Applicable) | | Applicant name, address & telephone: PERRY SUTHERLAND 51 SARGENT RD. PEAKS ISLAND 04108 766.5809 | Cost Of Work: \$ 23,000 Fee: \$ 228.00 C of O Fee: \$ _____ |
| Current Specific use: <u>SINGLE FAMILY RESIDENCE</u> | | Proposed Specific use: <u>"</u> | |
| Project description: BUILDING SMALL BARN W/ SMALL SCREENED PORCH AND DECKS | | | |
| Contractor's name, address & telephone: SELF | | | |
| Who should we contact when the permit is ready: <u>OWNER / SELF</u> | | | |
| Mailing address: 51 SARGENT RD PEAKS ISLAND, 04108 | | Phone: <u>766.5809</u> | |

Please submit all of the information outlined in the Commercial Application Checklist. Failure to do so will result in the automatic denial of your permit.

In order to be sure the City fully understands the full scope of the project, the Planning and Development Department may request additional information prior to the issuance of a permit. For further information visit us on-line at www.portlandmaine.gov, stop by the Building Inspections office, room 315 City Hall or call 874-8703.

I hereby certify that I am the Owner of record of the named property, or that the owner of record authorizes the proposed work and that I have been authorized by the owner to make this application as his/her authorized agent. I agree to conform to all applicable laws of this jurisdiction. In addition, if a permit for work described in this application is issued, I certify that the Code Official's authorized representative shall have the authority to enter all areas covered by this permit at any reasonable hour to enforce the provisions of the codes applicable to this permit.

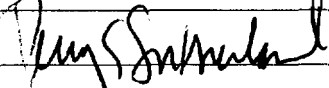
| | |
|---|-----------------------|
| Signature of applicant:  | Date: 11.23.05 |
|---|-----------------------|

This is not a permit; you may not commence ANY work until the permit is issued.

City of Portland, Maine - Building or Use Permit

389 Congress Street, 04101 Tel: (207) 874-8703, Fax: (207) 874-8716

| | | |
|------------------------------|--|----------------------------|
| Permit No: 05-1706 | Date Applied For: 11/22/2005 | CBL: 090 0015001 |
|------------------------------|--|----------------------------|

| | | | |
|---|--|--|---------------|
| Location of Construction: 51 Sargent Rd | Owner Name: Sutherland Perry S | Owner Address: 51 Sargent Rd | Phone: |
| Business Name: | Contractor Name: self | Contractor Address: Portland | Phone: |
| Lessee/Buyer's Name | Phone: | Permit Type: Additions - Dwellings | |

| | |
|--|--|
| Proposed Use: Single Family w/14' x 20' barn on piers w/storage above, 8' x 14' screen porch & 374 sf of deck on grade | Proposed Project Description: Build a 14' x 20' barn on piers w/storage above, 8' x 14' screen porch & 374 sf of deck on grade |
|--|--|

Dept: Zoning **Status:** Approved with Conditions **Reviewer:** Jeanine Bourke **Approval Date:** 11/23/2005

Note: **Ok to Issue:**

- 1) This property shall remain a single family dwelling. Any change of use shall require a separate permit application for review and approval.
- 2) Approved using the adjacent lot average setback for the front yard, inspector verify
- 3) The maximum height is 18' measured at the average roof pitch, inspector verify

Dept: Building **Status:** Approved with Conditions **Reviewer:** Jeanine Bourke **Approval Date:** 11/23/2005

Note: **Ok to Issue:**

- 1) Separate permits are required for any electrical, plumbing, or heating.
- 2) The loft is to be used for storage only, not a habitable space
- 3) Permit approved based on the plans submitted and reviewed w/owner/contractor, with additional information as agreed on and as noted on plans.

This page contains a detailed description of the Parcel ID you selected. Press the **New Search** button at the bottom of the screen to submit a new query.

Current Owner Information

| | |
|---------------|---|
| Card Number | I of I |
| Parcel ID | 090 0015001 |
| Location | 51 SARGENT RD |
| Land Use | SINGLE FAMILY |
| Owner Address | SUTHERLAND PERRY S 51 SARGENT RD PEAKS ISLAND RE 04108 |
| Book/Page | 10955/274 |
| Legal | 90-0-15-16-17-19-20 SARGENT RD-PLEASANT AV PEAKS ISLAND 11018SF |

*11/23 7³⁰
w.will*

*# 1706
IR-2
Stream Protect
Panel 15
zone X*

*14' x 20' ~~balcon~~
8' x 14 screen porch
8 x 20, 4 x 8 & 13' x 14
decks*

Current Assessed Valuation For Fiscal Year 2006

| | | |
|-----------|----------|-----------|
| Land | Building | Total |
| \$117,780 | \$56,750 | \$174,530 |

Estimated Assessed Valuation For Fiscal Year 2007*

| | | |
|-----------|----------|-----------|
| Land | Building | Total |
| \$190,200 | \$75,900 | \$266,100 |

* Value subject to change based upon review of property status as of 4/1/06. The tax rate will be determined by City Council in May 2006.

Property Information

| | | | | | |
|------------|------------|--------------|-------------|-------------|-----------|
| Year Built | Style | Story Height | sq. Ft. | Total Acres | |
| 1908 | Old Style | 1 | 1016 | 0.253 | |
| Bedrooms | Full Baths | Half Baths | Total Rooms | Attic | Basement |
| 2 | 1 | | 5 | Part Finsh | Pier/slab |

\$ 228

Outbuildings

| | | | | | |
|------|----------|------------|------|-------|-----------|
| Type | quantity | Year Built | Size | Grade | Condition |
|------|----------|------------|------|-------|-----------|

Sales Information

| | | | |
|------------|---------------|----------|-----------|
| Date | Type | Price | Book/Page |
| 09/01/1993 | LAND + BLDING | \$72,500 | 10955-274 |
| 06/01/1993 | LAND + BLDING | | 10960-278 |

Picture and Sketch

| | | |
|---------|--------|---------|
| Picture | Sketch | Tax Map |
|---------|--------|---------|

*392
~~172~~
160
32
182*

Click [here](#) to view Tax Roll Information.

Any information concerning tax payments should be directed to the Treasury office at 874-8490 or e-



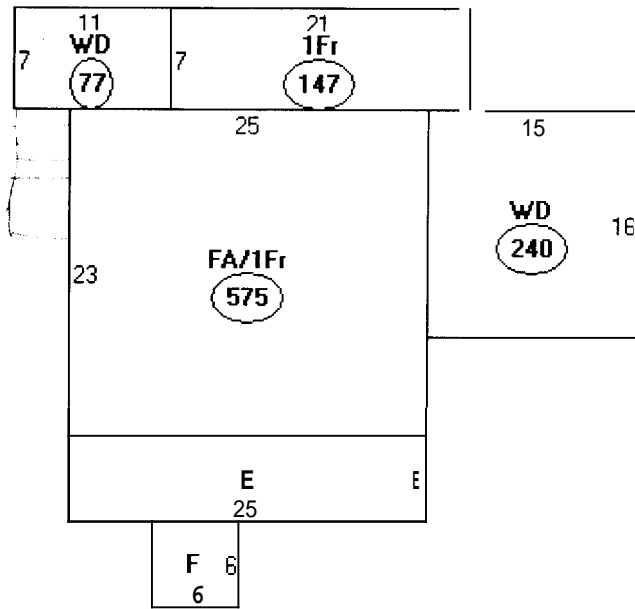

Descriptor/Area

- A FA/1Fr
575 sqft
- B: WD
77 sqft
- C 1Fr
147 sqft
- D WD
240 sqft
- E 1Fr
150 sqft
- F EP
36 sqft

BUILDING PERMIT INSPECTION PROCEDURES

Please call 874-8703 or 874-8693 to schedule your inspections as agreed upon

Permits expire in 6 months, if the project is not started or ceases for 6 months.

The Owner or their designee is required to notify the inspections office for the following inspections and provide adequate notice. Notice must be called in 48-72 hours in advance in order to schedule an inspection:

By initializing at each inspection time, you are agreeing that you understand the inspection procedure and additional fees from a "Stop Work Order" and "Stop Work Order Release" will be incurred if the procedure is not followed as stated below.

A **Pre-con**struction Meeting will take place upon receipt of your building permit.

- Footing/Building Location Inspection: Prior to pouring concrete
- NA Re-Bar Schedule Inspection: Prior to pouring concrete
- NA Foundation Inspection: Prior to placing ANY backfill
- NA Framing/Rough Plumbing/Electrical: Prior to any insulating or drywalling
- ~~Final/Certificate of Occupancy~~: Prior to any occupancy of the structure or use. ~~NOTE: There is a \$75.00 fee per inspection at this point.~~

Certificate of Occupancy is not required for certain projects. Your inspector can advise you if your project requires a Certificate of Occupancy. **All** projects DO require a final inspection

If any of the inspections do not occur, the project cannot go on to the next phase, REGARDLESS OF THE NOTICE OR CIRCUMSTANCES.

NA **CERIFICATE OF OCCUPANICES MUST BE ISSUED AND PAID FOR, BEFORE THE SPACE MAY BE OCCUPIED**

Perry S. Sullivan
Signature of Applicant/Designee

11/23/05
Date

James Brown
Signature of Inspections Official

11/23/05
Date

CBL: 090-0-15 +

Building Permit #: 05-1706

DISPLAY THIS CARD ON PRINCIPAL FRONTAGE OF WORK

CITY OF PORTLAND

BUILDING INSPECTION

PERMIT

PERMIT ISSUED

Permit Number: 051706

NOV 23 2005

CITY OF PORTLAND

Please Read Application And Notes, If Any, Attached

This is to certify that Sutherland Perry S/self

has permission to Build a 14' x 20' barn on pier /storage above, 8' x 14' screen porch & 374 sf of deck on grade

AT 51 Sargent Rd Call 090 0015001

provided that the person or persons, firm or corporation accepting this permit shall comply with all of the provisions of the Statutes of the State and of the Ordinances of the City of Portland regulating the construction, maintenance and use of buildings and structures, and of the application on file in this department.

Apply to Public Works for street line and grade if nature of work requires such information.

Notification of inspection must be given and when permission procured before this building or part thereof is laid or closed-in. 24 HOUR NOTICE IS REQUIRED.

A certificate of occupancy must be procured by owner before this building or part thereof is occupied.

OTHER REQUIRED APPROVALS

Fire Dept. _____

Health Dept. _____

Appeal Board _____

Other _____
Department Name

Jeannie Bourke 11/23/05
Director - Building & Inspection Services

PENALTY FOR REMOVING THIS CARD