

Permit # 2004-6036

SUBSURFACE WASTEWATER DISPOSAL SYSTEM APPLICATION

Maine Department of Human Services
Division of Health Engineering, Station 10 SHS
(207) 287-5672 FAX (207) 287-4172

PROPERTY LOCATION		Caution: Permit Required - Attach in Space Below	
City, Town, or Plantation	PORTLAND; PEAKS ISLAND	PORTLAND PERMIT # 9142 STATE COPY Date Permit Issued: 8/12/04 \$ 1,400.00 <input type="checkbox"/> Double Fee Charged Local Plumbing Inspector Signature: <i>[Signature]</i> L.P.I. # 010410	9008
Street or Road	397 ISLAND AVENUE		
Subdivision, Lot #		Municipal Tax Map # 9C Lot # SEC 0 LOT 8	
OWNER/APPLICANT INFORMATION			
Name (last, first, MI)	N/F WAGNER	Owner <input type="checkbox"/> Applicant <input checked="" type="checkbox"/>	
Mailing Address of	JENNIFER & ERIC WEISER c/o ALICE @ PORT ISLAND REALTY		
Daytime Tel. #			

Owner or Applicant Statement	Caution: Inspections Required
I state and acknowledge that the information submitted is correct to the best of my knowledge and understand that any falsification is reason for the Department and/or Local Plumbing Inspector to deny a permit.	I have inspected the installation as shown above and found it to be in compliance with the Subsurface Wastewater Disposal Rules Application.
Signature of Owner/Applicant: <i>[Signature]</i> Date: 9/20/04	Local Plumbing Inspector Signature: _____ Date: _____

PERMIT INFORMATION		
TYPE OF APPLICATION	THIS APPLICATION REQUIRES	DISPOSAL SYSTEM COMPONENTS
1. <input type="checkbox"/> First Time System 2. <input checked="" type="checkbox"/> Replacement System Type Replaced: _____ Year Installed: _____ 3. <input checked="" type="checkbox"/> Expanded System a. <input checked="" type="checkbox"/> Minor Expansion b. <input type="checkbox"/> Major Expansion 4. <input type="checkbox"/> Experimental System 5. <input type="checkbox"/> Seasonal Conversion	1. <input checked="" type="checkbox"/> No Rule Variance 2. <input type="checkbox"/> First Time System Variance a. <input type="checkbox"/> Local Plumbing Inspector Approval b. <input type="checkbox"/> State & Local Plumbing Inspector Approval 3. <input type="checkbox"/> Replacement System Variance a. <input type="checkbox"/> Local Plumbing Inspector Approval b. <input type="checkbox"/> State & Local Plumbing Inspector Approval 4. <input type="checkbox"/> Minimum Lot Size Variance 5. <input type="checkbox"/> Seasonal Conversion Approval	1. <input checked="" type="checkbox"/> Complete Non-Engineered System 2. <input type="checkbox"/> Primitive System (greywater & all toilet) 3. <input type="checkbox"/> Alternative Toilet, specify: _____ 4. <input type="checkbox"/> Non-Engineered Treatment Tank (only) 5. <input type="checkbox"/> Holding Tank, _____ Gallons 6. <input type="checkbox"/> Non-Engineered Disposal Field (only) 7. <input type="checkbox"/> Separated Laundry System 8. <input type="checkbox"/> Complete Engineered System (2000 gpd) 9. <input type="checkbox"/> Engineered Treatment Tank (only) 10. <input type="checkbox"/> Engineered Disposal Field (only) 11. <input type="checkbox"/> Pre-treatment, specify: _____ 12. <input type="checkbox"/> Miscellaneous components.
SIZE OF PROPERTY	DISPOSAL SYSTEM TO SERVE	TYPE OF WATER SUPPLY
+1-19,530 <input checked="" type="checkbox"/> sq. ft. <input type="checkbox"/> acres	1. <input checked="" type="checkbox"/> Single Family Dwelling Unit, No. of Bedrooms: 3 2. <input type="checkbox"/> Multiple Family Dwelling, No. of Units: _____ 3. <input type="checkbox"/> Other: _____ SPECIFY Current Use <input type="checkbox"/> Seasonal <input checked="" type="checkbox"/> Year Round <input type="checkbox"/> Undeveloped	1. <input type="checkbox"/> Drilled Well 2. <input type="checkbox"/> Dug Well 3. <input type="checkbox"/> Private 4. <input checked="" type="checkbox"/> Public 5. <input type="checkbox"/> Other: _____
SHORELAND ZONING		
<input type="checkbox"/> Yes <input checked="" type="checkbox"/> No		

DESIGN DETAILS SYSTEM LAYOUT SHOWN ON PAGE 3			
TREATMENT TANK	DISPOSAL FIELD TYPE & SIZE	GARBAGE DISPOSAL UNIT	DESIGN FLOW
1. <input checked="" type="checkbox"/> Concrete a. <input type="checkbox"/> Regular b. <input checked="" type="checkbox"/> Low Profile 2. <input type="checkbox"/> Plastic (IF NECESSARY) 3. <input type="checkbox"/> Other: _____ CAPACITY: 1000 gallons	1. <input type="checkbox"/> Stone Bed 2. <input type="checkbox"/> Stone Trench 3. <input checked="" type="checkbox"/> Proprietary Device a. <input type="checkbox"/> Cluster array c. <input checked="" type="checkbox"/> Linear b. <input checked="" type="checkbox"/> Regular d. <input type="checkbox"/> H-20 loaded 4. <input type="checkbox"/> Other: _____ SIZE: 960 <input checked="" type="checkbox"/> sq. ft. <input type="checkbox"/> lin. ft. 20 ELIEN IN-DRAIN UNITS	1. <input checked="" type="checkbox"/> No 3. <input type="checkbox"/> Maybe 2. <input type="checkbox"/> Yes >> Specify one below: a. <input type="checkbox"/> Multi-compartment tank b. <input type="checkbox"/> _____ tanks in series c. <input type="checkbox"/> Increase in tank capacity d. <input type="checkbox"/> Filter on tank outlet	270 gallons per day BASED ON: 1. <input checked="" type="checkbox"/> Table 501.1 (dwelling unit(s)) 2. <input type="checkbox"/> Table 501.2 (other facilities) SHOW CALCULATIONS - for other facilities - EXISTING 2 BEDROOMS POTENTIAL 3 BEDROOMS AT 50 GALLONS PER DAY EACH
SOIL DATA & DESIGN CLASS	DISPOSAL FIELD SIZING	PUMPING	
PROFILE CONDITION DESIGN 2 / A / 1 AT Observation Hole - TP 1 Depth 24 OF MOST LIMITING SOIL FACTOR	1. <input type="checkbox"/> Small - 2.0 sq.ft./gpd 2. <input type="checkbox"/> Medium - 2.6 sq.ft./gpd 3. <input checked="" type="checkbox"/> Medium-Large - 3.3 sq.ft./gpd 4. <input type="checkbox"/> Large - 4.1 sq.ft./gpd 5. <input type="checkbox"/> Extra-Large - 5.0 sq.ft./gpd	1. <input type="checkbox"/> Not required (SEE NOTE ON PAGE 3) 2. <input checked="" type="checkbox"/> Maybe required 3. <input type="checkbox"/> Required >> Specify only for engineered or experimental systems: DOSE: _____ Gallons	

SITE EVALUATOR STATEMENT
I certify that on 8/19/04 (date) I completed a site evaluation on this property and state that the data reported is accurate and that the proposed system is in compliance with the Subsurface Wastewater Disposal Rules (10-144A CMR 241).
Signature: <i>Albert Frick</i> SE Date: 8/30/2004

ALBERT FRICK	(207) 839-5563	ALBERT.FRICK@WORLDNET.ATT.NET
Site Evaluator Name Printed	Telephone Number	E-mail Address
ALBERT FRICK ASSOCIATES - 85A COUNTY ROAD ROAD GOPHAM, MAINE 04038 - (207) 839-5563		
Note: Changes to or deviations from the design should be confirmed with the Site Evaluator		

OCT 2 9 2004
HHE-200 Rev. 8/01

SUBSURFACE WASTEWATER DISPOSAL SYSTEM APPLICATION

Maine Department of Human Services
Division of Health Engineering, Station 10 SMS
(207) 287-5672 FAX (207) 287-4172

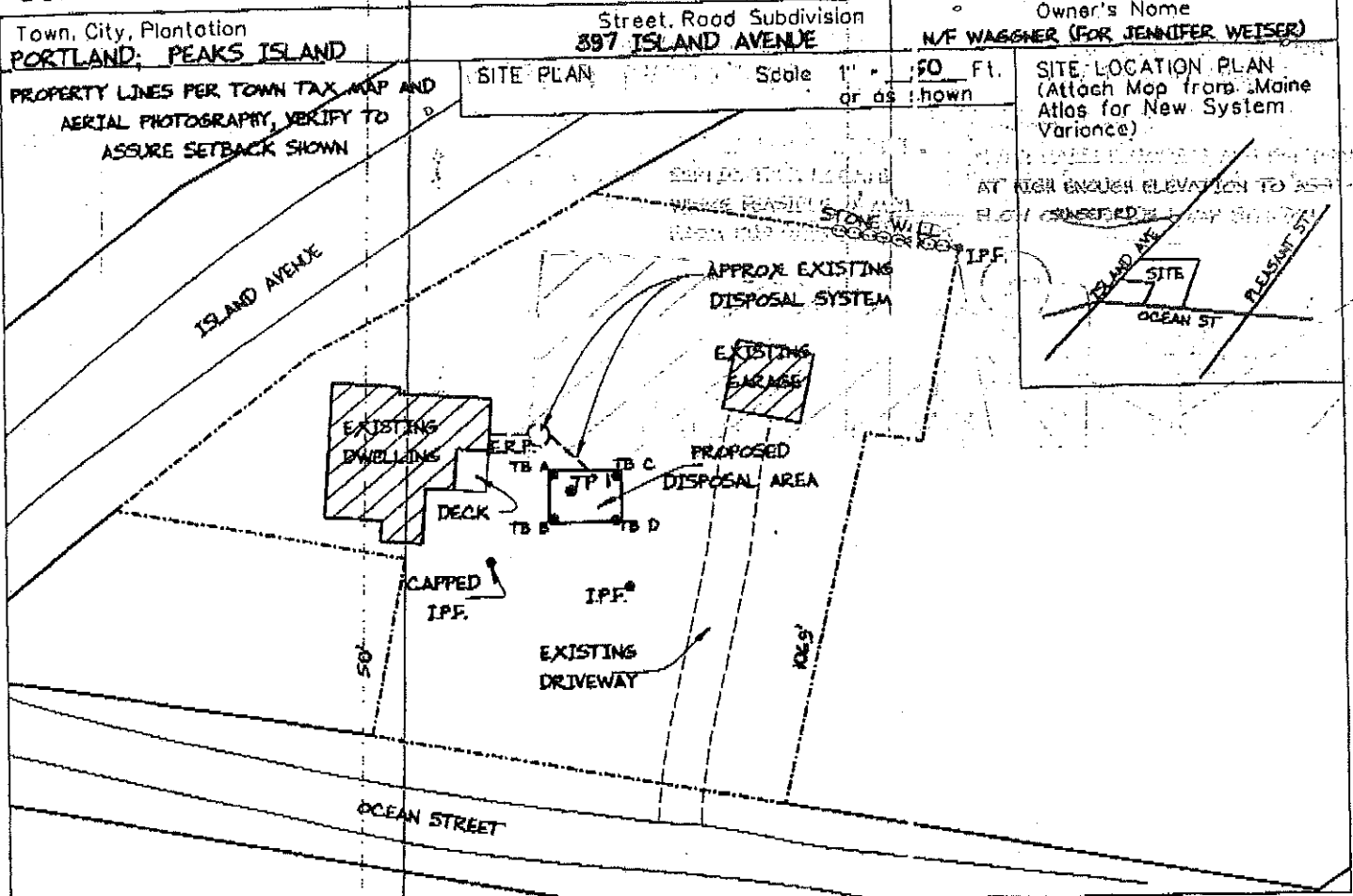

SOIL DESCRIPTION AND CLASSIFICATION (Location of Observation Holes Shown Above)

Observation Hole **TP 1** Test Pit Boring
Depth of Organic Horizon Above Mineral Soil

DEPTH BELOW MINERAL SOIL SURFACE (feet)	Texture	Consistency	Color	Mottling
0			DARK BROWN	
10	SANDY LOAM	FRIABLE	YELLOW BROWN	
20				
30	BEDROCK			
40				
50				

Soil Classification: **2 A**
Profile: **2** Condition: **A**

Slope: **24%**

Limiting Factor: Ground Water Restrictive Layer Bedrock Pit Depth

Observation Hole **TB** Test Pit Boring
Depth of Organic Horizon Above Mineral Soil

DEPTH BELOW MINERAL SOIL SURFACE (feet)	Texture	Consistency	Color	Mottling
0				
10	TB A = 30" TO BEDROCK			
20	TB B = 24" TO BEDROCK			
30	TB C = 27" TO BEDROCK			
40	TB D = 24" TO BEDROCK			
50				

Soil Classification: **2 A**
Profile: **2** Condition: **A**

Slope: **24%**

Limiting Factor: Ground Water Restrictive Layer Bedrock Pit Depth

Albert Frick
Site Evaluator Signature

63
SE

8/30/2004
Date

SUBSURFACE WASTEWATER DISPOSAL SYSTEM APPLICATION

Maine Department of Human Services
Division of Health Engineering, Station 10, SMS
(207) 287-5672 FAX (207) 287-4172

Town, City, Plantation PORTLAND; PEAKS ISLAND	Street, Road, Subdivision 397 ISLAND AVENUE	Owner's Name N/F WAGGNER (FOR JENNIFER WEISER)
---	---	--

SUBSURFACE WASTEWATER DISPOSAL PLAN

SCALE 1" = 20' FT.

1000 GALLON CONCRETE -
SEPTIC TANK LOCATE
WHERE FEASIBLE, 8' MIN
FROM BUILDING STRUCTURE

NOTE: RAISE PLUMBING AND SET NEW SEPTIC TANK
AT HIGH ENOUGH ELEVATION TO ASSURE GRAVITY
FLOW OR PROVIDE PUMP STATION

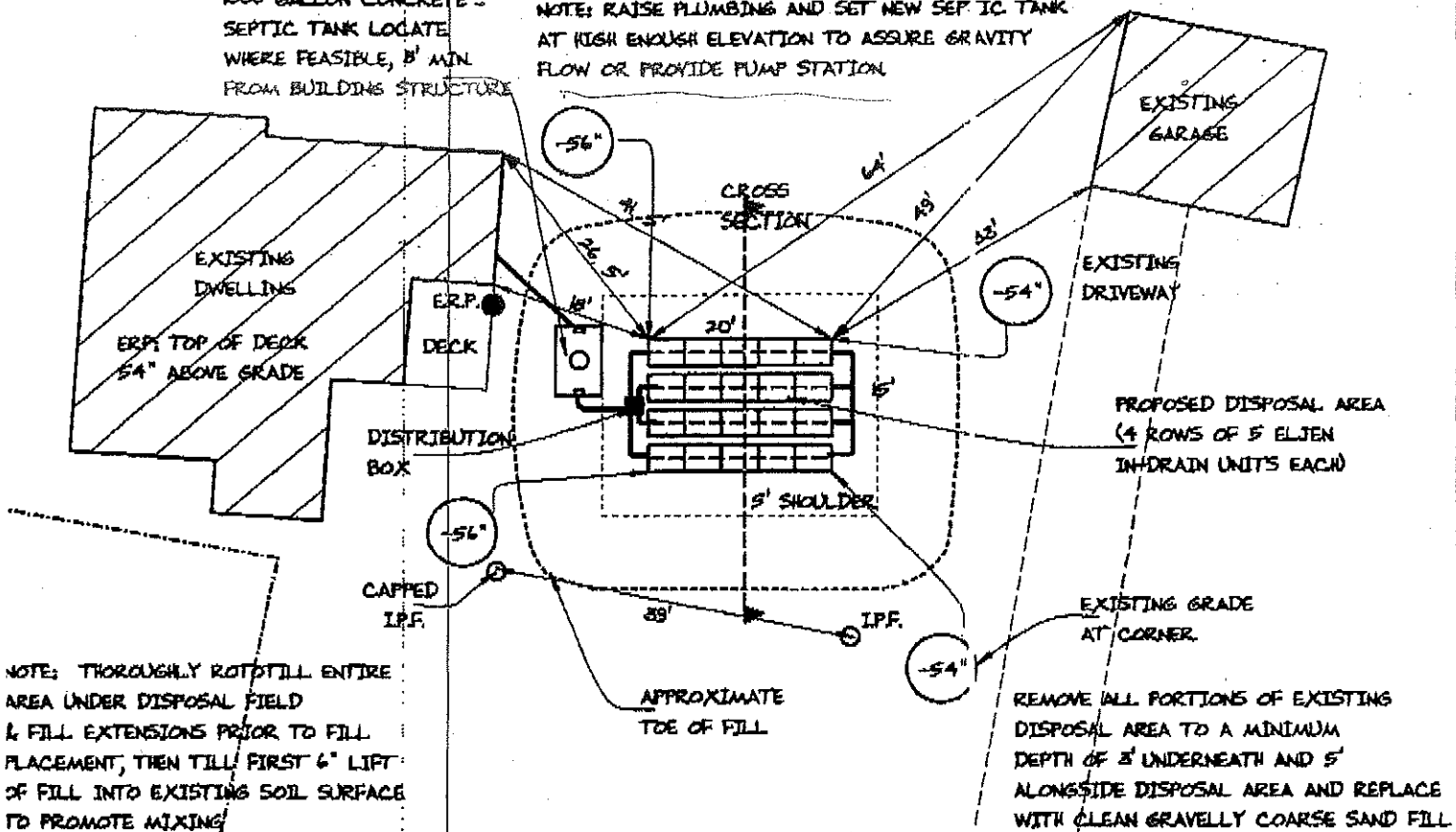

NOTE: THOROUGHLY ROTOTILL ENTIRE
AREA UNDER DISPOSAL FIELD
& FILL EXTENSIONS PRIOR TO FILL
PLACEMENT, THEN TILL FIRST 6" LIFT
OF FILL INTO EXISTING SOIL SURFACE
TO PROMOTE MIXING

REMOVE ALL PORTIONS OF EXISTING
DISPOSAL AREA TO A MINIMUM
DEPTH OF 3' UNDERNEATH AND 5'
ALONGSIDE DISPOSAL AREA AND REPLACE
WITH CLEAN GRAVELLY COARSE SAND FILL

FILL REQUIREMENTS	CONSTRUCTION ELEVATIONS	ELEVATION REFERENCE POINT
Depth of Fill (Upslope) : 23" - 25" Finished Grade Elevation	SEE DETAIL BELOW	Location & Description TOP OF DECK
Depth of Fill (Downslope) : 23" - 25" Top of Distribution Pipe or Proprietary Device		54" ABOVE GRADE
DEPTH AT CROSS-SECTION (shown below)		Reference Elevation is: 0.0" or -----

DISPOSAL AREA CROSS SECTION

SCALE:
VERTICAL: 1" = 5 FT
HORIZONTAL: 1" = 10 FT

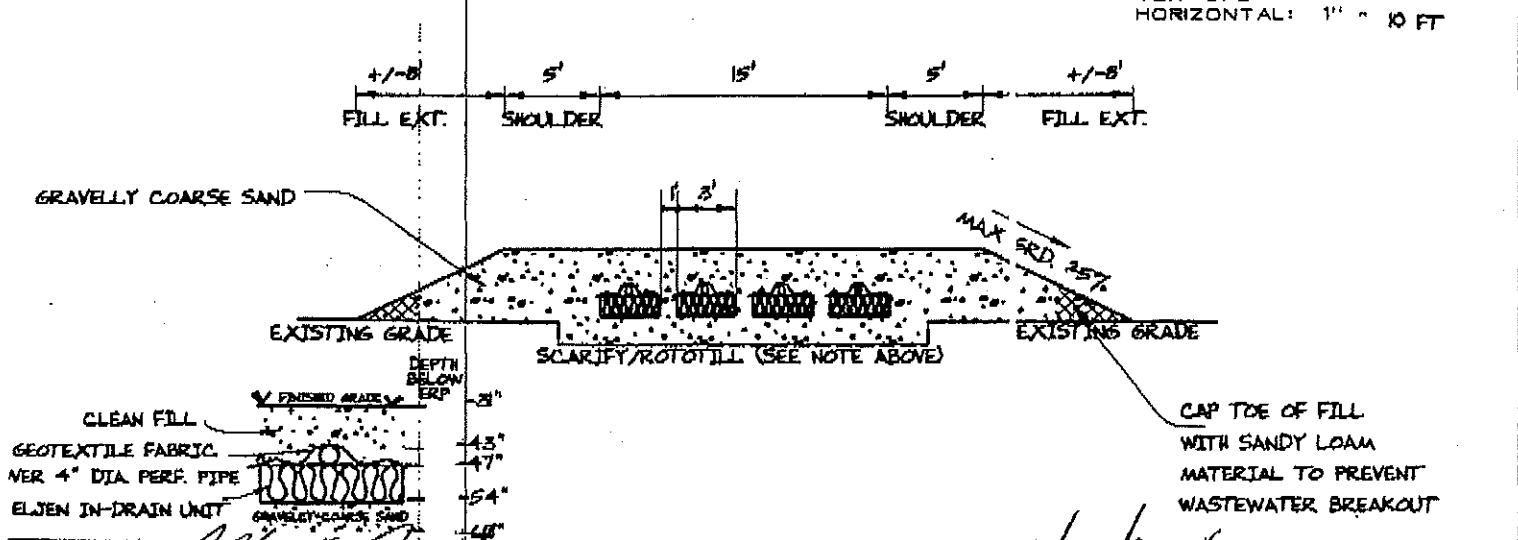

CAP TOE OF FILL
WITH SANDY LOAM
MATERIAL TO PREVENT
WASTEWATER BREAKOUT

Albert Frick
Site Evaluator Signature

163
SE

2/30/2004
Date



Albert Frick Associates, Inc.

Soil Scientists & Site Evaluators

95A County Road Gorham, Maine 04038

(207) 839-5563

PORTLAND; PEAKS ISLAND 397 ISLAND AVENUE N/F WAGBNER (FOR JENNIFER WEISER)

TOWN	LOCATION	APPLICANT'S NAME
------	----------	------------------

1) The Plumbing and Subsurface Wastewater Disposal Rules adopted by the State of Maine, Department of Human Services pursuant to 22 M.R.S.A. § 42 (the "Rules") are incorporated herein by reference and made a part of this application and shall be consulted by the owner/applicant, the system installer and/or building contractor for further construction details and material specifications. The system installer should contact Albert Frick Associates, Inc. 839-5563, if there are any questions concerning materials, procedures or designs. The system installer and/or building contractor installing the system shall be solely responsible for compliance with the Rules and with all state and municipal laws and ordinances pertaining to the permitting, inspection and construction of subsurface wastewater disposal systems.

2) This application is intended to represent facts pertinent to the Rules only. It shall be the responsibility of the owner/applicant, system installer and/or building contractor to determine compliance with and to obtain permits under all applicable local, state and/or federal laws and regulations (including, without limitation, Natural Resources Protection Act, wetland regulations, zoning ordinances, subdivision regulations, Site Location of Development Act and minimum lot size laws) before installing this system or considering the property on which the system is to be installed a "buildable" lot. It is recommended that a wetland scientist be consulted regarding wetland regulations.

Prior to the commencement of construction/installation, the local plumbing inspector shall inform the owner/applicant and Albert Frick Associates, Inc of any local ordinances which are more restrictive than the Rules in order that the design may be amended. All designs are subject to review by local, state and/or federal authorities. Albert Frick Associates, Inc.'s liability shall be limited to revisions required by regulatory agencies pursuant to laws or regulations in effect at the time of preparation of this application.

3) All information shown on this application relating to property lines, well locations, subsurface structures and underground facilities (such as utility lines, drains, septic systems, water lines, etc.) are based solely upon information provided by the owner/applicant and has been relied upon by Albert Frick Associates, Inc. in preparing this application. The owner/applicant shall review this application prior to the start of construction and confirm this information.

4) Installation of a garbage (grinder) disposal is not recommended. If one is installed, an additional 1000 gallon septic tank or a septic tank filter should be connected in series to the proposed septic tank.

5) The system user shall avoid introducing kitchen grease or fats into this system. Chemicals such as septic tank cleaners and/or chlorine (such as from water treatment) and controlled or hazardous substances shall not be disposed of in this system.

ATTACHMENT TO SUBSURFACE WASTEWATER DISPOSAL APPLICATION

PORTLAND; PEAKS ISLAND

397 ISLAND AVENUE

N/F WAGNER (FOR JENNIFER WEISER)

TOWN

LOCATION

APPLICANT'S NAME

6) The septic tank should be pumped within two years of installation and subsequently as recommended by the pump service, but in no event should the septic tank be pumped less often than every three years.

7) The actual water flow or number of bedrooms shall not exceed the design criteria indicated on this application without a re-evaluation of the system as proposed. If the system is supplied by public water or a private service with a water meter, the water consumption per period should be divided by the number of days to calculate the average daily water consumption (water usage (cu. ft.) x 7.48 cu. ft. (gallons per cu. ft.) divided by the # of days in period).

8) The general minimum setbacks between a well and septic system serving a single family residence is 100-300 feet, unless the local municipality has a more stringent requirement. A well installed by an abutter within the minimum setback distances prior to the issuance of a permit for the proposed disposal system may void this design.

9) When a gravity system is proposed: BEFORE CONSTRUCTION/INSTALLATION BEGINS, the system installer or building contractor shall review the elevations of all points given in this application and the elevation of the existing and/or proposed building drain and septic tank inverts for compatibility to minimum slope requirement. In gravity systems, the invert of the septic tank(s) outlet(s) shall be at least 4 inches above the invert of the distribution box outlet at the disposal area. When an effluent pump is required, provisions shall be made to make certain that surface ground water does not enter the septic tank or pump station. An alarm device warning of a pump failure shall be installed. Also, when pumping is required of a chamber system, install a "T" connection in the distribution box and place 3 inches of stone or a splash plate in the first chamber. Insulate gravity pipes, pump lines and the distribution box as necessary to prevent freezing.

10) On all systems, remove the vegetation, organic duff and old fill material from under the disposal area and any fill extension. On sites where the proposed system is to be installed in natural soil, scarify the bottom and sides of the excavated disposal area with a rake. Do not use wheeled equipment on the scarified soil surface. For systems installed in fill, scarify the native soil by roto-tilling to a depth of at least 8 inches over the entire disposal and fill extension area to prevent glazing and to promote fill bonding. Place fill in loose layers no deeper than 8 inches and compact thoroughly before placing more fill (this ensures that voids and loose pockets are eliminated to minimize the chance of leakage). Do not use wheeled equipment on the scarified soil area until after 12 inches of fill is in place. Keep equipment off the chambers. Divert the surface water away from the disposal area by ditching or shallow swales.

11) Unless noted otherwise, fill shall be gravelly coarse sand which contains no more than 5% fines (silt and clay).

12) Do not install systems on loamy, silty, or clayey soils during wet periods since soil smearing/glazing may seal off the soil interface.

13) Seed all filled and disturbed surfaces with perennial grass seed, then mulch with hay or equivalent



Albert Frick Associates, Inc.
Soil Scientists & Site Evaluators

95A County Road Gorham, Maine 04038
(207) 839-5563

Fill Estimation Worksheet

Albert Frick Associates Inc.
 95A County Road
 Gorham, Me 04038
 839-5563 FAX - 839-5564
 E-Mail - Albertfrick@worldnet.att.net

Town: Portland (Peaks Isl.)
 Project owner/applicant: Jennifer Weiser
 Address: 397 Island Ave.
Portland (Peaks Isl.)

9
 10750
 5260
 15950

This worksheet is being provided as a complimentary tool to assist in estimating the approximate amount of fill required to construct the proposed system. This worksheet does not substitute for a personal visit to the site for you own estimate. These calculations are intended to serve as a check to your work. Site features beyond the model (terrain) can vary to effect model projections.

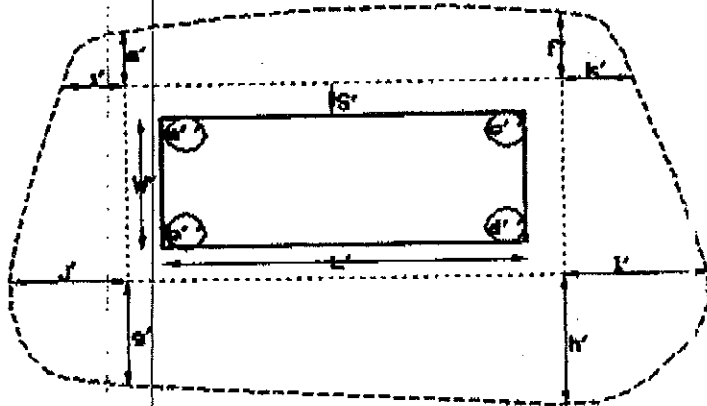

10750

Length (L)	<u>20 feet</u>
Width (W)	<u>15 feet</u>
Shoulder (S)	<u>5 feet</u>
<u>Depth of fill:</u>	
upper left (a)	<u>25 inches</u>
upper right (b)	<u>23 inches</u>
lower left (c)	<u>25 inches</u>
lower right (d)	<u>23 inches</u>
<u>Fill Extension:</u>	
left up (e)	<u>8 feet</u>
right up (f)	<u>8 feet</u>
left down (g)	<u>8 feet</u>
right down (h)	<u>8 feet</u>
upper left (i)	<u>8 feet</u>
lower left (j)	<u>8 feet</u>
upper right (k)	<u>8 feet</u>
lower right (l)	<u>8 feet</u>
Cost of fill per yard= \$	

Body	56 cubic yards
Fill Down	9 cubic yards
Fill Up	9 cubic yards
Fill left	8 cubic yards
Fill right	8 cubic yards
Fill uplef	2 cubic yards
Fill uprigt	2 cubic yards
Fill downleft	2 cubic yards
Fill downright	2 cubic yards

SubTotal= 98 cubic yards

Shrinkage % = 15 %

Total Backfill 112.7 cubic yards

Adjusted cost of Total Backfill = \$ -