

PLANTING SCHEDULE

SYMBOL	QUAN.	SIZE	BOTANICAL NAME	COMMON NAME
RV02	6	3 GAL.	ROSA VIRGINIANA	VIRGINIA ROSE

**WALSH**  
ENGINEERING ASSOCIATES, INC.  
One Karen Dr., Suite 2A | Westbrook, Maine 04092  
ph: 207.553.9868 | www.walsh-eng.com  
Copyright © 2015

STATE OF MAINE  
SILAS W. CANAVAN  
No. 12638  
LICENSED PROFESSIONAL ENGINEER  
10/15

ATLANTIC OCEAN  
CASCO BAY  
DIAMOND PASS

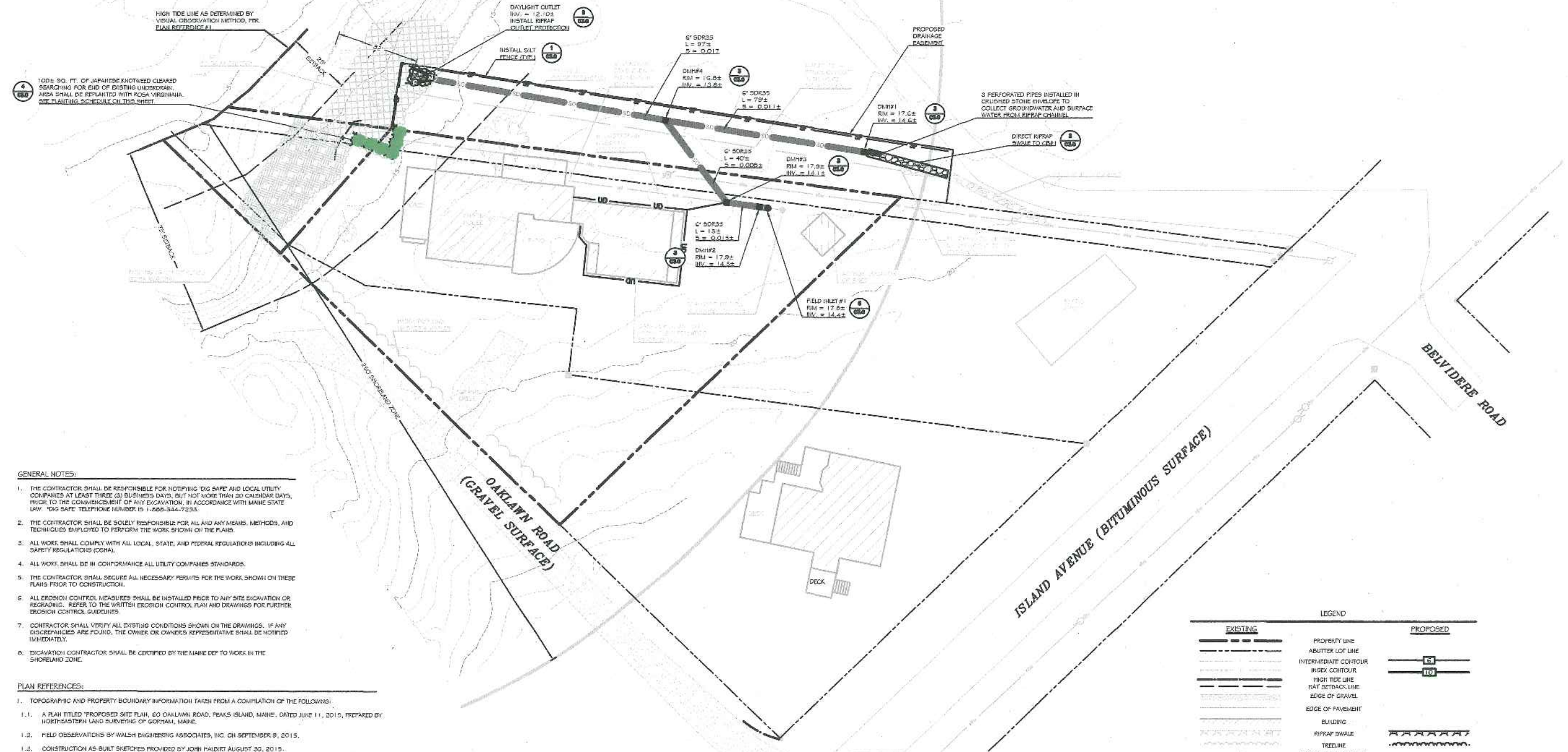

100± SQ. FT. OF JAPANESE KNOTWOOD CLEARED SEARCHING FOR EID OF EXISTING UNDERDRAINAGE SHALL BE REPLANTED WITH ROSA VIRGINIANA. SEE PLANTING SCHEDULE ON THIS SHEET.

HIGH TIDE LINE AS DETERMINED BY VISUAL OBSERVATION METHOD, PER PLAN REFERENCE #1.

DAYLIGHT OUTLET  
INV. = 12.0±  
INSTALL RIPRAP  
OUTLET PROTECTION

G' 50R35  
L = 97±  
S = 0.017

DM#4  
RIM = 11.0±  
INV. = 13.2±

G' 50R35  
L = 78±  
S = 0.011±

PROPOSED DRAINAGE PAVEMENT

DM#1  
RIM = 17.0±  
INV. = 14.6±

3 PERFORATED PIPES INSTALLED IN CRUSHED STONE ENVELOPE TO COLLECT GROUNDWATER AND SURFACE WATER FROM RIPRAP CHANNEL.

DIRECT RIPRAP  
SHALE TO GRAV

G' 50R35  
L = 40±  
S = 0.002±

DM#3  
RIM = 17.0±  
INV. = 14.1±

G' 50R35  
L = 13±  
S = 0.015±

DM#2  
RIM = 17.9±  
INV. = 14.5±

FIELD INLET #1  
RIM = 17.8±  
INV. = 14.4±

GENERAL NOTES:

1. THE CONTRACTOR SHALL BE RESPONSIBLE FOR NOTIFYING "DIG SAFE" AND LOCAL UTILITY COMPANIES AT LEAST THREE (3) BUSINESS DAYS, BUT NOT MORE THAN 30 CALENDAR DAYS, PRIOR TO THE COMMENCEMENT OF ANY EXCAVATION, IN ACCORDANCE WITH MAINE STATE LAW "DIG SAFE" TELEPHONE NUMBER IS 1-800-344-7233.
2. THE CONTRACTOR SHALL BE SOLELY RESPONSIBLE FOR ALL AND ANY MEANS, METHODS, AND TECHNIQUES EMPLOYED TO PERFORM THE WORK SHOWN ON THE PLANS.
3. ALL WORK SHALL COMPLY WITH ALL LOCAL, STATE, AND FEDERAL REGULATIONS INCLUDING ALL SAFETY REGULATIONS (OSHA).
4. ALL WORK SHALL BE IN COMPLIANCE ALL UTILITY COMPANIES STANDARDS.
5. THE CONTRACTOR SHALL SECURE ALL NECESSARY PERMITS FOR THE WORK SHOWN ON THESE PLANS PRIOR TO CONSTRUCTION.
6. ALL EROSION CONTROL MEASURES SHALL BE INSTALLED PRIOR TO ANY SITE EXCAVATION OR REGRADING. REFER TO THE WRITTEN EROSION CONTROL PLAN AND DRAWINGS FOR FURTHER EROSION CONTROL GUIDELINES.
7. CONTRACTOR SHALL VERIFY ALL EXISTING CONDITIONS SHOWN ON THE DRAWINGS. IF ANY DISCREPANCIES ARE FOUND, THE OWNER OR OWNER'S REPRESENTATIVE SHALL BE NOTIFIED IMMEDIATELY.
8. EXCAVATION CONTRACTOR SHALL BE CERTIFIED BY THE MAINE DEP TO WORK IN THE SHORELAND ZONE.

PLAN REFERENCES:

1. TOPOGRAPHIC AND PROPERTY BOUNDARY INFORMATION TAKEN FROM A COMPILATION OF THE FOLLOWING:
  - 1.1. A PLAN TITLED "PROPOSED SITE PLAN, 60 OAKLAWN ROAD, PEAKS ISLAND, MAINE, DATED JUNE 11, 2015, PREPARED BY NORTHEASTERN LAND SURVEYING OF GORHAM, MAINE.
  - 1.2. FIELD OBSERVATIONS BY WALSH ENGINEERING ASSOCIATES, INC. ON SEPTEMBER 9, 2015.
  - 1.3. CONSTRUCTION AS BUILT SKETCHES PROVIDED BY JOHN HALBERT AUGUST 30, 2015.
2. CONTOUR INFORMATION SHOWN IS BASED ON LIDAR SURVEY DATA OBTAINED FROM THE MAINE OFFICE OF GIS. ELEVATIONS ARE BASED ON NGVD83 DATUM.

DRAINAGE NOTES:

1. PIPE AND DRAINAGE STRUCTURE SIZES AND MATERIALS AND OVERALL DESIGN CONCEPT WERE PROVIDED BY THE OWNER AFTER INSTALLATION. WEA HAS NOT PERFORMED ANY HYDROLOGIC OR HYDRAULIC CALCULATIONS.
2. VISUAL OBSERVATIONS DURING A 5.0" RAIN STORM EVENT ON SEPTEMBER 30, 2015 INDICATED THAT THE PROPOSED DRAINAGE SYSTEM IS FUNCTIONING PROPERLY.

LEGEND

EXISTING	PROPOSED
PROPERTY LINE	PROPERTY LINE
ABUTTER LOT LINE	ABUTTER LOT LINE
INTERMEDIATE CONTOUR	INDEX CONTOUR
INDEX CONTOUR	HIGH TIDE LINE
HIGH TIDE LINE	HAT SETBACK LINE
HAT SETBACK LINE	EDGE OF GRAVEL
EDGE OF GRAVEL	EDGE OF PAVEMENT
EDGE OF PAVEMENT	BUILDING
BUILDING	RIPRAP SHALE
RIPRAP SHALE	TREELINE
TREELINE	OVERHEAD UTILITY LINE
OVERHEAD UTILITY LINE	STORMDRAIN LINE
STORMDRAIN LINE	UNDERDRAIN LINE
UNDERDRAIN LINE	FIELD INLET
FIELD INLET	DRAINAGE MANHOLE
DRAINAGE MANHOLE	UTILITY POLE
UTILITY POLE	TREE
TREE	SHRUB
SHRUB	

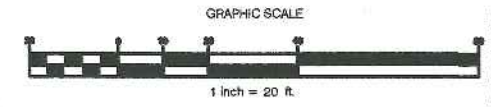

ISSUED FOR PERMITTING - NOT FOR CONSTRUCTION

Drainage Improvements  
60 OAKLAWN ROAD  
PEAKS ISLAND, ME

JOHN P. HALBERT  
584 SAWDUST ROAD, BOX 687  
THE WOODLANDS, TEXAS

Rev.	Date	Description	Drawn	Check
1	10/19/2015	ISSUED FOR PERMITTING - NOT FOR CONSTRUCTION	SWC	NGC

Sheet Title:  
**Site Layout and Grading Plan**

Job No.: 311      Sheet No.:  
Date: Oct. 19, 2015  
Scale: 1" = 20'  
Drawn: SWC  
Checked: NGC

**C2.0**