

GENERAL NOTES:

- 1. THE CONTRACTOR SHALL BE RESPONSIBLE FOR NOTIFYING 'DIG SAFE' AND LOCAL UTILITY COMPANIES AT LEAST THREE (3) BUSINESS DAYS, BUT NOT MORE THAN 30 CALENDAR DAYS, PRIOR TO THE COMMENCEMENT OF ANY EXCAVATION, IN ACCORDANCE WITH MAINE STATE LAW. 'DIG SAFE' TELEPHONE NUMBER IS 1-888-344-7233.
2. THE CONTRACTOR SHALL BE SOLELY RESPONSIBLE FOR ALL AND ANY MEANS, METHODS, AND TECHNIQUES EMPLOYED TO PERFORM THE WORK SHOWN ON THE PLANS.
3. ALL WORK SHALL COMPLY WITH ALL LOCAL, STATE, AND FEDERAL REGULATIONS INCLUDING ALL SAFETY REGULATIONS (OSHA).
4. THE CONTRACTOR SHALL SECURE ALL NECESSARY PERMITS FOR THE WORK SHOWN ON THESE PLANS PRIOR TO CONSTRUCTION.
5. ALL EXISTING TREES SHOWN ON THIS PLAN SHALL REMAIN IN PLACE. TREE TRUNKS AND ROOT SYSTEMS SHALL BE PROTECTED DURING CONSTRUCTION.
6. ALL EROSION CONTROL MEASURES SHALL BE INSTALLED PRIOR TO ANY SITE EXCAVATION OR REGRADING.
7. CONTRACTOR SHALL VERIFY ALL EXISTING CONDITIONS SHOWN ON THE DRAWINGS. IF ANY DISCREPANCIES ARE FOUND, THE OWNER OR OWNER'S REPRESENTATIVE SHALL BE NOTIFIED IMMEDIATELY.

PLAN REFERENCES:

- 1. TOPOGRAPHIC AND PROPERTY BOUNDARY INFORMATION TAKEN FROM A COMPILATION OF THE FOLLOWING:
1.1. SURVEY INFORMATION PROVIDED BY NORTHEASTERN LAND SURVEYING OF GORHAM, MAINE ON AUGUST 12, 2013.
1.2. PROPERTY LINE INFORMATION ON THIS PLAN WAS DIGITIZED FROM THE BOUNDARY SURVEY REFERENCED ABOVE.
1.3. PUBLICLY AVAILABLE LIDAR SURVEY DATA.
1.4. FIELD OBSERVATIONS BY WALSH ENGINEERING ASSOCIATES, INC.
2. BEACH TOPOGRAPHY SUBJECT TO CHANGE BASED ON TIDAL ACTION.
3. ELEVATION ARE BASED ON NAVD83 DATUM.
4. COORDINATES SHOWN ARE BASED ON NAD83 MAINE STATE PLANE (WEST), COORDINATE SYSTEM AS REFERENCED FROM A SURVEY PLAN TITLED 'PLAN DEPICTING THE RESULTS OF A BOUNDARY SURVEY MADE FOR WALTER HORNADAY, 39 OAKLAWN ROAD, PORTLAND, MAINE, DATED OCTOBER 7, 2009, PREPARED BY JAMES D. NADEAU, LLC OF PORTLAND MAINE.'

LAYOUT AND MATERIALS NOTES:

- 1. ALL DIMENSIONS, LOCATIONS AND CONTROLS SHALL BE VERIFIED IN THE FIELD BY THE CONTRACTOR PRIOR TO ANY CONSTRUCTION ACTIVITIES. ANY DISCREPANCIES SHALL BE REPORTED IMMEDIATELY TO THE OWNER OR OWNER'S REPRESENTATIVE.
2. IF SEDIMENT IS TRACKED ONTO OAKLAWN ROAD IT SHALL BE CLEANED UP AT THE END OF EACH WORKING DAY.
3. PROVIDE A SMOOTH TRANSITION WHERE NEW WORK MEETS EXISTING.
4. ALL DISTURBED AREAS NOT OTHERWISE TREATED WITHIN EXISTING LAWN AREA SHALL BE LOAMED, SEEDED, AN MULCHED WITH 'ESTATE GREEN MIX' AS DISTRIBUTED BY ALLEN, STERLING, AND LATHROP OF FALMOUTH, MAINE.
5. ALL DISTURBED AREAS NOT OTHERWISE TREATED BEYOND EDGE OF EXISTING LAWN AREA SHALL BE LOAMED AND SEEDED WITH MDOT 'ROADSIDE MIXTURE NUMBER 3' (MDOT G 18.01G). EROSION CONTROL BLANKET SHALL BE INSTALLED ON ALL SLOPES EQUAL TO OR GREATER THAN 10%.

PLANTING SCHEDULE

Table with 5 columns: SYMBOL, QUAN., SIZE, BOTANICAL NAME, COMMON NAME. Rows include M.PEN #19 #3 MYRICA PENNSYLVANICA BAYBEERY and C.PER #9 #3 COMPTONIA PEREGRINA SWEET FERN.

* EXISTING SWEET FERNS SHALL BE TRANSPLANTED, PROTECTED, AND REPLANTED.

PARCEL INFORMATION:

OWNER OF RECORD: STANLEY G. & MARSHA A. REICH, 5 SUNSET LANE, RIDGEBFIELD, CT 06877.
PARCEL AREA: 0.18 ACRES (TO H.A.T. LINE)
SITE ADDRESS: 29 OAKLAWN ROAD, PEAKS ISLAND, PORTLAND, MAINE
TAX MAP INFORMATION: MAP 90, BLOCK H, LOT 2
CURRENT ZONES: IR-2 (ISLAND RESIDENTIAL 2) SHORELAND OVERLAY ZONE

SPACE AND BULK STANDARDS:

Table with 4 columns: STREET FRONTAGE, MIN. REQUIRED, EXISTING, PROPOSED. Rows include FRONT YARD, SIDE YARD, REAR YARD, LOT AREA, LOT WIDTH, STRUCTURE HEIGHT, LOT COVERAGE.

* LOT AREA CALCULATED TO HIGHEST ANNUAL TIDE (HAT) ELEVATION.

LEGEND

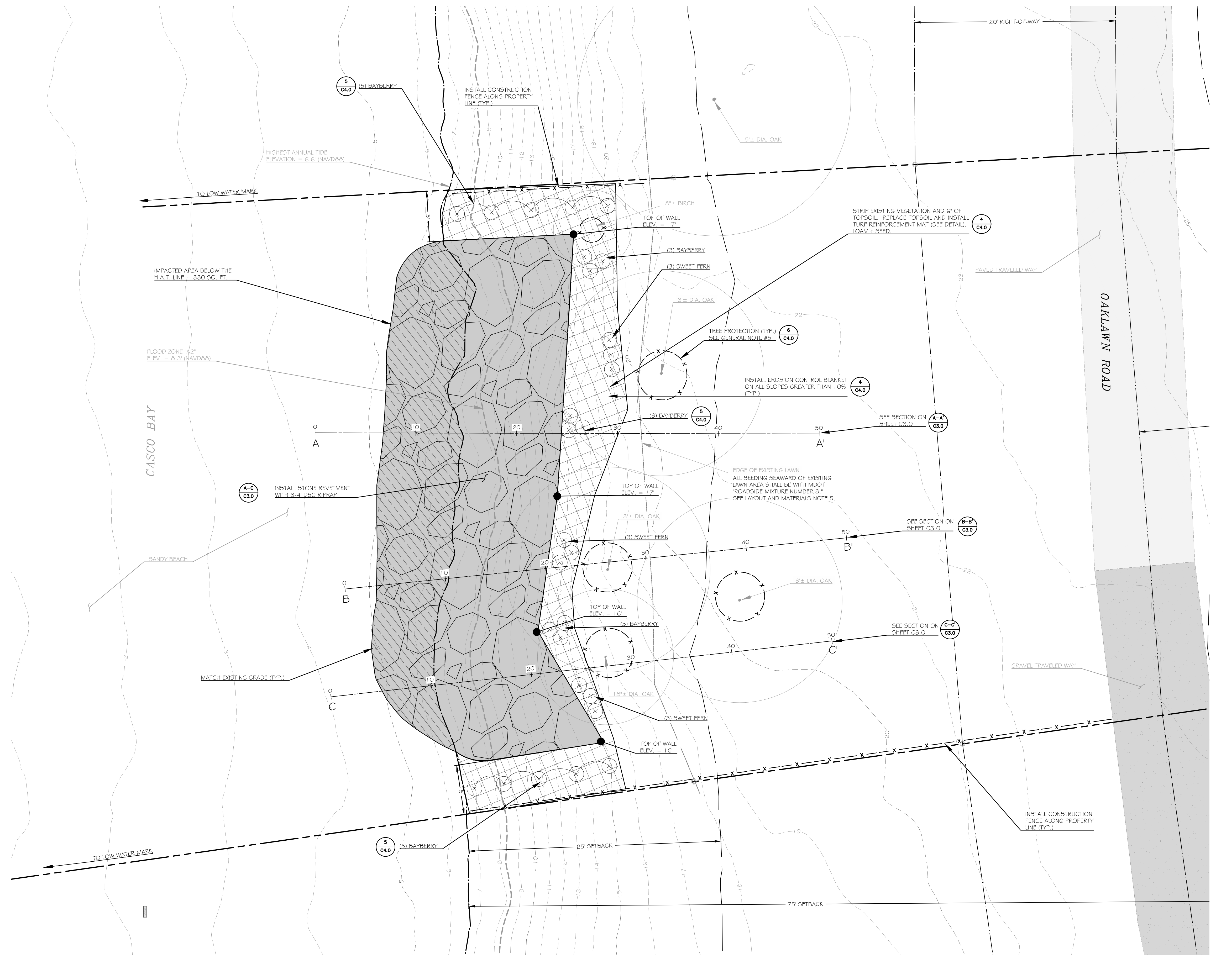
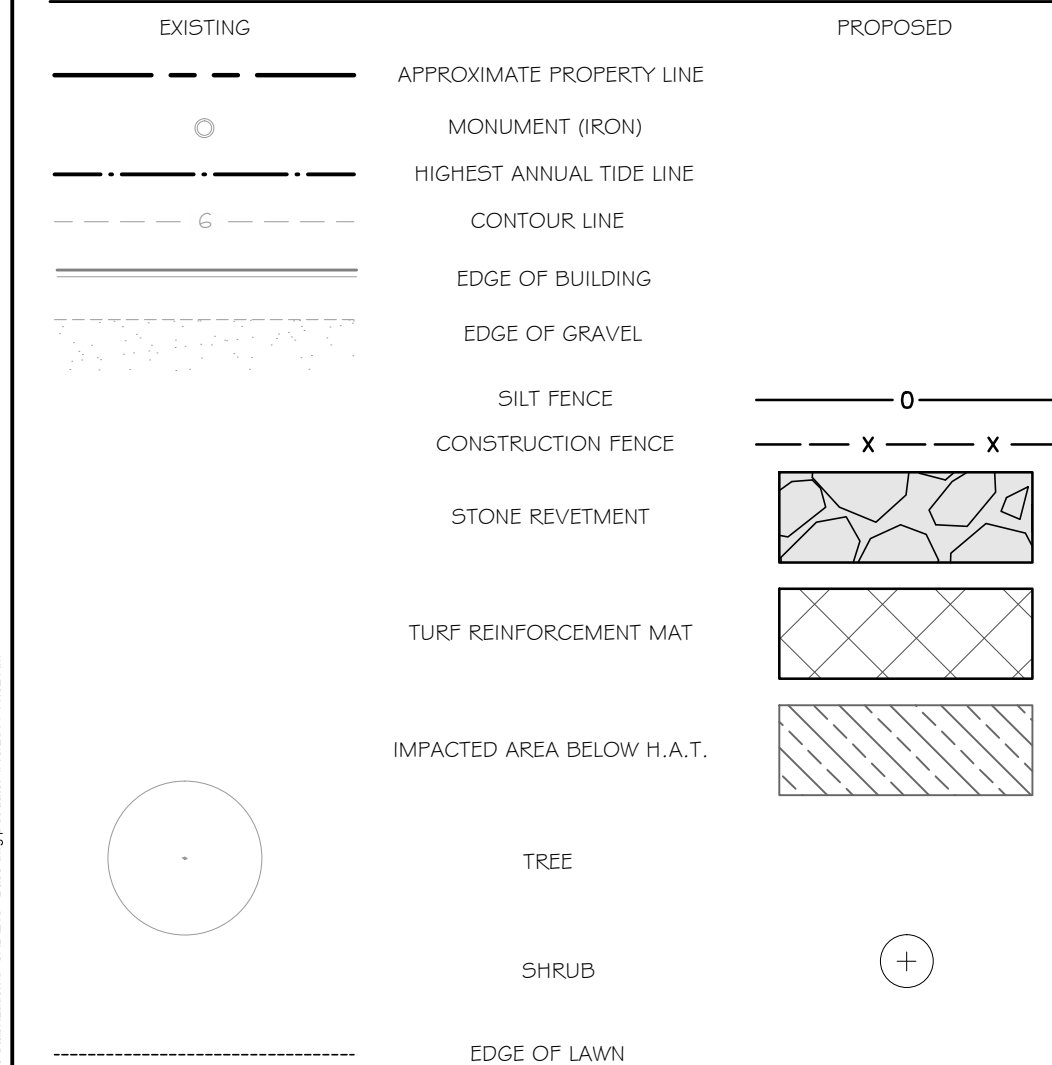

WALSH ENGINEERING ASSOCIATES, INC.
918 Brighton Ave | Portland, Maine 04102
ph: 207.553.9898 | www.walsh-eng.com
Copyright © 2012

STATE OF MAINE
WILLIAM R. WALSH, III
No. 8204
Professional Engineer
3/5/14

REICH RESIDENCE SHORELINE STABILIZATION
29 OAKLAWN ROAD
PEAKS ISLAND, MAINE
PREPARED FOR: STANLEY & MARSHA REICH
5 Sunset Lane
Ridgfield, CT 06877

Revision table with columns: Rev., Date, Description, Drawn, Check. Includes entries for permit applications and plan application.

SITE LAYOUT PLAN

Job No.: 218 Sheet No.:
Date: DEC. 26, 2013
Scale: 1"=5'
Drawn: SWC/WTE
Checked: WRW
C2.0

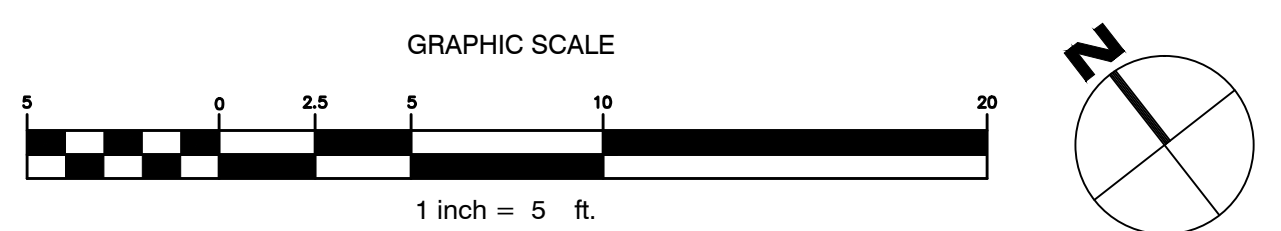

© 2013 Walsh Engineering Associates, Inc. All Rights Reserved. 11/20/13