

# SUBSURFACE WASTEWATER DISPOSAL SYSTEM APPLICATION

Maine Department of Human Services  
 Division of Health Engineering, Station 10 SHS  
 (207) 287-5672 FAX (207) 287-4172

Town, City, Plantation  
**PORTLAND, PEAKS ISLAND**

Street, Road, Subdivision  
**457 ISLAND AVENUE**

Owner's Name  
**KATHIE SMITH**

## SUBSURFACE WASTEWATER DISPOSAL PLAN

SCALE 1" = 20 FT.

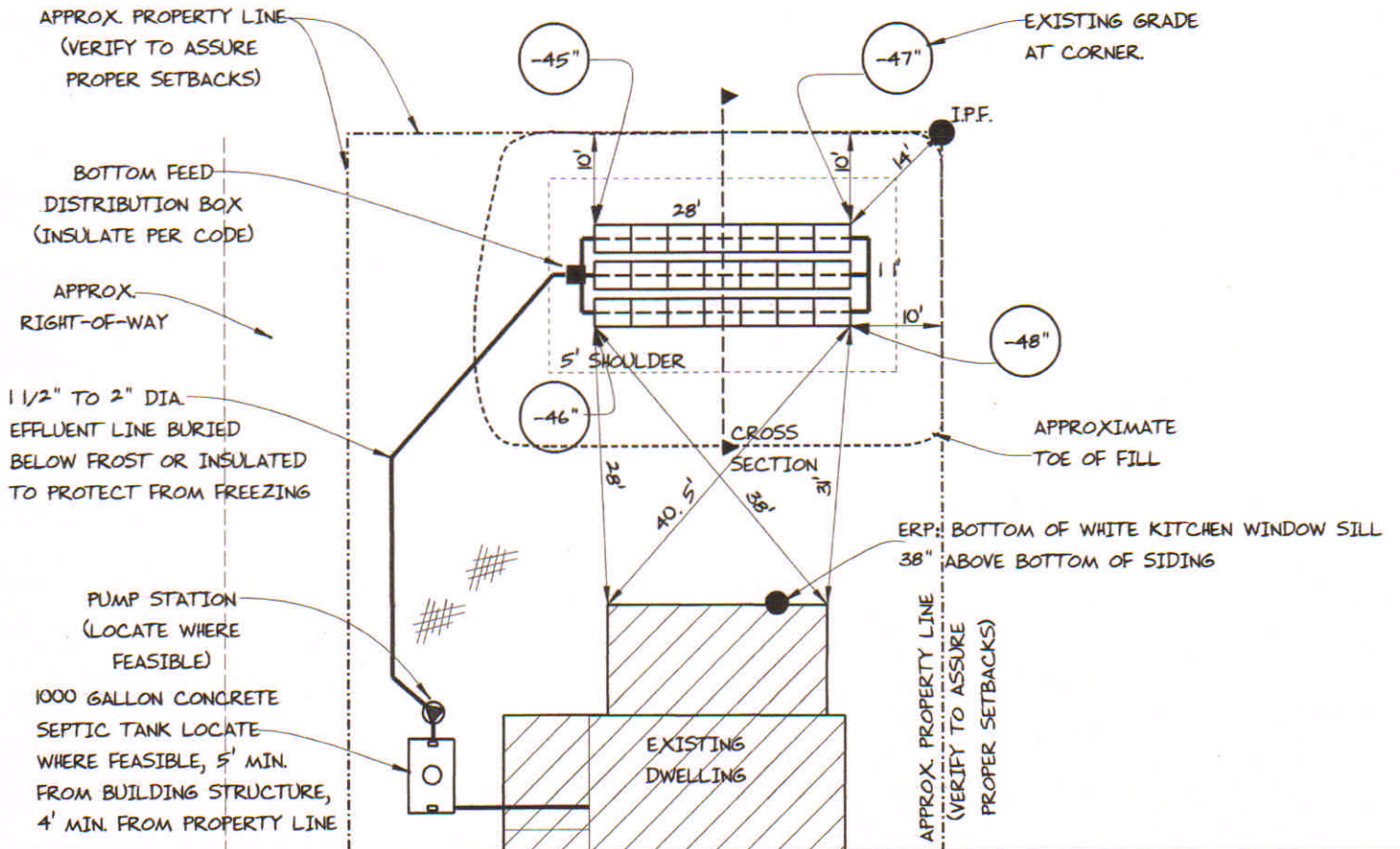

### FILL REQUIREMENTS

Depth of Fill (Upslope) : 15" - 17"  
 Depth of Fill (Downslope) : 16" - 18"  
 DEPTHS AT CROSS-SECTION (shown below)

### CONSTRUCTION ELEVATIONS

Finished Grade Elevation  
 Top of Distribution Pipe or Proprietary Device  
 Bottom of Disposal Area

### ELEVATION REFERENCE POINT

SEE DETAIL BELOW  
 Location & Description BOTTOM OF WHITE KITCHEN WINDOW SILL, 38" ABOVE SIDING  
 Reference Elevation is: 0.0" or -----

SCALE:  
 VERTICAL: 1" = 5 FT  
 HORIZONTAL: 1" = 10 FT

### DISPOSAL AREA CROSS SECTION

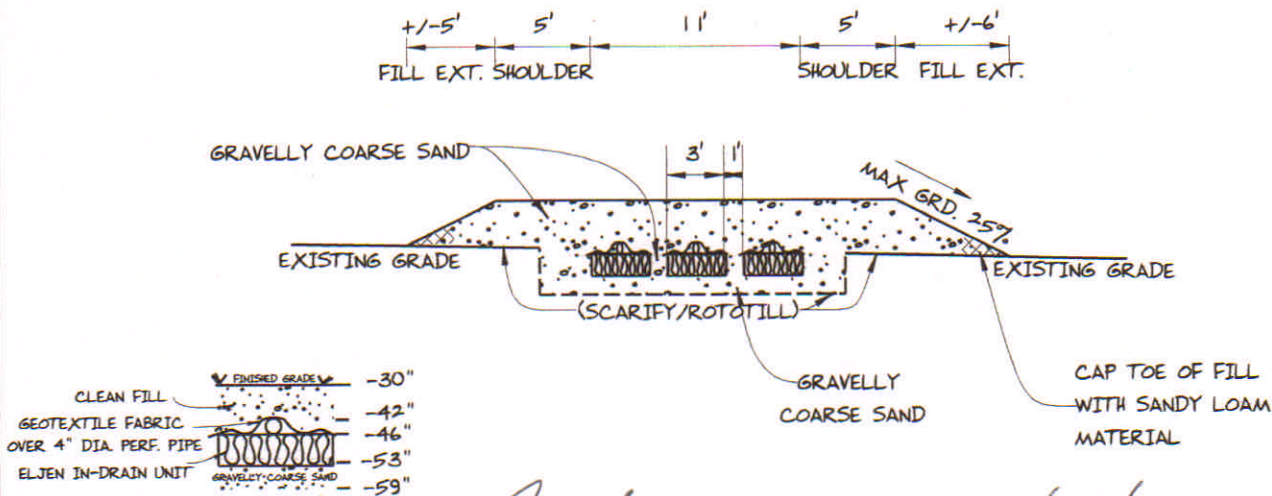

*Albert Frick*  
 Site Evaluator Signature

163  
 SE #

10/26/2011  
 Date