

Rachel Conly
 Architectural Design
 26 Sterling Street
 Peaks Island, Maine 04108
 207.766.5625

Proposed Plans

Branson Residence
 5 Beach Road
 Peaks Island, Me.
 04108

DATE	5.9.14	REVISED	
SCALE	$\frac{1}{4}'' = 1'-0''$	DRAWN BY	Rachel
NOTES			

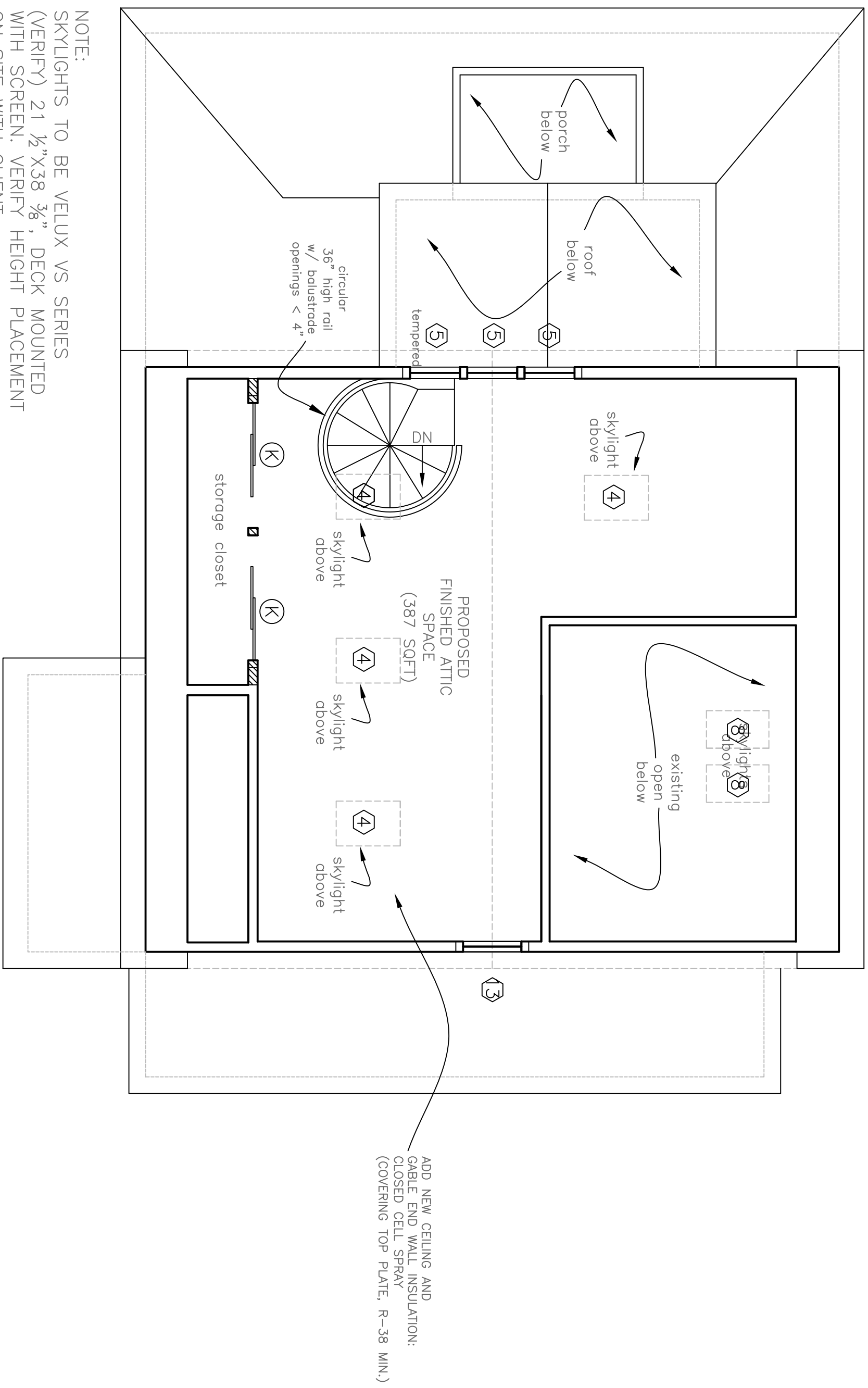

NOTE:
 SKYLIGHTS TO BE VELUX VS SERIES
 (VERIFY) 21 1/2"X38 3/8", DECK MOUNTED
 WITH SCREEN. VERIFY HEIGHT PLACEMENT
 ON SITE WITH CLIENT.

Proposed Third Floor Plan
 $\frac{1}{4}'' = 1'-0''$

