

Rachel Conly
 Architectural Design
 26 Sterling Street
 Peaks Island, Maine 04108
 207.766.5625

**Proposed Third
 Floor Plan**

Branson Residence
 5 Beach Road
 Peaks Island, Me.
 04108

DATE	11.12.13	REVISED	
SCALE	1/4" = 1'-0"	DRAWN BY	Rachel
NOTES			

A11

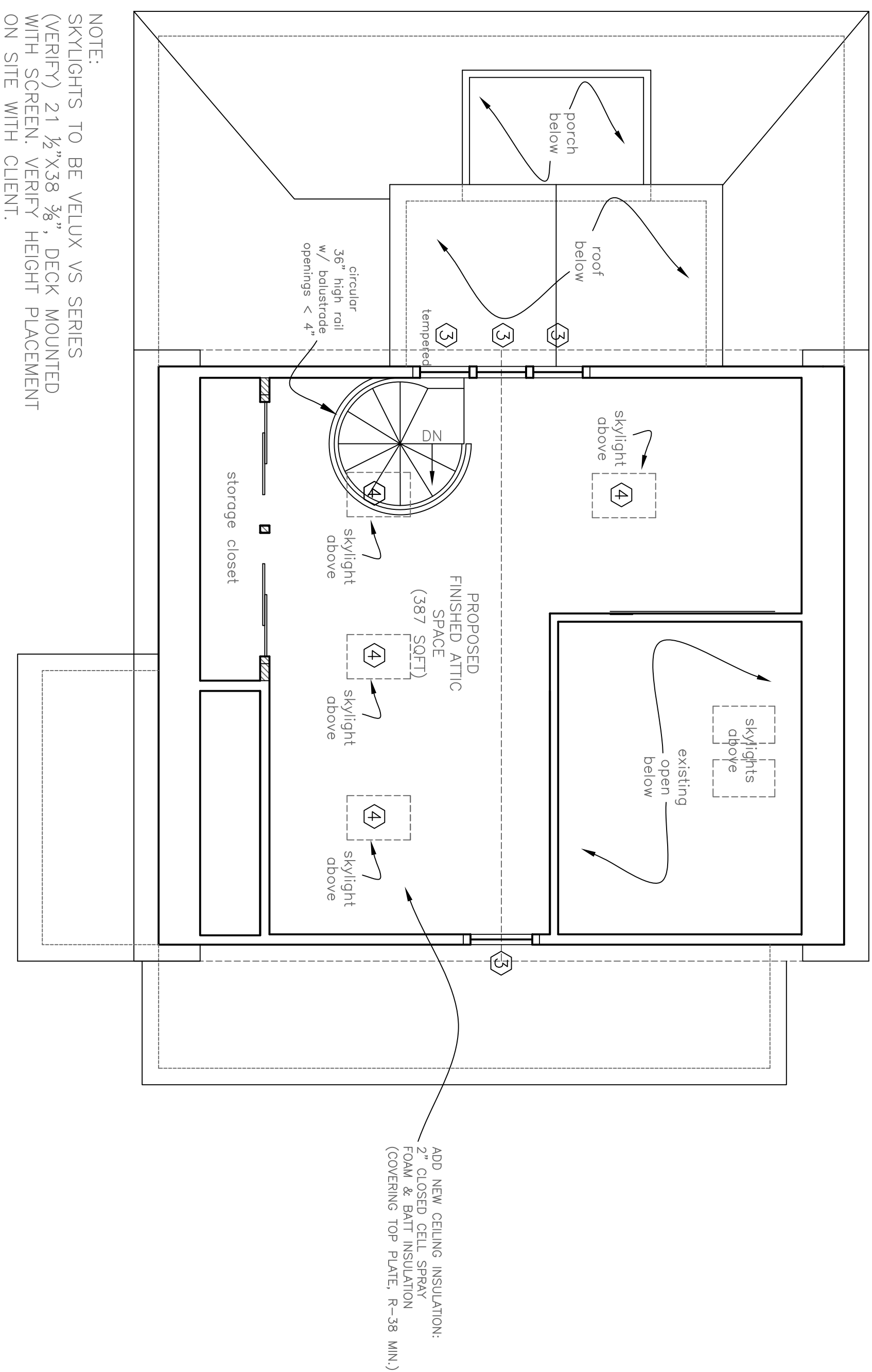

NOTE:
 SKYLIGHTS TO BE VELUX VS SERIES
 (VERIFY) 21 1/2" X 38 3/8", DECK MOUNTED
 WITH SCREEN. VERIFY HEIGHT PLACEMENT
 ON SITE WITH CLIENT.

(A) Proposed Third Floor Plan
 1/4" = 1'-0"



EXISTING WALL
 NEW WALL