

**Rachel Conly**  
Architectural Design

26 Sterling Street  
Peaks Island, Maine 04108  
207.766.5625

**Existing  
Attic Plan**

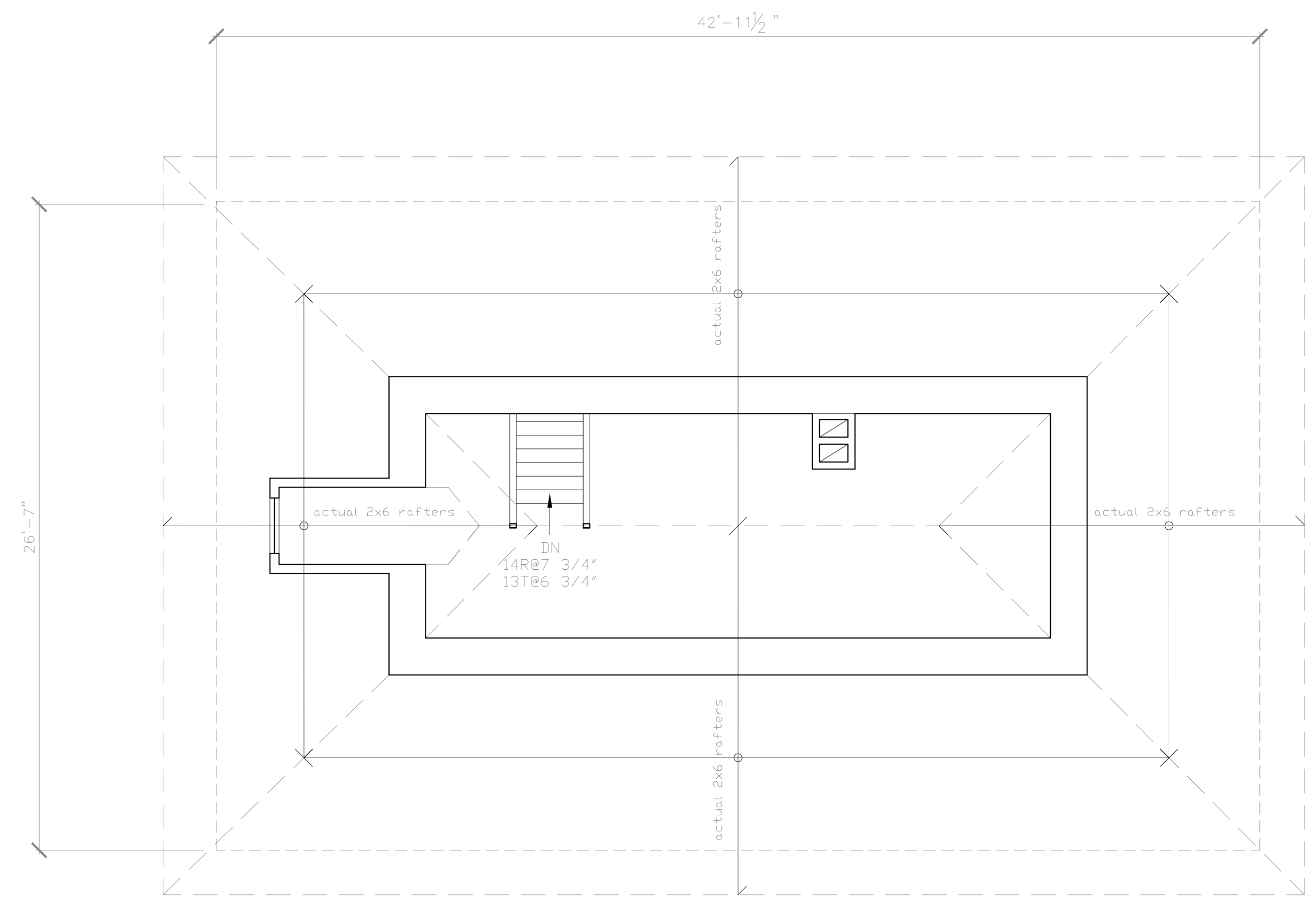

Ⓐ Existing Attic  
1/4" = 1'-0"

PROJECT

**Arnold Residence**  
398 Island Ave.  
Peaks Island, ME

DATE  
06.02.14

REVISED

SCALE  
1/4" = 1'-0"

DRAWN BY  
**Rachel &  
Harvey**

NOTES