

CK BY
ER

ED TO HOUSE AS PER 2009
2 DECKS (R502.2.2 THRU

RESPONSIBLE FOR THE ENGINEERING DESIGN
ALL ONLY. ALL OTHER WALLS AND
G ARE BY NEH. REFER TO DWG. A-19

MAXIMUM APPLIANCE DIMENSIONS
WITHOUT CUT SHEETS

- 30" GAS RANGE
- 46-7/8" H X 27-3/4" D X 29-7/8" W
- 30" ELECTRIC RANGE
- 46-7/8" H X 27-3/4" D X 29-7/8" W
- 21.7 CU. FT. FRIDGE
- 69.75" H X 34.75" D X 36" W
- DISH WASHER
- 23 7/8" W X 24 1/2" D X 34 1/2" TALL
- CLOTHES WASHER
- 27" W X 32 9/16" D X 38" TALL
- CLOTHES DRYER
- 27" W X 32 9/16" D X 38" TALL
- WALL OVEN SINGLE
- 30" W X 26 7/16" D X 28 3/4" T
- WALL OVEN DOUBLE
- 30" W X 26 7/16" D 51 1/2" T
- COOK TOP
- 30 13/16" W X 21 3/4" D X 3 3/4" T

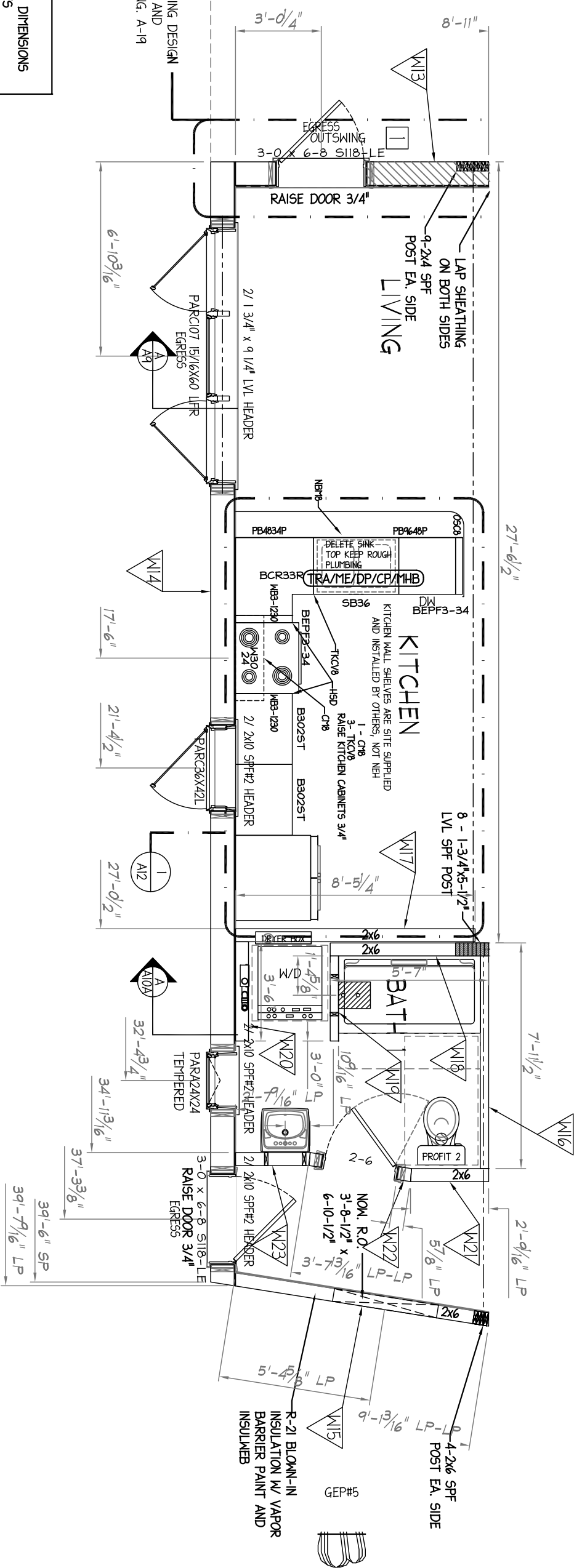

DOUBLE SIDES 7/16" STRUCTURAL SHEATHING
0.148"x2" NAILS UNLESS NOTED OTHERWISE
* FIELD FASTENING 12" O.C. TYPICAL

3" O.C. STAGGER W/ DOUBLE EDGE FRAMING

FORCE REQUIRED = 11273 LB

FASTEN TOP/BOTTOM PLATES TO RAILS W/ (2) ROWS 0.131"x2.5" NAILS @ 4" O.C.
SILL TO FOUNDATION ON SITE BY OTHERS FOR 575 PLF
RIM TO SILL = LAPPED SHEATHING W/ 0.131"x3" NAILS @ 2" O.C.

LABEL AND DATA PLATE INDEX:

TRA	THIRD PARTY LABEL	(TRA/ME/DP/CP/MHB)
ME	MAINE STATE LABEL	(TRA)
DP	DATA PLATE	(DP)
CP	CODE PLATE	
MHB	MAINE HOUSING BOARD NEW HOMES WARRANTY	
SMIMS	INSTALLATION WARRANTY SEAL	

ELEVATION	SHEAR WALL PERCENTAGE REQUIRED	PROVIDED	8D CORNION FASTENING EDGE/FIELD
FRONT	28%	53%	6" 1/2" O.C.
REAR	28%	72%	6" 1/2" O.C.
LEFT SIDE			ENGINEERED WALL
RIGHT SIDE	70%	76%	3" 1/2" O.C.

2001 WECM - 100 MPH W/EXPOSURE 1" C1
BUILDING ASPECT RATIO (L/W) = 2.35%

Builder to check appropriate box, sign, date, and return to NEH. Plans not checked, signed, and dated will be returned to Builder and subject to removal from Production Scheduling.

PERMIT PLANS

I HAVE REVIEWED THESE PLANS FOR ACCURACY AND HEREBY AUTHORIZE N.E.H. TO DO THE FOLLOWING;

- THERE ARE NO CHANGES TO THIS PLAN, RELEASE THE JOB FOR PRODUCTION.
- REVISE THE PLANS AS NOTED AND RELEASE THESE PLANS FOR PRODUCTION.
- REVISE THESE PLANS AS NOTED AND SEND ME ANOTHER SET OF PERMIT PLANS TO REVIEW.

Signature _____ Date _____

NOTE ANY & ALL Material shipped loose for the site completion of the manufactured product is ULTIMATELY the SOLE RESPONSIBILITY OF THE BUILDER LISTED BELOW to install and finish.

11256	Drawn: 3/10/17 JMS	277 Locust Street, Suite B Dover, NH 03820 www.newenglandhomes.net (telephone):800.800.8831 (fax):603.431.8540
	Revisions:	
Revision: 1	3/24/17 RTA	Builder: CMH, INC
	4/3/17 RTA	
	4/4/17 RTA	
	5/8/17 RTA	
	5/31/17 RTA	
Sheet: A-102B	7/25/17 RTA	Scale: 1:50
		Structure Desc: COLONIAL
FIRST FLOOR WALL FRAMING - BOX B		