

DECK TO BE ATTACHED TO HOUSE AS PER 2009 IRC, SECTION R502.2.2 DECKS (R502.2.2 THRU R502.2.2.4)

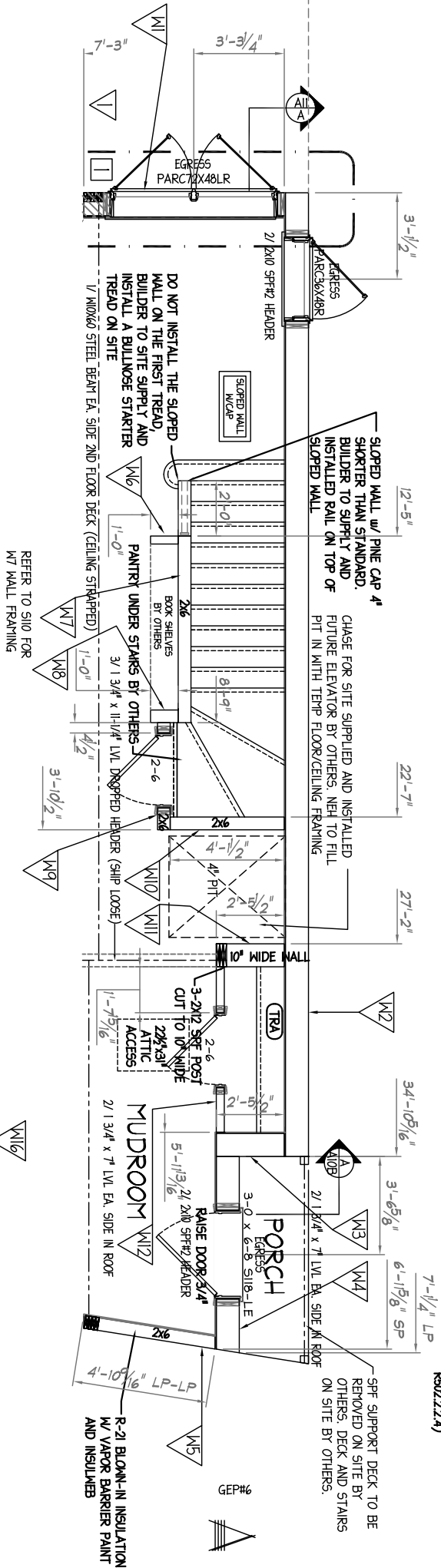

Builder to check appropriate box, sign, date, and return to N.E.H. Plans not checked, signed, and dated will be returned to Builder and subject to removal from Production Scheduling.

PERMIT PLANS

I HAVE REVIEWED THESE PLANS FOR ACCURACY AND HEREBY AUTHORIZE N.E.H. TO DO THE FOLLOWING;

- THERE ARE NO CHANGES TO THIS PLAN, RELEASE THE JOB FOR PRODUCTION.
- REVISE THE PLANS AS NOTED AND RELEASE THESE PLANS FOR PRODUCTION.
- REVISE THESE PLANS AS NOTED AND SEND ME ANOTHER SET OF PERMIT PLANS TO REVIEW.

Signature _____ Date _____

NEW ENGLAND HOMES INDEPENDENT BUILDERS DULY AUTHORIZED AGENT PER CONTRACT AGREEMENT

18'x18' DECK BY BUILDER

DECK TO BE ATTACHED TO HOUSE AS PER 2009 IRC, SECTION R502.2.2 DECKS (R502.2.2 THRU R502.2.2.4)

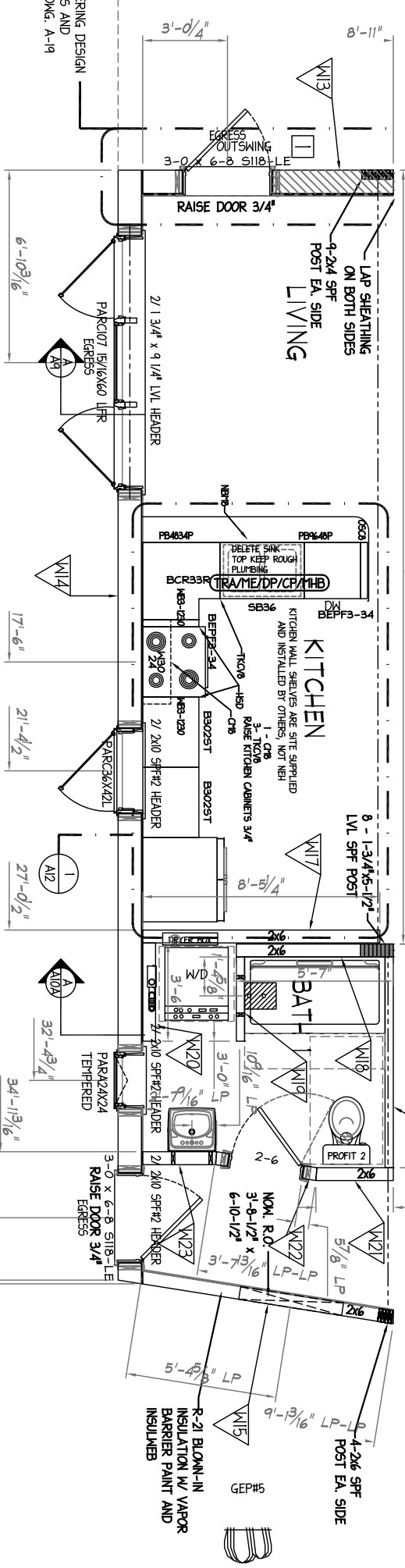

- MAINTAIN APPLIANCE DIMENSIONS WITHOUT CUT SHEETS**
- 30\"/>
- COOK TOP**
30\"/>
- WALL OVEN DOUBLE**
30\"/>
- WALL OVEN SINGLE**
30\"/>
- CLOTHES WASHER**
27\"/>
- CLOTHES DRYER**
27\"/>
- CLOTHES HANGER**
39\"/>
- CLOTHES WARDROBE**
39\"/>
- WALL OVEN DOUBLE**
30\"/>
- WALL OVEN SINGLE**
30\"/>
- CLOTHES WASHER**
27\"/>
- CLOTHES DRYER**
27\"/>
- CLOTHES HANGER**
39\"/>
- CLOTHES WARDROBE**
39\"/>

- NOTES:**
1. TACK BASEBOARD HOLDING IN ALL ROOMS.
 2. SPRINKLER SYSTEM TO BE INSTALLED LIFE SAFETY OF DUBLIN NEW HAMPSHIRE. THE SYSTEM WILL BE NFPA 80 MET SYSTEM.

DOUBLE SIDES 7/16\"/>

-
-

FASTEN TOP/BOTTOM PLATES TO RAILS W/ (2) ROWS 0.131x2.5\"/>

ELEVATION	REQUIRED	PROVIDED	BD OPTION FASTENING
FRONT	28%	53%	EDGE/FIELD
REAR	28%	72%	6\"/>
LEFT SIDE			ENGINEERED WALL
RIGHT SIDE	70%	76%	3\"/>

TRAME/DP/CP/TMB

TRAME/DP/CP/TMB	TRAME/DP/CP/TMB
TR4	THIRD PARTY LABEL
TR5	TRAME STATE LABEL
DP	DATA PLATE
CP	CODE PLATE
TMB	TRAME HOUSING BOARD NEW HOMES WARRANTY INSTALLATION WARRANTY SEAL

NOTE ANY & ALL Material shipped loose for the site completion of the manufactured product is ULTIMATELY the SOLE RESPONSIBILITY OF THE BUILDER LISTED BELOW to install and finish.

11256

Drawn: 3/10/17 JMS

Revisions:

3/24/17	RTA
4/3/17	RTA
4/4/17	RTA
5/8/17	RTA
5/31/17	RTA
7/25/17	RTA

Sheet: **A-102**

Builder: **CMH, INC**

Scale: **3/16"=1'-0"**

Structure Desc: **COLONIAL**

277 Locust Street, Suite B
Dover, NH 03820
www.newenglandhomes.net
(telephone)800.800.8831
(fax)603.431.8540

OVERALL FIRST FLOOR WALL FRAMING