

NOTES:

- 1.) ELECTRICAL, MECHANICAL, AND PLUMBING SPECIFICATIONS AND PERMITS BY OTHERS.
- 2.) REUSE EXISTING SWITCH LOCATIONS WHEN POSSIBLE.
- 2.) FUEL OIL FILL-PIPES WILL NEED TO BE RELOCATED (OR EXTENDED, IF POSSIBLE) AS PART OF PORCH EXPANSION
- 3.) (1) FROST-FREE SILLCOCK WILL NEED TO BE RELOCATED AS PART OF PORCH EXPANSION
- 4.) SPEAKER WIRES MAY NEED TO BE RELOCATED AS PART OF KITCHEN RENOVATIONS
- 5.) 4" LED RECESSED CANS TYPICAL
- 6.) ELECTRICAL CONTRACTOR RESPONSIBLE FOR ENSURING THAT PROJECT MEETS ALL LOCAL ELECTRICAL CODE REQUIREMENTS.

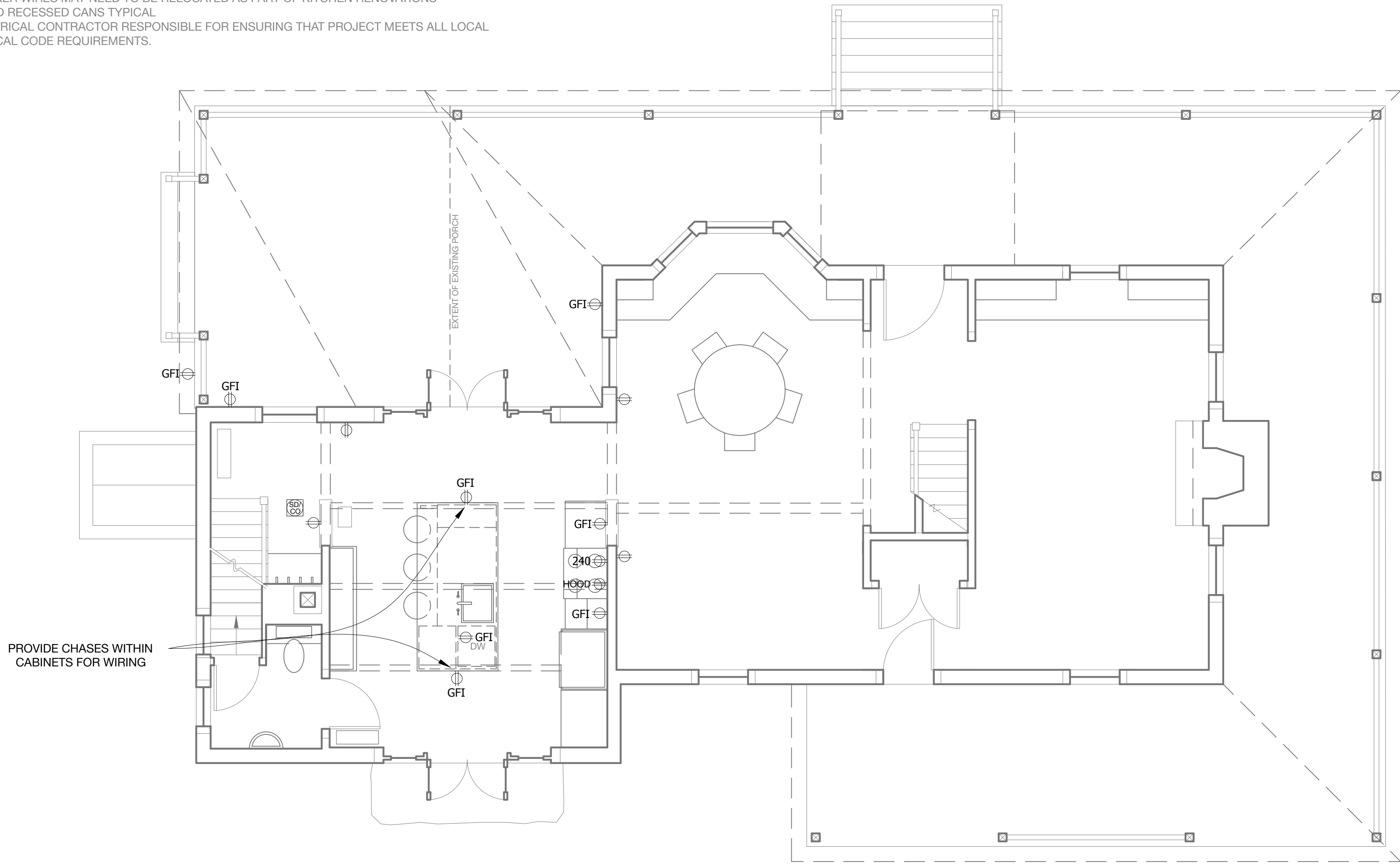

**A** Proposed Kitchen & Porch Power Plan

- NOTES:
- |  |                                  |  |                          |  |  |  |  |  |  |  |                                     |  |                                 |  |                     |
|--|----------------------------------|--|--------------------------|--|--|--|--|--|--|--|-------------------------------------|--|---------------------------------|--|---------------------|
|  | DUPLEX RECEPTACLE                |  | 3-WAY SWITCH             |  | LOW PROFILE WALL SCONCE LIGHT FIXTURE  |  | WET LOCATION WALL SCONCE LIGHT FIXTURE |  | RECESSED CAN LIGHT FIXTURE             |  | UNDER-COUNTER LIGHTS                |  | CEILING FAN WITH INTEGRAL LIGHT |  | PHONE JACK          |
|  | GROUND FAULT CIRCUIT INTERRUPTER |  | DIMMER SWITCH            |  | RECESSED "STAIR RISER" LIGHT FIXTURE   |  | CEILING MOUNT LIGHT FIXTURE            |  | COMPACT FLUORESCENT RECESSED CAN LIGHT |  | TRACK LIGHTING                      |  | CEILING FAN                     |  | DSL JACK            |
|  | 240 V                            |  | SMOKE DETECTOR           |  | WET LOCATION WALL SCONCE LIGHT FIXTURE |  | EXTERIOR FLOOD LIGHT LIGHT FIXTURE     |  | LED RECESSED CAN LIGHT                 |  | LOCALLY SWITCHED CLOSET RATED LIGHT |  | MINIMUM 50 CFM VENT FAN         |  | CABLE JACK          |
|  | SWITCH                           |  | COMBO SMOKE/CO2 DETECTOR |  | WET LOCATION WALL SCONCE LIGHT FIXTURE |  | LOCALLY SWITCHED READING LIGHT         |  | PENDANT LIGHT FIXTURE                  |  | CEILING FAN WITH INTEGRAL LIGHT     |  | CAT 5 JACK                      |  | CENTRAL VACUUM PORT |

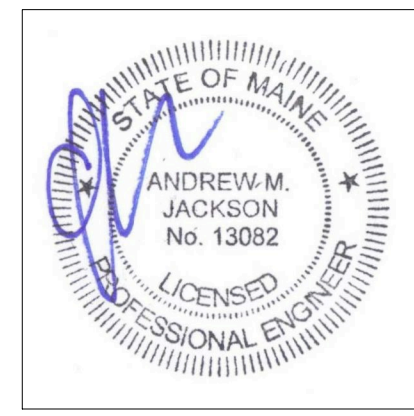

**Rachel Conly Design LLC**  
 26 Sterling Street  
 Peaks Island, Maine 04108  
 207.766.5625

DATE	NOTES
2017.01.03	Grade Comparison, REVISED
2017.01.17	Simplified Slab, New Girder, Hold-downs, No Skylights
2017.01.19	SK4: no hold-downs; SK5: laundry
2017.01.30	Kitchen Renovations & Porch Extension
2017.03.20	

1/4" = 1'

**Heselton Clements**  
**Bunkhouse/Studio**  
 11 Ocean St.  
 Peaks Island, ME 04108

**SK12**  
 Proposed  
 Kitchen & Porch  
 Power Plan