

**SPURN GULLIVER RESIDENCE**  
 PEAKS ISLAND, MAINE

**SYMBOLS LEGEND**

**HARDSCAPE**

- STONE PAVING (L5.0 DETAIL 1)
- IMPORTED BOULDER
- STABILIZED DECOMPOSED GRANITE
- IPE DECK (L5.0 DETAIL 10)
- HASTINGS GRASS PAVERS (L5.0 DETAIL 9)
- CONCRETE RETAINING WALL (L5.0 DETAIL 11)
- GRANITE CURB
- STEEL EDGING (L5.1 DETAIL 1)
- LANDSCAPE STEP / RISER

**PLANTS**

- LAWN
- EXISTING TREE
- PROPOSED DEODOUOUS TREE
- PROPOSED EVERGREEN TREE
- PROPOSED HEDGE / SHRUB / SMALL PERE
- PERENNIAL PLANTINGS

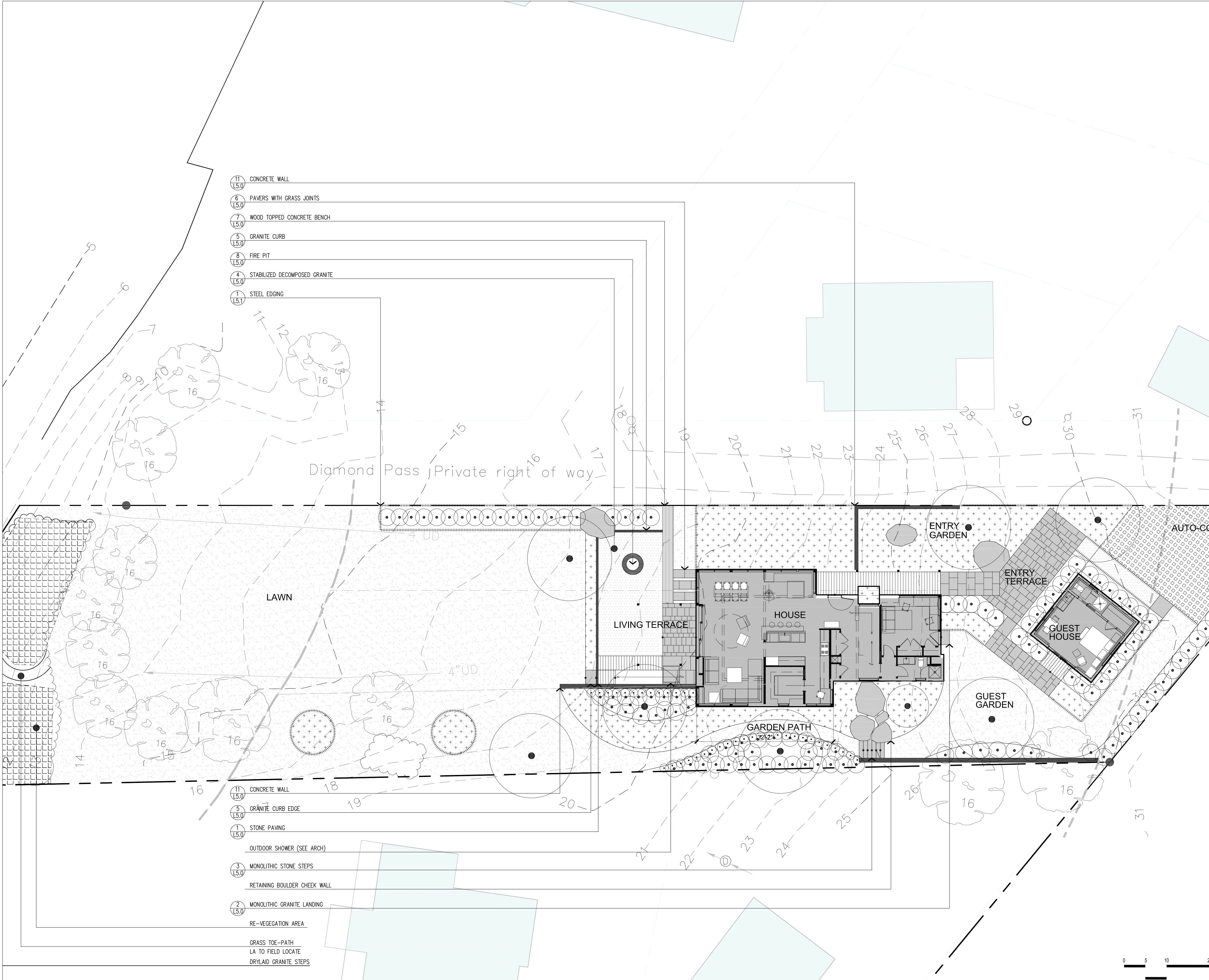

- 11 (L5.0) CONCRETE WALL
- 6 (L5.0) PAVERS WITH GRASS JOINTS
- 7 (L5.0) WOOD TOPPED CONCRETE BENCH
- 5 (L5.0) GRANITE CURB
- 8 (L5.0) FIRE PIT
- 4 (L5.0) STABILIZED DECOMPOSED GRANITE
- 1 (L5.1) STEEL EDGING

- 11 (L5.0) CONCRETE WALL
- 5 (L5.0) GRANITE CURB EDGE
- 1 (L5.0) STONE PAVING
- OUTDOOR SHOWER (SEE ARCH)
- 3 (L5.0) MONOLITHIC STONE STEPS
- RETAINING BOULDER CHEEK WALL
- 2 (L5.0) MONOLITHIC GRANITE LANDING
- RE-VEGETATION AREA
- GRASS TOE-PATH  
LA TO FIELD LOCATE  
DRYLAID GRANITE STEPS

No:	Revision	Date:
1	Revision	9/5/2017

revisions:  
 date: AUGUST 11, 2017  
 scale: As Noted  
 drawn: XX  
 checked: XX

**L1.0**  
 LANDSCAPE MATERIALS PLAN

0 5 10 20  
 PERMIT SET  
 NOT FOR CONSTRUCTION