

GENERAL NOTES: (PLEASE READ)

01. ALWAYS REFER TO STRUCTURAL DWGS FOR ADDITIONAL INFORMATION. PROMPTLY NOTIFY ARCHITECT AND ENGINEER IN THE EVENT OF ANY DIMENSIONAL DISCREPANCIES.
02. ALWAYS REFER TO OUTLINE SPECIFICATIONS FOR ADDITIONAL INFORMATION.
03. ALL FOUNDATION WALL DIMENSIONS TAKEN FROM OUTSIDE FACE OF CONCRETE UNLESS NOTED OTHERWISE. ALL WOOD FRAMED WALL DIMENSIONS TAKEN FROM OUTSIDE FACE OF FRAMING, UNLESS NOTED OTHERWISE.
04. ALL WINDOW AND DOOR OPENINGS MEASURED TO CENTER OF THE OPENING, UNLESS NOTED OTHERWISE. REFER TO EXTERIOR ELEVATIONS FOR ADDITIONAL DOOR AND WINDOW LOCATION / ALIGNMENT INFORMATION.
05. ALL INTERIOR FRAMED PARTITION WALLS TO BE 2 x 4 AND/OR 2 x 6 STUD WALL CONSTRUCTION, UNLESS NOTED OTHERWISE.
06. DOOR SLAB & CASED OPENING SIZES SHOWN IN FLOOR PLANS. SIZE AND CONSTRUCT ROUGH OPENINGS TO ACCOMMODATE.
07. ALL WOOD FRAMING IN CONTACT WITH CONCRETE TO BE PRESSURE TREATED.
08. PROVIDE SMOKE / CARBON MONOXIDE DETECTORS TO MEET LOCAL MUNICIPALITY REQUIREMENTS - COORDINATE FINAL LOCATIONS WITH ARCHITECT DURING CONSTRUCTION.
09. ADDITIONAL DETAILS, SPECIFICATIONS, AND INFORMATION WILL BE PROVIDED IN THE PENDING INTERIORS PACKAGE.

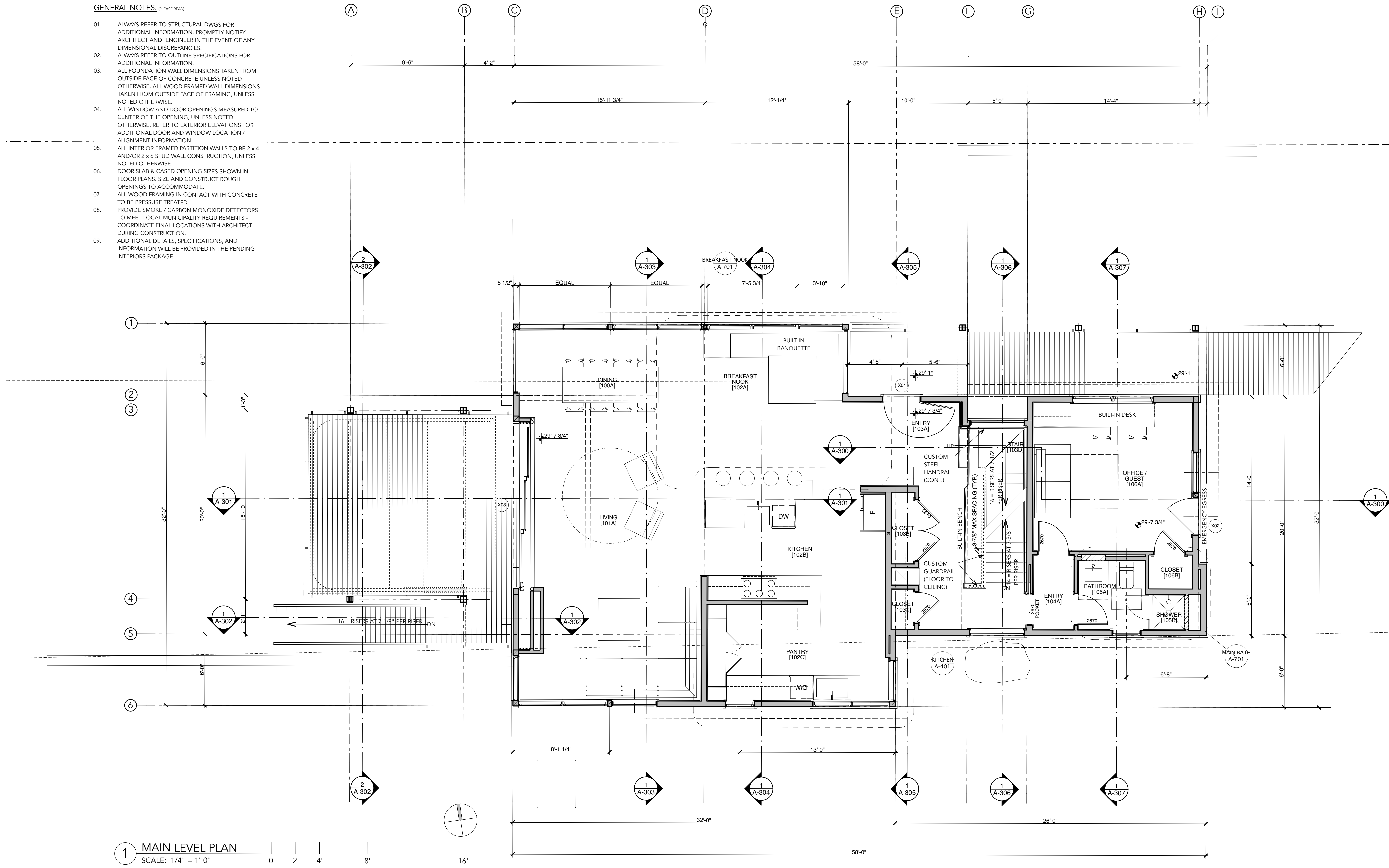

1 MAIN LEVEL PLAN
 SCALE: 1/4" = 1'-0"

Architect:
 Whitten Architects
 37 Silver Street
 Portland, Maine 04101
 Phone: (207) 774-0111
 www.whittenarchitects.com

Landscape Architect:
 Soren DeNiord Design Studio
 43 Wellwood Road
 Portland, Maine 04103
 Phone: (207) 400-2450

Civil Engineer:
 Walsh Engineering Assoc. Inc.
 One Karen Drive, Suite 2A
 Westbrook, Maine 04092
 Phone: (207) 553-9898

Structural Engineer:
 Albert Putnam Associates
 183 Park Row
 Brunswick, Maine 04011
 Phone: (207) 729-6230

General Contractor:
 Bunton Construction
 87 Middle Road
 Cumberland Center,
 Maine 04021
 Phone: (207) 829-6438

Drawing:

MAIN LEVEL PLAN
 Date:
 June 15, 2017
 September 5, 2017 REV-1

Issue:
 PERMIT SET

A-101A