

**GENERAL NOTES:** (PLEASE READ)

01. ALWAYS REFER TO STRUCTURAL DWGS FOR ADDITIONAL INFORMATION. PROMPTLY NOTIFY ARCHITECT AND ENGINEER IN THE EVENT OF ANY DIMENSIONAL DISCREPANCIES.
02. ALWAYS REFER TO OUTLINE SPECIFICATIONS FOR ADDITIONAL INFORMATION.
03. ALL FOUNDATION WALL DIMENSIONS TAKEN FROM OUTSIDE FACE OF CONCRETE, UNLESS NOTED OTHERWISE. ALL WOOD FRAMED WALL DIMENSIONS TAKEN FROM OUTSIDE FACE OF FRAMING, UNLESS NOTED OTHERWISE.
04. ALL WINDOW AND DOOR OPENINGS MEASURED TO THE CENTER OF THE OPENING, UNLESS NOTED OTHERWISE. REFER TO EXTERIOR ELEVATIONS FOR ADDITIONAL DOOR AND WINDOW LOCATION / ALIGNMENT INFORMATION.
05. ALL INTERIOR FRAMED PARTITION WALLS TO BE 2 x 4 AND/OR 2 x 6 STUD WALL CONSTRUCTION UNLESS NOTED OTHERWISE.
06. DOOR SLAB & CASED OPENING OPENING SIZES SHOWN IN FLOOR PLANS. SIZE AND CONSTRUCT ROUGH OPENINGS TO ACCOMMODATE.
07. ALL WOOD FRAMING IN CONTACT WITH CONCRETE TO BE PRESSURE TREATED.
08. ADDITIONAL DETAILS, SPECIFICATIONS, AND INFORMATION WILL BE PROVIDED IN THE PENDING INTERIORS PACKAGE

**Project:**  
**Peaks Island Cottage**  
 Portland, Maine

**Notes:**

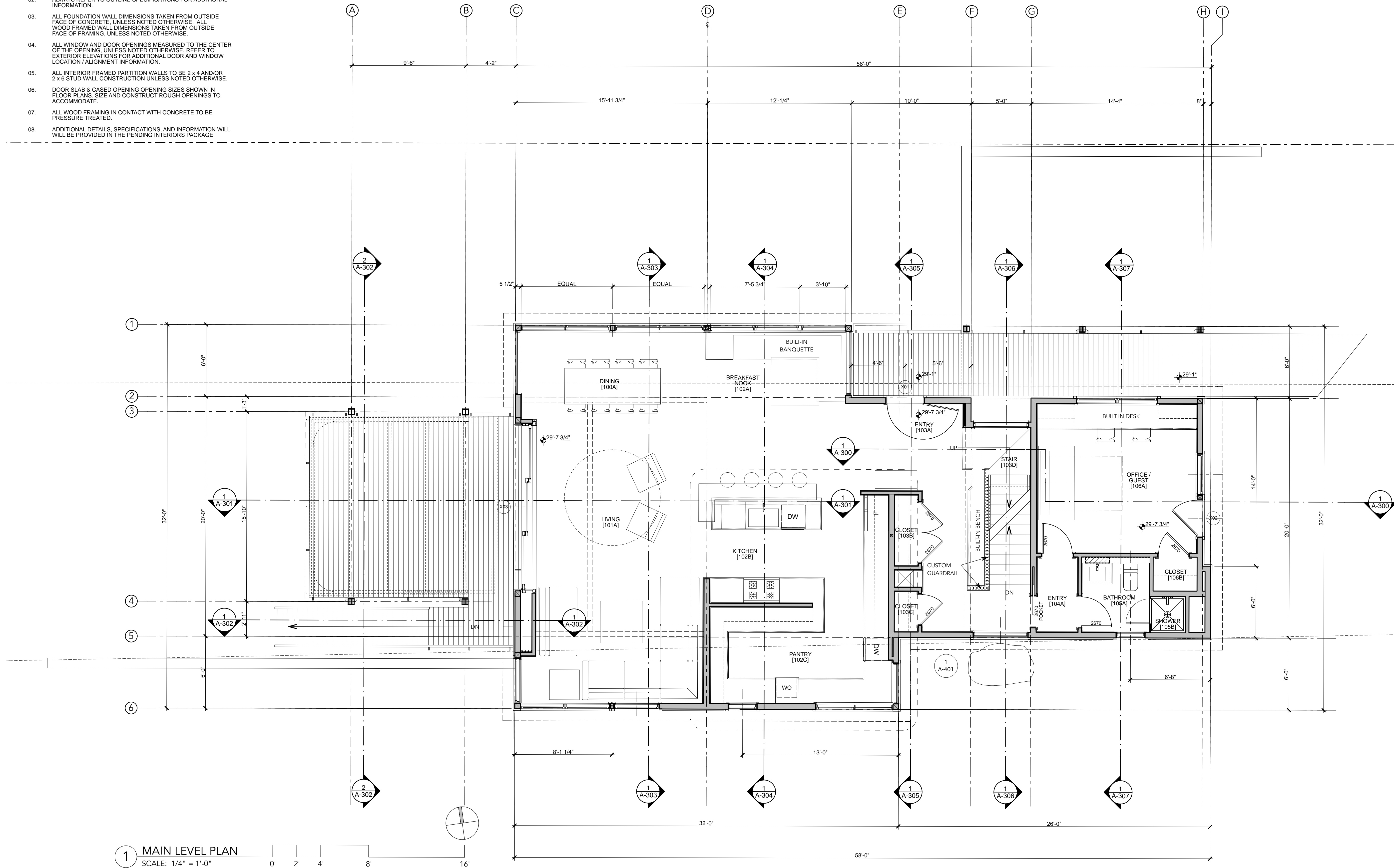

**1 MAIN LEVEL PLAN**  
 SCALE: 1/4" = 1'-0"

- Architect:**  
 Whitten Architects  
 37 Silver Street  
 Portland, Maine 04101  
 Phone: (207) 774-0111  
 www.whittenarchitects.com
- Landscape Architect:**  
 Soren DeNiord Design Studio  
 43 Wellwood Road  
 Portland, Maine 04103  
 Phone: (207) 400-2450
- Civil Engineer:**  
 Walsh Engineering Assoc. Inc.  
 One Karen Drive, Suite 2A  
 Westbrook, Maine 04092  
 Phone: (207) 553-9898
- Structural Engineer:**  
 Albert Putnam Associates  
 183 Park Row  
 Brunswick, Maine 04011  
 Phone: (207) 729-6230
- General Contractor:**  
 Bunton Construction  
 87 Middle Road  
 Cumberland Center,  
 Maine 04021  
 Phone: (207) 829-6438
- Drawing:**

**MAIN LEVEL PLAN**

**Date:**  
 June 15, 2017

**Issue:**  
 PERMIT SET

**A-101A**