

SUBSURFACE WASTEWATER DISPOSAL SYSTEM APPLICATION

Maine Department of Human Services
 Division of Health Engineering, Station 10 SMS
 (207) 287-5672 FAX (207) 287-4172

Town, City, Plantation: **PORTLAND, PEAKS ISLAND**
 Street, Road, Subdivision: **676 SEASHORE AVENUE**
 Owner's Name: **(SUSAN LEE)**

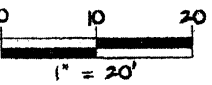
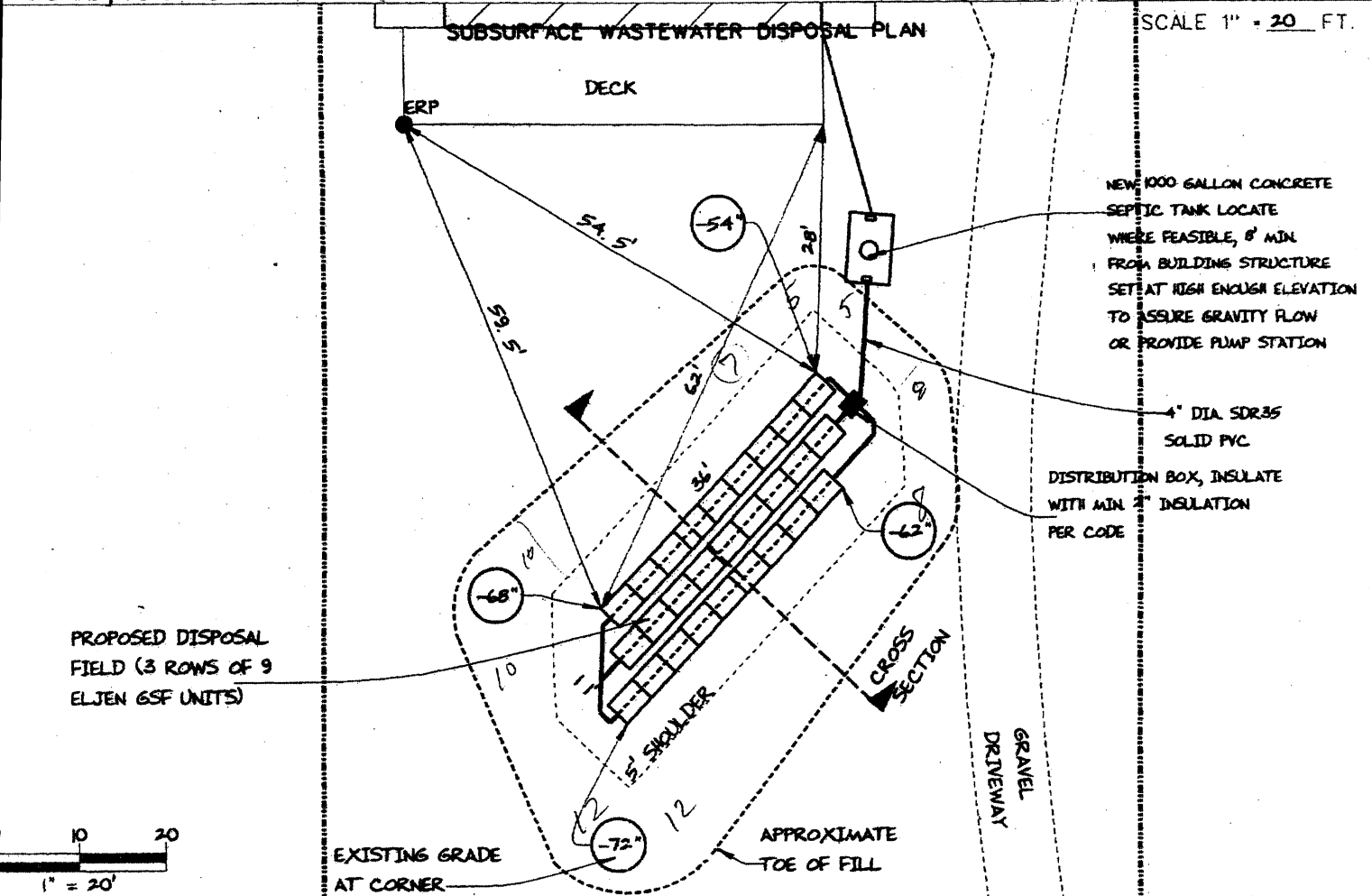

FILL REQUIREMENTS		CONSTRUCTION ELEVATIONS		SEE DETAIL BELOW	ELEVATION REFERENCE POINT	
Depth of Fill (Upslope)	= 15" - 29"	Finished Grade Elevation			Location & Description TOP OF CONCRETE FOOTINGS, 8" ABOVE GRADE	Reference Elevation is: 0.0" or -----
Depth of Fill (Downslope)	= 23" - 33"	Top of Distribution Pipe or Proprietary Device				
DEPTHS AT CROSS-SECTION (shown below)		Bottom of Disposal Area				

DISPOSAL AREA CROSS SECTION

SCALE: VERTICAL: 1" = 5 FT HORIZONTAL: 1" = 10 FT

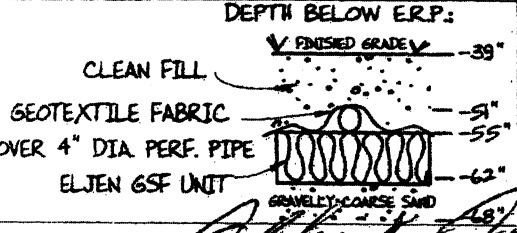
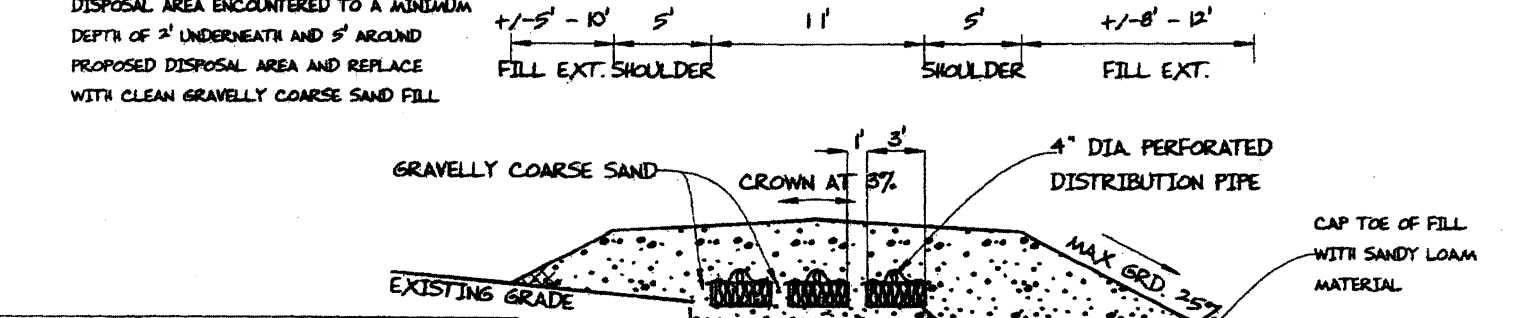

Albert Frick
 Site Evaluator Signature

163
 SE

10/9/2014
 Date