

# ASHP Site Plan



142 Presumpscot Street  
Portland, ME 04103  
(207) 221-6342

Customer Name:

Paul Stenzel & Judy Walsh  
41 Fredrick Ave  
Peaks Island, Maine

System Type:

Air Source Heat Pump

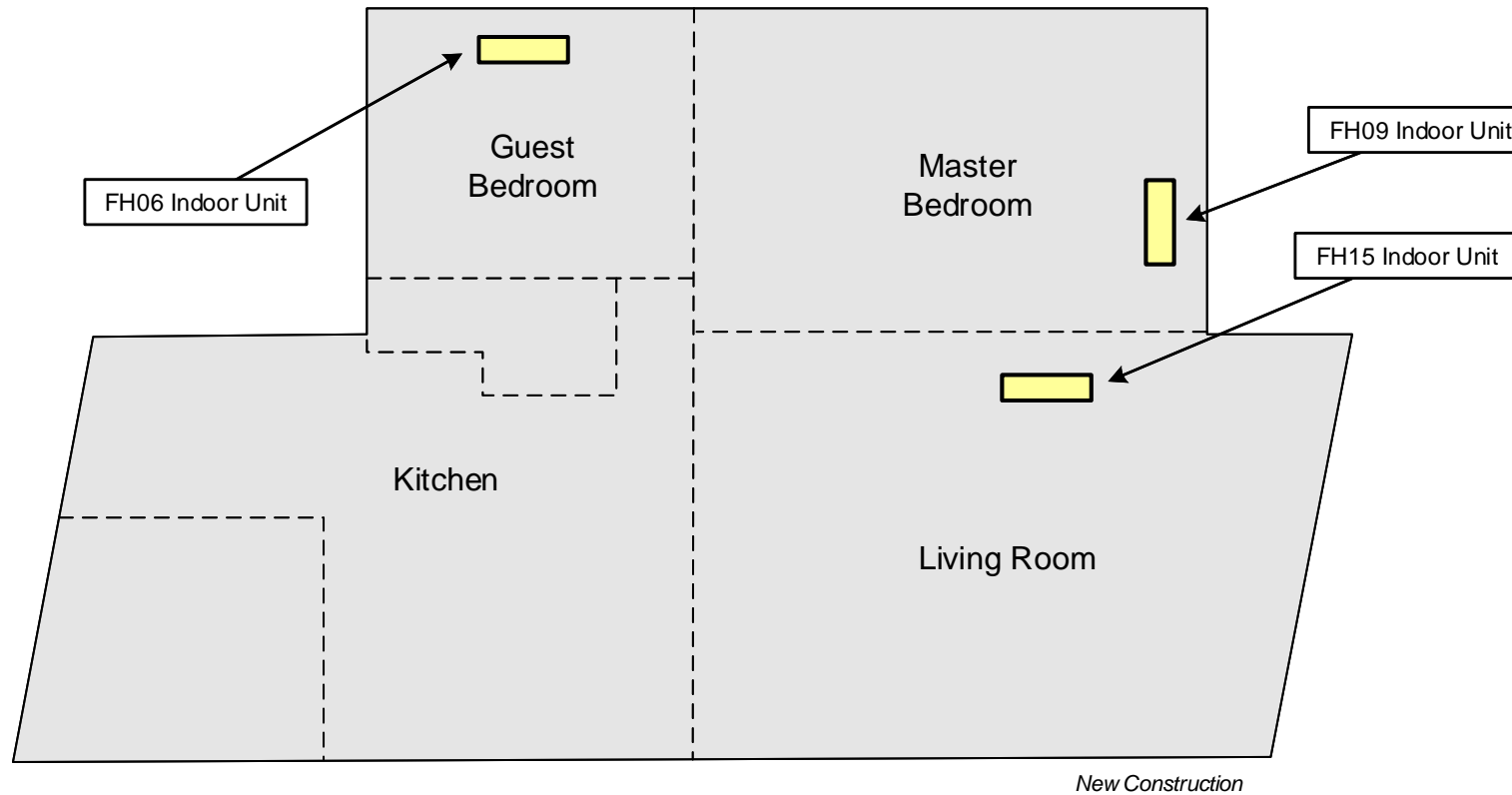

## Outdoor Unit

(1) Mitsubishi MXZ-3C30NAHZ – 189 lbs

Installation: Ground mounted stand with precast concrete base

Location: TBD (new construction)

## Indoor Units

(1) Mitsubishi MSZ-FH06 (ductless) – 29 lbs

Location: Wall-mounted, 1<sup>st</sup> floor, master bedroom

(1) Mitsubishi MSZ-FH09 (ductless) – 29 lbs

Location: Wall-mounted, 1<sup>st</sup> floor, kitchen

(1) Mitsubishi MSZ-FH15 (ductless) – 29 lbs

Location: Wall-mounted, 1<sup>st</sup> floor, living room

The home will be built of traditional wood framing and should be sufficient to support the additional load of the equipment being installed.

Designed by: BAA

Date: December 16, 2016

SITE PLAN

SHEET A01

© Copyright ReVision Energy

This diagram is provided as a service and is based on the understanding of the information supplied. It is subject to change based on actual conditions, applicable edition of the National Electric Code, and local governmental authorities.