

INSULATED WALLS - DP CELLULOSE ON EXTERIOR; ACOUSTIC BATTS ON INTERIOR

UNINSULATED WALLS

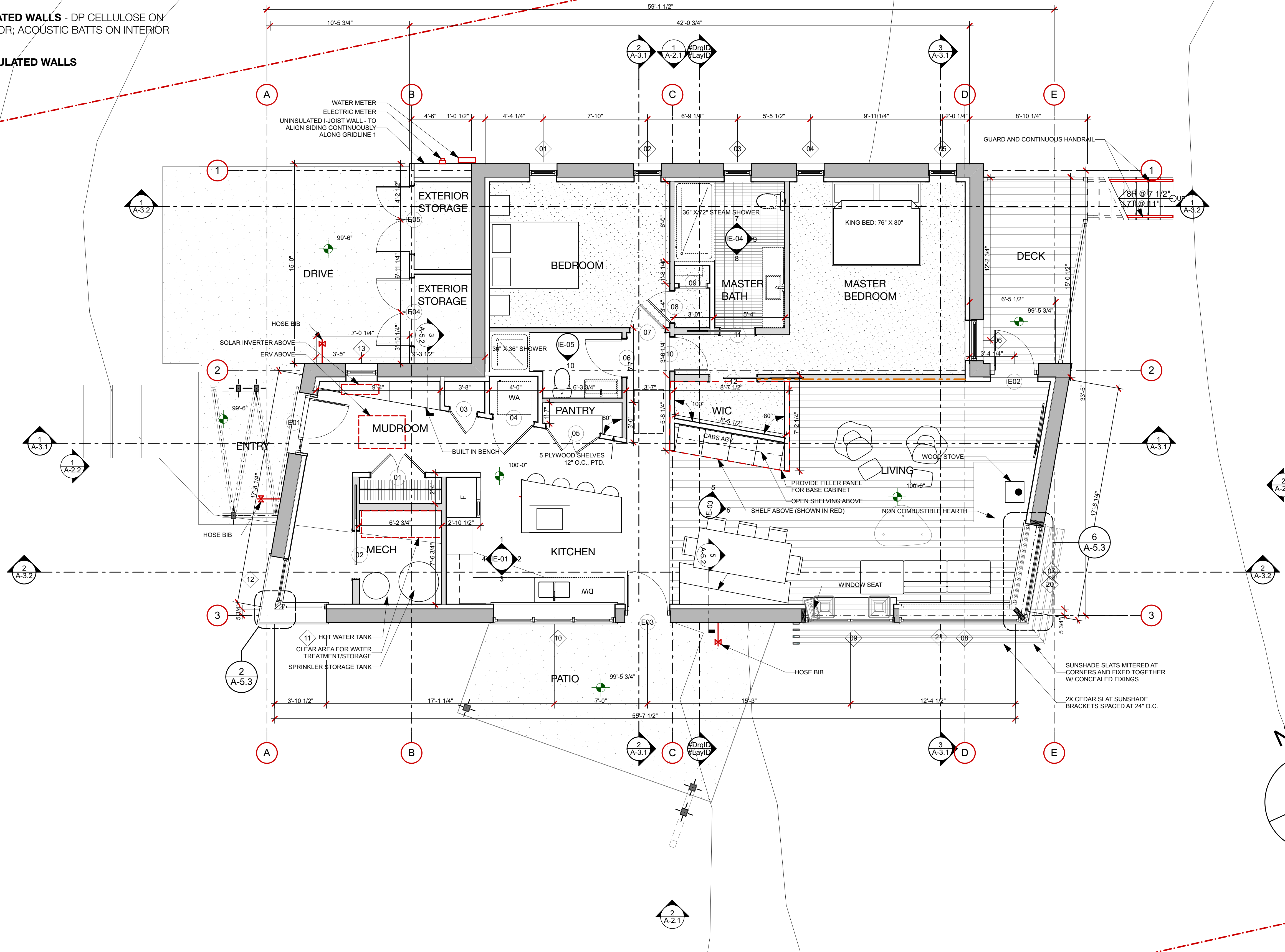

1st FLOOR
SCALE: 1/4" = 1'-0"

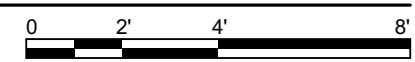
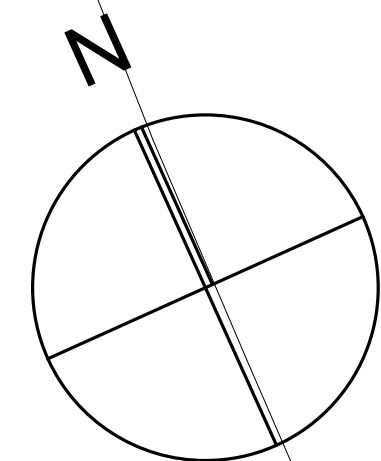

FOR CONSTRUCTION
PROJECT NO: STZ
DATE: 6/27/16
DRAWN BY: SDF
PHASE: CONSTRUCTION DOCUMENTS

1ST FLOOR PLAN

A-1.2