

- THIRD PARTY LABELS
- △ STATE LABELS
- DATA PLATE
- ⊕ MAINE WARRANTY LABEL

ME. NOTES:
 1. A NEW ENGLAND FURNACE SWITCH IS REQUIRED TO BE OUT SIDE OF BASEMENT DOOR.
 2. BATH FANS ARE MINIMUM 50 CFM AND 3 SONES.
 3. RANGE HOODS ARE A MINIMUM OF 100 CFM.

NOTE:
 -ALL EXTERIOR WALLS ARE CONTINUOUS SHEATHED BRACED WALLS W/ MIN. 7/16" STRUCTURAL PANEL (MEETING DOC PS1 or PS2) FASTENED W/ 16 GA. STAPLES @ 3" O.C. EDGES AND 6" O.C. FIELD. EXTERIOR WALL TO WALL (CORNERS) ARE FAST. W/16d (3 1/2"x.131") NAILS @ 12" O.C. MIN.

BOX "C"

BOX "D"

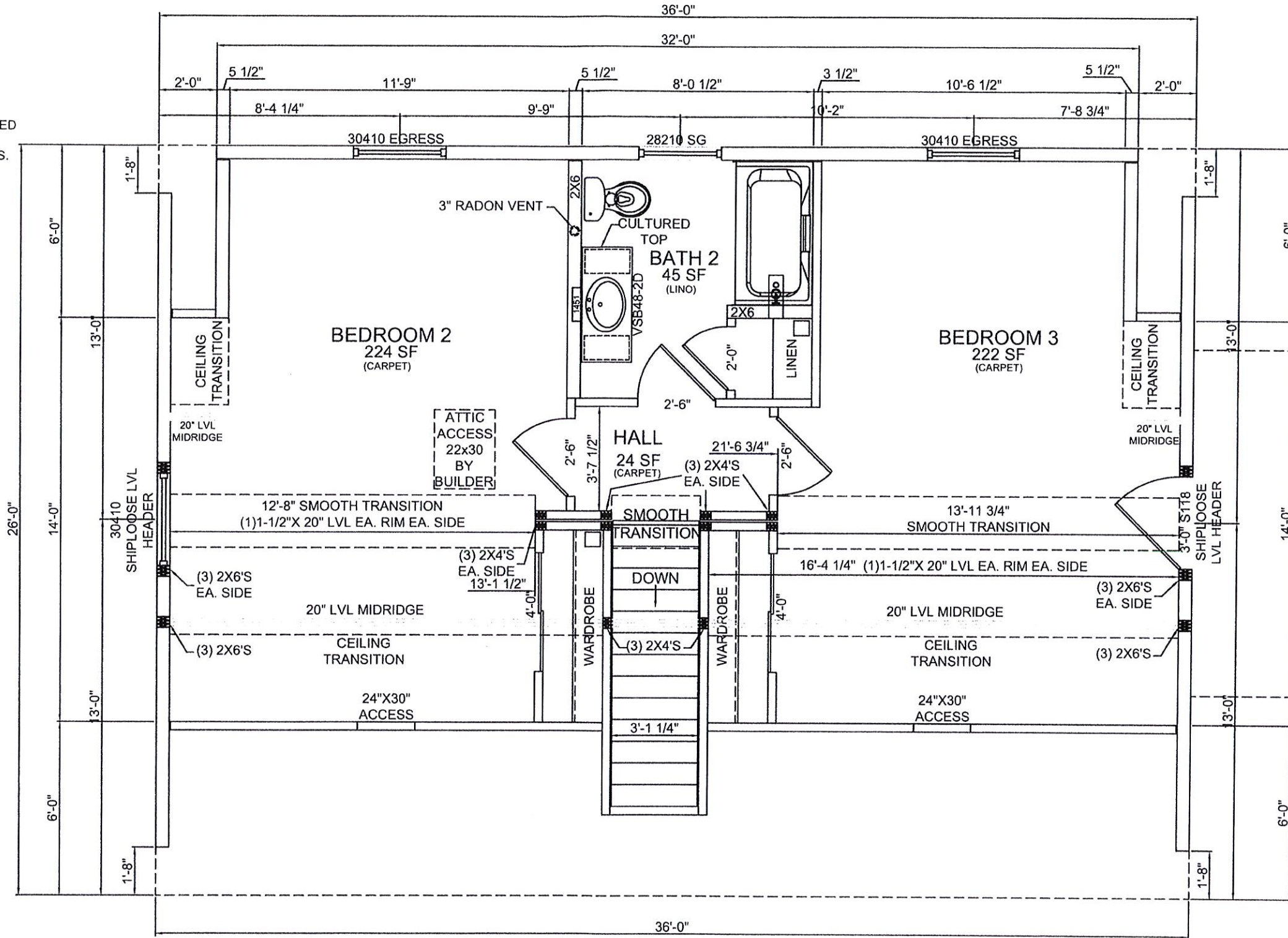

T.R. ARNOLD & ASSOCIATES, INC. PO Box 1081 Ellsworth, ME 04855
 State(s) MAINE
 Accredited Evaluation and Inspection Agency
 This document is certified as being in conformance with LISTED CODES
 Jul 5, 2016
 Approved By *Kevin White*
 Approval of this document does not authorize or approve any omission or deviation from the requirements of applicable State Laws.
 TRA APPROVAL LIMITED TO FACTORY-BUILT MODULES ONLY.

HARVEY WINDOWS

8'-0" CEILINGS

R20 DENSE PACK INSULATION @ EXTERIOR WALLS
 INSULATE BATHROOM WALLS WITH R11

JOB NAME
Purtell
 Peaks Island, ME 04108
 50# GSL / 90 MPH WIND

BUILDER
Hallmark Homes Corp
 619 Lewiston Road
 Topsham, ME 04086

HOUSE TYPE
4-Box Cape
 FILE NAME: Q-16-0117-JML
 SERIAL #: KBS-2735

2nd FLOOR PLAN
 SHEET # P4
 SCALE: 1/4" = 1'-0"
 DWN BY: SAT/ETW
 DATE: 06/22/16

REVISIONS	



KBS BUILDERS, INC.
 300 PARK STREET, SOUTH PARIS, ME 04281
 PHONE: 207-739-2400 FAX: 207-739-2223