

- THIRD PARTY LABELS
- △ STATE LABELS
- DATA PLATE
- ⊖ MAINE WARRANTY LABEL

ME. NOTES:
 1. A NEW ENGLAND FURNACE SWITCH IS REQUIRED TO BE OUT SIDE OF BASEMENT DOOR.
 2. BATH FANS ARE MINIMUM 50 CFM AND 3 SONES.
 3. RANGE HOODS ARE A MINIMUM OF 100 CFM.

NOTE:
 -ALL EXTERIOR WALLS ARE CONTINUOUS SHEATHED BRACED WALLS W/ MIN. 7/16" STRUCTURAL PANEL (MEETING DOC PS1 or PS2) FASTENED W/ 16 GA. STAPLES @ 3" O.C. EDGES AND 6" O.C. FIELD EXTERIOR WALL TO WALL (CORNERS) ARE FAST. W/16d (3 1/2"x.131") NAILS @ 12" O.C. MIN.

BOX "A"

BOX "B"

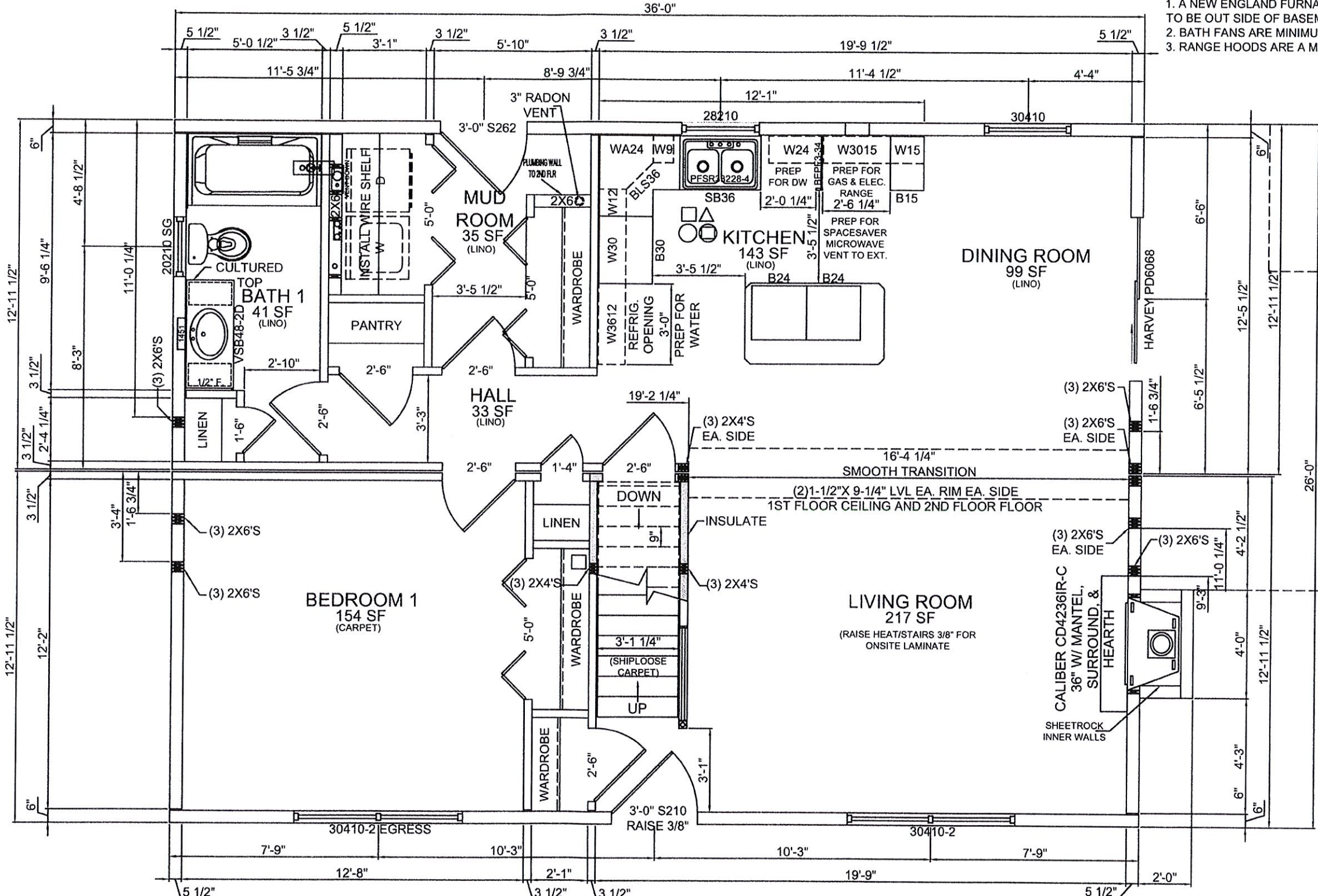

T.R. ARNOLD & ASSOCIATES, INC. PO Box 1091 Ellsworth, ME 04853
 State(s) MAINE
 Accredited Evaluation and Inspection Agency
 This document is certified as being in conformance with LISTED CODES
 Jul 5, 2016
 Approved By: *Kevin White*
 Approval of this document does not authorize or approve any omission or deviation from the requirements of applicable State Laws.
 TRA APPROVAL LIMITED TO FACTORY-BUILT MODULES ONLY.

HARVEY WINDOWS

8'-0" CEILINGS

R20 DENSE PACK INSULATION @ EXTERIOR WALLS
 INSULATE BATHROOM WALLS WITH R11

JOB NAME Purtell Peaks Island, ME 04108 50# GSL / 90 MPH WIND	BUILDER Hallmark Homes Corp 619 Lewiston Road Topsham, ME 04086	HOUSE TYPE 4-Box Cape FILE NAME: Q-16-0117-JML SERIAL #: KBS-2735	1st FLOOR PLAN SHEET # P3 SCALE: 1/4" = 1'-0" DWN BY: SAT/ETW DATE: 06/22/16	REVISIONS 	KBS BUILDERS, INC. 300 PARK STREET, SOUTH PARIS, ME 04281 PHONE: 207-739-2400 FAX: 207-739-2223
---	---	---	--	---------------	--