

# SUBSURFACE WASTEWATER DISPOSAL SYSTEM APPLICATION

Department of Health and Human Services  
Division of Environmental Health  
(207) 287-2070 FAX (207) 287-4172

Town, City, Plantation  
**PORTLAND; PEAKS ISLAND**

Street, Road Subdivision  
**30 HIGHLAND AVENUE**

Owner's Name  
**TIMOTHY WEBSTER**

**\*\*ALBERT FRICK ASSOCIATES ARE NOT SURVEYORS\*\***  
PROPERTY INFORMATION APPROXIMATED  
PER TOWN TAX MAP AND AERIAL PHOTOGRAPH  
VERIFY PROPERTY LINES TO ASSURE ACCURATE  
LOCATION PRIOR TO SYSTEM INSTALLATION

SITE PLAN

Scale 1" = 100 Ft.  
or as shown

SITE LOCATION PLAN  
(Attach Map from Maine  
Atlas Recommended)

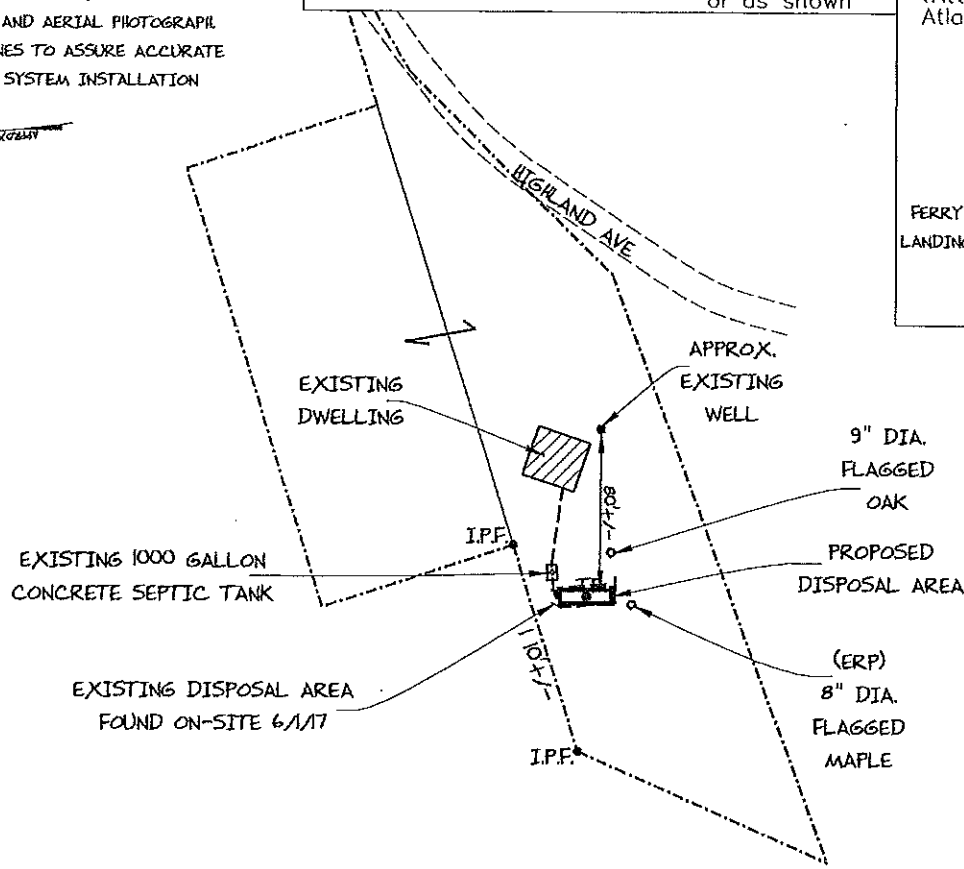
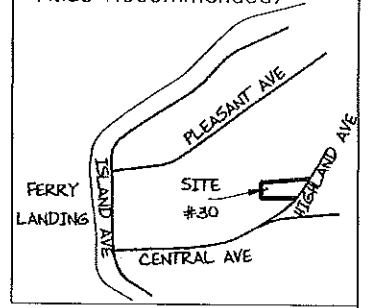

## SOIL DESCRIPTION AND CLASSIFICATION (Location of Observation Holes Shown Above)

Observation Hole TP 1  Test Pit  Boring  
" Depth of Organic Horizon Above Mineral Soil

DEPTH BELOW MINERAL SOIL SURFACE (inches)	Texture	Consistency	Color	Mottling
0	SANDY LOAM (FILL)		DARK BROWN	
10	GRAVELLY COARSE SAND	FRIABLE	YELLOW BROWN	NONE EVIDENT
20	ELJEN GSF UNIT			
30				
40				
50				

Soil Classification <b>12</b>	Slope <b>0-3 %</b>	Limiting Factor <b>-</b>	<input type="checkbox"/> Ground Water <input type="checkbox"/> Restrictive Layer <input type="checkbox"/> Bedrock <input type="checkbox"/> Pit Depth
Profile <b>B</b>	Condition <b>FILL OVER (2" AT117C)</b>		

Observation Hole \_\_\_\_\_  Test Pit  Boring  
" Depth of Organic Horizon Above Mineral Soil

DEPTH BELOW MINERAL SOIL SURFACE (inches)	Texture	Consistency	Color	Mottling
0				
10				
20				
30				
40				
50				

Soil Classification	Slope	Limiting Factor	<input type="checkbox"/> Ground Water <input type="checkbox"/> Restrictive Layer <input type="checkbox"/> Bedrock <input type="checkbox"/> Pit Depth
Profile	Condition	%	

*[Handwritten Signature]*  
Site Evaluator Signature

352  
SE #

*[Handwritten Date]*  
Date

Page 2 of 3  
HHE-200 Rev. 02/11