

Rachel Conly

Architectural Design

Peaks Island, Maine 04108
207.766.5625

**Proposed Cross
Section**

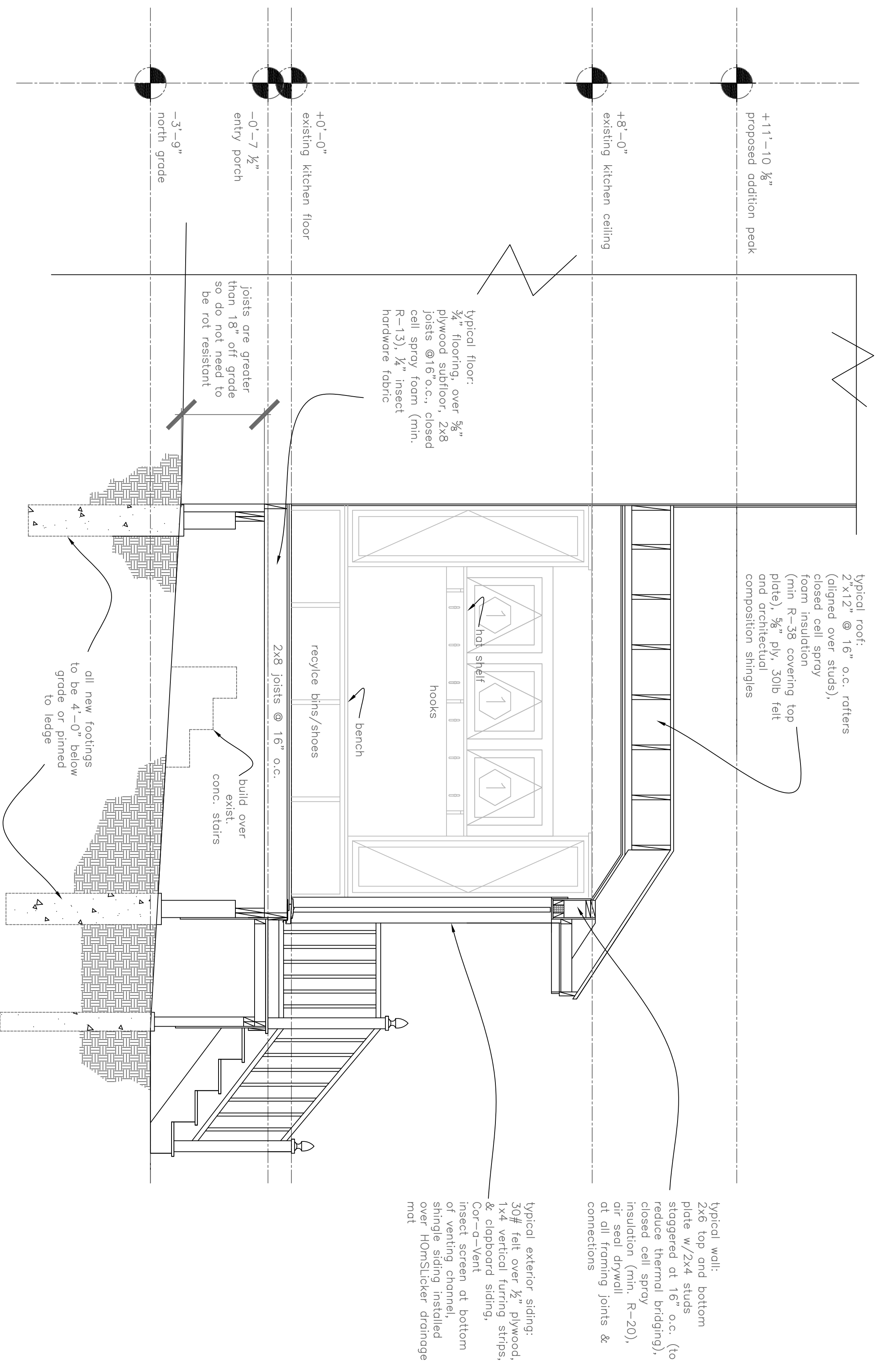

A Proposed Cross Section
1/2" = 1'-0"

PROJECT
**Remage Healey
Residence**

54 Central Avenue
Peaks Island, Me.
04108

DATE	4.30.13	REVISED	
SCALE	1/2" = 1'-0"	DRAWN BY	Rachel
NOTES			