

PERMIT	09.7.2011
STRUCTURAL ENGINEERING	08.12.2011
ZONING REVIEW	07.20.2011

DATE: 09.07.2011
 SCALE: 1/4" = 1'-0"

NEW FOUNDATION PLAN

S 1.1

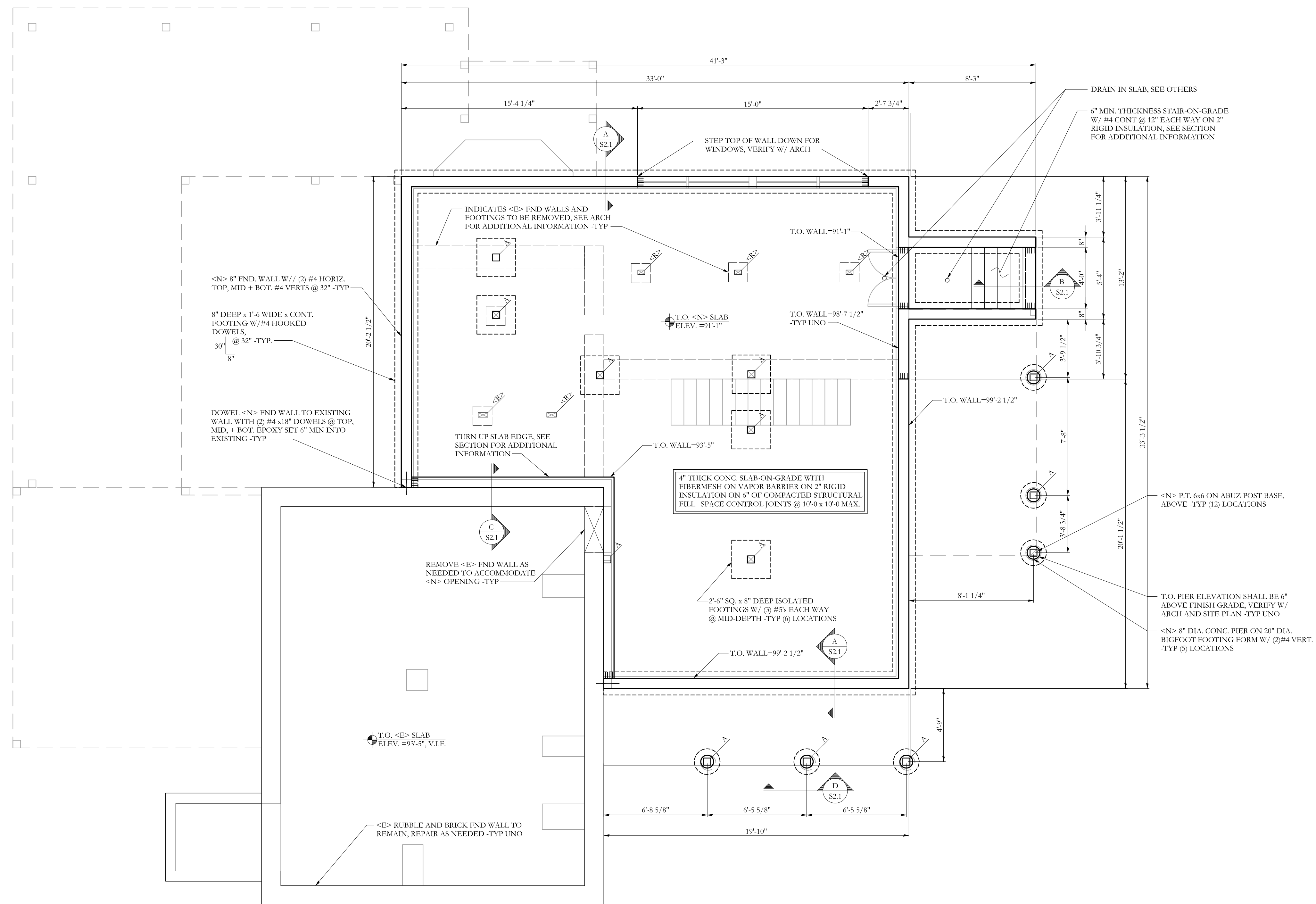

FOUNDATION PLAN

- NOTES: SCALE 1/4"=1'-0"
1. ALL FOOTINGS ARE 8" DEEP 1'-6" WIDE x CONT. WITH (2) #4 BARS LONGITUDINAL, UNO
 2. TOP OF FOOTING 4'-6" BELOW GRADE, MIN. AND ARE INDICATED THUS: (XX'-XX")
 3. TOP OF WALL ELEV. = 100'-0", UNLESS INDICATED THUS: TW=XXX'-XX
 4. SEE S1.0 FOR STRUCTURAL GENERAL NOTES
 5. VERIFY ALL ALL CONDITIONS IN FIELD, CONTACT SI Inc. W/ ANY DISCREPANCIES
 6. STEP IN TOP OF FOOTING IS INDICATED THUS: , AND SHOWS LOWER FOOTING.
 7. STEP IN TOP OF FOUNDATION WALL IS INDICATED THUS: , AND SHOWS LOWER SIDE OF WALL.

