

RAILING DETAIL

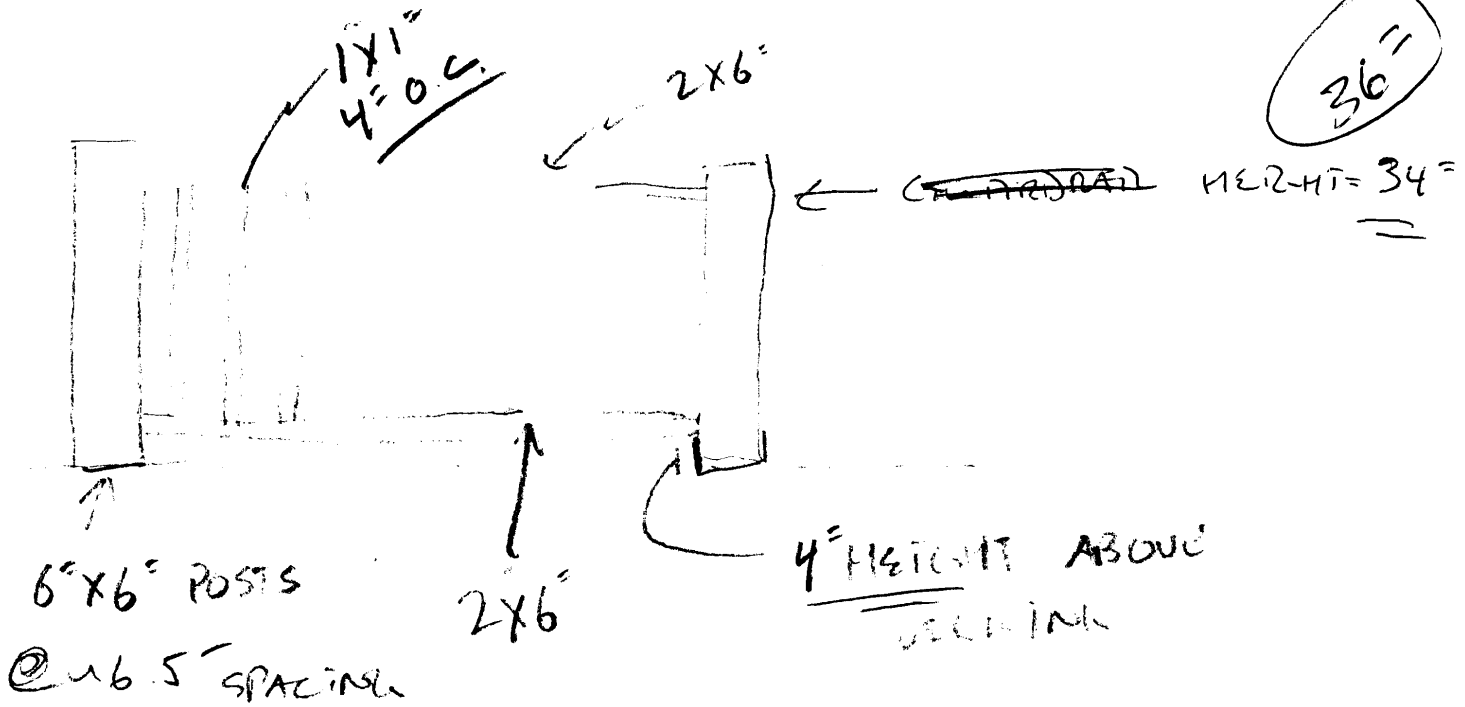

36"

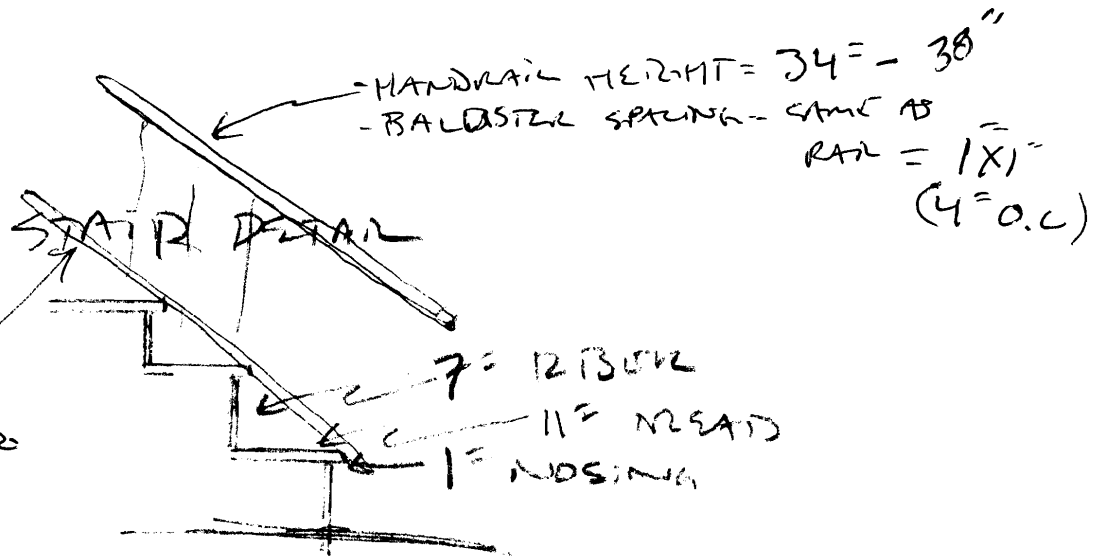

- STAIRS 4' 6" WIDE
- STRINGER AT 2'
- ∴ 4x



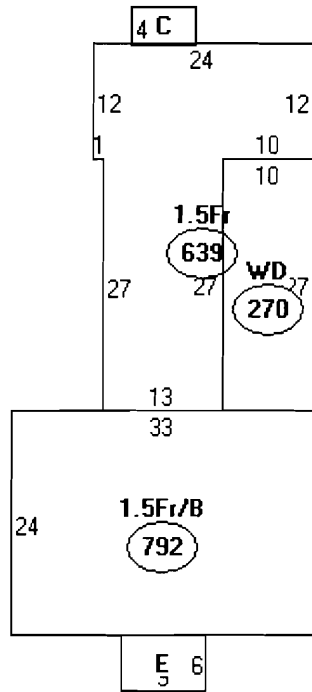

Descriptor/Area

A: 1.5Fr/B
792 sqft

B: 1.5Fr
639 sqft

C: WD
28 sqft

D: WD
270 sqft

~~E: WD
54 sqft~~

= 1729

perch 133

1862

This page contains a detailed description of the Parcel ID you selected. Press the **New Search** button at the bottom of the screen to submit a new query.

Current Owner Information

Card Number	1 of 1
Parcel ID	087 KK005001
Location	37 WILLOW ST
Land Use	SINGLE FAMILY
Owner Address	GREEN MARK & JEANNE GULNICK JTS 5 WILLOW ST PEAKS ISLAND ME 04108
Book/Page	22816/202
Legal	87-KK-5-6-7 WILLOW ST 37 PEAKS ISLAND 26356 SF

Current Assessed Valuation

Land	Building	Total
\$262,000	\$171,300	\$433,300

Property Information

Year Built 1890	Style Old Style	Story Height 1.5	Sq. Ft. 2504	Total Acres 0.605		
Bedrooms 4	Full Baths 1	Half Baths 1	Total Rooms 8	Attic None	Basement Full	

Outbuildings

Type	Quantity	Year Built	Size	Grade	Condition
-------------	-----------------	-------------------	-------------	--------------	------------------

Sales Information

Date	Type	Price	Book/Page
06/29/2005	LAND + BLDING	\$405,000	22816-202
06/18/1999	LAND + BLDING		14838-301

Picture and Sketch

<u>Picture</u>	<u>Sketch</u>	<u>Tax Map</u>
--------------------------------	-------------------------------	--------------------------------

[Click here](#) to view Tax Roll Information.

Any information concerning tax payments should be directed to the Treasury office at 874-8490 or e-mailed.

New Search!