

SUBSURFACE WASTEWATER DISPOSAL SYSTEM APPLICATION

Maine Department of Human Services
 Division of Health Engineering, Station 10 SHS
 (207) 287-5672 FAX (207) 287-4172

Town, City, Plantation
PORTLAND, PEAKS ISLAND

Street, Road, Subdivision
61 UPPER A STREET

Owner's Name
WILLIAM FLYNN

SUBSURFACE WASTEWATER DISPOSAL PLAN

SCALE 1" = 20' FT.

VERIFY WATERLINE LOCATION
 TO ASSURE MIN. 10' SETBACK
 FROM DISPOSAL SYSTEM

NEW 1000 GALLON CONCRETE
 SEPTIC TANK LOCATE
 WHERE FEASIBLE, 8' MIN.
 FROM BUILDING STRUCTURE
 SET AT HIGH ENOUGH ELEVATION
 TO PROVIDE GRAVITY FLOW
 OR PROVIDE PUMP STATION

APPROX. PROPERTY LINE (VERIFY
 TO ASSURE PROPER SETBACKS)

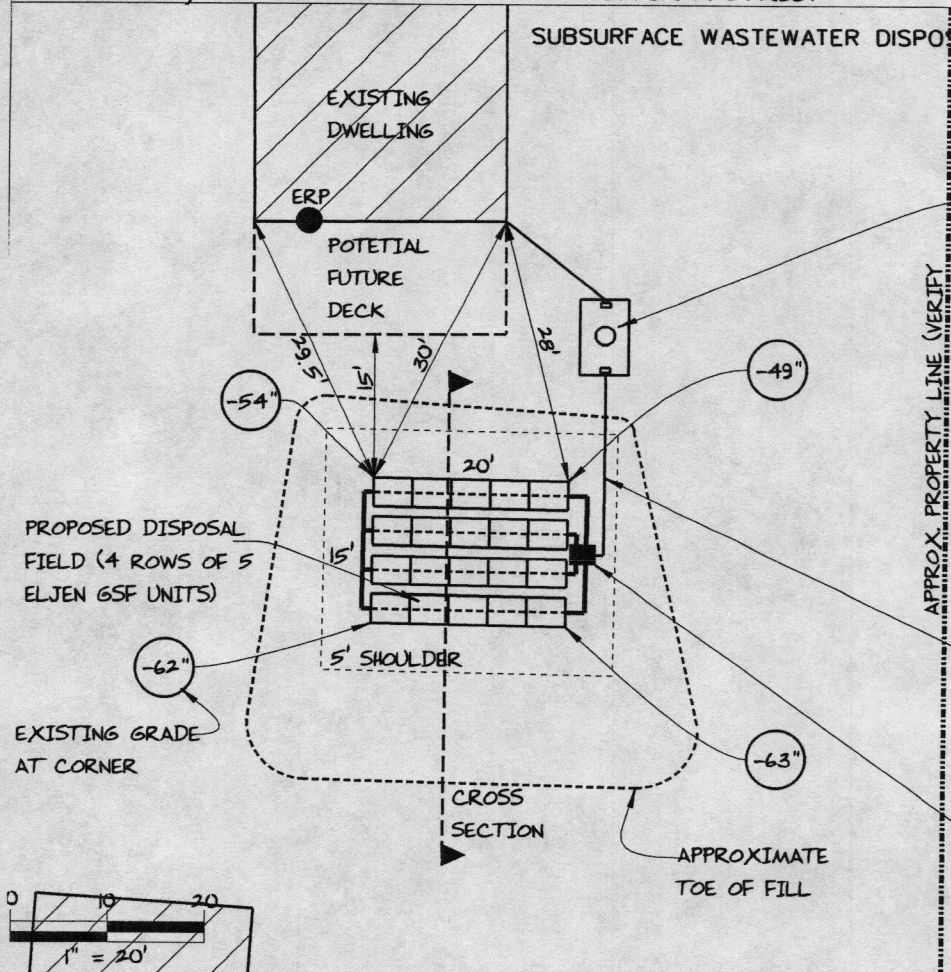

PROPOSED DISPOSAL
 FIELD (4 ROWS OF 5
 ELJEN GSF UNITS)

EXISTING GRADE
 AT CORNER

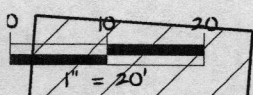

FILL REQUIREMENTS

Depth of Fill (Upslope) : $\frac{5''}{18''} - 10''$
 Depth of Fill (Downslope) : $\frac{18''}{19''} - 19''$
 DEPTHS AT CROSS-SECTION (shown below)

CONSTRUCTION ELEVATIONS

Finished Grade Elevation
 Top of Distribution Pipe or Proprietary Device
 Bottom of Disposal Area

ELEVATION REFERENCE POINT

SEE
 DETAIL
 BELOW
 Location & Description TOP OF
 ALUMINUM DOOR SILL, 34" ABOVE GRADE
 Reference Elevation is: 0.0" or -----

SCALE:
 VERTICAL: 1" = 5 FT
 HORIZONTAL: 1" = 10 FT

DISPOSAL AREA CROSS SECTION

REMOVE ALL PORTIONS OF EXISTING
 DISPOSAL AREA ENCOUNTERED TO A MINIMUM
 DEPTH OF 2' UNDERNEATH AND 5'
 ALONGSIDE DISPOSAL AREA AND REPLACE
 WITH CLEAN GRAVELLY COARSE SAND FILL

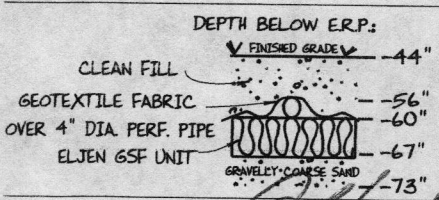
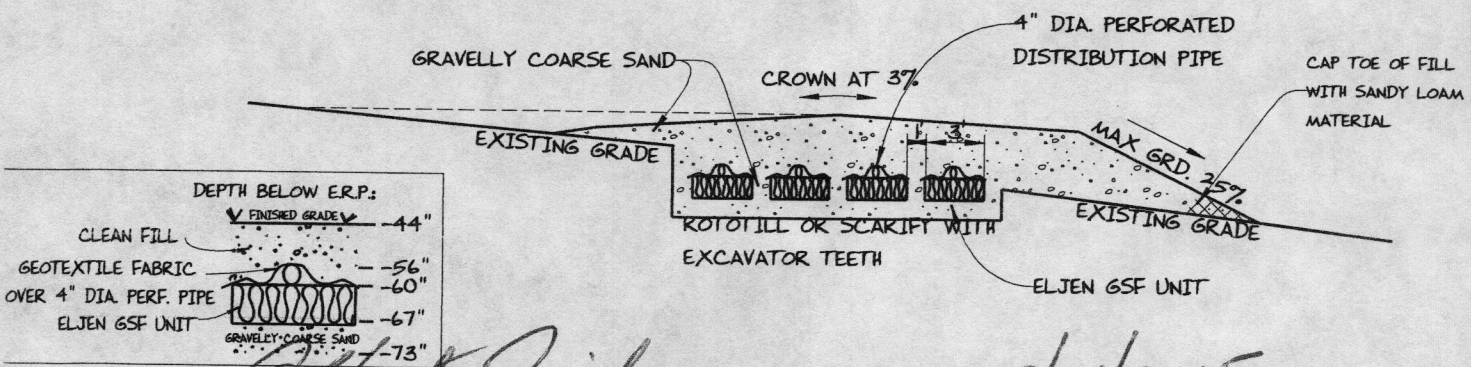
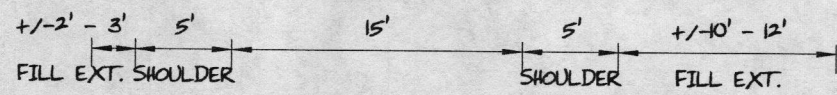

Albert Frick
 Site Evaluator Signature

163
 SE *

9/11/2015
 Date

Page 3 of 3
 HHE-200 Rev. 10/02