

Demolition Notes	
KEY	DESCRIPTION
1	Demolish Column
2	Demolish Wall
3	Demolish Window
4	Demolish Wall as Required for New Window Installation
5	Demolish Ceiling and Light Fixtures
6	Demolish Wall Finishes
7	Demolish Electric Panel Closet

REMOVE TWO PORCH ROOF COLUMNS FOR REPLACEMENT

REMOVE 2X4 FRAMED ENTRY PORCH ROOF, SHEATHING, ROOFING, AND FLASHING

NOTE: NO CHANGES ARE BEING MADE TO THE EXISTING PORCH FOUNDATION, FRAMING, RAILINGS, OR STAIRS. ONLY THE ROOF OVER THE PORCH AND THE TWO COLUMNS THAT SUPPORT THIS ROOF ARE BEING REPLACED BY THIS PROJECT

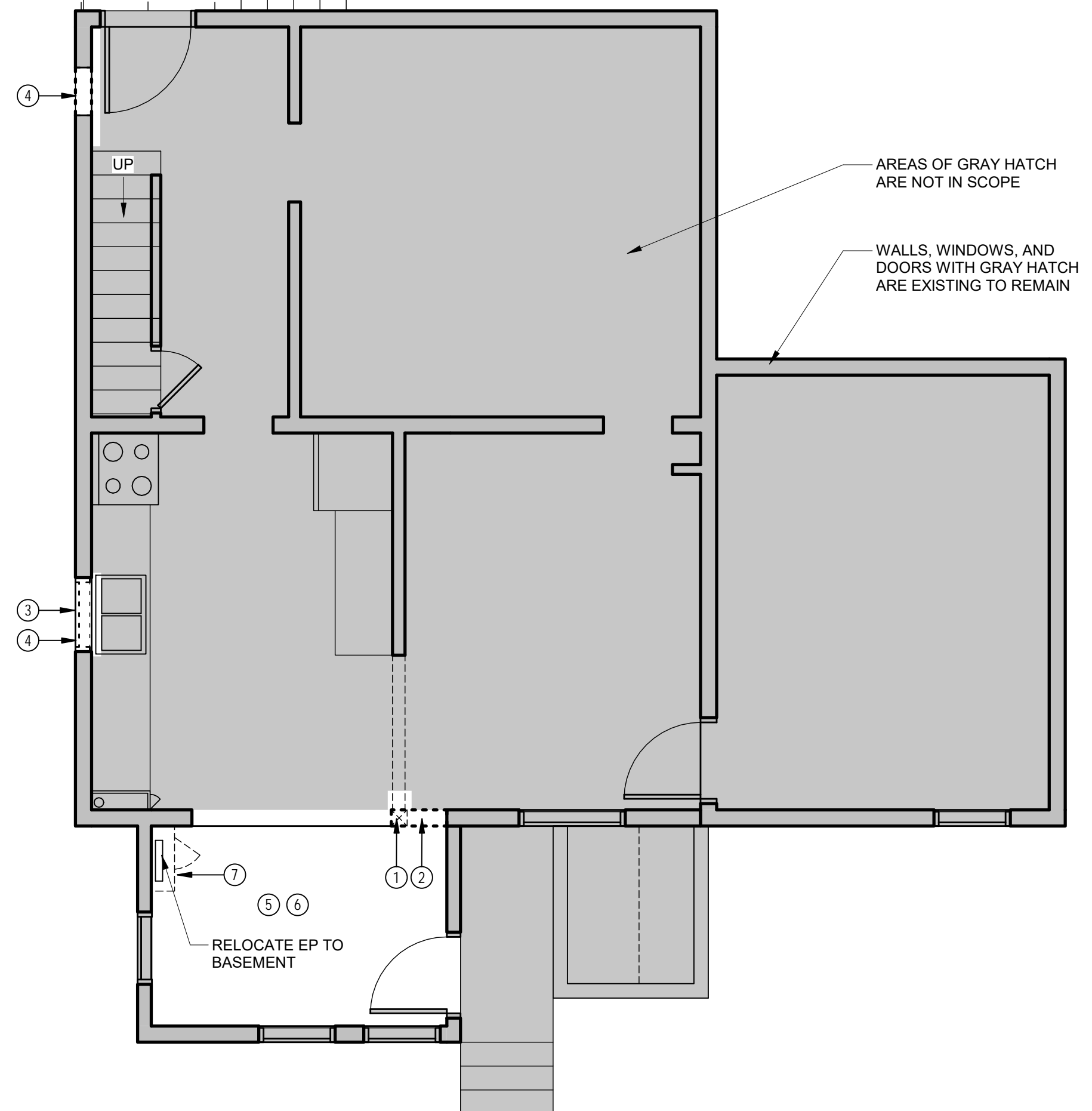

1 First Floor - Demolition Plan  
1/4" = 1'-0"

PERMIT DRAWINGS

38 Lower A  
Peaks Island, Maine 04108

DATE:  
JUNE 29, 2017

SCALE:  
1/4" = 1'-0"

TITLE  
Demolition Floor Plan and Notes

A2