

Map

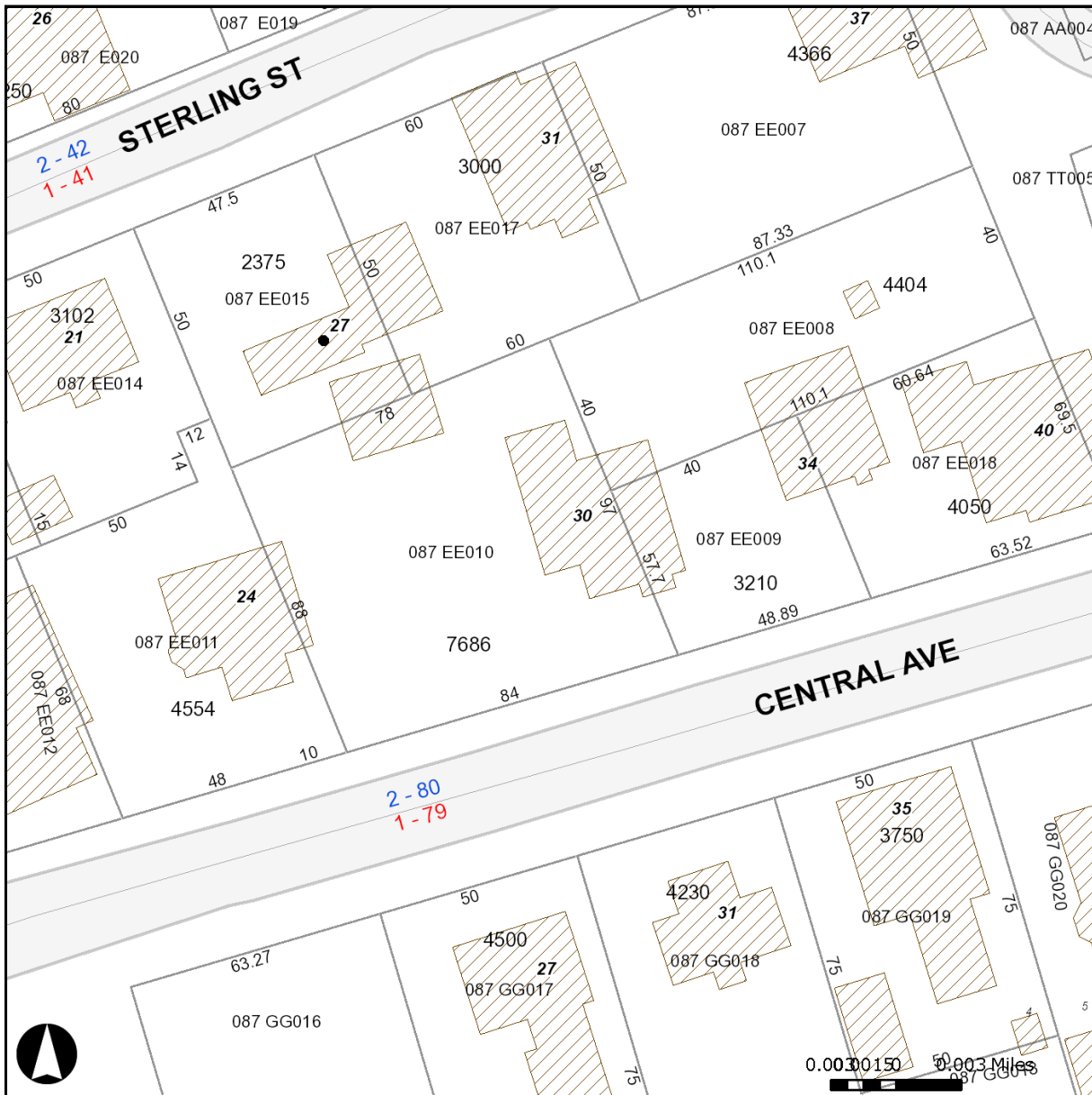

- | | | | |
|---------------------------------------|--------------------------------------|--------------------------------|-----------|
| Interstate
 | Traveled Ways
 | Jetport
 | Ocean
 |
| Streets
 | Stream
 | County Streets
 | |
| Buildings
Building
Out Building | Wetland
swamp | A15

A21

A31
 | |
| Parcels
 | Lake/Pond
under_road
waterbody | ME Towns
Land
Water Body | |

PLEASE SCAN
into "G" Drive

Assessor's Office | 389 Congress Street | Portland, Maine 04101 | Room 115 | (207) 874-8486

City Home Departments City Council E-Services Calendar Jobs

This page contains a detailed description of the Parcel ID you selected. Press the **New Search** button at the bottom of the screen to submit a new query.

Current Owner Information:

Services

Applications

Doing Business

Maps

Tax Relief

Tax Roll

Q & A

browse city services a-z

browse facts and links a-z

CBL	087 EE010001
Land Use Type	SINGLE FAMILY
Property Location	30 CENTRAL AVE
Owner Information	DARANYI EDUARDO G & ELLEN C MAHONEY JTS
	30 CENTRAL AVE PEAKS ISLAND ME 04108
Book and Page	16201/018
Legal Description	87-EE-10 CENTRAL AVE 30 PEAKS ISLAND 7886 SF
Acres	0.181

087-EE-010

IR-2 Zone

Current Assessed Valuation:

TAX ACCT NO.	13828	OWNER OF RECORD AS OF APRIL 2010 DARANYI EDUARDO G & ELLEN C MAHONEY JTS 30 CENTRAL AVE PEAKS ISLAND ME 04108
LAND VALUE	\$172,000.00	
BUILDING VALUE	\$199,900.00	
HOMESTEAD EXEMPTION	(\$10,000.00)	
NET TAXABLE - REAL ESTATE	\$361,900.00	
TAX AMOUNT	\$6,485.26	

Any information concerning tax payments should be directed to the Treasury office at 874-8490 or e-mailed.



Building Information:

Card 1 of 2

Year Built	1889
Style/Structure Type	OLD STYLE
# Stories	2
Bedrooms	4
Full Baths	2
Half Baths	1
Total Rooms	7
Attic	UNFIN
Basement	FULL
Square Feet	1976



[View Sketch](#) [View Map](#) [View Picture](#)

Card 2 of 2

Year Built	1920
Style/Structure Type	COTTAGE
# Stories	1.5
Bedrooms	2
Full Baths	1
Total Rooms	4
Attic	NONE
Basement	CRAWL
Square Feet	682



[View Sketch](#) [View Map](#) [View Picture](#)

Sales Information:

Sale Date	Type	Price	Book/Page
4/17/2001	LAND + BUILDING	\$0.00	16201/18
7/21/1999	LAND + BUILDING	\$125,900.00	14922/192

[New Search!](#)

REAL ESTATE ASSESSMENT RECORD - CITY OF PORTLAND, MAINE

CURR. DESC.	LAND NOS.	STREET	ELDG. NO.	CARD NO.	DEVELOPMENT NO.	AREA	DIST.	ZONE	CHART	BLOCK	LOT	CURR. DESC.
		Peaks Island Central Ave		1 OF 2		6475	4		87	EE	10	

TAXPAYER ADDRESS AND DESCRIPTION

HOFFMAN IRVING SOULE & FLORENCE
CENTRAL AVENUE PEAKS ISLAND ME
LAND & BLDGS CENTRAL AVE PEAKS
ISLAND PORTLAND MAINE
ASSESSORS PLAN 87-EE-10
AREA 6475 SQ FT

RECORD OF TAXPAYER			YEAR	BOOK	PAGE
Grey, Rec. 6, 77 - Adm. of Veh. App. 1952			1952	2124	154

PROPERTY FACTORS			
TOPOGRAPHY		IMPROVEMENTS	
LEVEL	<input checked="" type="checkbox"/>	WATER	<input type="checkbox"/>
HIGH	<input type="checkbox"/>	SEWER	<input type="checkbox"/>
LOW	<input type="checkbox"/>	GAS	<input type="checkbox"/>
ROLLING	<input type="checkbox"/>	ELECTRICITY	<input type="checkbox"/>
SWAMPY	<input type="checkbox"/>	ALL UTILITIES	<input type="checkbox"/>
STREET		TREND OF DISTRICT	
PAVED	<input checked="" type="checkbox"/>	IMPROVING	<input type="checkbox"/>
SEMI-IMPROVED	<input type="checkbox"/>	STATIC	<input type="checkbox"/>
DIRT	<input type="checkbox"/>	DECLINING	<input type="checkbox"/>
SIDEWALK	<input checked="" type="checkbox"/>		
TILLABLE		PASTURE	
		WOODED	
		WASTE	

LAND VALUE COMPUTATIONS AND SUMMARY						
FRONTAGE	DEPTH	UNIT PRICE	DEPTH FACTOR	FRONT FT. PRICE	YEAR 1951	19
68	97.00	5.20	98	492	330	
TOTAL VALUE LAND					330	
TOTAL VALUE BUILDINGS					2660	
TOTAL VALUE LAND AND BUILDINGS					2990	
SQ. FT. TO-FROM CH.			BLK.	LOT		
SQ. FT. TO-FROM CH.			BLK.	LOT		

LAND VALUE COMPUTATIONS AND SUMMARY						
FRONTAGE	DEPTH	UNIT PRICE	DEPTH FACTOR	FRONT FT. PRICE	19	19
TOTAL VALUE LAND						
TOTAL VALUE BUILDINGS						
TOTAL VALUE LAND AND BUILDINGS						
SQ. FT. TO-FROM CH.			BLK.	LOT		
SQ. FT. TO-FROM CH.			BLK.	LOT		

LAND VALUE COMPUTATIONS AND SUMMARY						
FRONTAGE	DEPTH	UNIT PRICE	DEPTH FACTOR	FRONT FT. PRICE	19	19
TOTAL VALUE LAND						
TOTAL VALUE BUILDINGS						
TOTAL VALUE LAND AND BUILDINGS						
SQ. FT. TO-FROM CH.			BLK.	LOT		
SQ. FT. TO-FROM CH.			BLK.	LOT		

LAND VALUE COMPUTATIONS AND SUMMARY						
FRONTAGE	DEPTH	UNIT PRICE	DEPTH FACTOR	FRONT FT. PRICE	19	19
TOTAL VALUE LAND						
TOTAL VALUE BUILDINGS						
TOTAL VALUE LAND AND BUILDINGS						
SQ. FT. TO-FROM CH.			BLK.	LOT		
SQ. FT. TO-FROM CH.			BLK.	LOT		

YEAR	ORIG. COST	RENTAL
YEAR	SALE PRICE	EXPENSE
YEAR	U. S. R. S.	NET

ASSESSMENT RECORD			INCREASE	DECREASE
1950	LAND	250		
	BLDGS.	1575		
	TOTAL	1825		
1951	LAND	230		
	BLDGS.	1600		
	TOTAL	1800		
1952	LAND			
	BLDGS.			
	TOTAL			
1953	LAND			
	BLDGS.			
	TOTAL			
1954	LAND			
	BLDGS.			
	TOTAL			
1955	LAND			
	BLDGS.			
	TOTAL			
1956	LAND			
	BLDGS.			
	TOTAL			
1957	LAND			
	BLDGS.			
	TOTAL			
1958	LAND			
	BLDGS.			
	TOTAL			
1959	LAND			
	BLDGS.			
	TOTAL			
1960	LAND			
	BLDGS.			
	TOTAL			

Marge Schmuckal - Fwd: Re: 30 Central Ave - Peaks Island

From: Marge Schmuckal
To: Donald McPherson; Tammy Munson
Date: 3/3/2011 3:13 PM
Subject: Fwd: Re: 30 Central Ave - Peaks Island

Ok I'll check the files - there is nothing current in the "G" drive.
Marge

>>> Donald McPherson 3/3/2011 2:52 PM >>>
Marge,

087 EE010001

I don't know the lot lines but looking at the GIS it looks like it in on the line with three lots.

Don

>>> Marge Schmuckal 3/3/2011 2:11 PM >>>
what does that mean? A different address? Please verify the correct property with address or CBL.
thanks,
Marge

>>> Donald McPherson 3/3/2011 1:01 PM >>>
Marge,

OOPS Building is to the west

Don

>>> Tammy Munson 3/3/2011 12:52 PM >>>
Thanks Don. We will need zoning to verify the legal use of the property. I know Ann is out so I'm sure you are busy marge but can you help us? Don can assist if you need anything else.

>>> Donald McPherson 3/3/2011 12:48 PM >>>
Tammy,

I did the inspection today. Smoke detectors work, no visible plumbing or electrical violations, space is clean and warm (outside temp in the teens). The space is a detached building to the east of the main building.

FYI - In Urban I see "Nbr of Units 1"

Don

>>> Tammy Munson 3/1/2011 4:25 PM >>>
If he goes to the island and has time, he can inspect the unit.

>>> Deborah Hoar 3/1/2011 3:07 PM >>>
Hi there,

Would it be possible for Don to inspect 30 Central Ave (carriage house) this Thursday, March 3rd? You can