

2 Roof Drain Detail
3" = 1'-0"

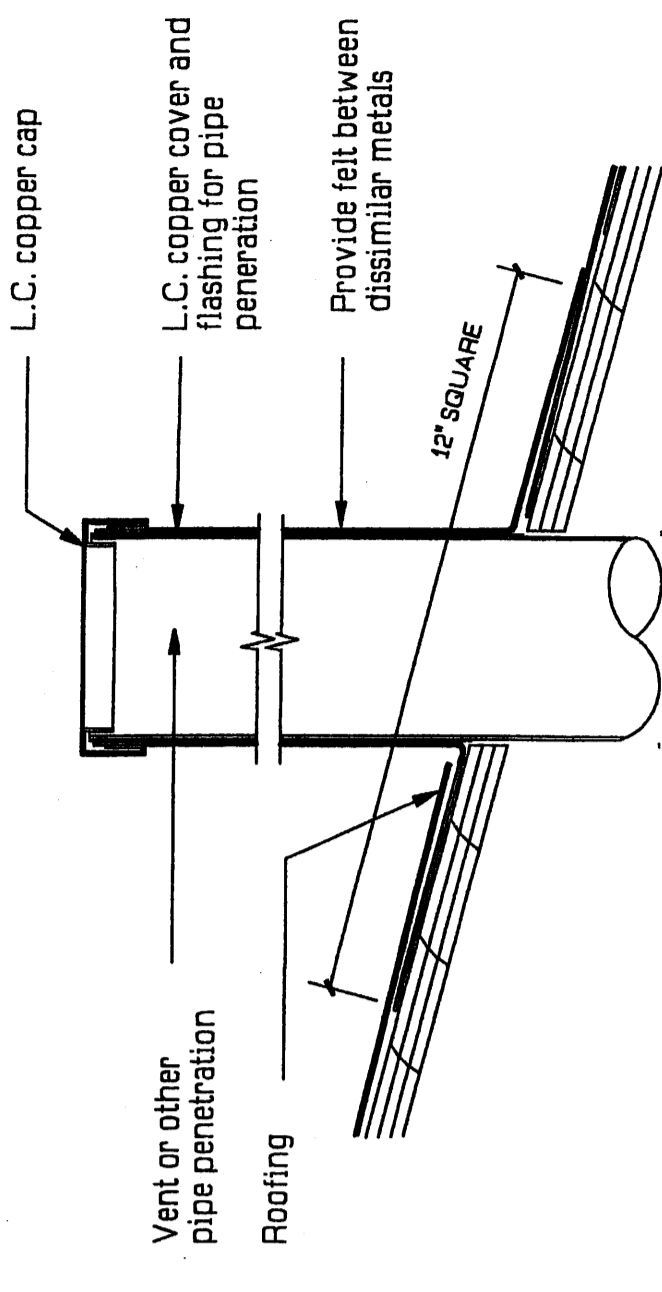

3 Pipe Penetration @ Sloped Roof
3" = 1'-0"

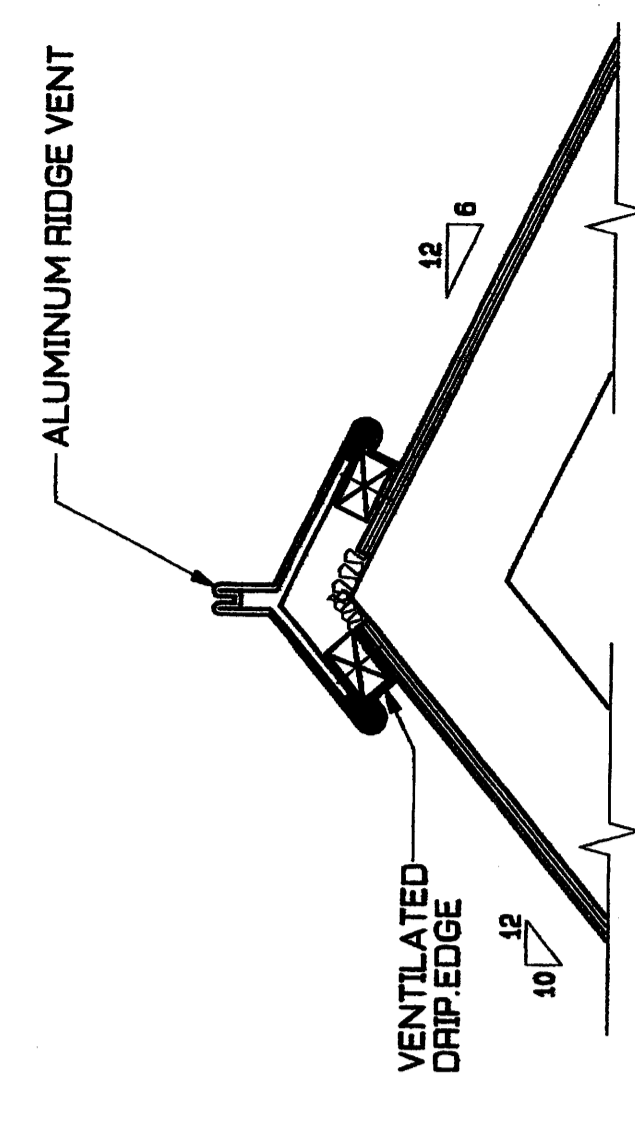

4 RIDGE VENT AT HEALTH CENTER
1 1/2" = 1'-0"

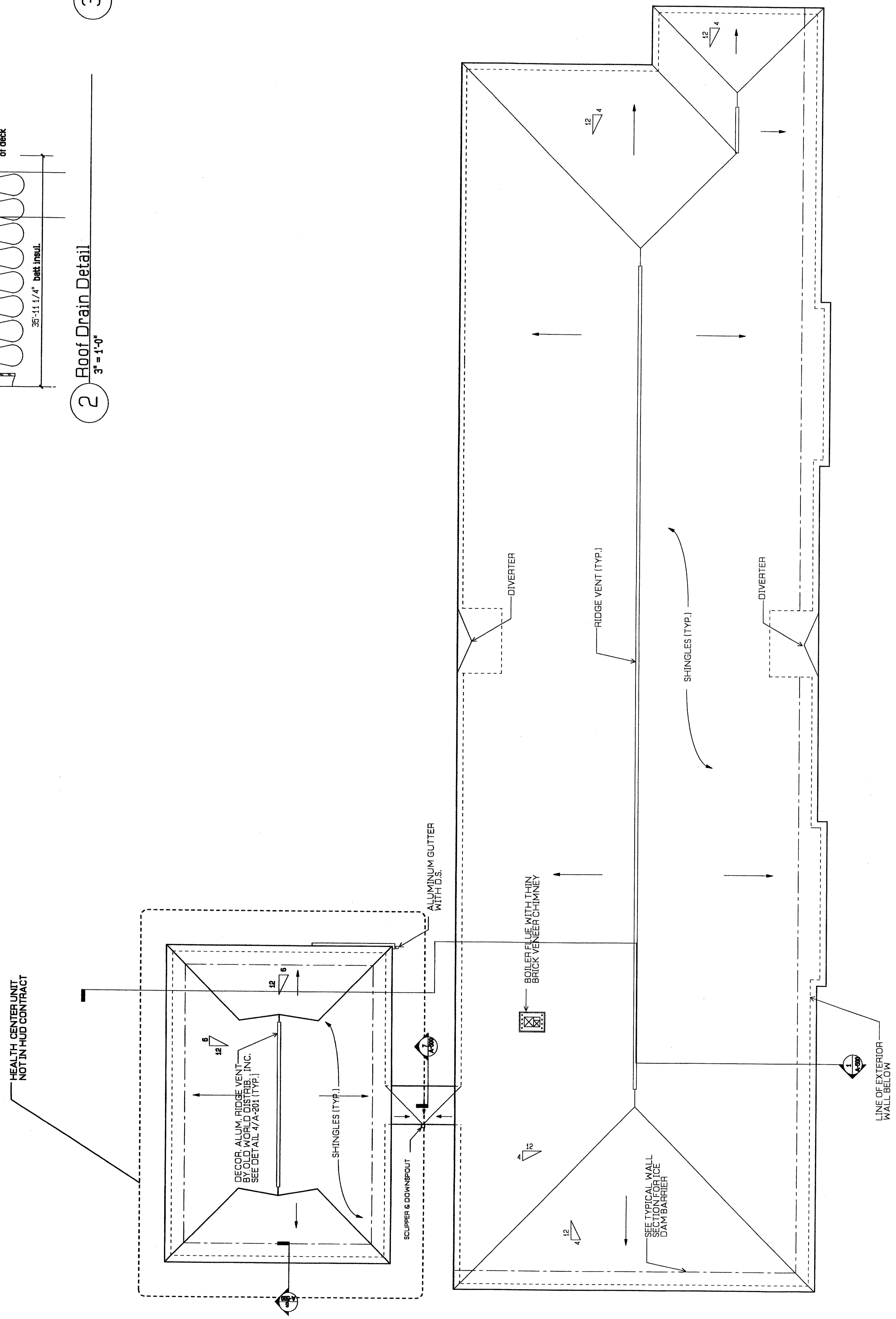

1 ROOF PLAN
SCALE 1/8" = 1'-0"

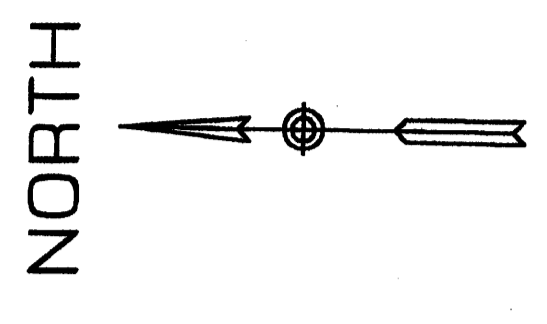

Revisions	No.	Date

Project: PEAKS ISLAND V.O.A.
SENIOR HOUSING FACILITY
& HEALTH CENTER
H.U.D. Project # 024-EE058
Central Avenue
Peaks Island, Maine

Drawing Title: ROOF PLAN

Echo Bridge Office Park
388 Elliot Street
Newton Upper Falls, MA 02464
Tsomides Associates Architects Planners
617 968-4774
Fax 617 968-4768
www.tsomides.com

STATE OF MAINE
REGISTERED ARCHITECT
TSOMIDES ASSOCIATES
ARCHITECTS PLANNERS
P.E. 583
DATE ISSUED 02/23/04
SCALE 1/8" = 1'-0" OR AS NOTED
DRAWING NUMBER
A-201