



Left Side

Left Side

□ Post

Hand Rails 32" ³⁶ From deck to Top of Rail

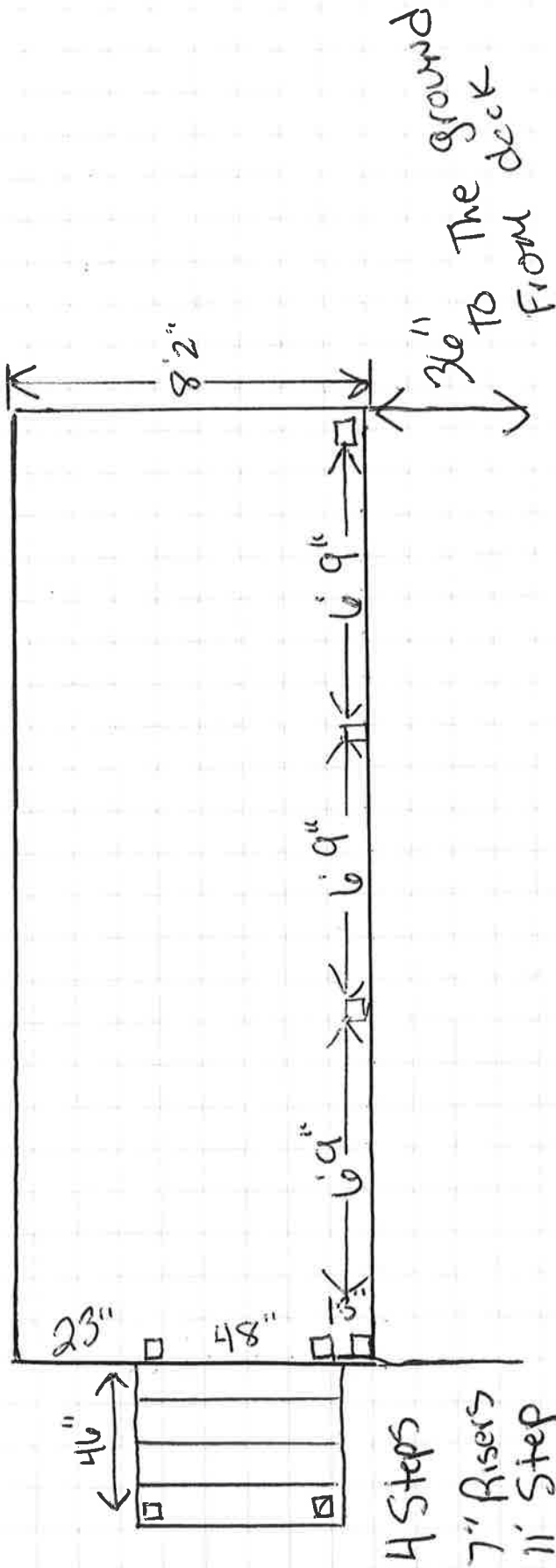



OPIS 14618
Right Side

Right Side ☒ Post 32" From Deck To Top of Railing
 36"

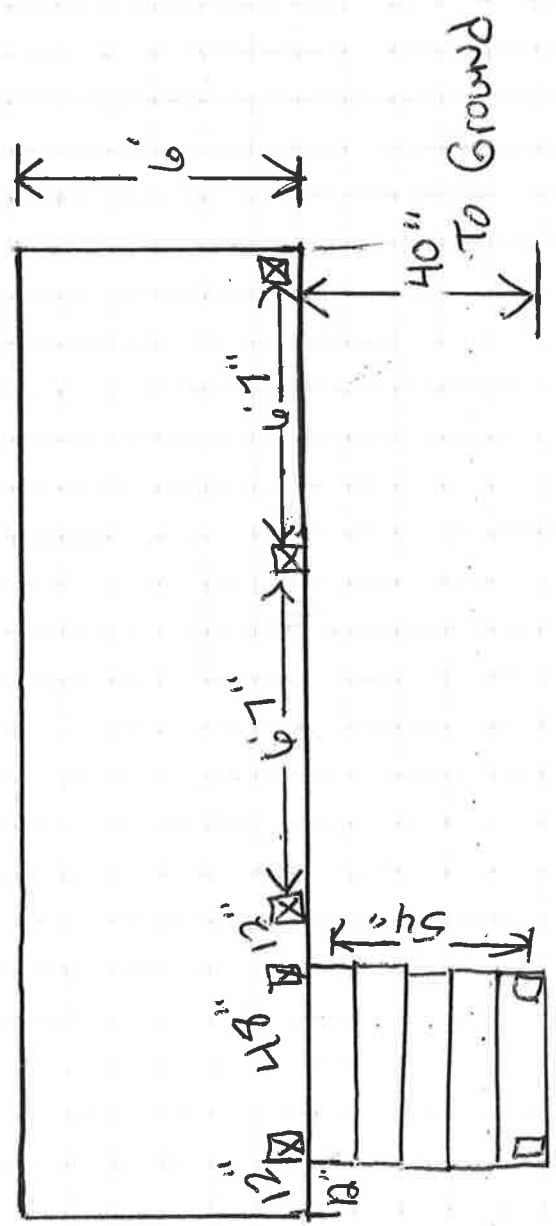

5 Steps
 7" Risers 11" Step

Middle Section
32" From Deck to Top of Handrail

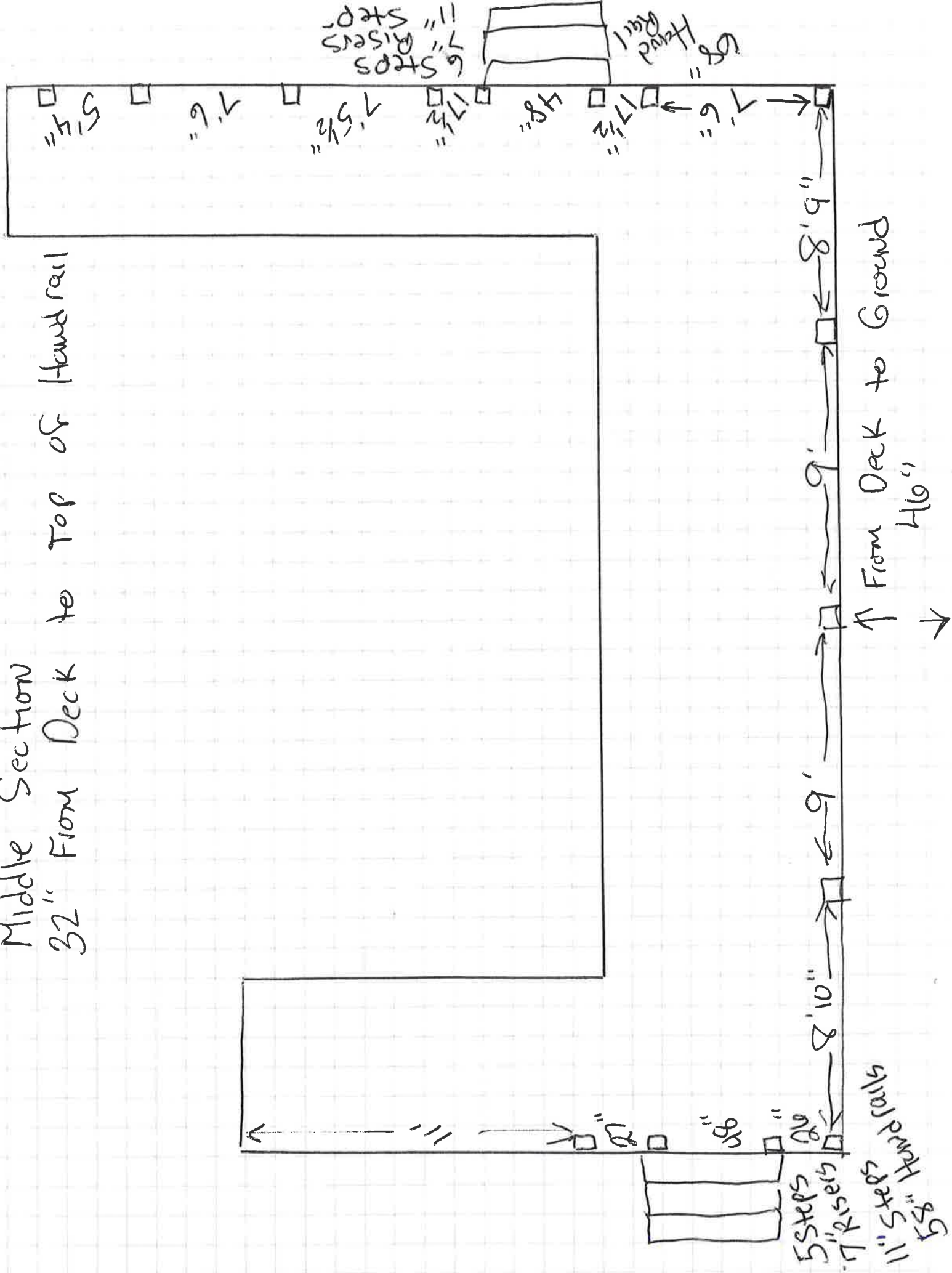

Middle Section
Over all

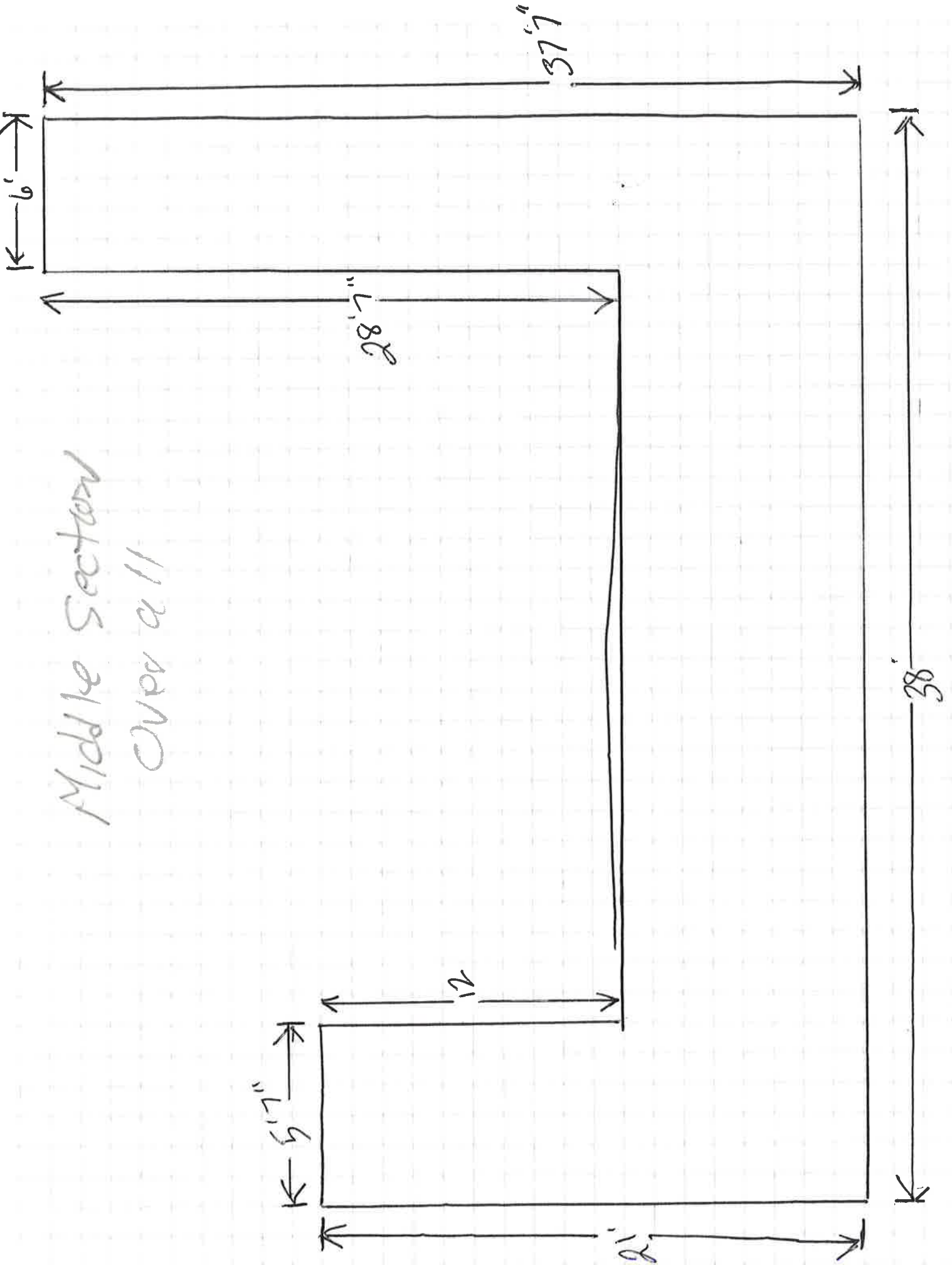

Middle Centred



Middle Right





Middle Left