

New footings:
 -12" pier on spread footing
 -Continuous center supports to structural ridge of new addition.

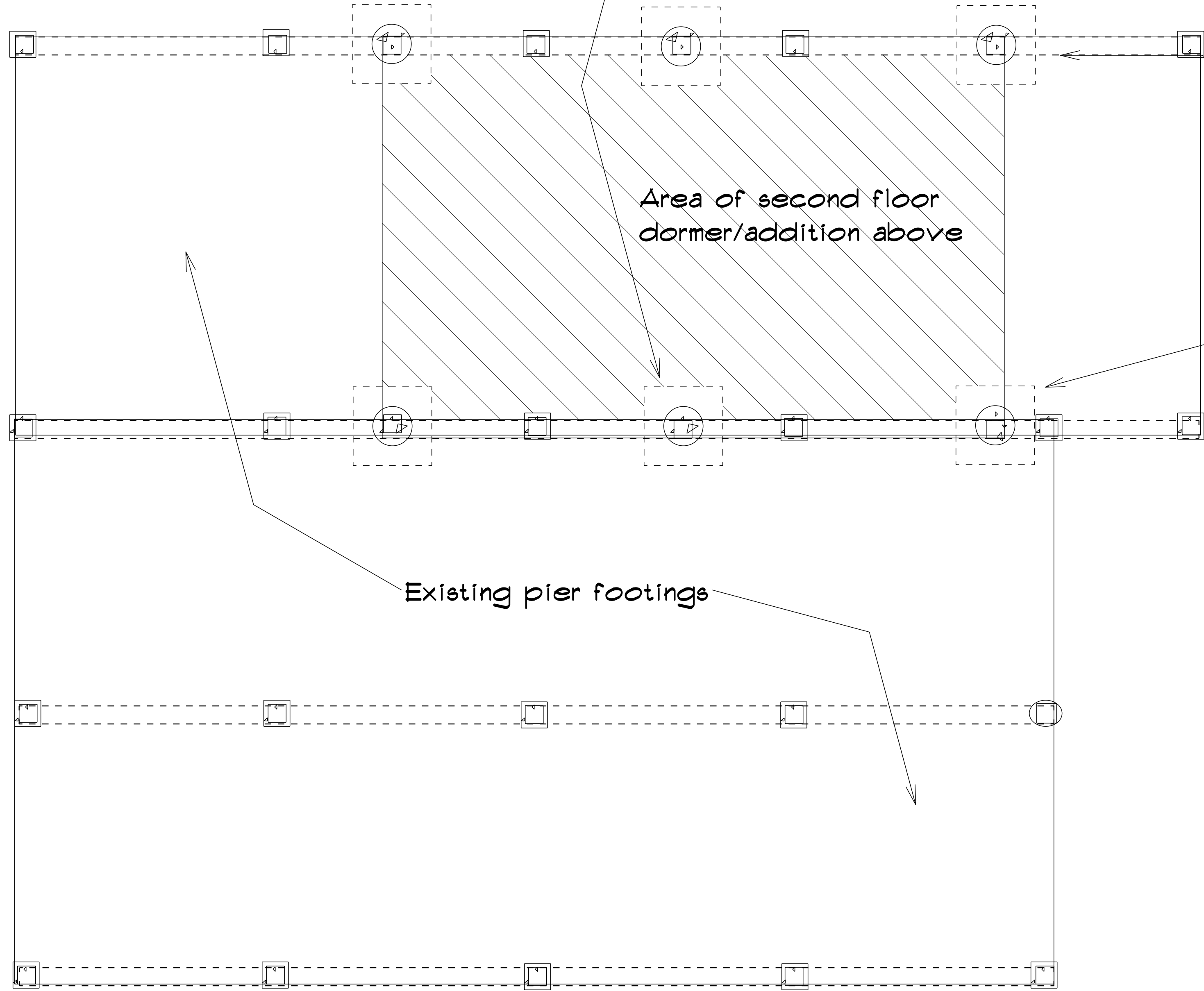
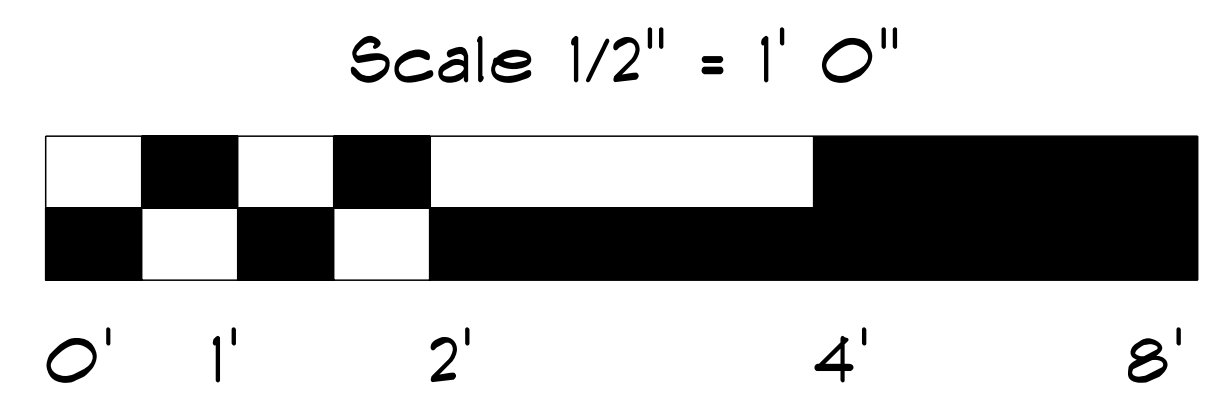

-New 12" pier footings to support second floor addition.
 -2' x 2' x 10" spread footing at base
 -Minimum of 48" below grade.

Notes:
 -12" round pier footings to spread footings at base.
 -Minimum 48" below grade.
 -Piers to be reinforced with 2 #4 rebar bent into spread footing.
 -6x6 P.T. post from pier to existing support beam above
 -Simpson posts base at all new pier to post connections
 -Simpson post-to-beam connectors at existing support beam

BASEMENT Pier System
 SCALE: 1/2" = 1'-0"

APPROVED: SECTION LETTER A	PAGE: S2/11
	CHECKED BY:
SCALE: 1/2" = 1'-0" DRAWN BY:	DATE: Thursday, November 2, 2017
Joe Lucey Carpentry Inc. 482 Walnut Hill Rd North Yarmouth ME 04097 PHONE: 207-671-4249 FAX: Joe@joeluceycarpentry.com	
Mark & Colleen Robison PHONE: FAX: Peaks Island, Portland ME 04101	