

**MAIN FLOOR**  
SCALE: 1/2" = 1'-0"

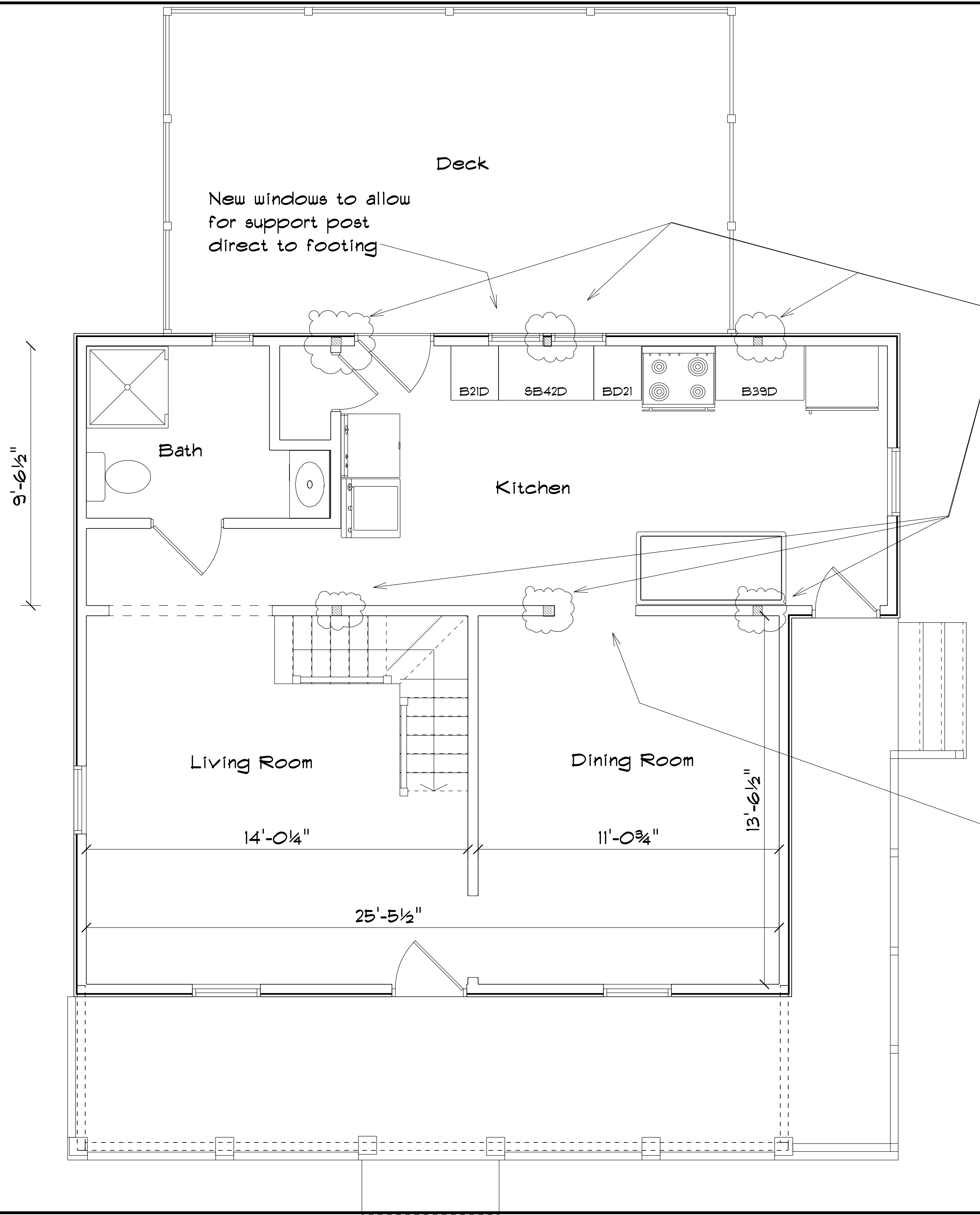

**Notes:**

- \*\*Roof at kitchen raised and switched to hip style.
- Helps provide break at new dormer.
- Entry door can stay at same location.
- Kitchen design TBD

Install 3 1/2" x 3 1/2" PSL posts at these point load locations to support new structure above

Shift DR door/opening to allow for direct support to footing below

