

FOOTPRINT CALCULATIONS:	
EXISTING HOUSE:	441 SF
EXISTING COVERED PORCH:	400 SF
EXISTING BACK DECK AND (2) STAIRS:	100 SF
EXISTING SHED:	57 SF
EXISTING FRONT STAIRS:	51 SF
EXISTING SIDE STAIRS:	8 SF
TOTAL EXISTING FOOTPRINT (NO CHANGE):	1057 SF
FLOOR AREA CALCULATIONS:	
EXISTING FIRST FLOOR:	775 SF
EXISTING SECOND FLOOR:	405 SF
EXISTING THIRD FLOOR:	192 SF
TOTAL EXISTING FLOOR AREA (NO CHANGE):	1372 SF
INTERIOR VOLUME CALCULATIONS:	
EXISTING FIRST FLOOR VOLUME:	3240 SF
EXISTING SECOND FLOOR VOLUME:	3206 SF
EXISTING THIRD FLOOR VOLUME:	1608 SF
TOTAL EXISTING INTERIOR VOLUME:	8054 SF
PROPOSED ENCLOSED PORCH VOLUME:	759 SF
TOTAL PROPOSED INTERIOR VOLUME:	8813 SF
	(9.4% INCREASE)

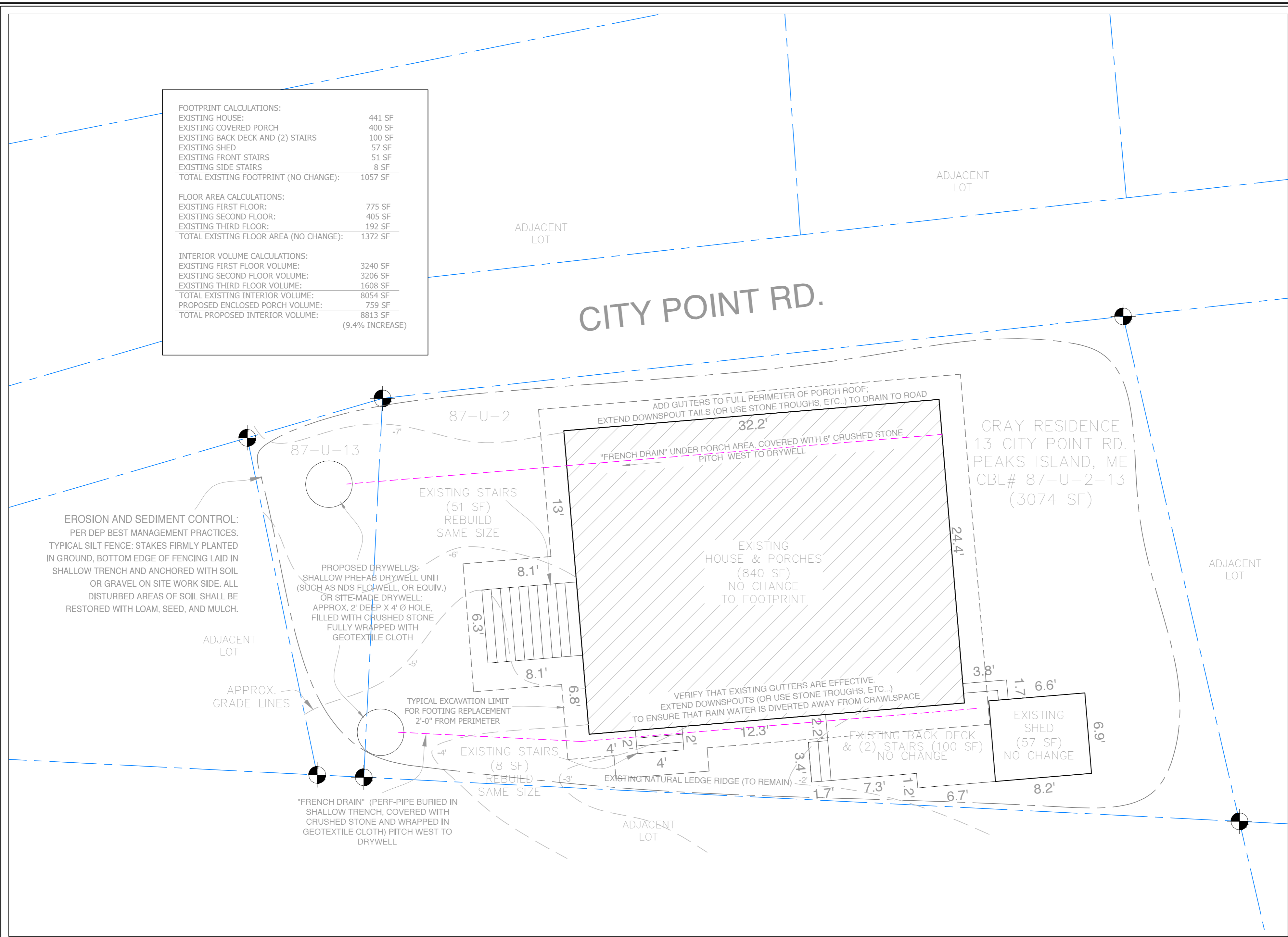

**Rachel Conly**  
 Architectural Design  
 26 Sterling Street  
 Peaks Island, Maine 04108  
 207.766.5625

NOTES	
DATE	REVISION
2015.10.14	REVISED
2016.03.16	REVISED DRAINAGE PLAN

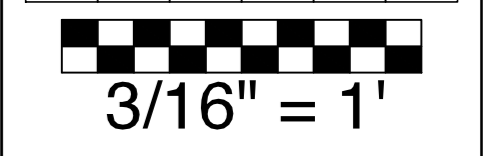

**Gray Residence**  
 13 City Point Rd.  
 Peaks Island, ME  
 04108

**A** Site Plan

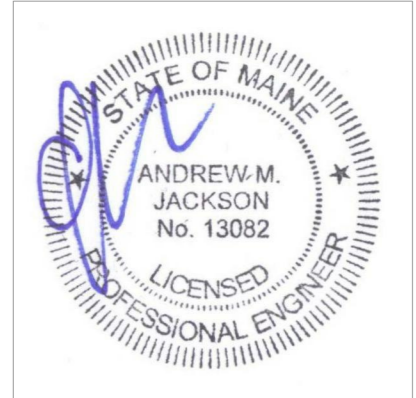
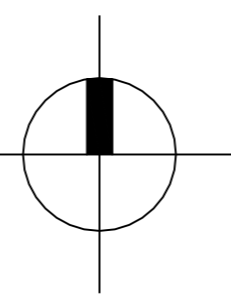

**A2**  
 Site Plan