

FOOTPRINT CALCULATIONS:	
EXISTING HOUSE:	441 SF
EXISTING COVERED PORCH:	400 SF
EXISTING BACK DECK AND (2) STAIRS:	100 SF
EXISTING SHED:	57 SF
EXISTING FRONT STAIRS:	51 SF
EXISTING SIDE STAIRS:	8 SF
TOTAL EXISTING FOOTPRINT (NO CHANGE):	1057 SF
FLOOR AREA CALCULATIONS:	
EXISTING FIRST FLOOR:	775 SF
EXISTING SECOND FLOOR:	405 SF
EXISTING THIRD FLOOR:	192 SF
TOTAL EXISTING FLOOR AREA (NO CHANGE):	1372 SF
INTERIOR VOLUME CALCULATIONS:	
EXISTING FIRST FLOOR VOLUME:	3240 SF
EXISTING SECOND FLOOR VOLUME:	3206 SF
EXISTING THIRD FLOOR VOLUME:	1608 SF
TOTAL EXISTING INTERIOR VOLUME:	8054 SF
PROPOSED ENCLOSED PORCH VOLUME:	759 SF
TOTAL PROPOSED INTERIOR VOLUME:	8813 SF
	(9.4% INCREASE)

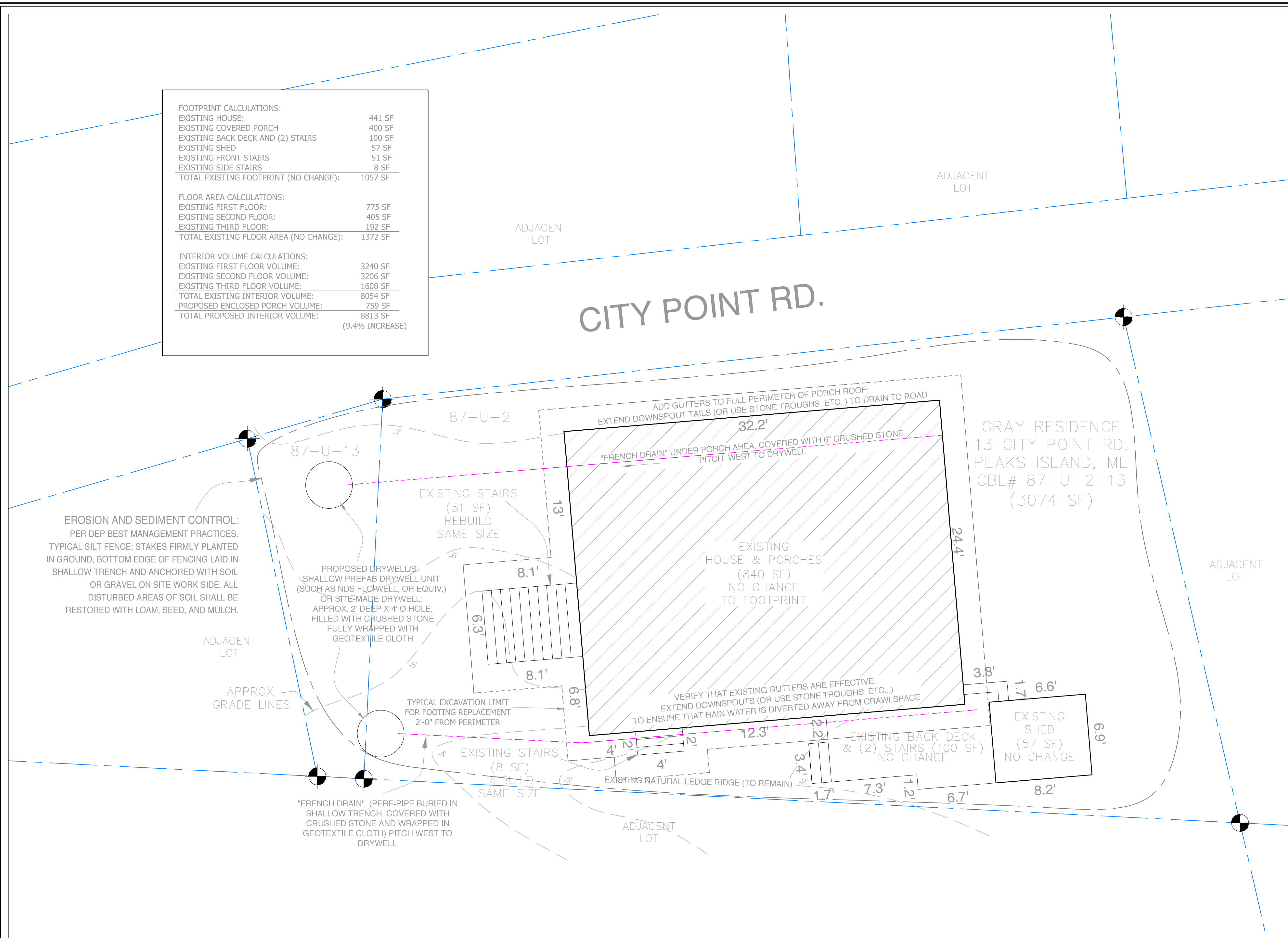

Rachel Conly
Architectural Design
26 Sterling Street
Peaks Island, Maine 04108
207.766.5625

NOTES	
DATE	REVISION
2015.10.14	REVISED
2016.03.16	REVISED DRAINAGE PLAN

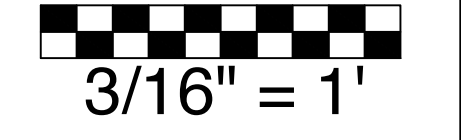

Gray Residence
13 City Point Rd.
Peaks Island, ME
04108

A Site Plan

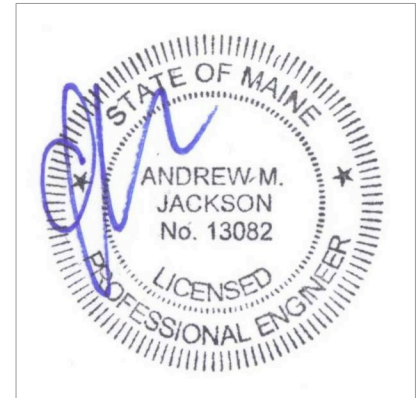
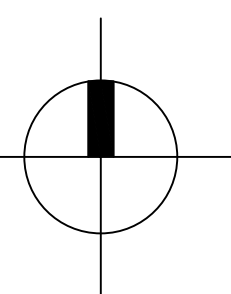

A2
Site Plan