

CENTENNIAL ST.

CITY POINT RD.

KONZAL RESIDENCE  
5 CITY POINT RD.  
PEAKS ISLAND, ME  
CBL# 87-U-1-5  
(39009 SF)

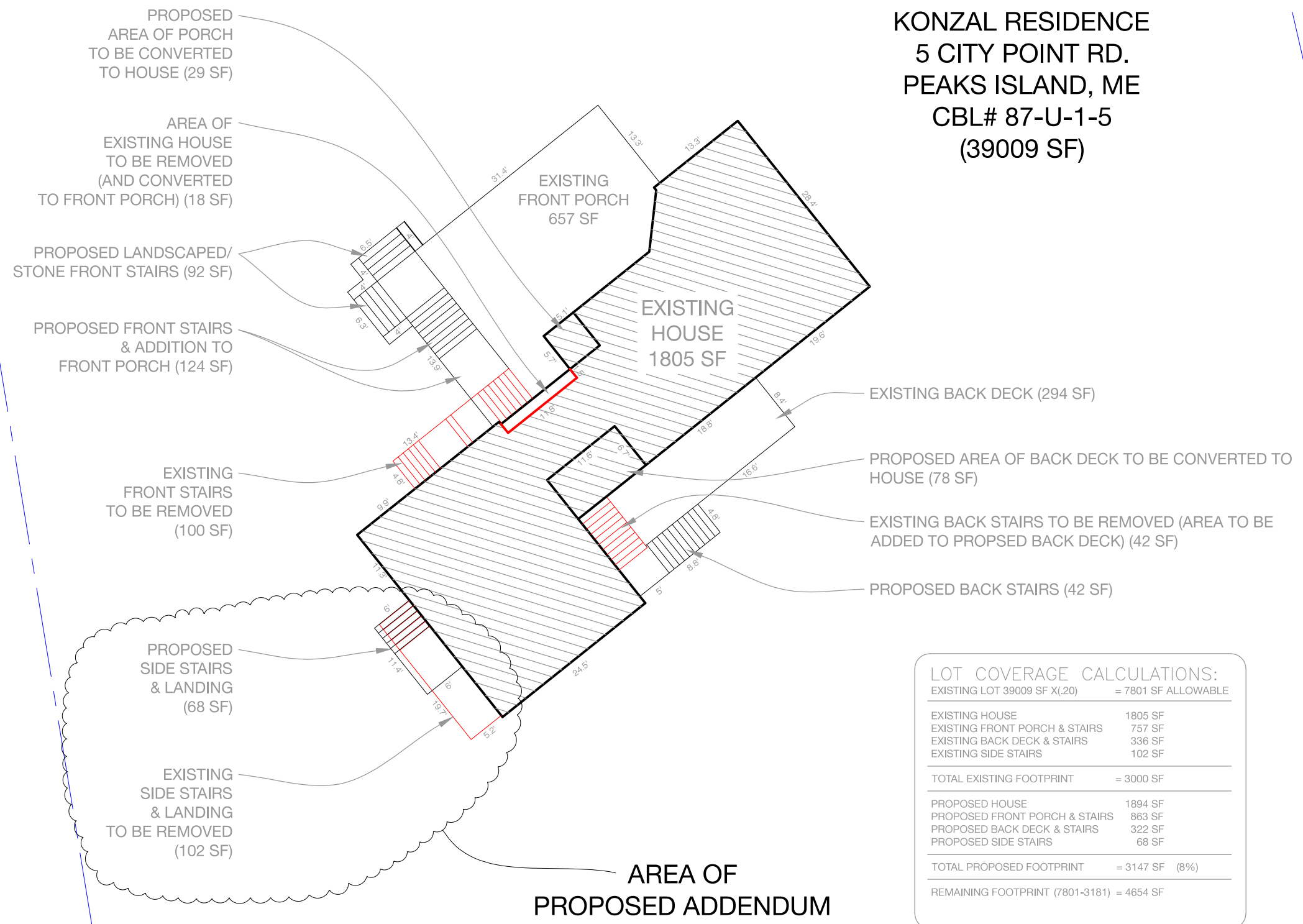

LOT COVERAGE CALCULATIONS:

EXISTING LOT 39009 SF X(.20)	= 7801 SF ALLOWABLE
EXISTING HOUSE	1805 SF
EXISTING FRONT PORCH & STAIRS	757 SF
EXISTING BACK DECK & STAIRS	336 SF
EXISTING SIDE STAIRS	102 SF
TOTAL EXISTING FOOTPRINT	= 3000 SF
PROPOSED HOUSE	1894 SF
PROPOSED FRONT PORCH & STAIRS	863 SF
PROPOSED BACK DECK & STAIRS	332 SF
PROPOSED SIDE STAIRS	68 SF
TOTAL PROPOSED FOOTPRINT	= 3147 SF (8%)
REMAINING FOOTPRINT (7801-3181)	= 4654 SF

Rachel Conly Design LLC  
26 Sterling Street  
Peaks Island, Maine 04108  
207.766.5625

DATE	NOTES
2015.10.28	
2016.05.12	Rebuild side entrance stairs and deck

PROJECT  
**Konzal Residence**  
5 City Point Rd.  
Peaks Island, ME  
04108

**A** Proposed Site Plan

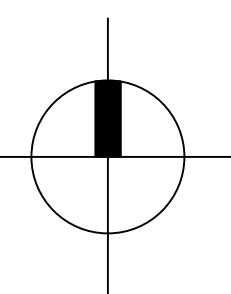

1/16" = 1'

**A2**

Site Plan