

RESIDENCE  
 JIM GREENWELL & EMILY MAGAL  
 130 ISLAND AVENUE  
 PEAKS ISLAND, MAINE 04108

JAMES W. GREENWELL, AIA, PLLC  
 ARCHITECT

158 ISLAND AVENUE  
 PEAKS ISLAND, ME 04108

VOICE 207-766-2509  
 CELL 202-607-8976

professional seal

**Structural Integrity**  
 Consulting Engineers, Inc.

77 Oak Street  
 Portland, ME, 04101  
 p. 207-774-4614  
 f. 866-793-7835  
 www.structuralinteg.com

**BUILD WITH CONFIDENCE**  
 © 2011 Structural Integrity Consulting Engineers, Inc.  
 SI# 11-0072

consultants

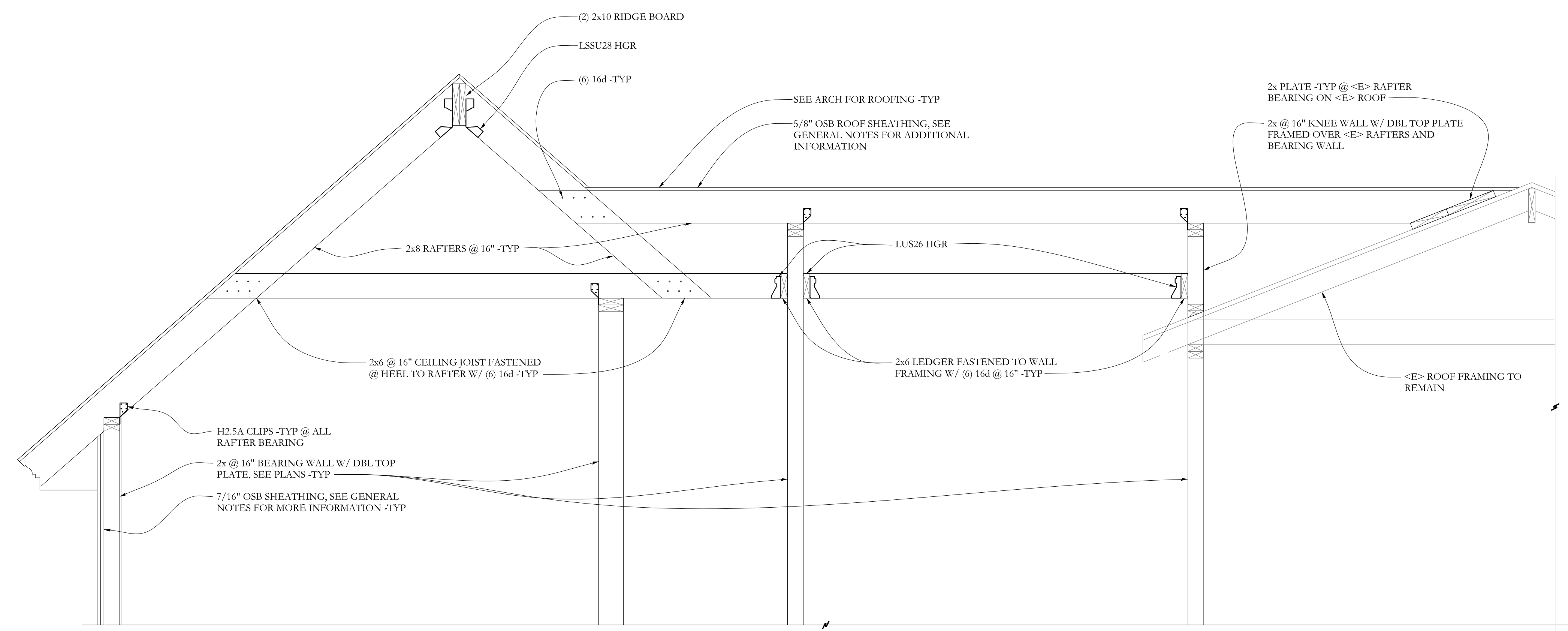

SECTION K  
S2.2 3/4"=1'-0"

ISSUE	DATE
PERMIT	09.7.2011
STRUCTURAL ENGINEERING	08.12.2011
ZONING REVIEW	07.20.2011

DATE: 09.07.2011  
 SCALE: 3/4" = 1'-0"

SECTIONS

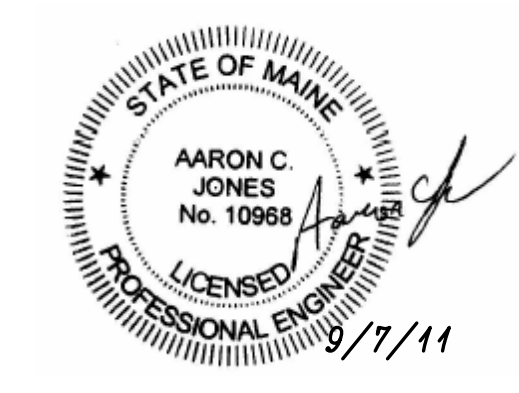

**S 2.2**