

RESIDENCE
 JIM GREENWELL & EMILY MAGAL
 130 ISLAND AVENUE
 PEAKS ISLAND, MAINE 04108

JAMES W. GREENWELL, AIA, PLLC
 ARCHITECT
 158 ISLAND AVENUE
 PEAKS ISLAND, ME 04108
 VOICE 207-766-2509
 CELL 202-607-8976

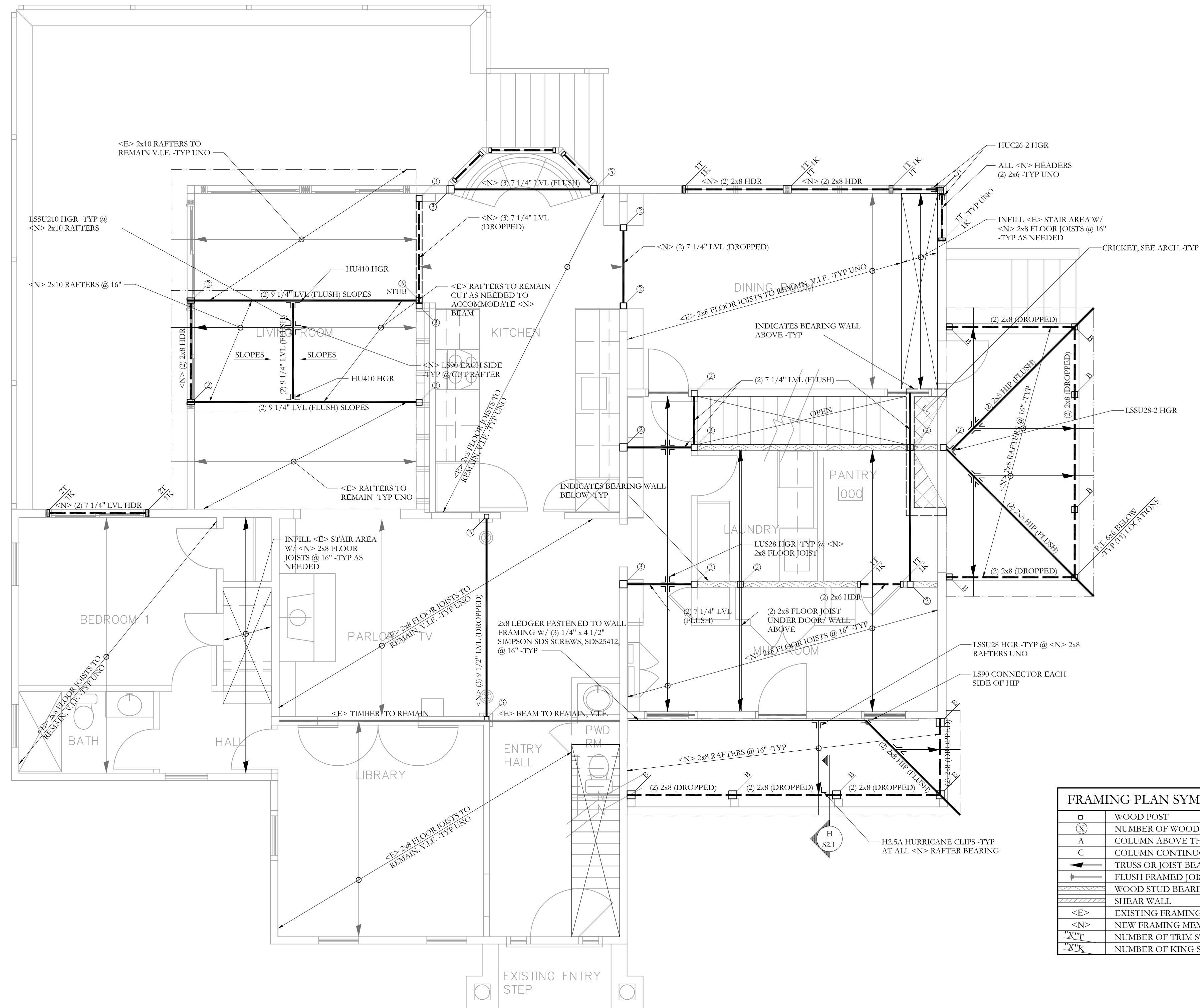

FRAMING PLAN SYMBOLS KEY	
□	WOOD POST
⊗	NUMBER OF WOOD STUDS IN POST BELOW
A	COLUMN ABOVE THIS LEVEL
C	COLUMN CONTINUOUS THROUGH THIS LEVEL
—	TRUSS OR JOIST BEARING
—	FLUSH FRAMED JOIST BEARING WITH HANGER
—	WOOD STUD BEARING WALL BELOW
—	SHEAR WALL
<E>	EXISTING FRAMING MEMBER
<N>	NEW FRAMING MEMBER
1/4" T	NUMBER OF TRIM STUDS UNDER HEADER
1/4" K	NUMBER OF KING STUDS ADJACENT TO HEADER

UPPER LEVEL/ LOW ROOF FRAMING PLAN
 NOTES: SCALE 1/4"=1'-0"
 1. FLOOR DECK SHALL BE 3/4" T&G SHEATHING, SEE GENERAL NOTES FOR ADDITIONAL INFO
 2. ALL WOOD COLUMNS IN 2x6 WALLS SHALL BE 3-2x6 AND IN 2x4 WALLS SHALL BE 3-2x4 UNLESS NOTED OTHERWISE ON PLANS
 3. ALL BEAMS ARE FLUSH, UNO
 4. ALL <N> FLOOR JOISTS TO BE 2x8 @ 16" -TYP UNO
 5. SEE SHEET S1.0 FOR GENERAL STRUCTURAL NOTES
 6. ALL HEADERS ARE 3-2x6, UNO
 7. VERIFY ALL ALL CONDITIONS IN FIELD, CONTACT SI Inc. W/ ANY DISCREPANCIES

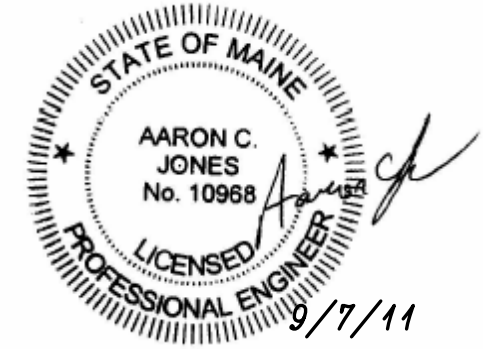

S 1.3

ISSUE	DATE
PERMIT	09.7.2011
STRUCTURAL ENGINEERING	08.12.2011
ZONING REVIEW	07.20.2011

DATE: 09.07.2011
 SCALE: 1/4" = 1'-0"
 UPPER LEVEL
 FRAMING PLAN

professional seal consultants