

STRUCTURAL DRAWING LIST	
SHEET	TITLE
S1	STRUCTURAL NOTES DECK FOUNDATION PLAN
S2	DECK FLOOR PLAN
S3	DECK ROOF PLAN

### STRUCTURAL NOTES

- STRUCTURE HAS BEEN DESIGNED TO COMPLY WITH THE 2009 INTERNATIONAL CODE COMMITTEE FAMILY OF CODES INCLUDING BY REFERENCE: ASCE 7-10: NATION DESIGN SPECIFICATION FOR WOOD CONSTRUCTION, 2012 EDITION; ACI BUILDING CODE REQUIREMENTS FOR STRUCTURAL CONCRETE 318-08.
- DECK FRAMING HAS BEEN DESIGNED FOR THE FOLLOWING LOADS:  
DEAD LOAD 10 PSF  
LIVE LOAD 40 PSF
- FOUNDATION DESIGN IS BASED ON A PRESUMPTIVE BEARING PRESSURE OF 1500 PSF (IBC TABLE 1804.2).
- CONCRETE USED SHALL HAVE A MINIMUM COMPRESSIVE STRENGTH OF 3,000 PSI AT 28 DAYS. REINFORCING STEEL BARS SHALL CONFORM TO ASTM A615, GRADE 60.
- WOOD FRAMING INDICATED IN THE DRAWING BY NOMINAL SIZES (2X4, 2X6, ETC) SHALL BE KILN DRIED SPRUCE-PINE-FIR, #2 OR BETTER.
- CONNECTIONS AND FASTENERS NOTED IN THE DRAWINGS SHALL BE CONSIDERED TYPICAL AT ALL SIMILAR CONNECTIONS UNLESS NOTED OTHERWISE.
- CONNECTORS NOTED BY PART NUMBER ARE BY SIMPSON STRONG-TIE OR APPROVED EQUAL.
- CONTRACTOR IS RESPONSIBLE FOR SHORING, TEMPORARY STABILITY, AND MEANS & METHODS OF CONSTRUCTION. IMMEDIATELY NOTIFY THE ENGINEER IF THE WORK RESULTS IN EXCESSIVE DEFLECTION OR CRACKING.
- JOIST SPACING IS EQUAL WITHIN BAYS UNLESS OTHERWISE NOTED. JOISTS MAY BE MOVED +/- 3" RELATIVE TO THE POSITION SHOWN ON THE DRAWINGS TO ENABLE FIELD COORDINATION IF NECESSARY.
- STRUCTURAL DESIGN IS ONLY PROVIDED FOR THOSE ELEMENTS SPECIFICALLY NOTED ON THESE DRAWINGS. ALL OTHER STRUCTURAL DESIGN FOR FOUNDATIONS, WALLS, LATERAL SYSTEMS, ROOFS, ARCHITECTURAL OR ORNAMENTAL FEATURES, STAIRS, MECHANICAL, PLUMBING AND ELECTRICAL SYSTEMS AND ATTACHMENTS IS BY OTHERS. DO NOT SCALE FROM THESE DRAWINGS.

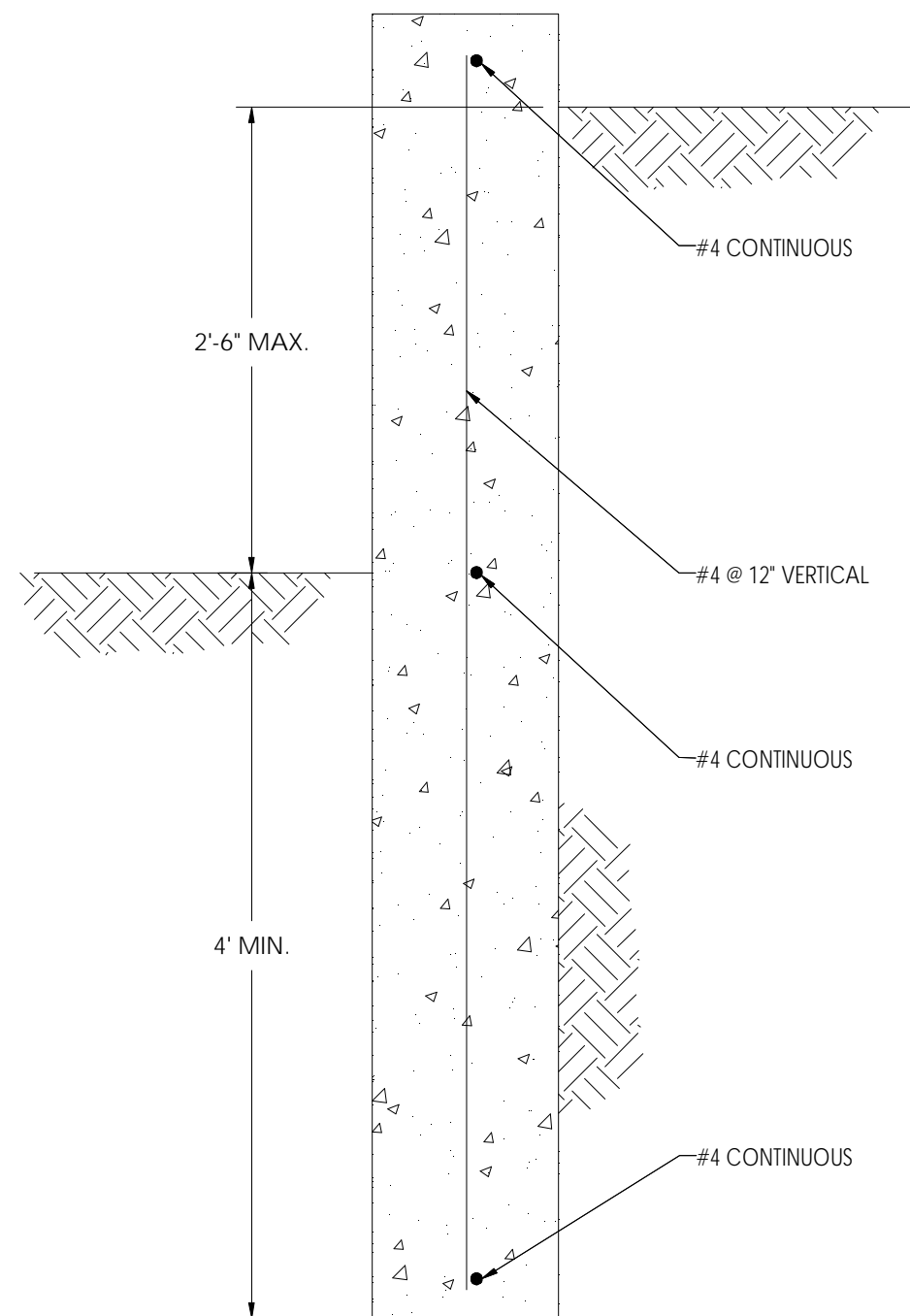

2 DETAIL  
1" = 1'-0"

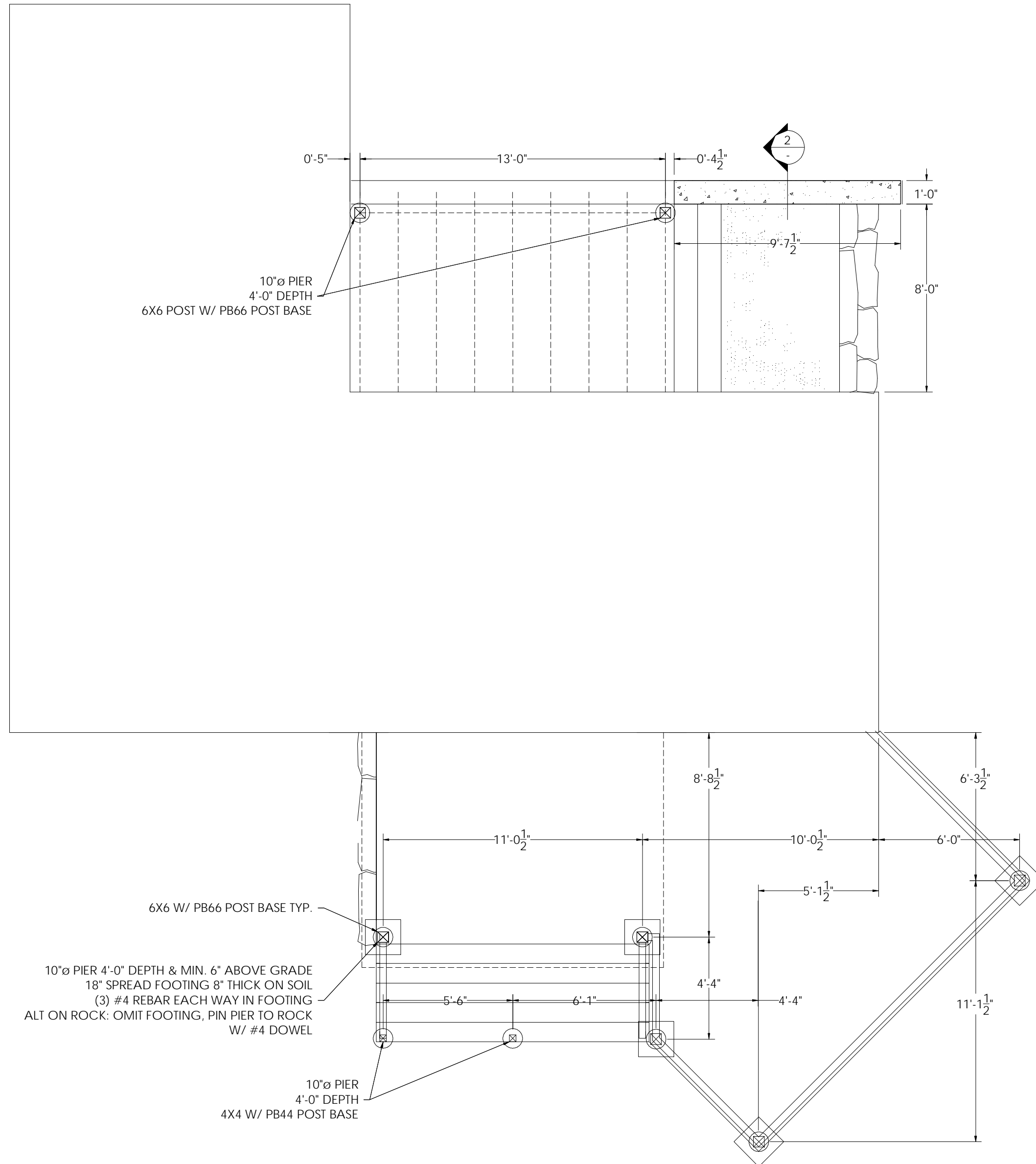

NOTE:  
1. SEE ARCHITECTURAL DRAWINGS FOR INFO NOT SHOWN.  
2. DESIGN IS FOR DECK & PORCH STRUCTURES ONLY.

1 PORCH & DECK FOUNDATION PLAN  
1/4" = 1'-0"

Rachel Conly

Architectural Design

Peaks Island, Maine 04108  
207.766.5625

## STRUCTURAL NOTES DECK FOUNDATION PLAN

PROJECT

Gulliver Family  
Residence

Island Avenue  
Peaks Island, Me.  
04108

DATE 4.5.13

REVISED

SCALE 1/4" = 1'-0"

DRAWN BY  
AJ

NOTES

S1

Rachel Conly

Architectural Design

Peaks Island, Maine 04108  
207.766.5625

STRUCTURAL  
DECK FRAMING

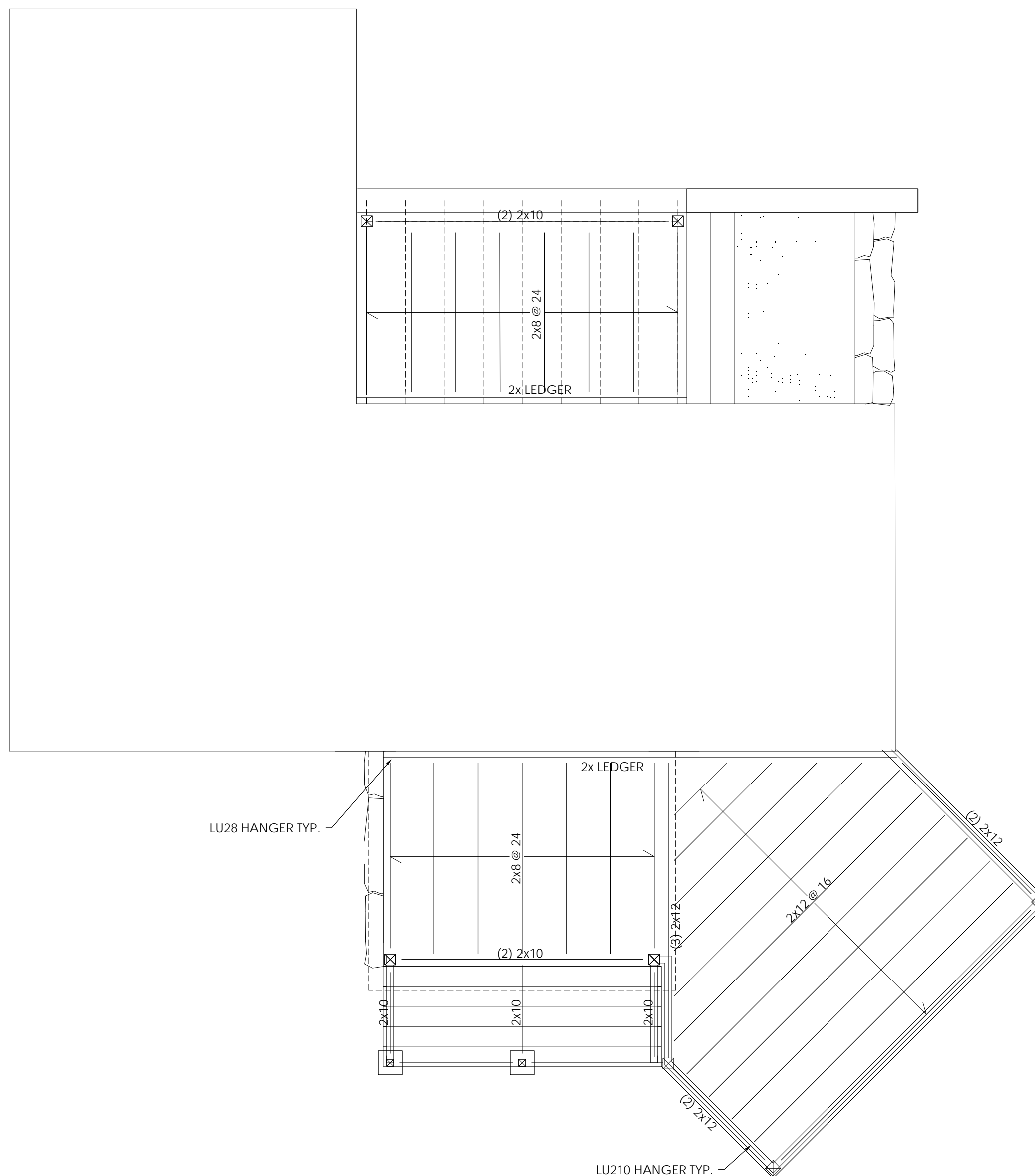

PROJECT  
Gulliver Family  
Residence  
  
Island Avenue  
Peaks Island, Me.  
04108

DATE	4.5.13	REVISED	
SCALE	1/4" = 1'-0"	DRAWN BY	AJ

NOTES

1 PORCH & DECK FRAMING PLAN  
1/4" = 1'-0"

S2

Rachel Conly

Architectural Design

Peaks Island, Maine 04108  
207.766.5625

STRUCTURAL  
DECK ROOF

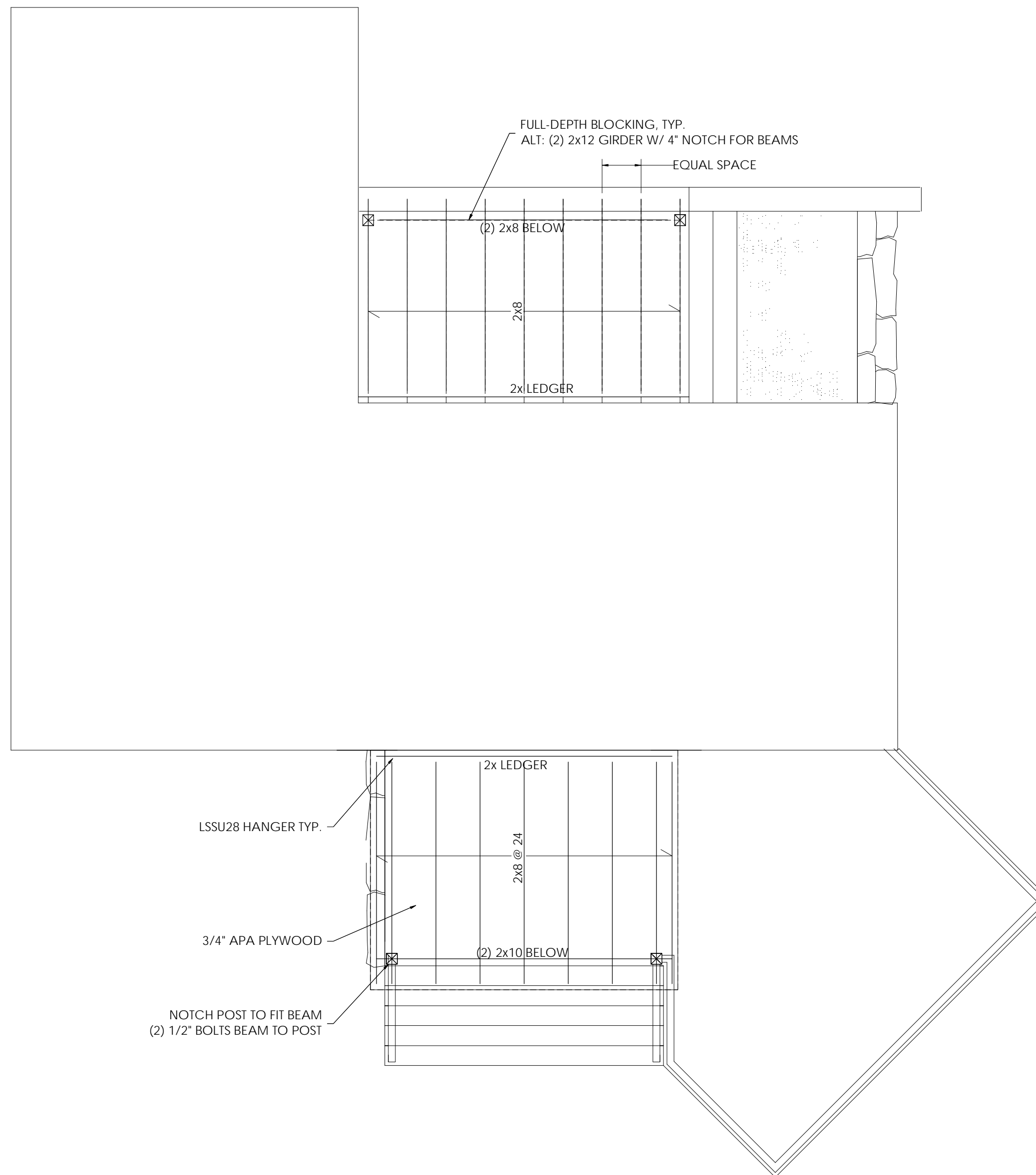

2 PORCH & DECK ROOF PLAN  
1/4" = 1'-0"

PROJECT

Gulliver Family  
Residence

Island Avenue  
Peaks Island, Me.  
04108

DATE  
4.5.13

REVISED

SCALE  
1/4" = 1'-0"

DRAWN BY  
AJ

NOTES

S3