

**City of Portland, Maine - Building or Use Permit Application**

389 Congress Street, 04101 Tel: (207) 874-8703, Fax: (207) 874-8716

Permit No: 08-1253	Issue Date:	CBL: 087 H005001
-----------------------	-------------	---------------------

Location of Construction: 108 BRACKETT AVE	Owner Name: HANLEY SUSAN E & DANIEL JT	Owner Address: 108 BRACKETT AVE	Phone:
Business Name:	Contractor Name: property owner	Contractor Address:	Phone
Lessee/Buyer's Name	Phone:	Permit Type: HVAC	Zone: IR 2

Past Use: Single Family Home	Proposed Use: Single Family Home - i install a Petit Godin small round Coal/wood stove	Permit Fee: \$30.00	Cost of Work: \$400.00	CEO District: 1
Proposed Project Description: install a Petit Godin small round Coal/wood stove		FIRE DEPT: <input type="checkbox"/> Approved <input type="checkbox"/> Denied	INSPECTION: Use Group: R3 Type: STOVE Signature: <i>Mr 10/6/08</i>	
		PEDESTRIAN ACTIVITIES DISTRICT (P.A.D.) Action: <input type="checkbox"/> Approved <input type="checkbox"/> Approved w/Conditions <input type="checkbox"/> Denied Signature: Date:		

Permit Taken By: Idobson	Date Applied For: 10/06/2008	<b>Zoning Approval</b>		
<ol style="list-style-type: none"><li>This permit application does not preclude the Applicant(s) from meeting applicable State and Federal Rules.</li><li>Building permits do not include plumbing, septic or electrical work.</li><li>Building permits are void if work is not started within six (6) months of the date of issuance. False information may invalidate a building permit and stop all work..</li></ol>		Special Zone or Reviews <input type="checkbox"/> Shoreland <input type="checkbox"/> Wetland <input type="checkbox"/> Flood Zone <input type="checkbox"/> Subdivision <input type="checkbox"/> Site Plan Maj <input type="checkbox"/> Minor <input type="checkbox"/> MM <input type="checkbox"/> Date: <i>10/6/08</i>	Zoning Appeal <input type="checkbox"/> Variance <input type="checkbox"/> Miscellaneous <input type="checkbox"/> Conditional Use <input type="checkbox"/> Interpretation <input type="checkbox"/> Approved <input type="checkbox"/> Denied Date:	Historic Preservation <input type="checkbox"/> Not in District or Landmark <input type="checkbox"/> Does Not Require Review <input type="checkbox"/> Requires Review <input type="checkbox"/> Approved <input type="checkbox"/> Approved w/Conditions <input type="checkbox"/> Denied Date: <i>10/6/08</i>

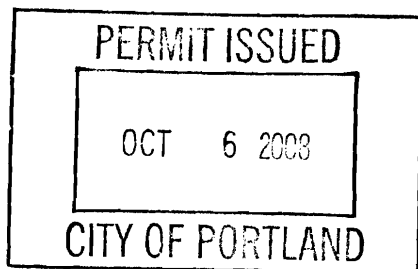
**CERTIFICATION**

I hereby certify that I am the owner of record of the named property, or that the proposed work is authorized by the owner of record and that I have been authorized by the owner to make this application as his authorized agent and I agree to conform to all applicable laws of this jurisdiction. In addition, if a permit for work described in the application is issued, I certify that the code official's authorized representative shall have the authority to enter all areas covered by such permit at any reasonable hour to enforce the provision of the code(s) applicable to such permit.

SIGNATURE OF APPLICANT

ADDRESS

DATE

PHONE

RESPONSIBLE PERSON IN CHARGE OF WORK, TITLE

DATE

PHONE



FILL IN AND SIGN WITH INK

# APPLICATION FOR PERMIT HEATING OR POWER EQUIPMENT

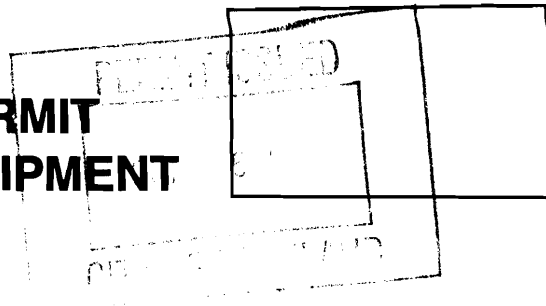

To the INSPECTOR OF BUILDINGS, PORTLAND, ME.

The undersigned hereby applies for a permit to install the following heating, cooking or power equipment in accordance with the Laws of Maine, the Building Code of the City of Portland, and the following specifications:

Location / CBL 103 BRACKETT AVE. PEAKS ISLAND Use of Building RESIDENCE Date 10/6/08

Name and address of owner of appliance DANIEL HANLEY 103 BRACKETT AVE PEAKS IS. 04108

Installer's name and address DANIEL HANLEY 103 BRACKETT AVE PEAKS IS. 04108

Telephone 207 766 2735

## Location of appliance:

- ☐ Basement ☒ Floor  
☐ Attic ☐ Roof

## Type of Fuel:

- ☐ Gas ☐ Oil ☒ Solid

Appliance Name: PETIT GODIN

U.L. Approved ☒ Yes ☐ No

Will appliance be installed in accordance with the manufacture's installation instructions? ☒ Yes ☐ No

IF NO Explain: \_\_\_\_\_

## The Type of License of Installer:

- ☐ Master Plumber # \_\_\_\_\_  
☐ Solid Fuel # \_\_\_\_\_  
☐ Oil # \_\_\_\_\_  
☐ Gas # \_\_\_\_\_  
☐ Other \_\_\_\_\_

## Type of Chimney:

- ☒ Masonry Lined  
Factory built \_\_\_\_\_

- ☐ Metal  
Factory Built U.L. Listing # \_\_\_\_\_

- ☐ Direct Vent  
Type \_\_\_\_\_ UL# \_\_\_\_\_

## Type of Fuel Tank

- ☐ Oil  
☐ Gas

Size of Tank \_\_\_\_\_

Number of Tanks \_\_\_\_\_

Distance from Tank to Center of Flame \_\_\_\_\_ feet.

Cost of Work: \$ 400

Permit Fee: \$ 30

## Approved

Fire: \_\_\_\_\_

Ele.: \_\_\_\_\_

Bldg.: \_\_\_\_\_

Signature of Installer

White - Inspection

Yellow - File

Pink - Applicant's

Gold - Assessor's Copy

## Approved with Conditions

- ☐ See attached letter or requirement

Inspector's Signature

Date Approved

**City of Portland, Maine - Building or Use Permit**

389 Congress Street, 04101 Tel: (207) 874-8703, Fax: (207) 874-8716

<b>Permit No:</b> 08-1253	<b>Date Applied For:</b> 10/06/2008	<b>CBL:</b> 087 II005001
------------------------------	--	-----------------------------

<b>Location of Construction:</b> 108 BRACKETT AVE	<b>Owner Name:</b> HANLEY SUSAN E & DANIEL JT	<b>Owner Address:</b> 108 BRACKETT AVE	<b>Phone:</b>
<b>Business Name:</b>	<b>Contractor Name:</b> property owner	<b>Contractor Address:</b>	<b>Phone</b>
<b>Lessee/Buyer's Name</b>	<b>Phone:</b>	<b>Permit Type:</b> HVAC	

<b>Proposed Use:</b> Single Family Home - i install a Petit Godin small round Coal/wood stove	<b>Proposed Project Description:</b> install a Petit Godin small round Coal/wood stove
--	---

<b>Dept:</b> Zoning	<b>Status:</b> Not Applicable	<b>Reviewer:</b>	<b>Approval Date:</b>	<b>Ok to Issue:</b> <input checked="" type="checkbox"/>
<b>Note:</b>				
<b>Dept:</b> Building	<b>Status:</b> Approved with Conditions	<b>Reviewer:</b> Tom Markley	<b>Approval Date:</b> 10/06/2008	<b>Ok to Issue:</b> <input checked="" type="checkbox"/>
<b>Note:</b>	1) Application approval based upon information provided by applicant. Any deviation from approved plans requires separate review and approval prior to work. 2) Installation shall comply with 2003 International Mechanical Code and State of Maine Oil and Solid Fuel Board Laws and Rules			



Conforms with Standard  
CAN/CSA - B 365  
ULC S-627  
UL Standard 1482

**Distribution:**

Drolet Stoves & Fireplaces Inc.  
1700 Léon Harmel - Québec - G1N 4R9  
Tél (418) 527-3060  
1-800-363-5573  
Fax (418) 527-4311

**Manufacturer : GODIN s.a.**  
**Guisse 02120 - France**

<b>PETIT GODIN small round</b>	Ref. 3730 coal burning stove
<b>PETIT GODIN large round</b>	Ref. 3731 coal burning stove
<b>PETIT GODIN small oval</b>	Ref. 3732 coal burning stove
<b>PETIT GODIN large oval</b>	Ref. 3734 coal burning stove
<b>BELLE EPOQUE</b>	Ref. 3733A coal burning stove
<b>REGENCE</b>	Ref. 3754 coal burning stove
<b>ART DECO</b>	Ref. 3137 wood burning stove
<b>LE JURASSIEN</b>	Ref. 3101 wood burning stove
	Ref. 3701 coal burning stove suitable for wood burning

**SAFETY NOTICE:**

A stove improperly installed or operated can set fire to your house or cause injury. Please read this entire manual before you install and use your new room heater and follow the instructions.

Before installing, ask your local building or fire officials about local restrictions, permits and inspections. Even if not required, ask the local officials to inspect your installation before firing. Your safety depends on it.

**KEEP THIS MANUAL FOR REFERENCE.**

Failure to follow instructions may result in property damage, bodily injury or even death.

**GENERAL CHARACTERISTICS**

Overall dimensions in mm (in.) and weight :

	Weight (Kg / lbs)	Height	Depth	Width
3730	60 / 132	760 (29.9)	410 (16.1)	410 (16.1)
3731	102 / 225	940 (37)	530 (20.8)	530 (20.8)
3732	84 / 185	770 (30.3)	480 (18.9)	590 (23.2)
3734	100 / 220	940 (37)	480 (18.9)	590 (23.2)
3701	190 / 419	710 (28)	470 (18.5)	772 (30.4)
3101	157 / 346	710 (28)	470 (18.5)	772 (30.4)
3733	98 / 216	890 (35)	470 (18.5)	400 (15.7)
3754	126 / 278	595 (23.4)	320 (12.6)	645 (25.4)
3137	160 / 353	690 (27.2)	410 (16.1)	750 (29.5)

**Firebox dimensions**

	Height	Depth	Width
3730	400 (15.7)	200 (7.9)	200 (7.9)
3731	600 (23.6)	300 (11.8)	300 (11.8)
3732	500 (19.7)	200 (7.9)	330 (13)
3734	600 (23.6)	200 (7.9)	330 (13)
3701	270 (10.6in)	470 (18.5in)	400 (15.7in)
3101	270 (10.6in)	470 (18.5in)	550 (21.6in)
3733	400 (15.7)	200 (7.9)	200 (7.9)
3754	250 (9.8)	200 (7.9)	400 (15.7)
3137	590 (23.2)	250 (9.8)	280 (11)

***Instruction Manual for use and installation***



#### TECHNICAL DATA

The maximum steady outputs given below are levels that you can expect your Godin stove to deliver and conveniently, day in and day out, without damage to your stove.

Ref	Maximum heating output (kw/Btu)	Rated heated volume (m3/cubic feet)	Distance between floor and top of rear flue outlet
3730	4/13600	120/4250	680 / 26.8 in 460 / 18.1 in
3731	6.5/22100	220/7700	605 / 23.8 in 830 / 32.7 in
3732	5/17000	150/5300	430 / 17 in 660 / 26 in
3734	7/23900	240/8500	610 / 24 in 830 / 32.7 in
3701	9.5/32400	380/13400	530 / 21 in
3101	11.2/38200	470/16500	530 / 21 in
3733	5/17000	150/5300	565 / 22.2 in 785 / 30.9 in
3754	7/23900	240/8500	520 / 20.5 in
3137	11/37500	450/15800	625 / 24.6 in

#### Consumptions in

Kg per hour / lbs per hour at :	Low speed using wood	Low speed using coal	Normal speed using wood	Normal speed using coal
3730	0.5/1.1	0.25/0.5	1.5/3.3	0.6/1.3
3731	0.8/1.8	0.3/0.6	2.3/5	0.9/2
3732	0.7/1.5	0.3/0.6	2/4.4	0.8/1.8
3734	0.8/1.8	0.3/0.6	2.5/5.5	0.95/2
3701	0.6/1.3	0.3/0.7	4/8.8	1.3/2.9
3101	1/2.2	-	4/8.8	-
3733	0.7/1.5	0.25/0.5	2/4.4	0.8/1.8
3754	1.1/2.4	0.4/0.9	3.5/7.7	1/2.2
3137	0.8	-	3.8/8.4	-

Their autonomy at low combustion rate is of 12 hours (10 hours for 3101).

Manual speed regulation using the front air arrival control for all stoves except 3701 using thermostatic regulation by knob located on the right side of the stove.

#### PRE INSTALLATION CHECKS

Before installing the appliance, ensure that it is in perfect condition. Checks should be made to ensure that the doors close correctly, that the regulating and cleaning devices operate efficiently and that the smoke ducts are not blocked. Checks should also be made to ensure that external air, essential for the proper functioning of the appliance, can arrive easily and in adequate quantity. An insufficient air supply can create demands on neighbouring rooms which can dangerously affect the operation of appliances installed in them.

#### CHIMNEY AND CONNECTION

The chimney is of prime importance and all causes likely to reduce the draught must be eliminated as far as possible.

This room heater must be connected to:

- 1/ a chimney approved UL 103 Type HT for the U.S.A.; and ULC S629 for Canada
- 2/ a code-approved masonry chimney with a flue liner

#### Chimney connector minimum diameter:

Ref 3730 : 4 inches	Ref 3732 : 6 inches	Ref 3734 : 5 inches	
Ref 3731 : 5 inches	Ref 3733 : 4 inches	Ref 3701 : 6 inches	Ref 3101 : 6 inches

Nota : Chimney connector size is same in reduced clearance installations as in standard installations.

Before the installation is carried out, ensure that the chimney is in good condition and will provide adequate draught, i.e. 1.5 mm WG (0,06" WG). The chimney should be independent and well insulated

It must be airtight and its area of cross section must be constant, no less than 2,5 dm<sup>2</sup> (39 sq. Inches). On the other hand, an excessively large area of cross section produces too great a volume, which is difficult to heat and is one of the principle causes of poor draught.

The height of the flue should be no less than 6 meters (20 feet) and the top should be 1 meter above the ridge of the roof and terminate without any form of restriction in the open air.

It is recommended that a well sealed cleaning access be placed approximately 50cm/20in. below the junction of the stove pipe with main flue.

Never use stove pipe of a smaller diameter than that intended for the appliance or restrict it in any way.

The connection between the stove's pipe and the chimney must be perfectly airtight.

NOTE: It is essential to check that the room in which the appliance is installed is sufficiently well ventilated to provide an adequate air supply. The installation must be in compliance with local jurisdictions having authorities in your area.

DO NOT CONNECT TO ANY AIR DISTRIBUTION DUCT OR SYSTEM

DO NOT CONNECT THIS UNIT TO A CHIMNEY FLUE SERVING ANOTHER APPLIANCE

#### INSTALLATION OF THE EQUIPMENT

### *Instruction Manual for use and installation*



If this room heater is not properly installed, a house fire may result. To reduce this risk, follow the installation instructions. Contact local building or fire officials about restrictions and installation inspection requirements in your area.

The appliance must be connected to the chimney by a short pipe. There is often a tendency to install stoves with long pipes in the hope that these will act as heat collectors from the smoke. The stoves themselves fulfill this role and the small amount of heat retained in the smoke is essential to the draught.

The spigot is fitted on the back of the appliance. It is possible to connect the stove direct to the chimney using a short horizontal length of pipe (Fig.3)

It is also possible to make a vertical connection to the back of the stove using the cast iron tee (Fig.4)

The chimney connector shall not pass through an attic or roof space, closet or similar concealed space, or a floor, or ceiling. Where passage through a wall, or partition of combustible construction is desired, the installation shall conform to local jurisdictions having authorities in area of installation.

The connecting pipe must be solidly attached and air tight. In the case of connection to the register of a chimney, use a pipe cut slantwise with the opening turned downwards.

#### - IMPORTANT NOTE

If the floor consists of combustible material, it must be protected by a raised plate providing 40 cm (16 inches) clearance in front of the stove and 20 cm (8 inches) clearance side and back of the stove.

The plate must act as heat shield and be absolutely non-combustible. Use 153 mm (6 in.) stove pipe which should be enamelled, to provide protection from corrosion.

The run of stove pipe should be as short as possible in order that heat retained by the flue gases is used to establish a good draught.

The rear wall must not be of flammable materials.

In the opposite case, it should be suitably protected.

**HOT WHILE IN OPERATION. KEEP CHILDREN, CLOTHING AND FURNITURE AWAY. CONTACT MAY CAUSE SKIN BURNS.**

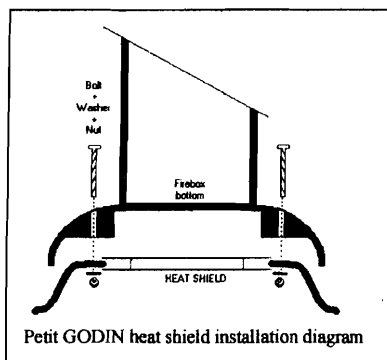

Testing the appliance : a coating of grease protects some internal parts against rust and at first lighting their heating may release a little smell which is normal and transitory. When the appliance has been suitably installed and connected to the smoke duct it should be operated with a low fire for several hours. Sudden contact with a brisk fire can cause damage.

When an appliance is lit which is connected to a cold chimney which has not been used for some time, there may be difficulties with the draught. The conclusion should not be drawn prematurely that the appliance or the smoke duct is defective but rather wait at least a day for confirmation.

#### CLEARANCES

All examples below are sidewall/backwall installations with rear wall penetration. Clearance to combustible walls and measurements for floor protectors are given in inches. For other listed installations, including instructions for installing with reduced clearances, see the owner's manual.

**CONSULT LOCAL BUILDING OR FIRE OFFICIALS ABOUT RESTRICTIONS AND INSTALLATIONS REQUIREMENT FOR YOUR AREA.**

Model	To sidewall from nearest side of chimney connector	To backwall from the back of the unit	To front edge of floor protector from fire door of unit
3701	33 inches	32 inches	16 inches
3101	33 inches	32 inches	16 inches

#### STANDARD CLEARANCES (in Inches)

	Ceiling penetration		Rear wall penetration		Corner installation Pipe to wall
	Sidewall- Pipe	Backwall- Pipe	Sidewall- Pipe	Backwall- Stove	
3730	33	24	33	32	31
3731	34	28	34	37	31
3732	28	18	33	32	24
3733	33	24	33	32	31
3734	34	24	34	37	31

#### REDUCED CLEARANCES (in Inches)

	Ceiling penetration		Rear wall penetration		Corner installation Pipe to wall
	Sidewall- Pipe	Backwall- Pipe	Sidewall- Pipe	Backwall- Stove	
3730	15	9	15	10	9
3731	15	9	15	10	9
3732	15	9	15	10	9
3733	15	9	15	10	9
3734	15	9	15	10	9

Supplementary information : Using a back wall shield only, in case of ceiling penetration, backwall clearance to pipe is 9 inches. Backwall clearance to stove is 10 inches.

### *Instruction Manual for use and installation*



Sidewall clearance to pipe is 33" for 3730 & 3733 ; 34" for 3731 & 3734 and 28" for 3732.

Only low-volatile soft coal should be used in a Godin stove. High volatile soft coal may burn too fast, and overheat both stove and stovepipe. The space heated will vary, depending on the heat loss of the dwelling, the air circulation between rooms, the location of the stove, and the manner in which the stove is operated.

The heat output, space heated, and useful burn time with coal are based on good quality "nut" size anthracite, rated at 13,500 BTU/lb, with 8-10% ash content. The quality of coal you burn, and therefore the performance you obtain, may be less.

Godin stoves should be vented to Standard listed, factory built chimney, or to a lined masonry chimney that meet local codes. Most existing chimneys are suitable for Godin stoves, but extremely large fireplaces flues may not attain the recommended draft, or may do so only slowly, making it difficult to establish a good fire. Such large flues should be fitted with a metal chimney liner.

#### **FOOTNOTES TO GODIN CLEARANCES CHART**

- Clearances in the chart are from the outside of the chimney connector to walls. See illustrations.
- Floor protection is defined as the non-combustible surface applied to the floor area beneath, extending beyond front, sides and back of the heater. It may be a listed covering manufactured for that purpose equivalent to 3/8" thick asbestos millboard, a minimum single layer of 2 1/2" thick common solid brick on top of 26 gauge galvanized steel, or of materials specified in the Building Code. The floor protector must extend 16 inches to the front, 8 inches to the sides, 8 inches to the rear, and 2 inches beyond the perimeter of the chimney connector. In rear wall installations, the floor protector must extend to the backwall, covering the entire floor area beneath the chimney connector and 2 inches past each side of the connector. Corner installation floor protectors must extend fully into corner. Reduced clearance floor protectors must extend fully to the backwall and sidewall shield and 8 inches beyond the side of the unit opposite the sidewall shield.
- Reduced clearance shields shall be of material equivalent to 20 gauge sheet steel or acceptable means stated in the Building Code. A one inch air space must be maintained between the wall surface and the wall protector. It must be open at the top and one side of each shield for ventilation. Attach to wall with non-combustible spacers spaced on 16 inches (40cm) centers. Rear and side shields must extend 18 inches along the wall from the edge of the unit and from the floor to 1 inch (2,54cm) from the ceiling. Reduced clearance rear wall penetrations require wall protectors as described above except the shield must end 11 inches (28 cm) above the top of the unit. Corner installation wall protectors must extend fully into the corner. No gaps between shields are allowed.
- Ceiling clearance to stovepipe is 18 inches (45 cm) in all installations.
- Measurements are from unit back to wall. No measurement from unit back to pipe is given in rear wall flue penetration installations.
- Clearances are measured to the shield itself, not the combustible wall behind the shields. The wall is 1 inch (2,54cm) farther than the measurement given.

#### **RECOMMENDED FUELS**

Anthracite 20x30, anthracite 10x20, wood log length 33cm/13in. (50cm/20in. for ref.3101)

**DO NOT BURN GARBAGE OR FLAMMABLE FLUIDS SUCH AS GASOLINE, NAPHTA OR ENGINE OIL.**

NOTE: In the case of bad draft from the chimney, it is recommended to use 20x30. If not available, use 20 gramme coal: it is better for bad draft but can cause damage if the draft is correct.

At first lightings, it is important that the appliance runs at moderate speed to allow the adjustment of the different parts.

#### **- IMPORTANT:**

Do not use the stove if the glass is damaged. Replace it immediately prior any lighting.

Be careful of the handles which are hot when the stove is functioning.

- **LOW SPEED:** To use in this position, the thermostat must be on the off position and the minimum of fuel must be loaded to the top half of the tank (ref. 3701). Concerning reference 3101, the fresh air arrival must remain close while a sufficient quantity of large diameter wood log is loaded on a thin red ashes bed.

- **CAUTION:** The use of any other fuel than recommended may cause serious damages to your installation and your health. It is also a case of guarantee unvalidity.

#### **UTILISATION**

*Never use gasoline, gasoline-type lantern fuel, kerosene, charcoal lighter fluid, or similar liquids to start or freshen up a fire in this heater. Keep all such liquids well away from the heater while it is in use.*

#### **COAL USING:**

The stove is equipped with a fuel tank to adjust according to the coal used. In most cases, for 20x30 anthracite, install the tank as precised in Fig.B. The front part of the tank is in this case, more low and rear located. The stove is filled through the removable top.

#### **WOOD USING for reference 3701:**

The loading of the stove is operated either through the door, either through the top. The fuel tank must be removed. The thermostat may stay on the lowest position, doors must remain close during functioning. We preconise a loading of 2 or 3 wood log (6 to 8 kg). If smokeless briquettes are used, limit the loading to 8 or 10 briquettes.

#### **WOOD USING for reference 3101:**

The loading of the stove is operated either through the door, either through the top. The fuel tank must be removed. The thermostat may stay on the lowest position, doors must remain close during functioning. Fresh air registers are located on the ash-pan door. The left one is to be used for lighting or relighting after low speed. It must remain close at normal speed, only use the register marked 0-1-2-3 located on the right. We preconise a loading of 2 or 3 wood log (6 to 8 kg). If smokeless briquettes are used, limit the loading to 8 or 10 briquettes.

#### **LIGHTING-REGULATION**

For Petit Godin, we recommend 20gr smokeless briquettes. If this fuel is not available, the following can be used : 20x30 anthracite, lignite briquettes.

### **Instruction Manual for use and installation**



Clean thoroughly. Open the furnace door. Ensure that the bottom and front grates are in position. Insert the normal fire lighting material through the loading door. Light through the front grate and fully open the air regulator damper. When the material is well alight, put 2 or 3 kilos of fuel on top. After 15 to 20 minutes fill the appliance and, after a further 20 to 30 minutes, set the control damper to the appropriate mark.

The 3730 A, 3731 A, 3732 & 3734 stoves are regulated by the damper on the furnace and ash-pan door, i.e.  $\frac{1}{2}$  to 1 turn slow, 2 to 4 turns average, 4 to 7 turns normal and 7 to 10 turns fast and very fast. The 3733 1A stove is regulated by the damper on the ash-pan door:  $\frac{1}{4}$  slow, 1 to 2 normal and 2 to 4 fast.

Fill the stove for the night, on a bed of fuel of about 8 to 10 cm giving a clear fire, fill the firebox until it is  $\frac{2}{3}$  full.

Open the front loading door as well as the top.

Install lighting materials on the whole griddle surface. Avoid too big wood pieces. Close the top. Light the stove by the front door.

Close this door and turn the thermostat knob for reference 3701 to the maximum position. For Petit Godin and reference 3101, open all air registers on the ash-pan door.

If lighting is difficult, it is possible to open the ash pan door for a few minutes.

When the fire is well alight, completely load the stove and adjust the thermostat at required speed.

Do not forget to close the ash pan door.

**DO NOT USE CHEMICALS OR FLUIDS TO START THE FIRE.**

**TAKE CARE AT MAINTENING FIRE SUFFICIENTLY FAR FROM THE FRONT WINDOW**

### **REMOVAL OF ASHES**

For Jurassien, use the rectangular tube and install it at the left rear side at the top. Remove from left to right until red ashes fall into the ash pan. For Petit Godin, push and pull the ring of the gratin vigorously until the red hot ashes fall into the ash pan.

At least do it in the morning for the relighting after the night. Empty the cinder at least every two days.

Never let ashes accumulated to be in contact with the griddle. It will not be cold any more and be very rapidly damaged.

Ashes should be placed in a metal container with a tight fitting lid. The closed container of ashes should be placed on a noncombustible floor or on the ground, well away from all combustible materials, pending final disposal. If the ashes are disposed of being locally dispersed, they should be retained in the closed container until all cinders have thoroughly cooled.

### **SWEEPING THE CHIMNEY**

Both sweep and inspect your connector and chimney at least once a year or every two months during the heating season to determine if a soot or creosote buildup has occurred. Clean the stove and check the door seals. Inspect the internal flue paths (remove the cleaning trap door) at least once per heating season. Use the GODIN NET product to clean the window. These operations should be conducted by a professional.

*Formation and removal of creosote (wood burning) and soot (coal burning)*

- When coal is burned, the products of combustion combine with moisture to form a soot residue which accumulates on the flue lining. When ignited, this soot makes an extremely hot fire.

- When wood is burned slowly, it produces tar and other organic vapors, which combine with expelled moisture to form creosote. The creosote vapors condense in the relatively cool chimney flue of a slow-burning fire. As a result, creosote residue which accumulates on the flue lining.

When ignited, this creosote makes an extremely hot fire.

If soot or creosote has accumulated, it should be removed to reduce the risk of a chimney fire.

### **FUEL IMPORTANCE**

The JURASSIEN stove has a thermal output close from 70% (ref 3101) or 80% (ref 3701). It must give you complete satisfaction. This result corresponds to the best rates at this time.

Nevertheless, you must not forget that whatever the appliance, it gives the energy included in the combustible. If the heating of the stove is not convenient to you, it can be said that:

- Either the fuel quantity is not sufficient

- Either the burnt fuel has not energy enough

! Using wet fuels damage the chimney and can cause fires.

Only burn dry wood being at least 2 or 3 years stocked. Humidity in the wood or in the coal goes from 15% to 50%. Always store your combustible materials dedicated to be burnt for a period, it will avoid any damage to your installation.

### **MAINTENANCE**

We recommend the use of our range of cleaning products, both suitable for enamelled surfaces and cast iron parts.

**CLEANING** : Allow it to go out from time to time and clean. Have the chimney swept annually. Replace worn parts if necessary. The smoke box must only be removed under exceptional circumstances. On refitting replace the fire cement seal. For the 3730 A, 3731 A, 3733 & 3734 stoves, remove the cleaning door at the back of the smoke box.

**ENAMEL** : The barrel of that stove is enamelled and needs no special treatment for maintenance. Never clean an enamelled surface when it is hot. The firedoor lintel of the 3730 A and the 3731 A stoves are subject to wear. Their condition must be checked before each heating season. Cracked or chipped enamel is not considered by us to be a cause of depreciation of the appliance. In certain cases, it is practically impossible to avoid these fine cracks which are due to differences in expansion between the metal and the enamel.

#### **IMPORTANT NOTE CONCERNING THE WINDOW GLASS DOOR**

For a better aspect of your stove and a good seeing of the flame, you have to clean the window regularly. This will also protect it from deposits which may damage your stove.

Our stoves are factory built in all safety conditions for a proper and safe installation of the window glass door.

Be careful when opening and closing the door to avoid a slamming shut which could damage the window. Also never use abrasive materials to clean the window, and always proceed when the stove is not functioning and sufficiently cold.

If unfortunately, this window is damaged, never use the stove without a correct replacement part, and contact your local dealer who will be able to give you all informations about the correct replacement material. He will also be able to reinstall the window of a correct manner. In the await

## *Instruction Manual for use and installation*





of its replacement, you may remove the damaged glass by unscrewing the maintaining metal parts from the inside of the door. Never use replacement materials which are not dedicated to this use, and never cut the glass yourself.

**SERVICING - AFTER SALES** If some parts need replacing after many years of satisfactory service, please contact your original supplier or any of our approved dealers. Give him product data as displayed in your warranty voucher, or on your appliance's name plate located at the rear of the appliance. Our dealers are in possession of all relevant documentation and shall supply you rapidly with all spare parts you need, and proceed with all servicing operations required within the scope of their professional competence. To be able to claim the benefits of the warranty, you must return the attached warranty voucher (to keep even after its validity date) to the local Godin dealer (or to the manufacture).

**LIABILITY** : It is reminded that the manufacturer's liability is limited to the product as manufactured in its original form (as it leaves its works), and that installation of the product is performed under the ultimate seller's total responsibility, or that of his commissioned installation professionals. Our products must be installed in accordance with relevant standards, safety regulations, codes of practice, and in accordance with this manual's instructions.

In the interest of constant product improvement, Godin reserve the right to change specifications without prior notice.

*These instructions will help you to obtain the most effective performance from your appliance under normal operating conditions, if any problems concerning your appliance should arise, do not hesitate to contact your supplier who, as he did during the time of installation, will be only too pleased to give you all the necessary advice.*

IMPERIAL MEASUREMENTS ARE GIVEN WITHOUT GUARANTEE, FOR GUIDANCE PURPOSES ONLY.

Manufactured by: GODIN - 02 120 Guise - FRANCE

Société Anonyme au Capital de 7.814.100 Francs

TVA N° FR 82 835 480 294

Tél (33) 03.23.05.70.00

Fax (33) 3.23.60.41.05 Fax S.A.V. (33) 3.23 05.70.25

RC Vervins B 835 480 294

Conforme à la Norme  
CAN/CSA - B 365  
ULC S-627  
UL Standard 1482

**Distribution:**

Drolet Poeles & Foyers Ltée.

1700 Léon Harmel - Québec - G1N 4R9

Tél (418) 527-3060

1-800-363-5573

Fax (418) 527-4311

*Instruction Manual for use and installation*

# Model 3750 CANYWOOD

NOTE: HAND DRAWING. DIMENSIONS ARE CORRECT BUT NOT TO PERFECT SCALE

COMBUSTIBLE

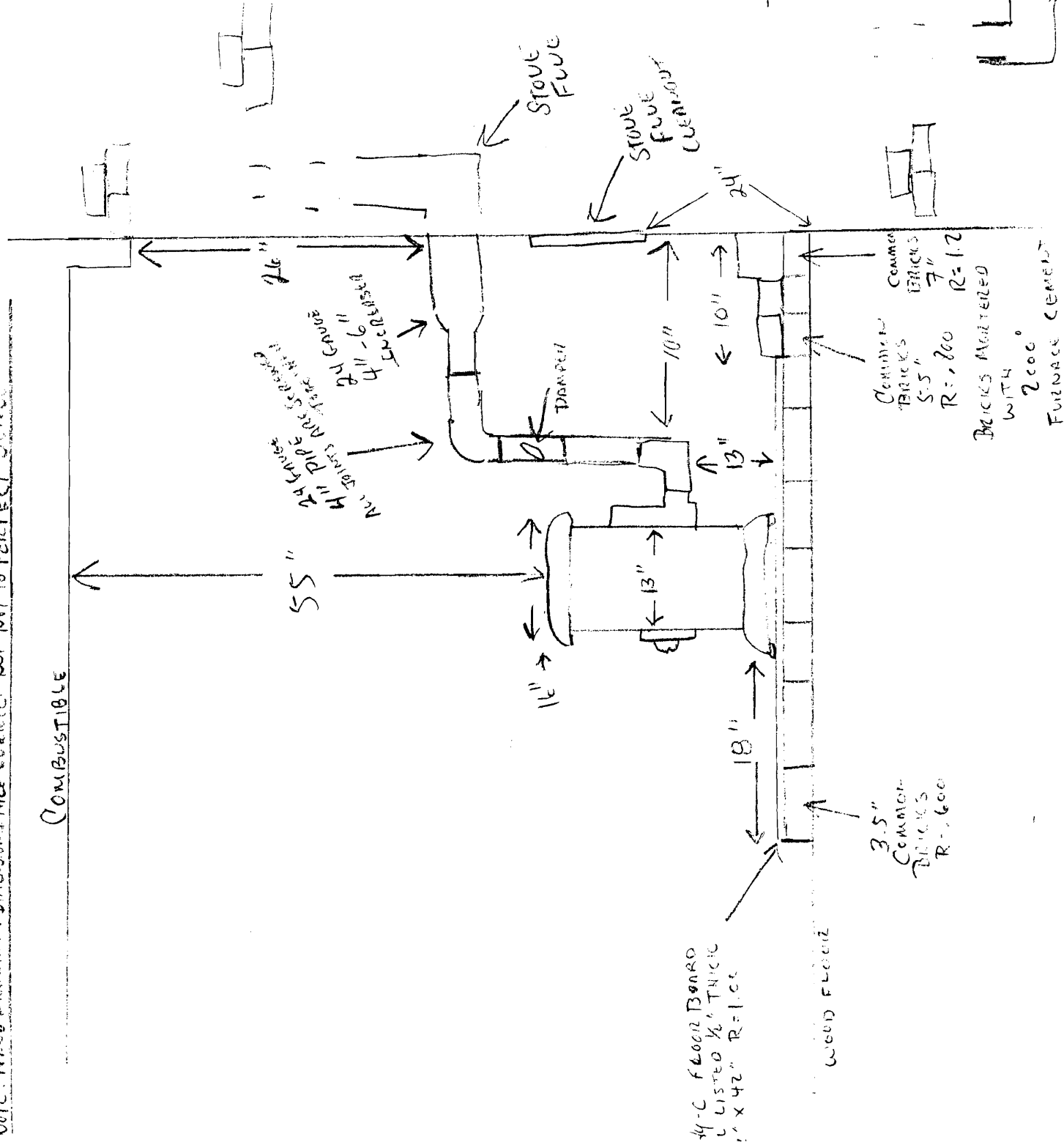

Brick Chimney

- ✓ Located in house
- ✓ Center of house
- ✓ Converted No. 1, 2000°
- ✓ From direct clay
- ✓ Lined flue for
- ✓ Curing in house
- ✓ To double flue standard
- ✓ Steel 1 1/2" professional
- ✓ Flue for wood stove is
- ✓ 6" dia. flue for 6"
- ✓ Bricks is 6' dia.

Missing - chimney

OIL BURNER FLUE

## BUILDING PERMIT INSPECTION PROCEDURES

Please call 874-8703 or 874-8693 (ONLY )

to schedule your inspections as agreed upon

Permits expire in 6 months, if the project is not started or ceases for 6 months.

The Owner or their designee is required to notify the inspections office for the following inspections and provide adequate notice. Notice must be called in 48-72 hours in advance in order to schedule an inspection:

By initializing at each inspection time, you are agreeing that you understand the inspection procedure and additional fees from a "Stop Work Order" and "Stop Work Order Release" will be incurred if the procedure is not followed as stated below.

A Pre-construction Meeting will take place upon receipt of your building permit.

  X   Final inspection required at completion of work.

Certificate of Occupancy is not required for certain projects. Your inspector can advise you if your project requires a Certificate of Occupancy. All projects DO require a final inspection.

If any of the inspections do not occur, the project cannot go on to the next phase, REGARDLESS OF THE NOTICE OR CIRCUMSTANCES.

**CERIFICATE OF OCCUPANICES MUST BE ISSUED AND PAID FOR, BEFORE THE SPACE MAY BE OCCUPIED.**

  
\_\_\_\_\_  
Signature of Applicant/Designee

10/6/08  
\_\_\_\_\_  
Date

  
\_\_\_\_\_  
Signature of Inspections Official

10/6/08  
\_\_\_\_\_  
Date