

- NOTE:
- 1.) ALL WOOD FRAMING MEMBERS THAT REST ON CONCRETE OR MASONRY EXTERIOR WALLS AND ARE LESS THAN 8" FROM THE EXPOSED GROUND SHALL BE OF A ROT RESISTANT MATERIAL.
 - 2.) ALL WOOD JOISTS OR THE BOTTOM OF A WOOD STRUCTURAL FLOOR WHEN CLOSER THAN 18", OR WOOD GIRDERS WHEN CLOSER THAN 12", TO THE EXPOSED GROUND, SHALL BE OF A ROT RESISTANT MATERIAL.
 - 3.) NEW WOOD SIDING AND/OR SHEATHING TO BE ABOVE GRADE A MINIMUM OF 6" OR ELSE OF A ROT RESISTANT MATERIAL.
 - 4.) ALL NEW FOUNDATION POSTS TO BE OF ROT RESISTANT MATERIAL RESTING ON CONCRETE FILLED SONOTUBE FOOTINGS, 4'-0" BELOW GRADE OR PINNED TO LEDGE.

Proposed
Framing Plan
1/4" = 1'-0"

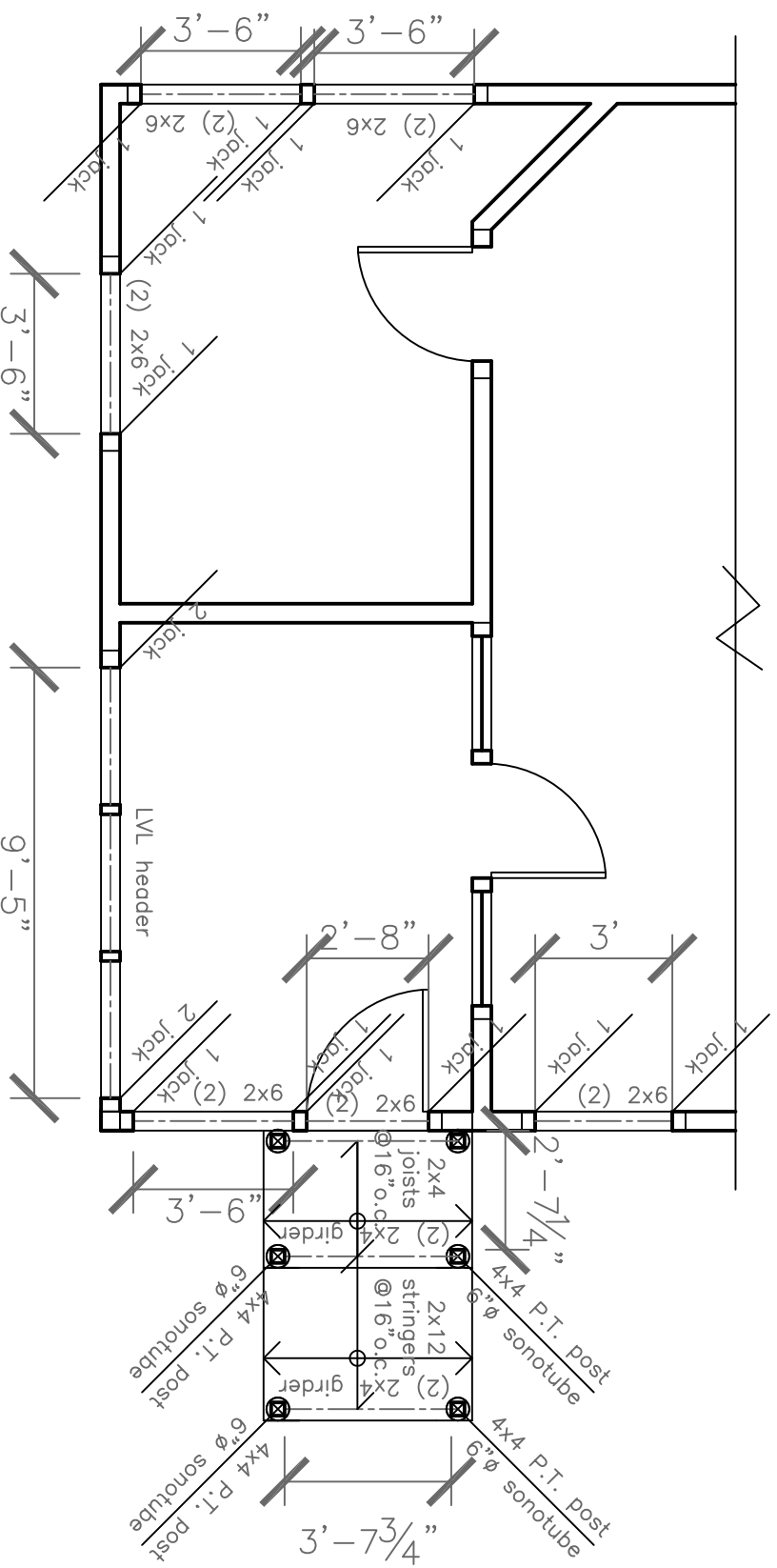

Rachel Conly
Architectural Design
Peaks Island, Maine 04108
207.766.5625

Proposed Framing Plan

PROJECT
Noonan-Kaye Residence
7 Luther Street
Peaks Island, Me.
04108

DATE	6.27.13	REVISED
SCALE	1/4" = 1'-0"	DRAWN BY
NOTES		Rachel

S1