



ARCHITECT:

**REED & CO. ARCHITECTURE**  
48 CUMBERLAND AVE  
PORTLAND, ME 04101  
207 871 5678

INTERIOR DESIGNER:

**COLE DESIGN**  
PO BOX 361  
KITTEERY, ME 03904  
207 653 0083

STRUCTURAL ENGINEER

**SHELLEY ENGINEERING**  
PO BOX 1030  
GRAY, ME 04039  
207 657 8031

MECHANICAL ENGINEER:

**HOLBROOK ENGINEERING**  
52 HEATH RD  
SACO, ME 04072  
207 283 9127

ELECTRICAL ENGINEER:

**BARTLETT DESIGN**  
942 WASHINGTON STREET  
BATH, MAINE 04530  
207 443 5447

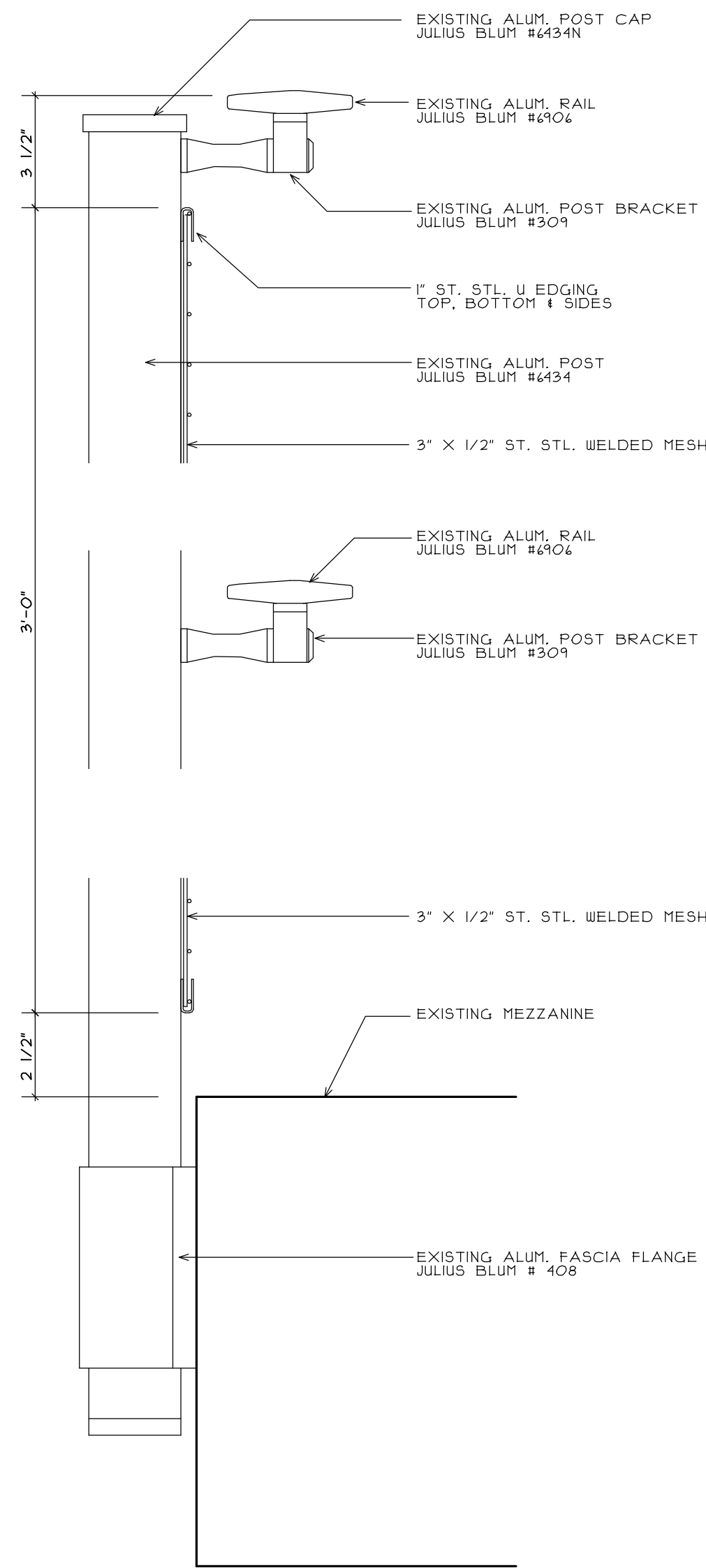

1. SECTION EXISTING GUARD AT MEZZANINE

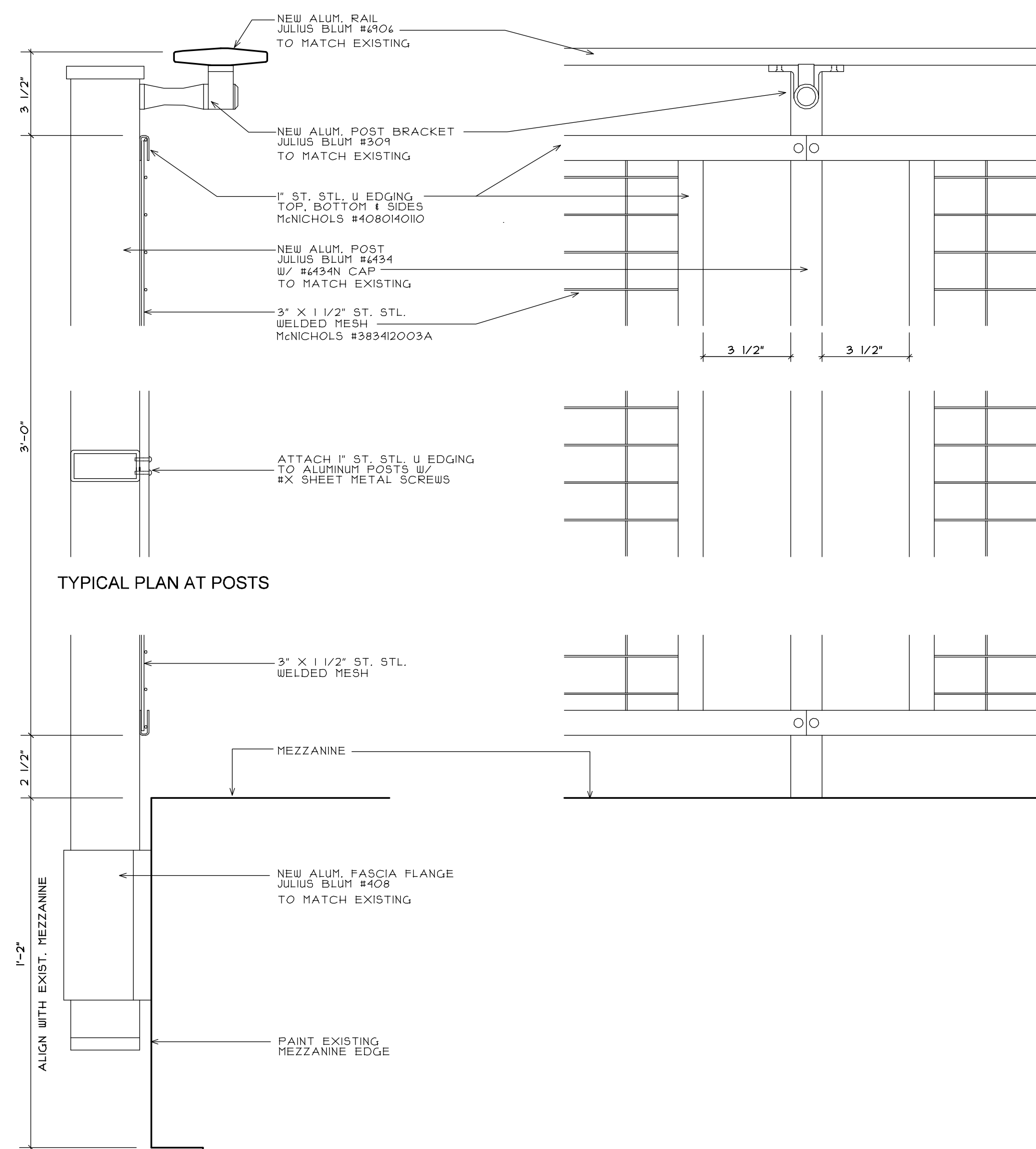

2. SECTION NEW GUARD AT MEZZANINE

3. SECTION NEW MESH PANEL ELEVATION FROM MEZZANINE

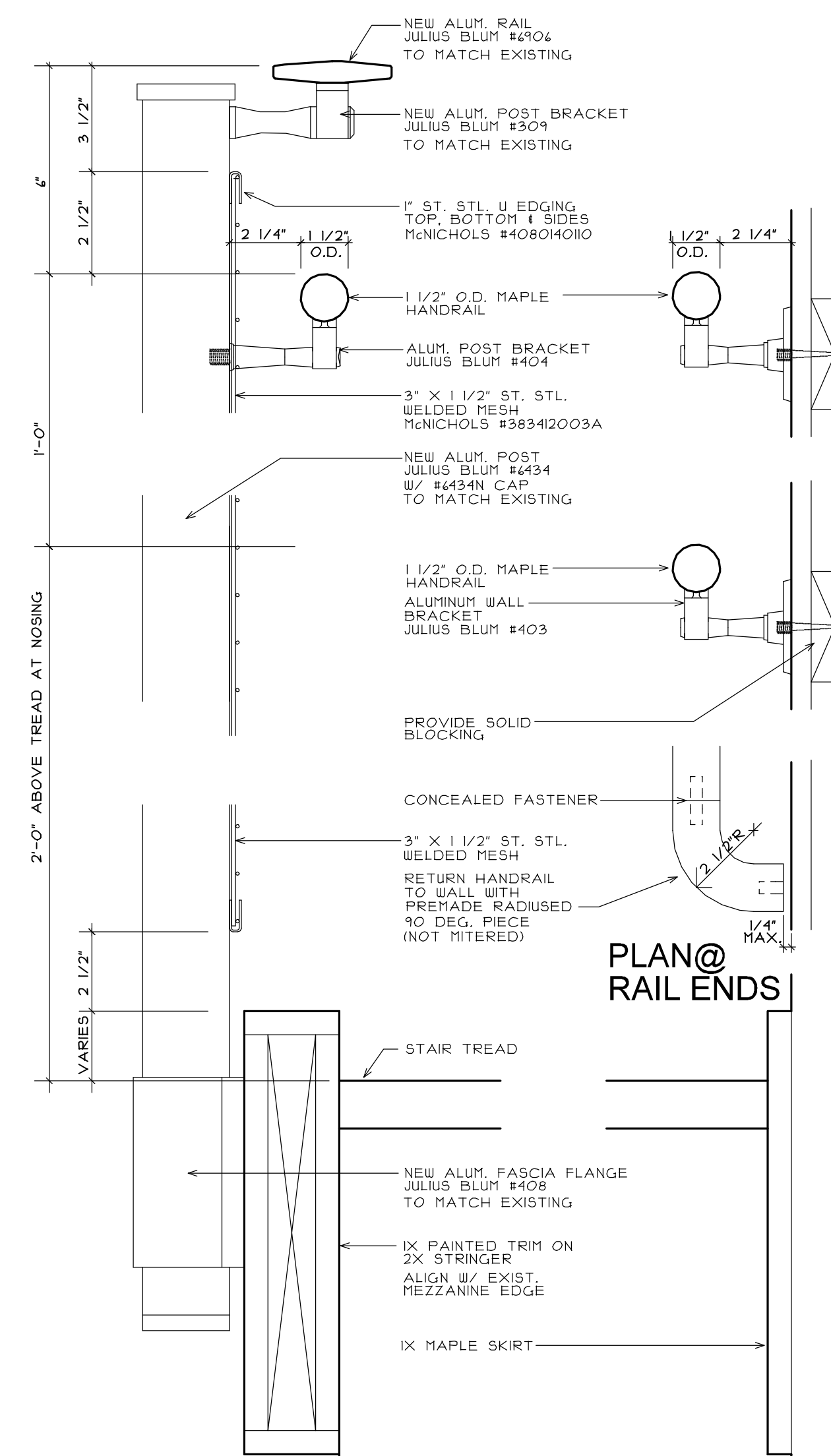

4. SECTION NEW GUARD AND HANDRAILS AT NEW STAIR

5. SECTION WALL MOUNTED HANDRAIL

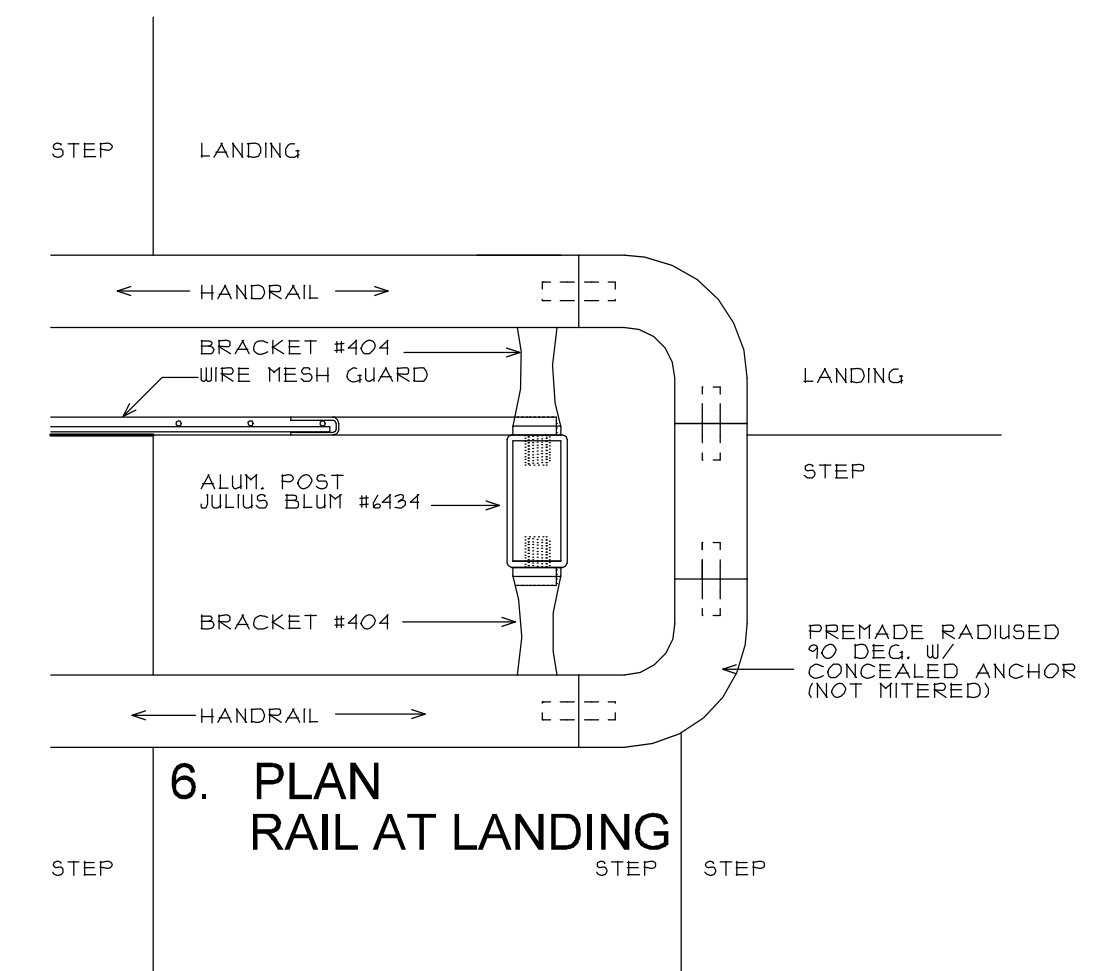

6. PLAN RAIL AT LANDING

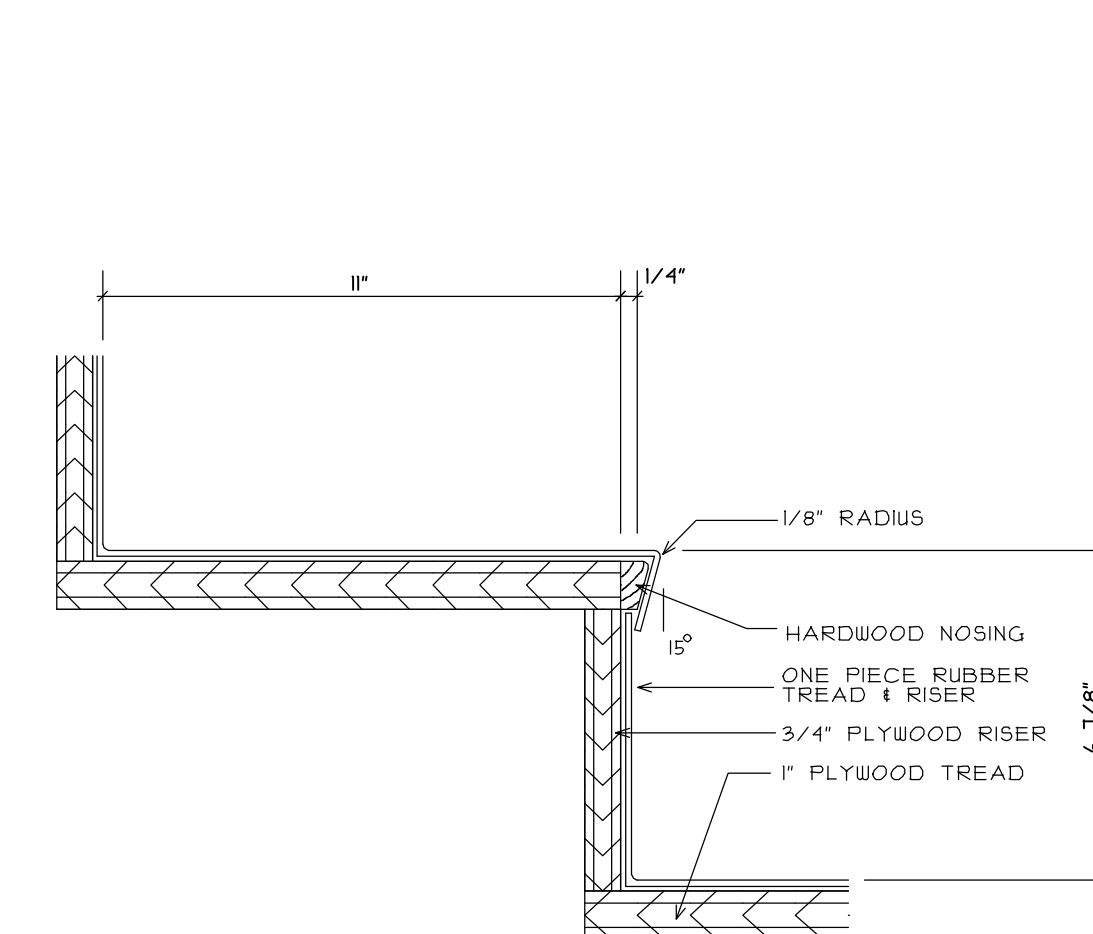

7. TYPICAL SECTION RUBBER TREAD & RISER

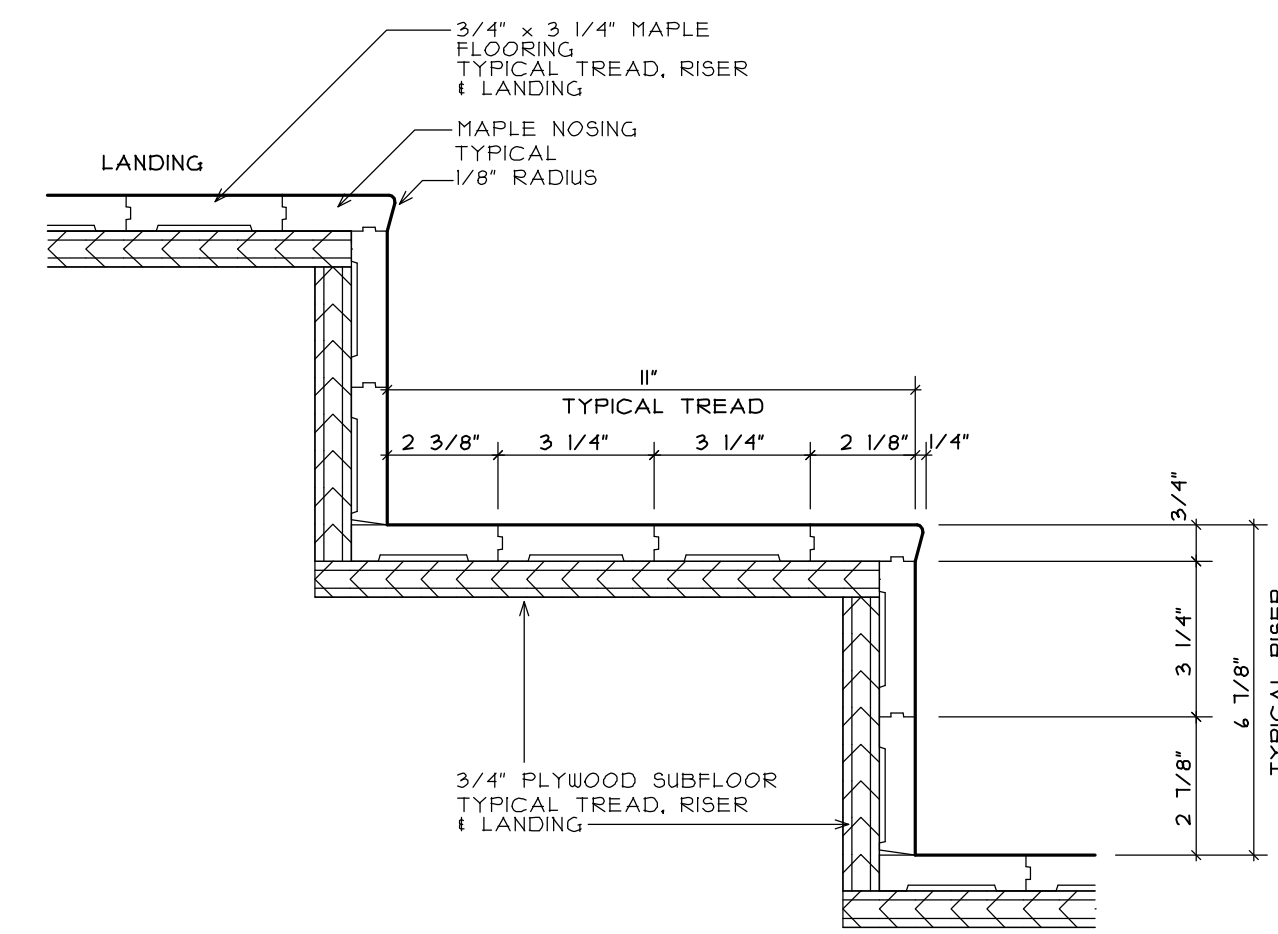

8. SECTION @ WOOD STAIR & LANDING

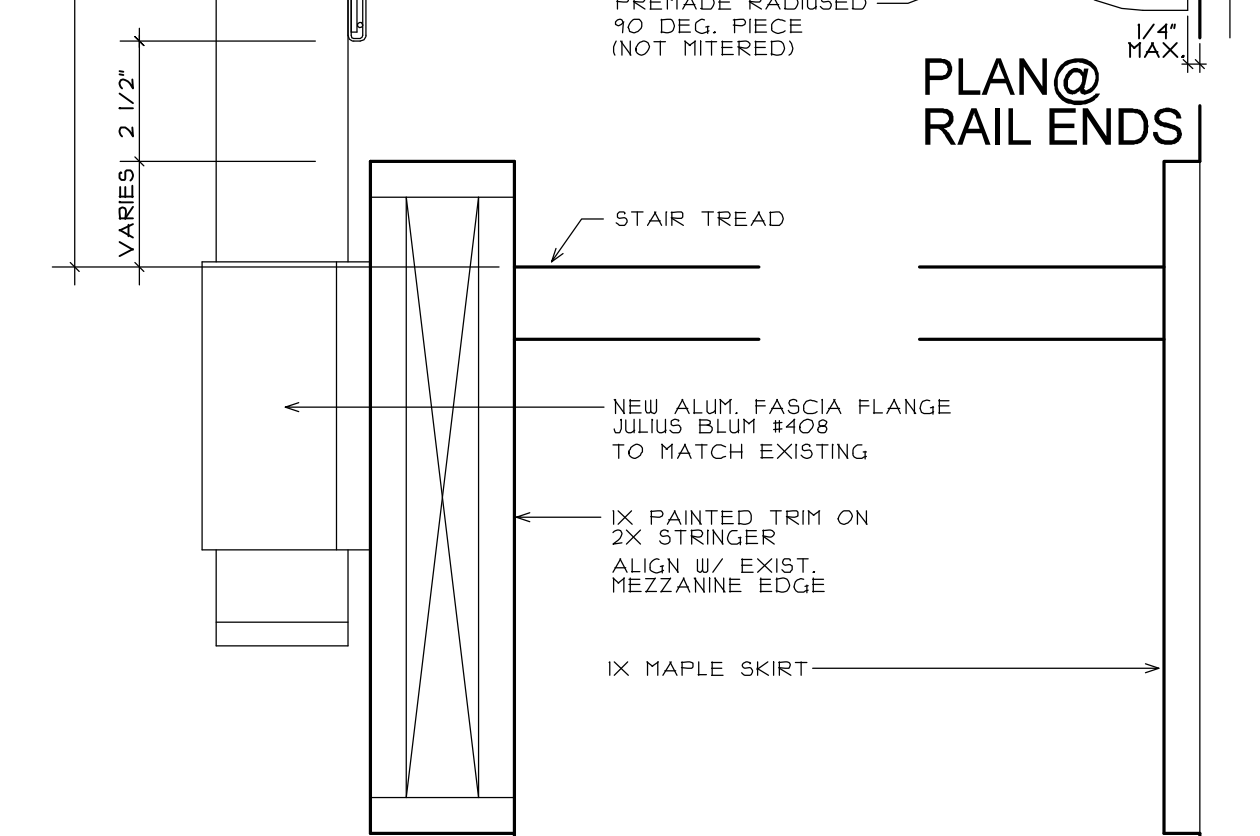

PLAN @ RAIL ENDS

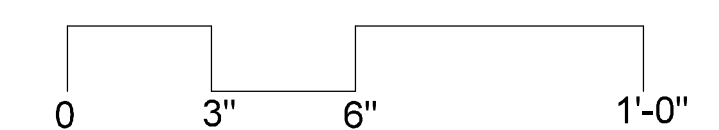

12-21-16 Issued for Review  
4-12-17 Issued for Bidding

PROPOSED IMPROVEMENTS

**PEAKS ISLAND COMMUNITY CENTER & LIBRARY**

Title: STAIR DETAILS

Sheet No.

**A3.3**

Scale: 3" = 1'-0"

Date:

Revised: