



ARCHITECT:  
**REED & CO. ARCHITECTURE**  
 46 CUMBERLAND AVE  
 PORTLAND, ME 04101  
 207 871 5878

INTERIOR DESIGNER:  
**COLE DESIGN**  
 PO BOX 361  
 KITTERY, ME 03904  
 207 653 0083

STRUCTURAL ENGINEER:  
**SHELLEY ENGINEERING**  
 PO BOX 1030  
 GRAY, ME 04039  
 207 657 8031

MECHANICAL ENGINEER:  
**HOLBROOK ENGINEERING**  
 52 HEATH RD  
 SACO, ME 04072  
 207 283 9127

ELECTRICAL ENGINEER:  
**BARTLETT DESIGN**  
 942 WASHINGTON STREET  
 BATH, MAINE 04530  
 207 443 5447

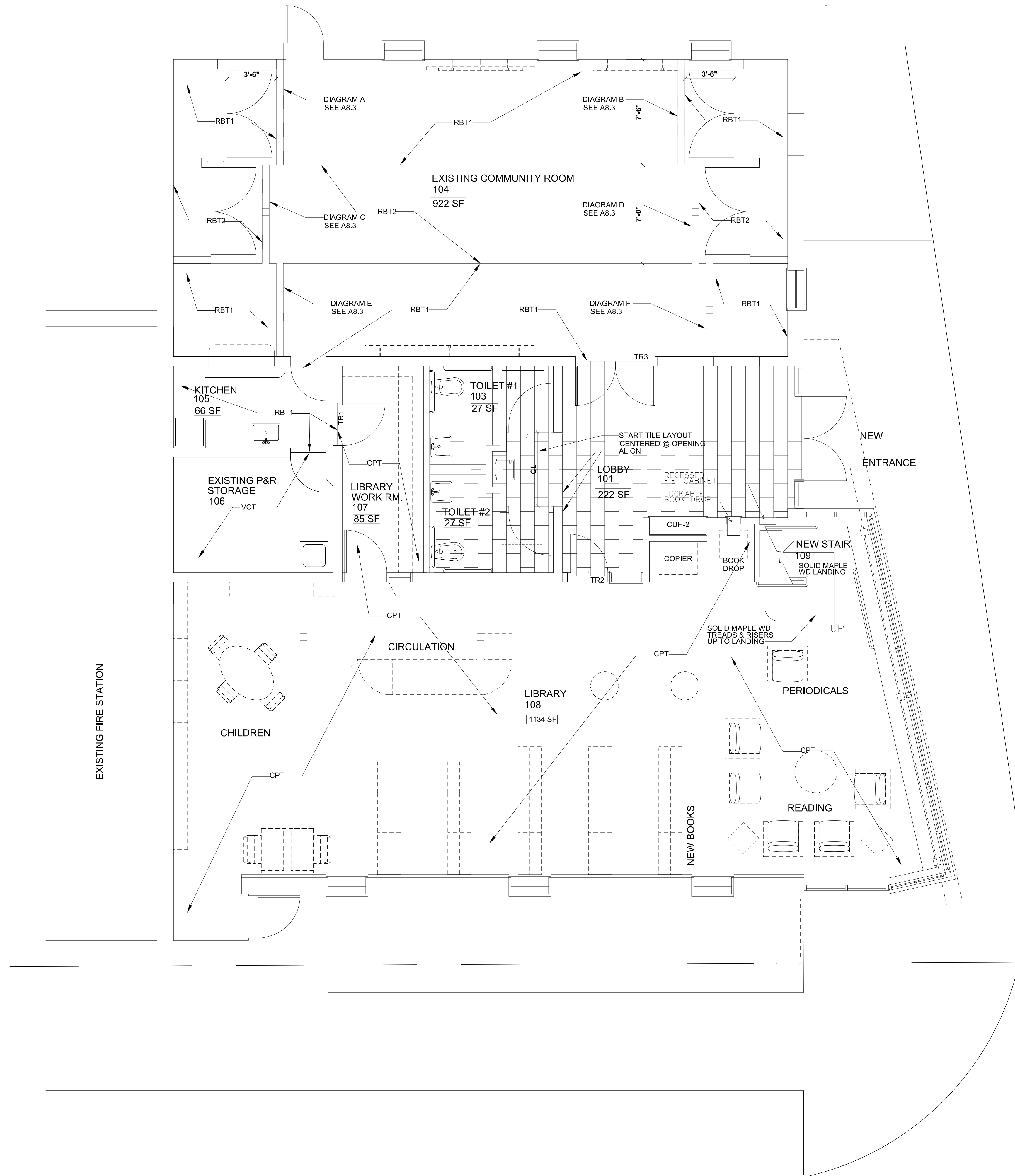

STERLING STREET

EXISTING FIRE STATION

ISLAND AVENUE

PROPOSED IMPROVEMENTS

**PEAKS ISLAND COMMUNITY CENTER & LIBRARY**

Title:  
 FIRST FLOOR FINISH PLAN

Sheet No.

**A8.1**

Scale: 1/4" = 1'-0"  
 Date:  
 Revised:

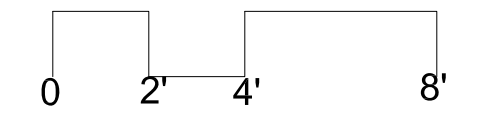
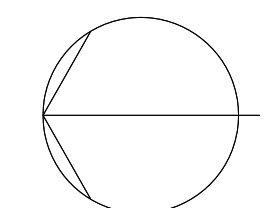

12-21-16 ISSUED FOR REVIEW