

ARCHITECT:  
**REED & CO. ARCHITECTURE**  
 46 CUMBERLAND AVE  
 PORTLAND, ME 04101  
 207 871 5678

INTERIOR DESIGNER:  
**COLE DESIGN**  
 PO BOX 381  
 KITTERY, ME 03904  
 207 653 0083

STRUCTURAL ENGINEER:  
**SHELLEY ENGINEERING**  
 PO BOX 1030  
 GRAY, ME 04039  
 207 657 8031

MECHANICAL ENGINEER:  
**HOLBROOK ENGINEERING**  
 52 HEATH RD  
 SAKO, ME 04072  
 207 283 9127

ELECTRICAL ENGINEER:  
**BARTLETT DESIGN**  
 942 WASHINGTON STREET  
 BATH, MAINE 04530  
 207 443 5447

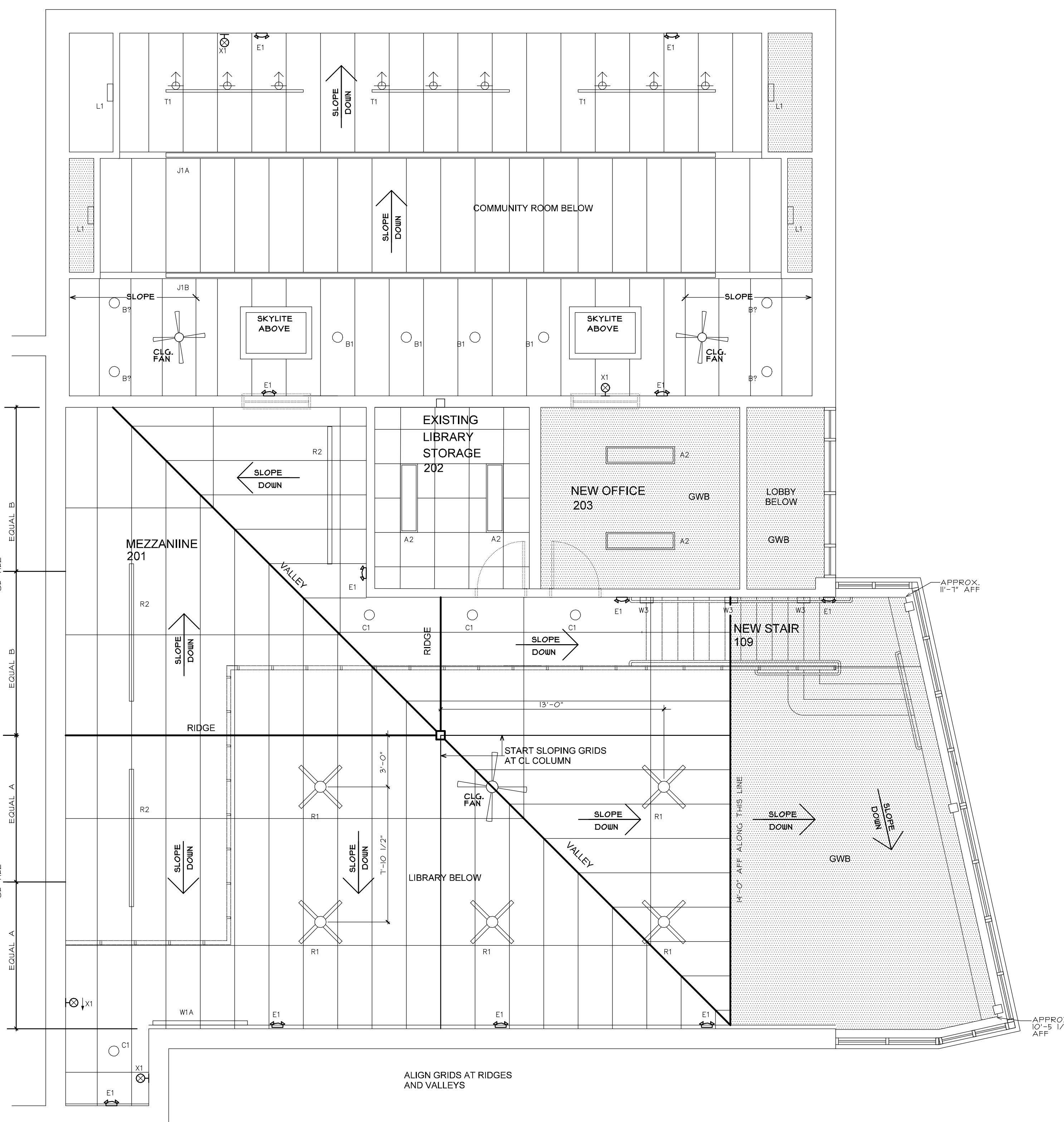

UPPER REFLECTED CEILING PLAN

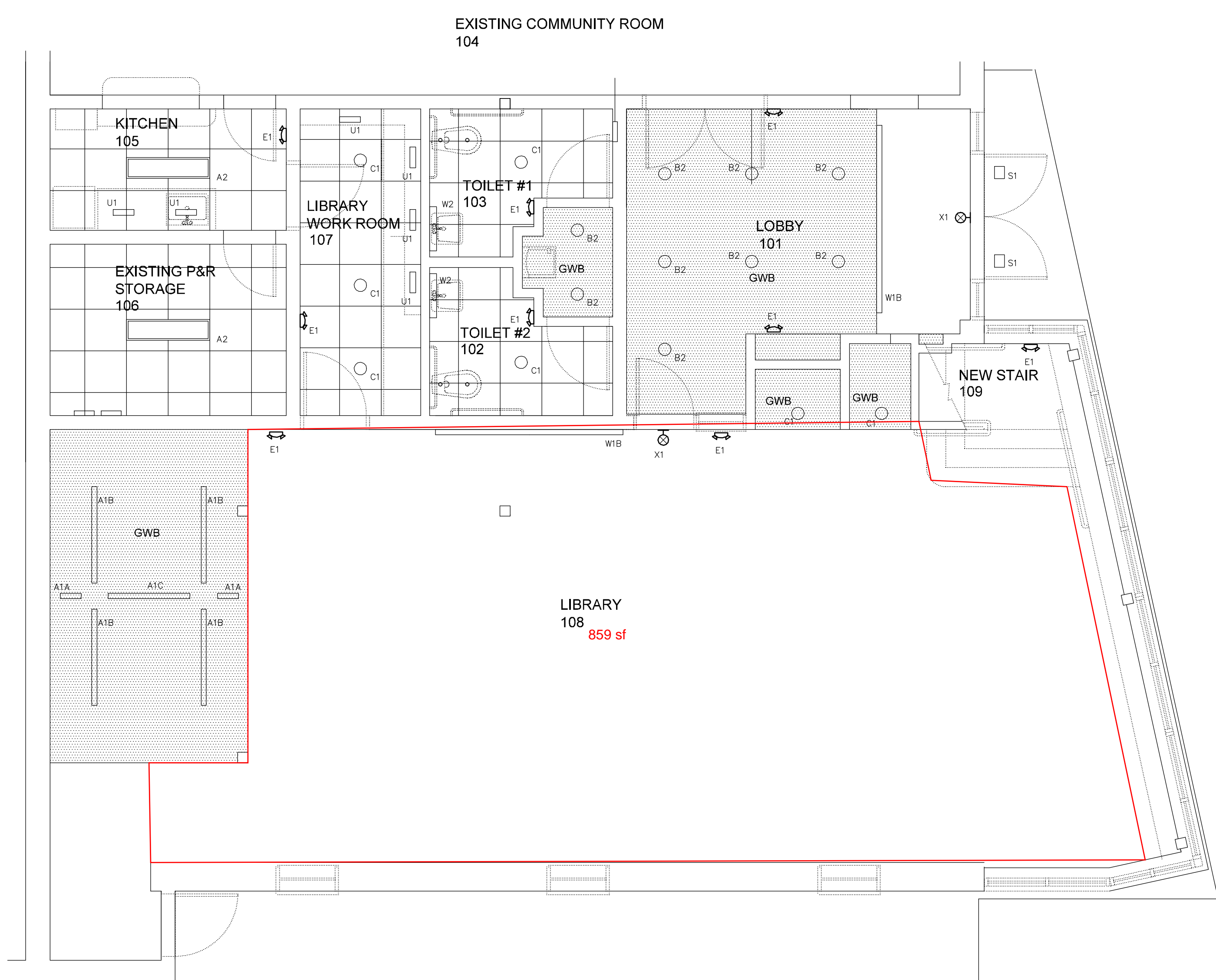

BELOW MEZZANINE REFLECTED CEILING PLAN

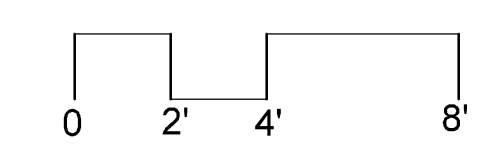
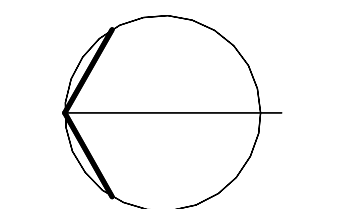

12-21-16 Issued for Review

PROPOSED IMPROVEMENTS

**PEAKS ISLAND COMMUNITY CENTER & LIBRARY**

Title:  
 REFLECTED CEILING PLANS  
 Sheet No.

**A4.1**

Scale: 1/4" = 1'-0"  
 Date:  
 Revised: