

ARCHITECT:
REED & CO. ARCHITECTURE
 46 CUMBERLAND AVE
 PORTLAND, ME 04101
 207 871 5678

INTERIOR DESIGNER:
COLE DESIGN
 PO BOX 381
 KITTERY, ME 03904
 207 653 0083

STRUCTURAL ENGINEER:
SHELLEY ENGINEERING
 PO BOX 1030
 GRAY, ME 04039
 207 657 8031

MECHANICAL ENGINEER:
HOLBROOK ENGINEERING
 52 HEATH RD
 SACO, ME 04072
 207 283 9127

ELECTRICAL ENGINEER:
BARTLETT DESIGN
 942 WASHINGTON STREET
 BATH, MAINE 04530
 207 443 5447

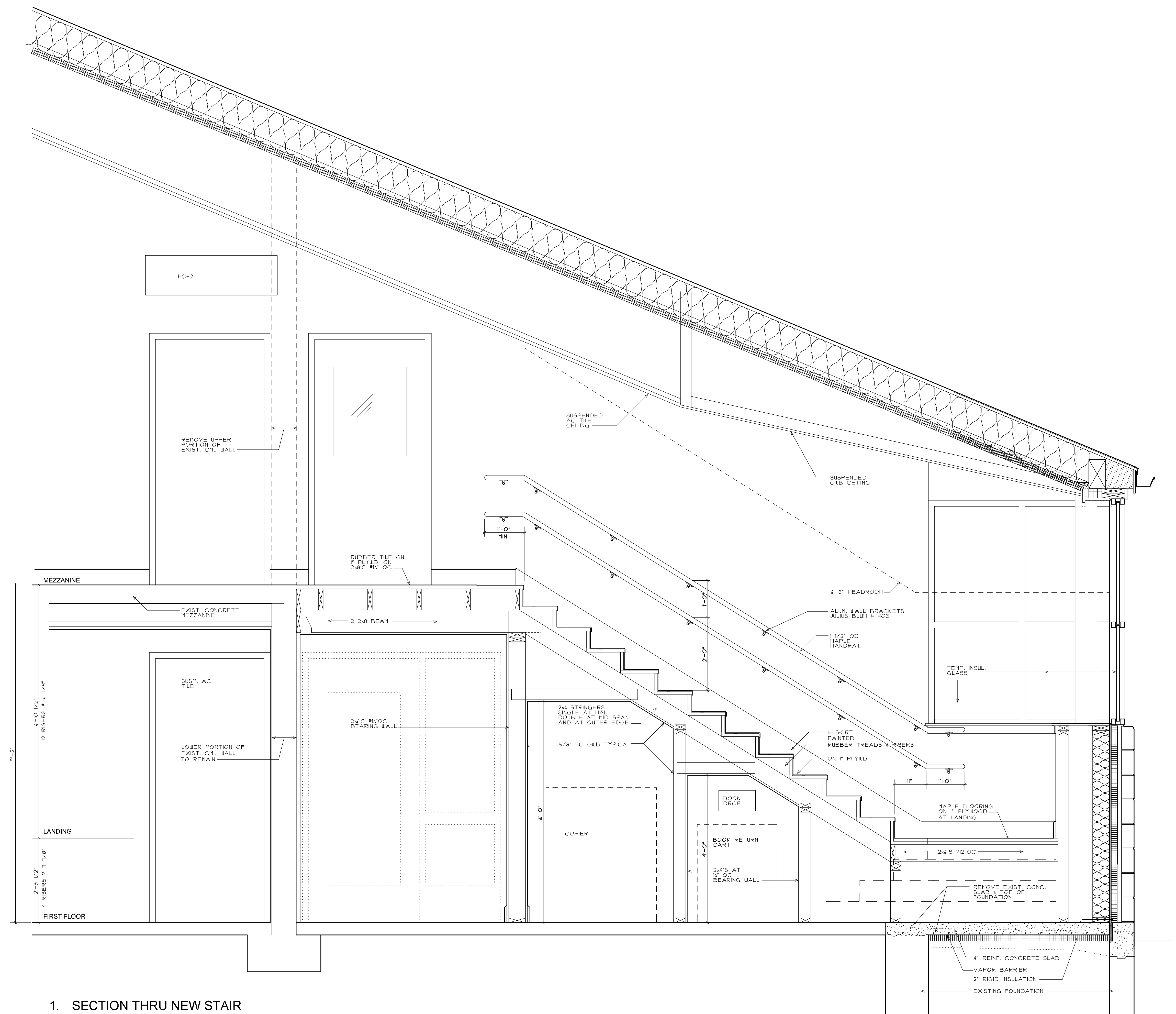

1. SECTION THRU NEW STAIR

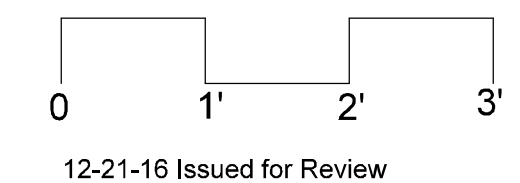

PROPOSED
 IMPROVEMENTS

**PEAKS ISLAND
 COMMUNITY
 CENTER
 & LIBRARY**

Title: STAIR SECTION
 Sheet No. **A3.1**
 Scale: 3/4" = 1'-0"
 Date: XXX
 Revised: