

FILE COPY



Rachel Conly
Architectural Design
26 Sterling Street
Peaks Island, Maine 04108
207.766.5625

DATE	NOTES
2015.09.17	
REVISED	

1/4"=1'

PROJECT
Medlen Residence
34 Sterling St.
Peaks Island, ME

A9
Proposed First Floor Plan

1. ALL EXISTING WALLS SHALL BE REINFORCED TO MATCH EXISTING WALLS. ALL EXISTING WALLS SHALL BE REINFORCED TO MATCH EXISTING WALLS. ALL EXISTING WALLS SHALL BE REINFORCED TO MATCH EXISTING WALLS.
2. ALL EXISTING WALLS SHALL BE REINFORCED TO MATCH EXISTING WALLS. ALL EXISTING WALLS SHALL BE REINFORCED TO MATCH EXISTING WALLS. ALL EXISTING WALLS SHALL BE REINFORCED TO MATCH EXISTING WALLS.
3. ALL EXISTING WALLS SHALL BE REINFORCED TO MATCH EXISTING WALLS. ALL EXISTING WALLS SHALL BE REINFORCED TO MATCH EXISTING WALLS. ALL EXISTING WALLS SHALL BE REINFORCED TO MATCH EXISTING WALLS.
4. ALL EXISTING WALLS SHALL BE REINFORCED TO MATCH EXISTING WALLS. ALL EXISTING WALLS SHALL BE REINFORCED TO MATCH EXISTING WALLS. ALL EXISTING WALLS SHALL BE REINFORCED TO MATCH EXISTING WALLS.
5. ALL EXISTING WALLS SHALL BE REINFORCED TO MATCH EXISTING WALLS. ALL EXISTING WALLS SHALL BE REINFORCED TO MATCH EXISTING WALLS. ALL EXISTING WALLS SHALL BE REINFORCED TO MATCH EXISTING WALLS.

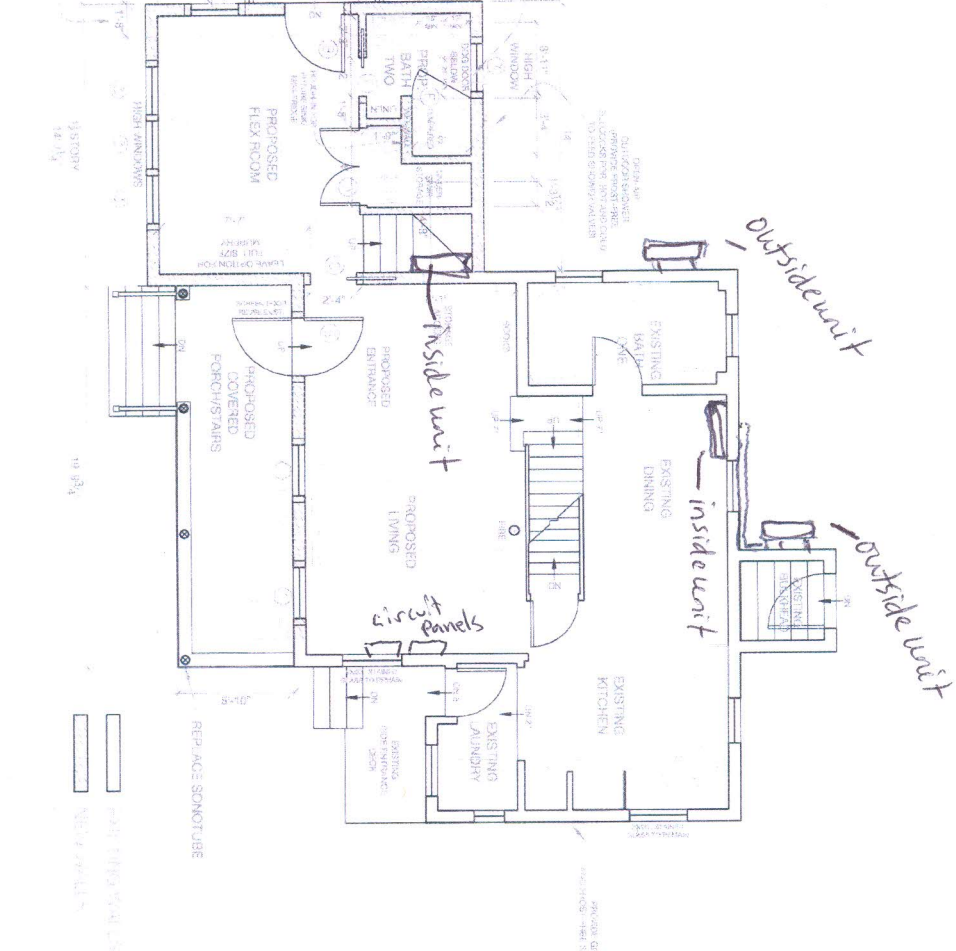

A Proposed First Floor Plan

