

GENERAL NOTES:
 1.) ADDITION TO HAVE FULL BASEMENT. CONNECT TO MAIN BASEMENT IF PRACTICAL - WILL REQUIRE INCREASING SIZE OF EXISTING BASEMENT, (REPLACING SECTION OF CRAWLSPACE.) PROVIDE MAN-DOOR BETWEEN OLD AND NEW SECTIONS OF BASEMENT.
 2.) PROVIDE A HIGH PERFORMANCE MOISTURE CONTROLLED, CONTINUOUS AIR TIGHT AND INSULATED ENVELOPE FOR ADDITION, INCLUDING BASEMENT.

EXTEND NEW BASEMENT UNDER EXISTING HOUSE;
 CUT DOORWAY IN EXISTING BASEMENT WALL

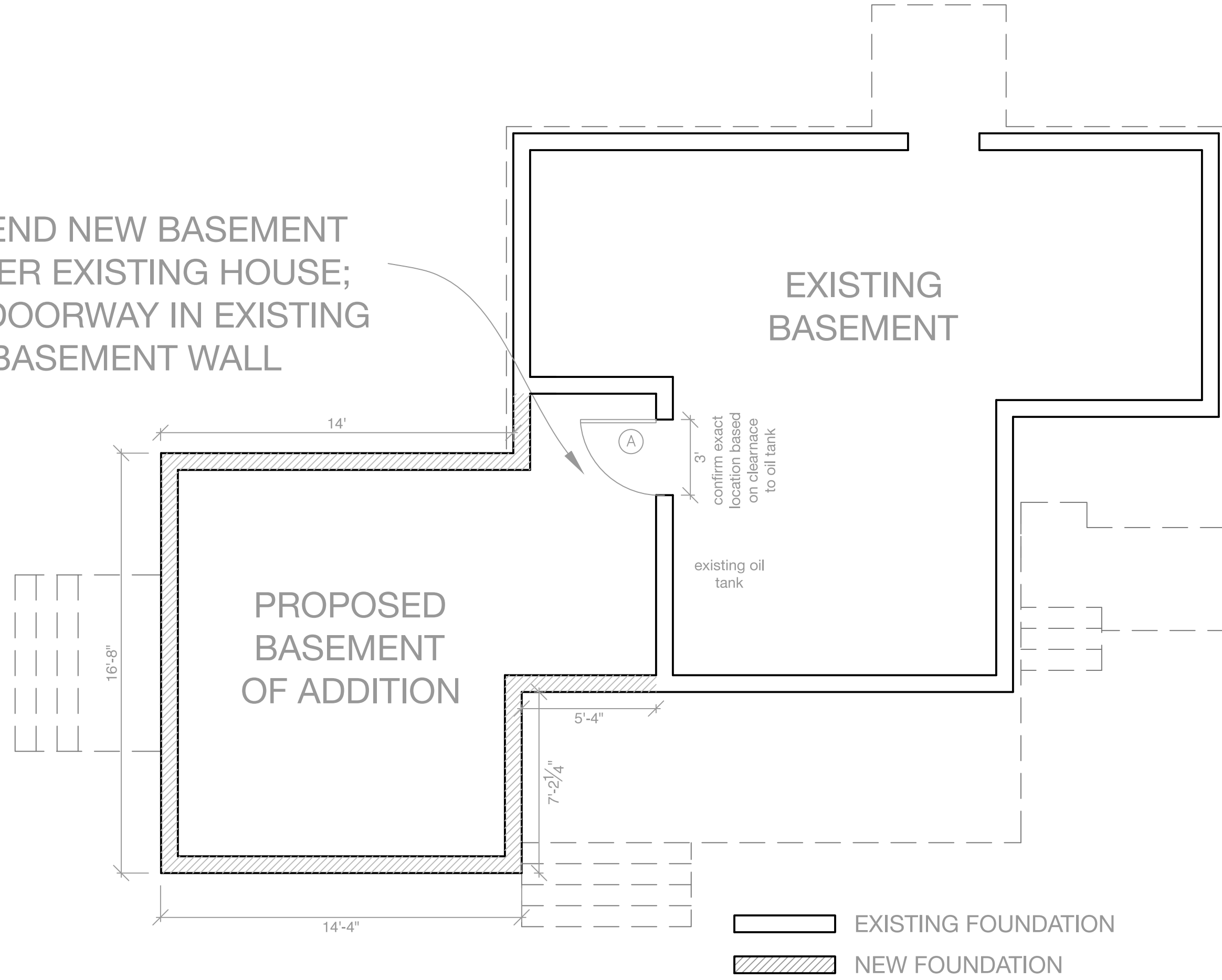

A Proposed Basement Plan

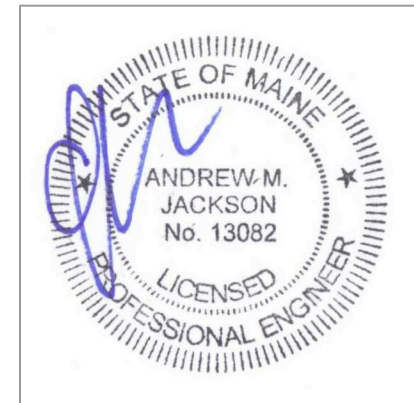

Rachel Conly
 Architectural Design
 26 Sterling Street
 Peaks Island, Maine 04108
 207.766.5625

DATE	NOTES
2015.09.17	
2015.11.02	Removed cantilever

1/4" = 1'

Medlen Residence
 34 Sterling St.
 Peaks Island, ME

A8
 Proposed
 Basement
 Plan