

WINDOW SCHEDULE

MINUM U FACTOR FOR WINDOWS IN HEATED SPACES — .31 TO .17
 MINUM R VALUE FOR WINDOWS IN HEATED SPACES — 3.3

- 7. (W1) 2X2 RD. CASEMENT
- 3. (W4) 2X2 RD CASEMENT SINGLE GLAZE
- 4. (W1.3) 2-6 X 2-6 AWNING SINGLE GLAZE
- 8. (W2) 3-2 3/8 X 5-0 7/8 DOUBLE HUNG *
- 3. (W3) 3-0 3/8 X 4-8 3/8 RD. DOUBLE HUNG
- 2. (W4) 2-6 X 2X6 R.O. CASEMENT
- 3. (W5) 3-0 3/8 X 5-8 3/8 RD. DOUBLE HUNG *
- 4. (W6) 4-0 X 4-0 RD. CASEMENT *
- 2. (W7) 2-6 X 4-0 RD. CASEMENT *
- 3. (W1.3) 3-0 X 2-0 RD AWNING SINGLE GLAZE

* MEETS EGRESS REQUIREMENTS

- 9. (D1) 2-6 X 6-8 SOLID WOOD INTERIOR DOOR WITH WINDOW
- 1. (D2) 3-0 X 6-8 INSULATED EXTERIOR DOOR WITH WINDOW
- (D3) 2-6 X 6-8 INSULATED EXTERIOR DOOR WITH WINDOW
- (D4) 2-6 X 6-8 INSULATED EXTERIOR DOOR

STAIRS CROSSECTION

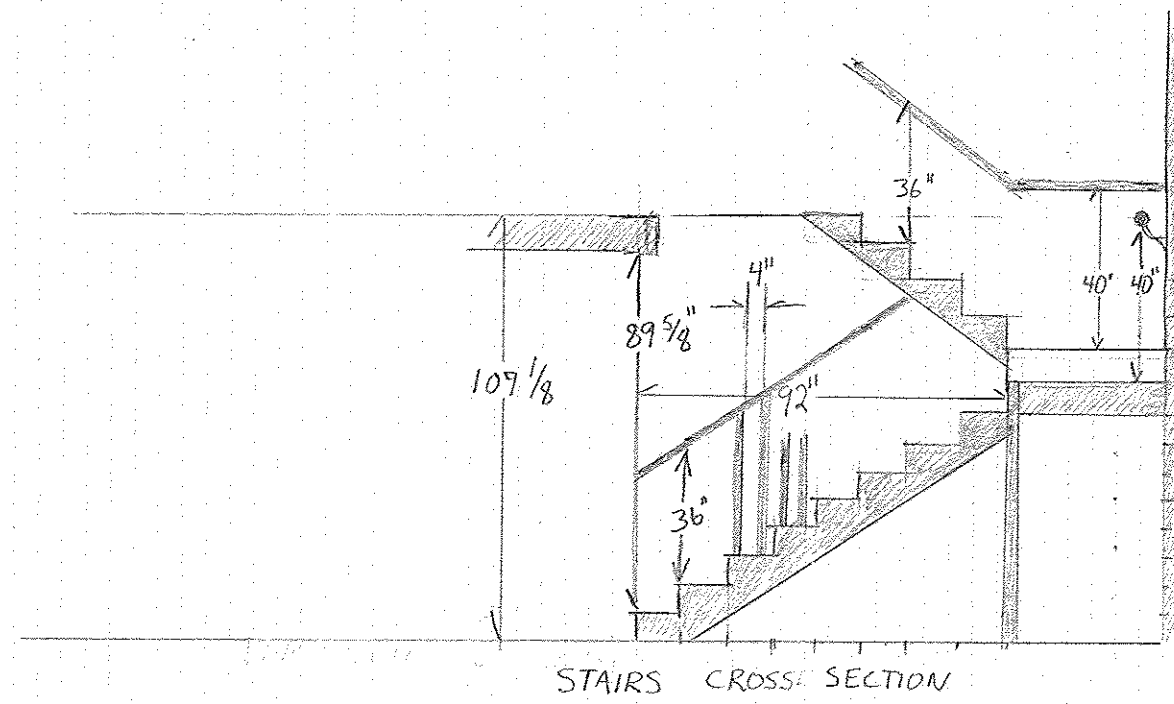

RISERS = 7 5/8"
 TREADS = 11 1/2"

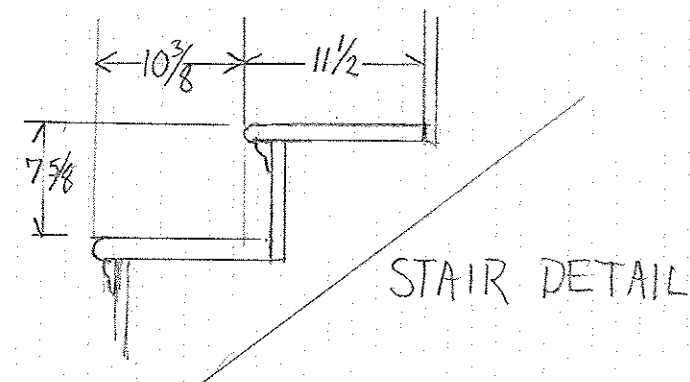

STAIR DETAIL

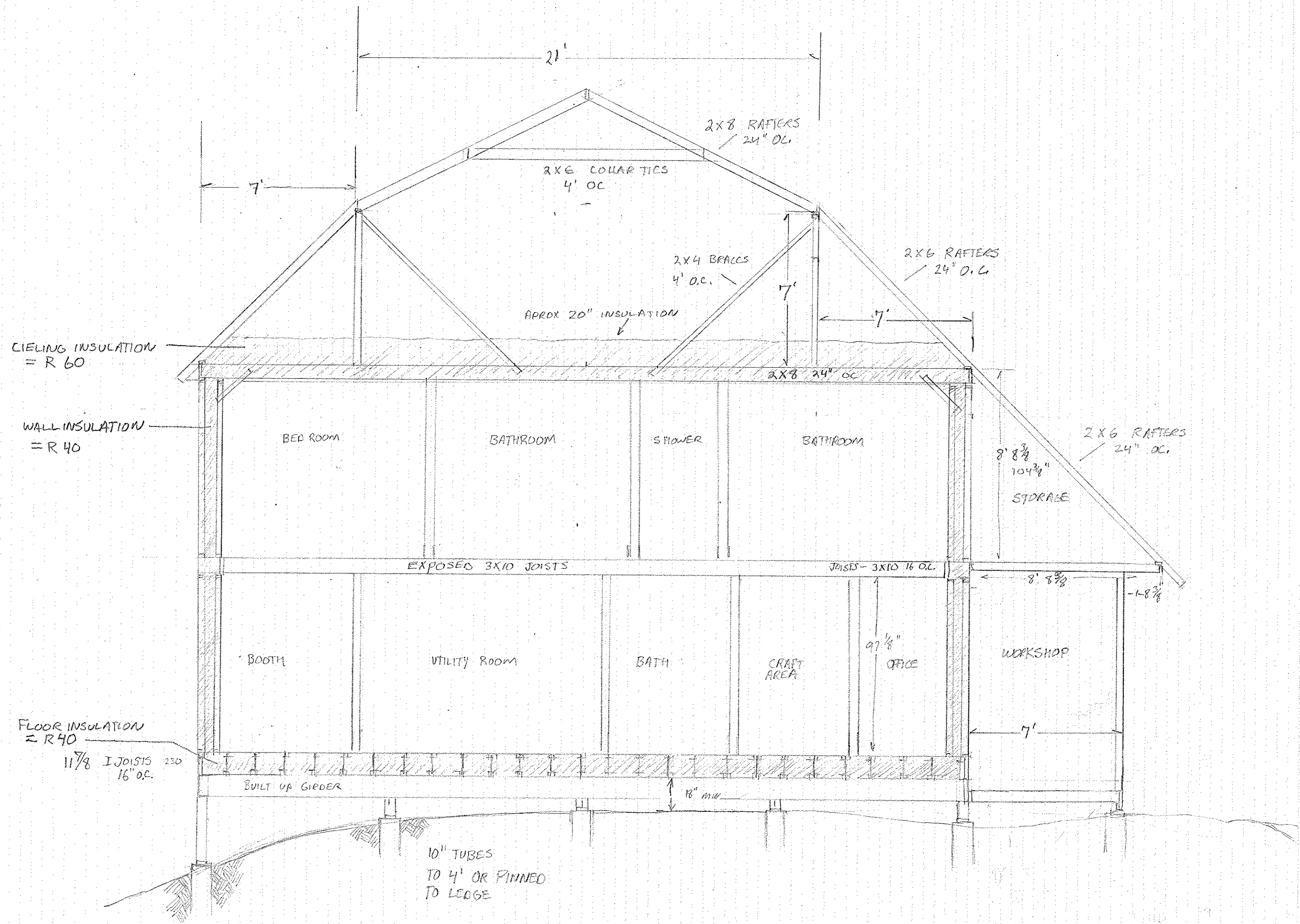

CROSS SECTION

SCALE 1/4" = 1' ← → = 1'