

PERMIT ISSUED

City of Portland, Maine - Building or Use Permit Application
389 Congress Street, 04101 Tel: (207) 874-8703, Fax: (207) 874-8716

Permit No: 03-0813	Issue Date: JUL 15 2003	CBL: 087 C003001
-----------------------	-----------------------------------	---------------------

Location of Construction: 67 Pleasant Ave Pi	Owner Name: Stein Donald K &	Owner Address: 67 Pleasant Ave CITY OF PORTLAND	Phone: 766-5138
Business Name:	Contractor Name: McTigue, Construction	Contractor Address: 97 Brackett Ave, P.I. Portland	Phone: 2077662676
Lessee/Buyer's Name	Phone:	Permit Type: Additions - Dwellings	Zone: IR-1

Past Use: Single Family	Proposed Use: Single Family w/sunroom	Permit Fee: \$201.00	Cost of Work: \$20,000.00	CEO District: 3
----------------------------	--	-------------------------	------------------------------	--------------------

FIRE DEPT: <input type="checkbox"/> Approved <input type="checkbox"/> Denied	INSPECTION: Use Group: 23 Type: 5B BOCA 1999
Signature:	Signature: JMB 7/15/03

Proposed Project Description:
Build 10x14 three season room

PEDESTRIAN ACTIVITIES DISTRICT (P.A.D.)
Action: Approved Approved w/Conditions Denied
Signature: _____ Date: _____

Permit Taken By: jmb	Date Applied For: 07/15/2003	Zoning Approval
-------------------------	---------------------------------	------------------------

- This permit application does not preclude the Applicant(s) from meeting applicable State and Federal Rules.
- Building permits do not include plumbing, septic or electrical work.
- Building permits are void if work is not started within six (6) months of the date of issuance. False information may invalidate a building permit and stop all work..

Special Zone or Reviews	Zoning Appeal	Historic Preservation
<input type="checkbox"/> Shoreland <input type="checkbox"/> Wetland <input checked="" type="checkbox"/> Flood Zone <i>Panel 15 Zone C</i> <input type="checkbox"/> Subdivision <input type="checkbox"/> Site Plan <i>well over 75' to Stream protection</i> Maj <input type="checkbox"/> Minor <input type="checkbox"/> MM <input type="checkbox"/> Date: JMB 7/15/03	<input type="checkbox"/> Variance <input type="checkbox"/> Miscellaneous <input type="checkbox"/> Conditional Use <input type="checkbox"/> Interpretation <input type="checkbox"/> Approved <input type="checkbox"/> Denied Date: _____	<input checked="" type="checkbox"/> Not in District or Landmark <input type="checkbox"/> Does Not Require Review <input type="checkbox"/> Requires Review <input type="checkbox"/> Approved <input type="checkbox"/> Approved w/Conditions <input type="checkbox"/> Denied Date: JMB

CERTIFICATION

I hereby certify that I am the owner of record of the named property, or that the proposed work is authorized by the owner of record and that I have been authorized by the owner to make this application as his authorized agent and I agree to conform to all applicable laws of this jurisdiction. In addition, if a permit for work described in the application is issued, I certify that the code official's authorized representative shall have the authority to enter all areas covered by such permit at any reasonable hour to enforce the provision of the code(s) applicable to such permit.

SIGNATURE OF APPLICANT ADDRESS DATE PHONE

RESPONSIBLE PERSON IN CHARGE OF WORK, TITLE DATE PHONE

City of Portland, Maine - Building or Use Permit

389 Congress Street, 04101 Tel: (207) 874-8703, Fax: (207) 874-8716

Permit No: 03-0813	Date Applied For: 07/15/2003	CBL: 087 C003001
------------------------------	--	----------------------------

Location of Construction: 67 Pleasant Ave Pi	Owner Name: Stein Donald K &	Owner Address: 67 Pleasant Ave	Phone: () 766-5138
Business Name:	Contractor Name: McTigue, Construction	Contractor Address: 97 Brackett Ave, P.I. Portland	Phone: (207) 766-2676
Lessee/Buyer's Name	Phone:	Permit Type: Additions - Dwellings	

Proposed Use: Single Family w/sunroom	Proposed Project Description: Build 10x14 three season room
---	---

Dept: Zoning **Status:** Approved **Reviewer:** Jeanine Bourke **Approval Date:** 07/15/2003

Note: **Ok to Issue:**

- 1) This property shall remain a single family dwelling. Any change of use shall require a separate permit application for review and approval.

Dept: Building **Status:** Approved **Reviewer:** Jeanine Bourke **Approval Date:** 07/15/2003

Note: **Ok to Issue:**

- 1) All notes on plans made w/owner at review and will be given to contractor
- 2) Separate permits are required for any electrical or plumbing work.
- 3) Application approval based upon information provided by applicant. Any deviation from approved plans requires separate review and approval prior to work.

All Purpose Building Permit Application

If you or the property owner owes real estate or personal property taxes or user charges on any property within the City, payment arrangements must be made before permits of any kind are accepted.

Location/Address of Construction: <u>67 Pleasant Ave. Peaks Island</u>		
Total Square Footage of Proposed Structure <u>140 sq. ft.</u>	Square Footage of Lot <u>64,309</u>	
Tax Assessor's Chart, Block & Lot Chart# <u>097</u> Block# <u>C-100</u> Lot# <u>003</u>	Owner: <u>Stein, Donald K. a Lane Williamson JTS</u>	Telephone: <u>766-5138</u>
Lessee/Buyer's Name (If Applicable) <u>N/A</u>	Applicant name, address & telephone: <u>Donald Stein, Lane Williamson P.O. Box 53, 67 Pleasant Ave Peaks Island, ME 04108</u>	Cost Of Work: <u>\$20,000</u> Fee: <u>\$ 201.00</u>
Current use: <u>residential-home</u>		
If the location is currently vacant, what was prior use: <u>N/A</u>		
Approximately how long has it been vacant: <u>N/A</u>		
Proposed use: <u>3 season porch</u>		
Project description: <u>Add 3 season porch to existing house</u>		
Contractor's name, address & telephone: <u>Bob McTigue, Braukton Ave, P.F. 766-2676</u>		
Who should we contact when the permit is ready: <u>Donald Stein</u>		
Mailing address: <u>P.O. Box 53 Peaks Island, ME 04108-0053</u>		
We will contact you by phone when the permit is ready. You must come in and pick up the permit and review the requirements before starting any work, with a Plan Reviewer. A stop work order will be issued and a \$100.00 fee if any work starts before the permit is picked up. PHONE: <u>766-5138</u>		

IF THE REQUIRED INFORMATION IS NOT INCLUDED IN THE SUBMISSIONS THE PERMIT WILL BE AUTOMATICALLY DENIED AT THE DISCRETION OF THE BUILDING/PLANNING DEPARTMENT, WE MAY REQUIRE ADDITIONAL INFORMATION IN ORDER TO APPROVE THIS PERMIT.

I hereby certify that I am the Owner of record of the named property, or that the owner of record authorizes the proposed work and that I have been authorized by the owner to make this application as his/her authorized agent. I agree to conform to all applicable laws of this jurisdiction. In addition, if a permit for work described in this application is issued, I certify that the Code Official's authorized representative shall have the authority to enter all areas covered by this permit at any reasonable hour to enforce the provisions of the codes applicable to this permit.

Signature of applicant: <u>Donald A. Stein</u>	Date: <u>7/14/03</u>
--	----------------------

**This is NOT a permit, you may not commence ANY work until the permit is issued.
If you are in a Historic District you may be subject to additional permitting and fees with the
Planning Department on the 4th floor of City Hall**

This page contains a detailed description of the Parcel ID you selected. Press the **New Search** button at the bottom of the screen to submit a new query.

Current Owner Information

Card Number	1 of 1
Parcel ID	087 C003001
Location	67 PLEASANT AVE PI
Land Use	SINGLE FAMILY
Owner Address	STEIN DONALD K & LANE B WILLIAMSON JTS 67 PLEASANT AVE PEAKS ISLAND ME 04108
Book/Page	14580/122
Legal	67-C-3 PLEASANT AVE PEAKS ISLAND 64309 SF

Valuation Information

Land	Building	Total
\$59,540	\$108,040	\$167,580

Property Information

Year Built	Style	Story Height	Sq. Ft.	Total Acres	
1820	Old Style	1.5	2064	1.476	
Bedrooms	Full Baths	Half Baths	Total Rooms	Attic	Basement
3	2		10	None	Part

Outbuildings

Type	Quantity	Year Built	Size	Grade	Condition
POOL-PREFAB	1	1975	42X20	C	G
PLASTIC LINER	1	1940	30X16	C	A
GARAGE-WD/CB	1	1900	8X16	D	A
SHED-FRAME					

Sales Information

Date	Type	Price	Book/Page
03/01/1999	LAND + BLDING	\$226,000	14580-122

Picture and Sketch

[Picture](#) [Sketch](#)

[Click here](#) to view Tax Roll Information.

Any information concerning tax payments should be directed to the Treasury office at 874-8490 or e-mailed.



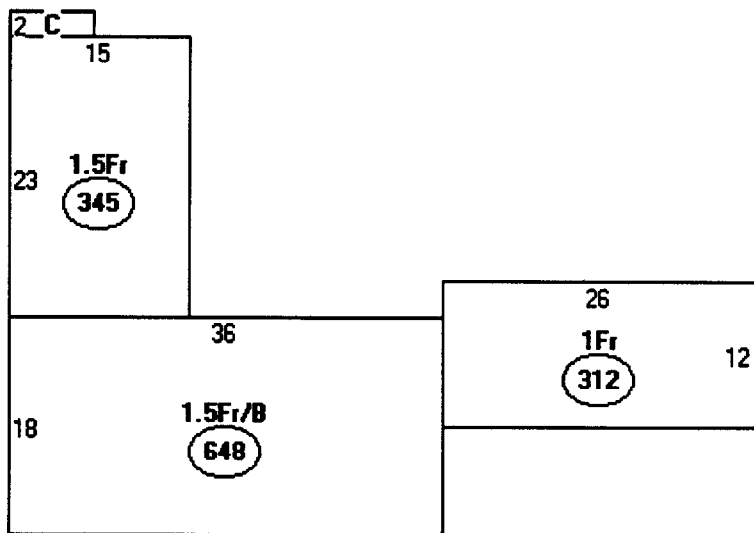

Descriptor/Area

A: 1.5Fr/B
648 sqft

B: 1.5Fr
345 sqft

C: FBAY
14 sqft

D: 1Fr
312 sqft

1319

496 garage

140 garage add.

135 shed

2,090 SF
14 @ sunroom

2,230

64,309 SF

x 20%

12,861 SF

OK



BUILDING PERMIT INSPECTION PROCEDURES

Please call 874-8703 or ~~874-8693~~ to schedule your inspections as agreed upon

Permits expire in 6 months, if the project is not started or ceases for 6 months.

The Owner or their designee is required to notify the inspections office for the following inspections and provide adequate notice. Notice must be called in 48-72 hours in advance in order to schedule an inspection:

By initialzing at each inspection time, you are agreeing that you understand the inspection procedure and additional fees from a "Stop Work Order" and "Stop Work Order Release" will be incurred if the procedure is not followed as stated below.

JB Pre-construction Meeting: Must be scheduled with your inspection team upon receipt of this permit. ~~Jay Reynolds, Development Review Coordinator at 874-8632 must also be contacted at this time, before any site work begins on any project other than single family additions or alterations.~~

Footing/Building Location Inspection: Prior to pouring concrete

NA Re-Bar Schedule Inspection: Prior to pouring concrete

NA Foundation Inspection: Prior to placing ANY backfill

Framing/Rough Plumbing/Electrical: Prior to any insulating or drywalling

Final/Certificate of Occupancy: Prior to any occupancy of the structure or use. NOTE: ~~There is a \$75.00 fee per inspection at this point.~~

Certificate of Occupancy is not required for certain projects. Your inspector can advise you if your project requires a Certificate of Occupancy. All projects DO require a final inspection

If any of the inspections do not occur, the project cannot go on to the next phase, REGARDLESS OF THE NOTICE OR CIRCUMSTANCES.

NA **CERIFICATE OF OCCUPANICES MUST BE ISSUED AND PAID FOR, BEFORE THE SPACE MAY BE OCCUPIED**

[Signature]
Signature of applicant/designee

7/15/03
Date

[Signature]
Signature of Inspections Official

7/15/03
Date

CBL: 87-C-3 Building Permit #: 03-0813

DISPLAY THIS CARD ON PRINCIPAL FRONTAGE OF WORK

CITY OF PORTLAND

Please Read Application And Notes, If Any, Attached

CONSTRUCTION

PERMIT ISSUED

PERMIT

Permit Number: 030813

JUL 15 2003

This is to certify that Stein Donald K &/McTigue, Construction
has permission to Build 10x14 three season room
AT 67 Pleasant Ave Pi C 087 C003001

CITY OF PORTLAND

provided that the person or persons, firm or corporation accepting this permit shall comply with all of the provisions of the Statutes of Maine and of the ordinances of the City of Portland regulating the construction, maintenance and use of buildings and structures, and of the application on file in this department.

Notification of inspection must be given and written permission procured before this building or part thereof is leased or otherwise closed-in. HOUR NOTICE IS REQUIRED.

Apply to Public Works for street line and grade if nature of work requires such information.

A certificate of occupancy must be procured by owner before this building or part thereof is occupied.

OTHER REQUIRED APPROVALS

Fire Dept. _____
Health Dept. _____
Appeal Board _____
Other _____
Department Name

Jaime Bonke 7/15/03
Director - Building & Inspection Services

PENALTY FOR REMOVING THIS CARD