

NOTES:

- 1.) ELECTRICAL, MECHANICAL, AND PLUMBING SPECIFICATIONS AND PERMITS BY OTHERS.
- 2.) PROVIDE AFCI CIRCUIT BREAKERS IN ELECTRICAL PANEL AND SUB-PANELS, AS REQUIRED BY CODE, TO PROTECT LISTED ROOM TYPES.
- 3.) CONTRACTOR RESPONSIBLE FOR ENSURING THAT PROJECT MEETS ALL LOCAL ELECTRICAL CODE REQUIREMENTS.
- 4.) CONTRACTOR TO PURCHASE, DELIVER, AND INSTALL ALL PROJECT MATERIALS, COMPONENTS, FINISHES, APPLIANCES AND FIXTURES, UNLESS OTHERWISE NOTED IN CONTRACT. PROVIDE STATED ALLOWANCES IN QUOTE/ESTIMATE FOR ITEMS TO BE SELECTED BY CLIENT AND PAID FOR BY CONTRACTOR.

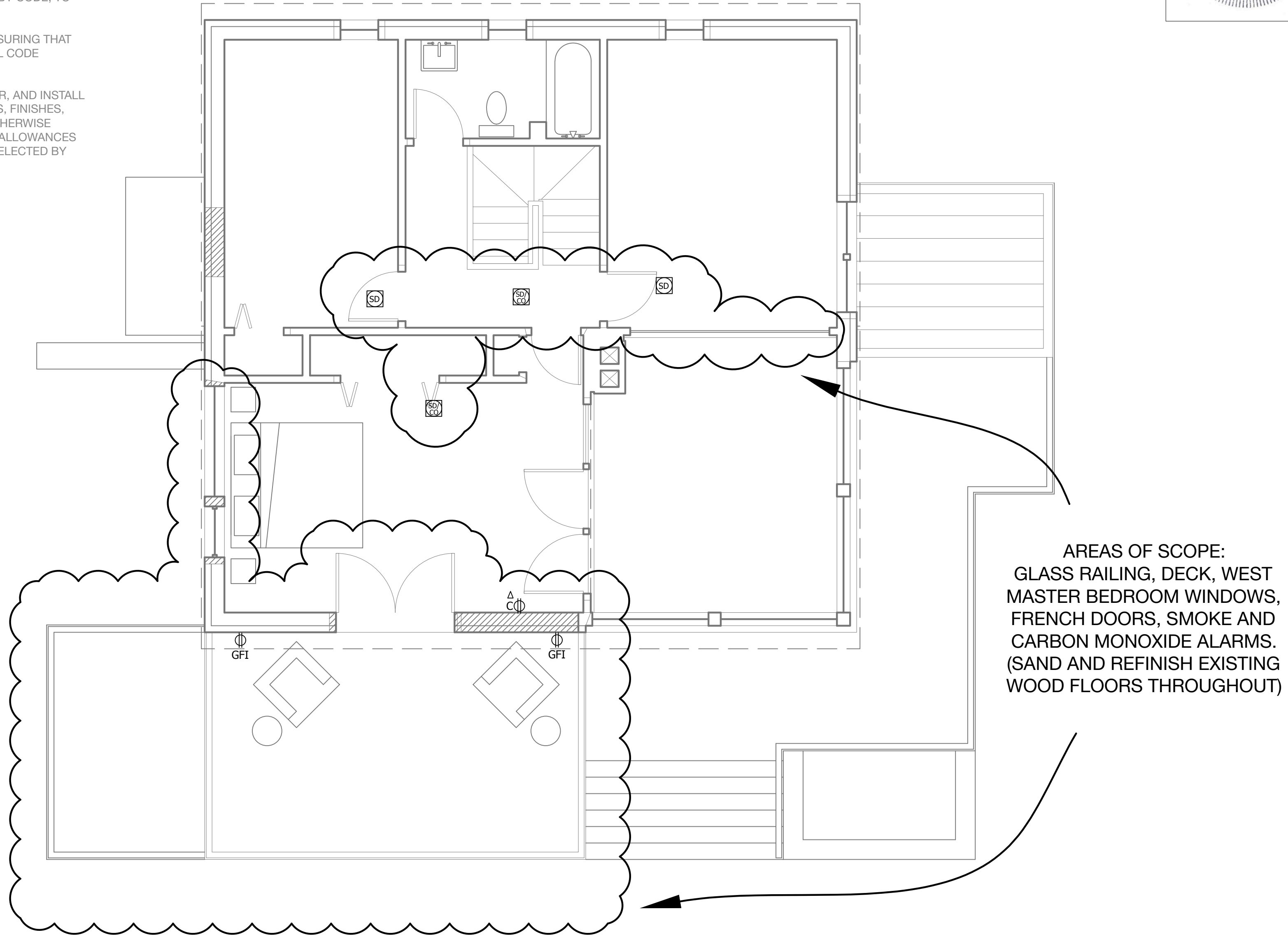
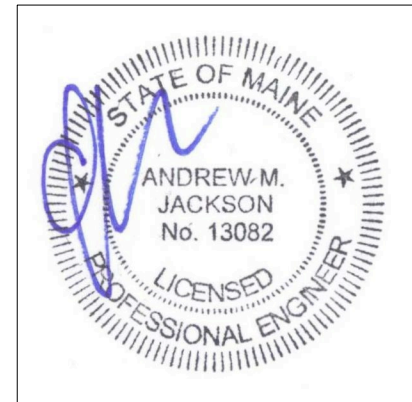

AREAS OF SCOPE:
GLASS RAILING, DECK, WEST
MASTER BEDROOM WINDOWS,
FRENCH DOORS, SMOKE AND
CARBON MONOXIDE ALARMS.
(SAND AND REFINISH EXISTING
WOOD FLOORS THROUGHOUT)

Rachel Conly Design LLC
26 Sterling Street
Peaks Island, Maine 04108
207.766.5625

DATE	NOTES
2016.12.06	
2017.02.23	SMOKE/CO ALARMS

1/4" = 1'

PROJECT
Scott Residence
Peaks Island, ME
04108

A Proposed Second Floor Power Plan

NOTES:

- | | | | | | | |
|--|---|---|--|---|--|---|
| <ul style="list-style-type: none"> ⊕ DUPLEX RECEPTACLE ⊕ GFI GROUND FAULT CIRCUIT INTERRUPTER ⊕ 240 V ⊕ SWITCH | <ul style="list-style-type: none"> 3-WAY SWITCH DIMMER SWITCH SD SMOKE DETECTOR CO CARBON MONOXIDE DETECTOR | <ul style="list-style-type: none"> ⊕ CEILING MOUNT LIGHT FIXTURE ⊕ WALL SCONCE LIGHT FIXTURE ⊕ LOW PROFILE WALL SCONCE LIGHT FIXTURE ⊕ WET LOCATION WALL SCONCE LIGHT FIXTURE | <ul style="list-style-type: none"> ⊙ PENDANT LIGHT FIXTURE RC RECESSED CAN LIGHT FIXTURE FC COMPACT FLUORESCENT RECESSED CAN LIGHT LED 3" LED RECESSED CAN LIGHT | <ul style="list-style-type: none"> — UNDER-COUNTER LIGHTS △ TRACK LIGHTING ⊕ LOCALLY SWITCHED CLOSET RATED LIGHT | <ul style="list-style-type: none"> ⊗ CEILING FAN WITH INTEGRAL LIGHT ⊗ CEILING FAN ⊗ MINIMUM 50 CFM VENT FAN ⊗ MINIMUM 50 CFM VENT FAN/LIGHT COMBO | <ul style="list-style-type: none"> △ PHONE JACK △ DSL DSL JACK △ C CABLE JACK CS CAT 5 JACK CV CENTRAL VACUUM PORT |
|--|---|---|--|---|--|---|

E1
Proposed
Second Floor
Power Plan