

SANDPIPER ROAD

ADJACENT LOT

ADJACENT LOT

SCOTT RESIDENCE
20 SANDPIPER RD.
PEAKS ISLAND, ME
CBL# 85-DD-02
19096 SF
ZONE: IR-1

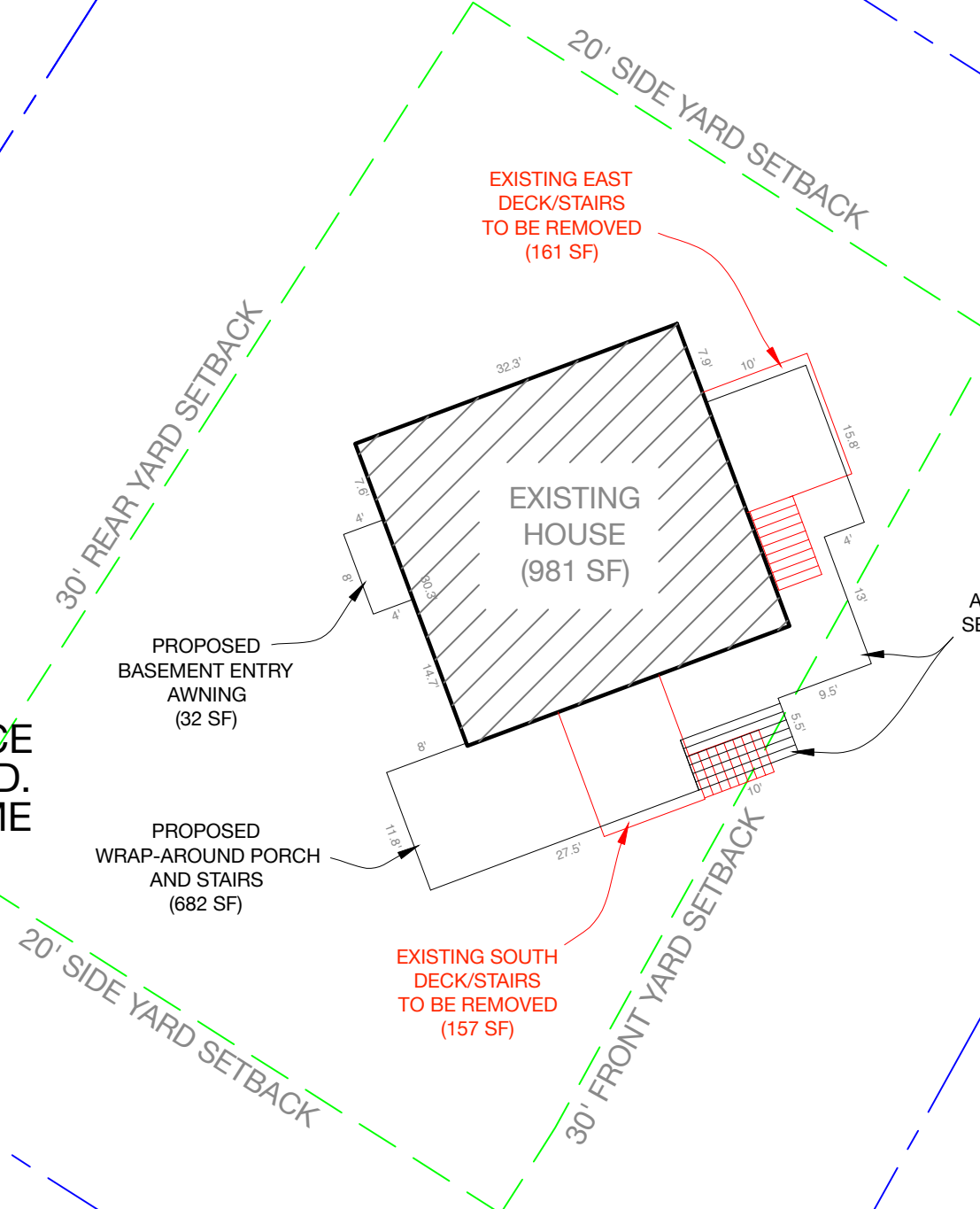

SEASHORE AVE.

75' FROM HIGHEST ANNUAL TIDE LINE

ADJACENT LOT

LOT COVERAGE CALCULATIONS

LOT: 19096 SF X 20% = 3819 SF ALLOWABLE

EXISTING HOUSE	981 SF
EXISTING EAST DECK/STAIRS	161 SF
EXISTING SOUTH DECK/STAIRS	157 SF

TOTAL EXISTING LOT COVERAGE: +1299 SF

REMOVE EXISTING EAST DECK/STAIRS	-161 SF
REMOVE EXISTING SOUTH DECK/STAIRS	-157 SF
ADD PROPOSED WRAP-ROUND PORCH & STAIRS	+682 SF
ADD PROPOSED BASEMENT ENTRY AWNING	+32 SF

TOTAL PROPOSED LOT COVERAGE: =1695 SF (9%)

NOTES

DATE	2016.11.07
REVISED	

PROJECT
Scott Residence
Peaks Island, ME
04108

A Site Plan

1/16" = 1'

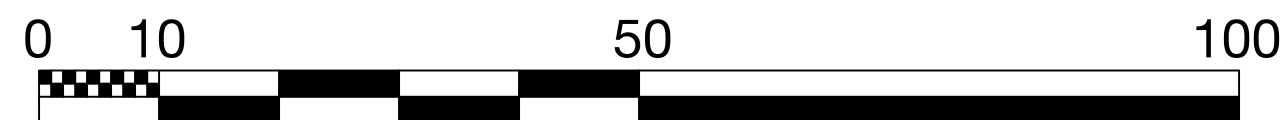
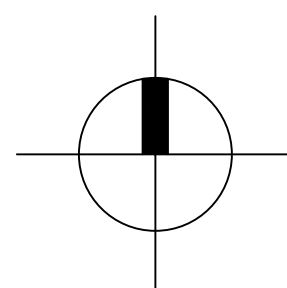

A2

Site Plan