

NOTES:

- 1.) REPLACE ALL WINDOWS OTHER THAN MARVIN WINDOWS IN CATHEDRAL AREA, WITH LOGIC TRIPLE-PANE UPVC WINDOWS.
- 2.) THE GENERAL CONTRACTOR IS RESPONSIBLE FOR ENSURING THAT ALL PROJECT COMPONENTS ARE BUILT/INSTALLED TO CODE.
- 3.) MINI-SPLIT HEAT PUMPS TO PROVIDE PRIMARY HEATING. LOCATIONS OF OUTDOOR UNITS AND INTERIOR AIR HANDLERS TO BE DETERMINED.

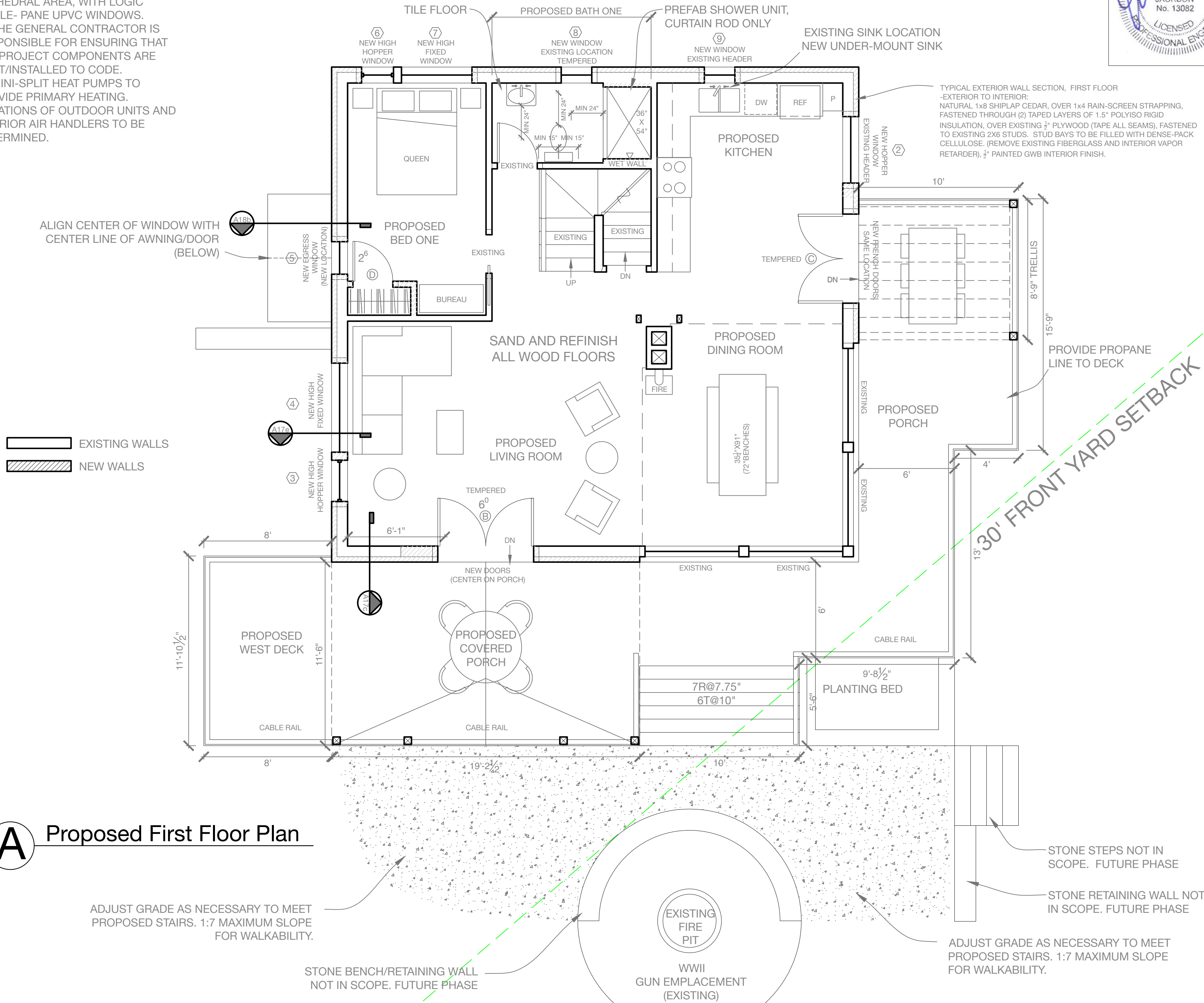
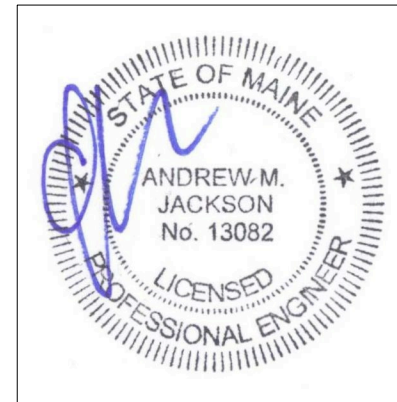

A Proposed First Floor Plan

Rachel Conly Design LLC
 26 Sterling Street
 Peaks Island, Maine 04108
 207.766.5625

DATE	NOTES
2016.11.07	
	REVISED

1/4" = 1'

PROJECT
Scott Residence
 Peaks Island, ME
 04108

A11
 Proposed
 First Floor
 Plan